



H-x030W Series

Pro-Pal Add-A-Drain

Full Port Forged DZR Brass Ball Valve
w/ Cap & Strap
& Adjustable Packing Gland

Certifications

Certified to NSF/ANSI 61 & 372



	Size (in)	Item#	Max Temp	Pressure Rating	Weight (lbs)	Carton Qty	Case Qty
FIP x Hose	1/2" x 3/4"	H-40302W	250°F Max	250 PSI CWP Max	0.41	12	72
	3/4"	H-40303W	250°F Max	250 PSI CWP Max	0.44	12	72
	1" x 3/4"	H-40304W	250°F Max	250 PSI CWP Max	0.55	8	64
	1 1/4" x 3/4"	H-40305W	250°F Max	250 PSI CWP Max	0.78	6	48
	1 1/2" x 3/4"	H-40306W	250°F Max	250 PSI CWP Max	0.91	6	36
G-Thread x Hose	1" x 3/4"	H-G0304W	250°F Max	250 PSI CWP Max	0.55	8	64
	1 1/2" x 3/4"	H-G0306W	250°F Max	250 PSI CWP Max	0.91	6	36
MIP x Hose	1/2" x 3/4"	H-20302W	250°F Max	250 PSI CWP Max	0.41	12	72
	3/4"	H-20303W	250°F Max	250 PSI CWP Max	0.48	12	72
	1" x 3/4"	H-20304W	250°F Max	250 PSI CWP Max	0.59	8	64
	1 1/4" x 3/4"	H-20305W	250°F Max	250 PSI CWP Max	0.66	6	48
	1 1/2" x 3/4"	H-20306W	250°F Max	250 PSI CWP Max	0.96	6	36
Press x Hose	1/2" x 3/4"	H-80302W	250°F Max	250 PSI CWP Max	0.45	12	72
	3/4"	H-80303W	250°F Max	250 PSI CWP Max	0.52	12	72
	1" x 3/4"	H-80304W	250°F Max	250 PSI CWP Max	0.57	8	64
	1 1/4" x 3/4"	H-80305W	250°F Max	250 PSI CWP Max	0.77	6	48
	1 1/2" x 3/4"	H-80306W	250°F Max	250 PSI CWP Max	1.03	6	36
SWT x Hose	1/2" x 3/4"	H-50302W	250°F Max	250 PSI CWP Max	0.36	12	72
	3/4"	H-50303W	250°F Max	250 PSI CWP Max	0.41	12	72
	1" x 3/4"	H-50304W	250°F Max	250 PSI CWP Max	0.47	8	64
	1 1/4" x 3/4"	H-50305W	250°F Max	250 PSI CWP Max	0.73	6	48
	1 1/2" x 3/4"	H-50306W	250°F Max	250 PSI CWP Max	0.89	6	36



	Size (in)	Item#	A	B	C	D	E	F	G	H	I
FIP x Hose	1/2" x 3/4"	H-40302W	1.58	2.74							
	3/4"	H-40303W	1.58	2.74							
	1" x 3/4"	H-40304W	1.58	3.06							
	1 1/4" x 3/4"	H-40305W	1.75	3.15							
	1 1/2" x 3/4"	H-40306W	1.75	3.25							
G-Thread x Hose	1" x 3/4"	H-G0304W	1.58	3.11							
	1 1/2" x 3/4"	H-G0306W	1.75	3.35							
MIP x Hose	1/2" x 3/4"	H-20302W	1.58	2.98							
	3/4"	H-20303W	1.58	3.07							
	1" x 3/4"	H-20304W	1.58	3.39							
	1 1/4" x 3/4"	H-20305W	1.75	3.54							
	1 1/2" x 3/4"	H-20306W	1.75	3.54							
Press x Hose	1/2" x 3/4"	H-80302W	1.58	3.46							
	3/4"	H-80303W	1.58	3.66							
	1" x 3/4"	H-80304W	1.58	3.87							
	1 1/4" x 3/4"	H-80305W	1.75	3.88							
	1 1/2" x 3/4"	H-80306W	1.75	4.33							
SWT x Hose	1/2" x 3/4"	H-50302W	1.58	2.59							
	3/4"	H-50303W	1.58	2.86							
	1" x 3/4"	H-50304W	1.58	3.15							
	1 1/4" x 3/4"	H-50305W	1.75	3.26							
	1 1/2" x 3/4"	H-50306W	1.75	3.56							

Specifications: Threaded ends comply with ANSI B1.20.7. Solder joints per ASME B16.18 Annex A for 95-5 solder. Do not silver braze or over heat valves when soldering. G-threaded bodies require matching G-union fitting for installation. EPDM o-rings for press ends. Designed for use with water, oil, glycol mix in residential or commercial plumbing and heating systems. This valve is actuated by a blowout proof stem and features an adjustable packing gland.

NO.	DESCRIPTION	MATERIAL
1	Packing Gland	Brass
2	Packing	PTFE
3	Body	Lead-Free DZR Brass
4	Seat	PTFE
5	Ball	Brass HCP
6	Strap	PVC
7	Cap	Brass
8	Cap Gasket	EPDM
9	Cap	Lead-Free DZR Brass
10	Handle	Aluminum
11	Screw	Stainless Steel
12	Stem	Brass

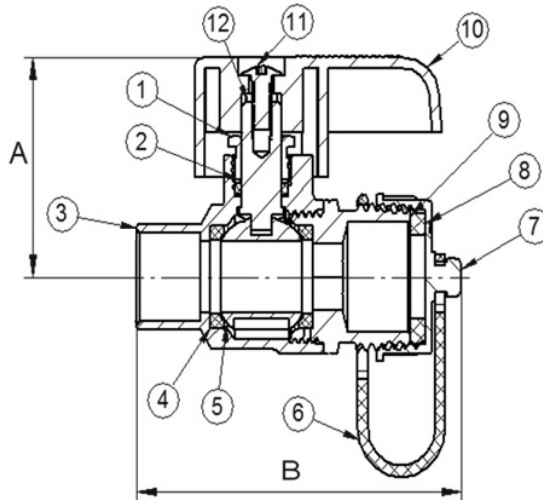

REV:10/11/2022

