

For Residential and Commercial Applications

Job Name _____

Contractor _____

Job Location _____

Approval _____

Engineer _____

Contractor's P.O. No. _____

Approval _____

Representative _____

LEAD FREE*

Series LF26A, LF263A
Small Pressure Regulators

Sizes: LF26A: 1/8" – 1/2"
 LF263A: 1/4" – 1/2"

Series LF26A, LF263A Small Pressure Regulators are general purpose pressure regulators for water service. The LF26A, LF263A features Lead Free* construction to comply with Lead Free* installation requirements. These regulators are ideal for use in beverage dispensers, ice cube machines and other similar applications. Lead Free* small pressure regulators shall comply with state codes and standards, where applicable, requiring reduced lead content.

Features

- Rugged forged Lead Free* Brass body
- Tee handle adjustment
- Oversized orifice

Models

- LF26A 2-way regulator
- LF263A 3-way regulator

Materials

- Body: Lead Free* Brass
- Spring Cage: Aluminum
- Disc: Buna-N stainless steel
- Diaphragm: Reinforced Buna-N

Pressure – Temperature

Temperature Range: 0°F – 140°F (-18°C – 60°C)
 Maximum Working Pressure: 300psi (21 bar)
 Reduced Pressure Range:

SUFFIX	RANGE		STD. SET AT	
	psi	bar	psi	bar
A	1 – 25	0.1 – 1.7	10	0.7
B	3 – 50	0.2 – 3.4	15	1.0
C	10 – 125	0.7 – 8.6	25	1.7
D	50 – 175	3.4 – 12.1	50	3.4

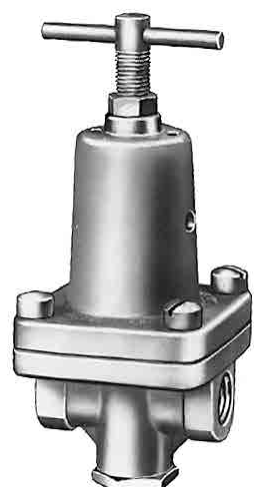

LF26A
2-Way



LF263A
3-Way

Options

- G Pressure gauge
- SS All stainless steel construction
- X Slotted adjusting screw

NOTICE

The information contained herein is not intended to replace the full product installation and safety information available or the experience of a trained product installer. You are required to thoroughly read all installation instructions and product safety information before beginning the installation of this product.

NOTICE

Inquire with governing authorities for local installation requirements

*The wetted surface of this product contacted by consumable water contains less than 0.25% of lead by weight.

Watts product specifications in U.S. customary units and metric are approximate and are provided for reference only. For precise measurements, please contact Watts Technical Service. Watts reserves the right to change or modify product design, construction, specifications, or materials without prior notice and without incurring any obligation to make such changes and modifications on Watts products previously or subsequently sold.



Capacity

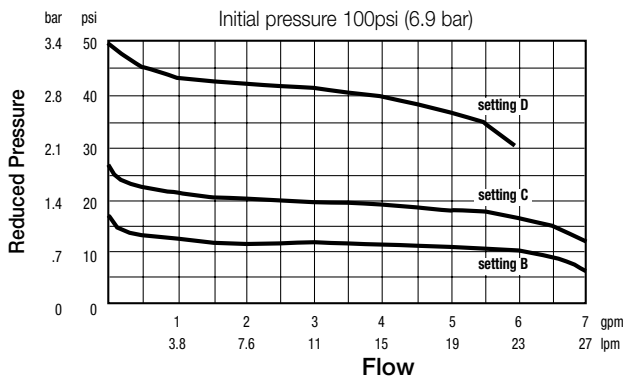

Approvals



Certified to
NSF/ANSI 61-G

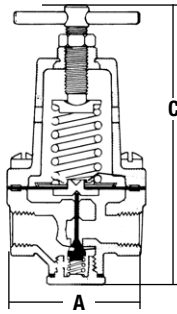

Dimensions – Weights

MODEL	SIZE	DIMENSIONS				WEIGHT	
		A		C		lbs.	kgs
	in.	in.	mm	in.	mm		
LF26A	1/8	2 1/8	54	4 3/8	111	1	.45
LF26A/LF263A	1/4	2 1/8	54	4 3/8	111	1	.45
LF26A/LF263A	3/8	2 1/8	54	4 3/8	111	1	.45
LF26A/LF263A	1/2	2 1/8	54	4 3/8	111	1	.45



USA: T: (978) 689-6066 • F: (978) 975-8350 • Watts.com
 Canada: T: (905) 332-4090 • F: (905) 332-7068 • Watts.ca
 Latin America: T: (62) 81-1001-8600 • Watts.com