

## Tech Data

# Viega ProPress® 316 Ball Valve Model 4075



### Description

The ProPress 316 ball valve can be used in a variety of commercial and industrial applications. The EPDM sealing elements make it the perfect choice for potable water systems, while the durable 316 stainless steel allows it to stand up to some of the harshest environments found in power plants, refineries, utilities, and mills. The double EPDM stem seals prevent leaks without the need for constant adjustment. The 316 stainless steel ball valves are available in sizes ranging from ½" to 2" and are equipped with Viega's unique Smart Connect® technology for easy identification of unpressed connections during pressure testing.

### Features

- Smart Connect® ProPress press ends
- EPDM sealing elements
- 316 stainless steel ball and stem
- Full-port design
- Blowout-proof stainless steel stem
- Reinforced PTFE seats
- Lockable, 316 stainless steel handle

### Ratings

- 250 CWP
- Temperature range: 0°F to 250°F
- Max. operating pressure: 250 psi

### Viega ProPress 316 Ball Valve - Model 4075

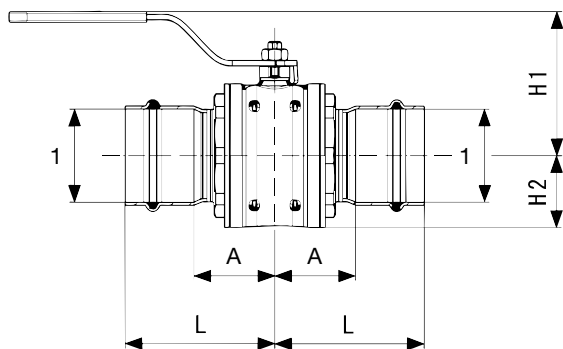

The ProPress 316 ball valve can be used in a variety of commercial and industrial applications. The EPDM sealing elements make it the perfect choice for potable



This document is subject to updates. For the most current Viega technical literature please visit [www.viega.us](http://www.viega.us).



Viega products are designed to be installed by licensed and trained plumbing and mechanical professionals who are familiar with Viega products and their installation. **Installation by non-professionals may void Viega LLC's warranty.**

### Approvals

- Conforms to MSS SP-110
- ASME A112.4.14/CSA B125.14
- IAPMO/ANSI Z1157
- NSF®-61-372
- NSF®-U.P. Code

Component	Material
Body	316 stainless steel
Ball	316 stainless steel
Seat	Reinforced PTFE
Stem	316 stainless steel
Stem seals	EPDM
Nut	Stainless Steel
Handle	316 Stainless Steel
Handle cover	Polyvinyl
Sealing element	EPDM

Part No.	Size (in)	A (in)	L (in)	H1 (in)	H2 (in)	Cv (US gal/min)
	1					
81081	½	1.10	1.85	2.01	0.59	10.4
81086	¾	1.22	2.13	2.09	0.71	23.6
81096	1	1.38	2.68	2.48	0.87	46.2
81097	1¼	1.46	2.48	2.68	1.14	96.2
81106	1½	1.61	3.03	3.03	1.38	143
81107	2	1.85	3.46	3.31	1.65	252

**V Viega LLC**  
585 Interlocken Blvd.  
Broomfield, CO 80021

Phone (800) 976-9819  
[www.viega.us](http://www.viega.us)

TD-PP 1224 316 Ball Valve 4075

