

# Split Phase Evaporative Cooler

## 6.3" Diameter, Open Dripproof

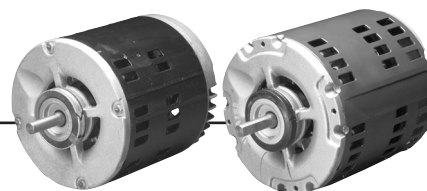

### APPLICATIONS:

To meet manufacturer's requirements for evaporative cooling units.

### FEATURES:

- Ball Bearings
- Class F Insulation
- CW Rotation Shaft End
- Zinc-Phosphate Stator Studs and Nuts
- Corrosion Resistant Rotor Core and Actuator Assembly
- Industry Standard Hub To Hub Dimension
- Automatic Reset Thermal Overload Protector
- **Discount Symbol: DS-3HAC**

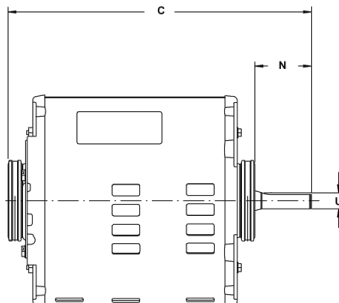

### Single Speed

HP	RPM	Voltage	Catalog Number	List	Bearings	NEMA <sup>†</sup> Frame	Amps	Shaft N	Shaft U	Protector	Total C	SF	Ship Wt. (lbs)	Notes
1/3	1725	115	6764	\$164	Ball	56Z	5.6	1.6	0.500	Auto	9.4	1.00	14	
1/2	1725	115	7095	\$180	Ball	56Y	8.4	1.6	0.500	Auto	9.4	1.00	17	89
	1725	115	6768	\$155	Ball	56Z	8.2	1.6	0.500	Auto	9.4	1.00	15	
	1725	230	6766	\$200	Ball	56Y	4.8	1.6	0.500	Auto	9.4	1.00	19	
3/4	1725	115	7096	\$201	Ball	56Y	11.7	1.6	0.500	Auto	9.4	1.00	19	89
	1725	115	6769	\$185	Ball	56Z	10.5	1.6	0.500	Auto	9.4	1.00	18	
	1725	230	6771	\$241	Ball	56Y	5.4	1.6	0.500	Auto	9.4	1.00	20	

### Two Speed

HP	RPM	Voltage	Catalog Number	List	Bearings	NEMA <sup>†</sup> Frame	Amps	Shaft N	Shaft U	Protector	Total C	SF	Ship Wt. (lbs)	Notes
1/3	1725/1140	115	7097	\$192	Ball	56Z	6.6	1.6	0.500	Auto	9.4	1.00	17	89
	1725/1140	115	6767	\$160	Ball	56Z	5.5/3.9	1.6	0.500	Auto	9.4	1.00	17	
1/2	1725/1140	115	6765	\$167	Ball	56YZ	7.5/4.0	1.6	0.500	Auto	9.4	1.00	16	
	1725/1140	115	7098	\$200	Ball	56Z	8.2	1.6	0.500	Auto	9.4	1.00	19	89
	1725/1140	230	6795	\$209	Ball	56Z	4.5	1.6	0.500	Auto	9.4	1.00	19	
3/4	1725/1140	115	7099	\$231	Ball	56Z	10.9	1.6	0.500	Auto	9.4	1.00	19	89
	1725/1140	230	6796	\$268	Ball	56Y	5.5	1.6	0.500	Auto	9.4	1.00	19	
1	1725/1140	115	2574	\$360	Ball	56	12.4/6.1	1.9	0.625	Auto	11.8	1.00	35	35,60,89,H39
	1725/1140	230	2423	\$359	Ball	56	7.0/3.7	1.9	0.625	Auto	11.8	1.00	34	35,60,89,H39

NOTE: For Hub Mounting, Order Kit Number 51 and 52. See Pages 188-189.

- Note 35 Includes Resilient Base
- Note 60 Capacitor Start
- Note 89 All Copper Wound
- Note H39 Reversible Rotation By Easy Reconnection

† All marks shown within this document are properties of their respective owners.

