



Established 1958

Float & Thermostatic Steam Traps Series TA-FT

Operation

Tunstall Corporation produces a full line of Float & Thermostatic Steam Traps containing a float valve mechanism which modulates to discharge condensate continuously, while non-condensable gases are released by a separate internal balanced pressure thermostatic air vent (The Tunstall Capsule®).

The “H” pattern body on all ¾”, 1” (15, 30, 75 & 125 psig) and 1-1/4” (15 & 30 psig) has been designed to offer maximum installation flexibility.

For larger sizes 1-1/2”, 2” (15, 30, 75 & 125 psig) and 1-1/4” (75 & 125 psig), the inlet and outlet taps are located in the cover. This design allows for higher capacities and direct retrofits for older piping systems. All Tunstall float and thermostatic traps can be serviced without disturbing system piping.

Features

- Variety of piping connections.
- Stainless steel balanced pressure thermostatic air vent (Tunstall Capsule®).
- All stainless steel internal components
- Wide selection ¾”-2” @ 15, 30, 75 & 125 psig differential pressures.
- Designed to withstand water hammer & high load demands.
- Designed for In-line repair.

Construction

Tunstall float and thermostatic traps feature all stainless steel interiors, heavy duty trap housings, easy access to internal parts and convenient piping connections.



Float & Thermostatic Traps

Materials of Construction	
Body & Cover	Cast Iron-ASTMA 126CI B
Valve Head	Stainless Steel
Valve Seat	Stainless Steel
Valve Seat Gasket	Non-Asbestos
Float	Stainless Steel
Bracket & Lever Assembly	Stainless Steel
Thermostatic Air Vent	Tunstall Capsule® Stainless Steel
Cover Bolts	Carbon Steel Grade 5
Cover Gasket	Non-Asbestos
Draining Plug	Stainless Steel



Tunstall Corporation
118 Exchange Street · Chicopee, MA 01013

Phone (413) 594-8695 · Fax (413) 598-8109
www.maconbalancing.com

© June 2016

We reserve the right to alter designs, specifications and information without notice.

Bulletin-TA-Series-TA-FT-0814.2
Float & Thermostatic Traps

Float & Thermostatic Steam Traps - Series TA-FT

Engineering Specifications

Capacities			Differential Pressure (PSI)														
lbs. Condensate per hour			1/4	1/2	1	2	5	10	15	20	25	30	40	50	75	100	125
Model	Size NPT	PSIG Orifice															
TA-FT3-15	3/4"	.218	279	369	489	650	785	1000	1075								
TA-FT4-15	1"	.218	279	369	489	650	785	1000	1075								
TA-FT5-15	1-1/4"	.312	600	770	980	1240	1640	2000	2340								
TA-FT6-15	1-1/2"	.500	1100	1700	2400	3300	5000	6600	7600								
TA-FT8-15	2"	.625	2300	2800	3600	4650	6900	9000	10900								
TA-FT3-30	3/4"	.218	279	369	489	650	785	1000	1075	1210	1300	1370					
TA-FT4-30	1"	.218	279	369	489	650	785	1000	1075	1210	1300	1370					
TA-FT5-30	1-1/4"	.228	375	500	690	910	1200	1500	1680	1800	1900	2000					
TA-FT6-30	1-1/2"	.390	1000	1300	1700	2300	3400	4600	5500	6000	6600	7000					
TA-FT8-30	2"	.500	1300	1800	2500	3400	5200	6800	7800	8600	9300	10000					
TA-FT3-75	3/4"	.166	160	213	280	365	520	700	795	875	930	970	1120	1230	1450		
TA-FT4-75	1"	.166	160	213	280	365	520	700	795	875	930	970	1120	1230	1450		
TA-FT5-75	1-1/4"	.312	550	725	960	1300	1900	2650	3050	3400	3700	4000	4400	4750	5400		
TA-FT6-75	1-1/2"	.312	550	725	960	1300	1900	2650	3050	3400	3700	4000	4400	4750	5400		
TA-FT8-75	2"	.421	850	1100	1500	2000	3100	4150	4750	5200	5500	5800	6400	6800	7700		
TA-FT3-125	3/4"	.125	100	135	175	230	330	415	500	585	620	685	750	830	970	1110	1190
TA-FT4-125	1"	.125	100	135	175	230	330	415	500	585	620	685	750	830	970	1110	1190
TA-FT5-125	1-1/4"	.246	400	520	680	890	1300	1700	2050	2300	2500	2700	3000	3200	3800	4200	4500
TA-FT6-125	1-1/2"	.246	400	520	680	890	1300	1700	2050	2300	2500	2700	3000	3200	3800	4200	4500
TA-FT8-125	2"	.332	550	675	880	1225	1950	2600	3000	3250	3500	3800	4200	4600	5500	6100	6600

Float & Thermostatic Traps

All 3/4", 1" TA-FT
1-1/4" TA-FT-15, TA-FT-30

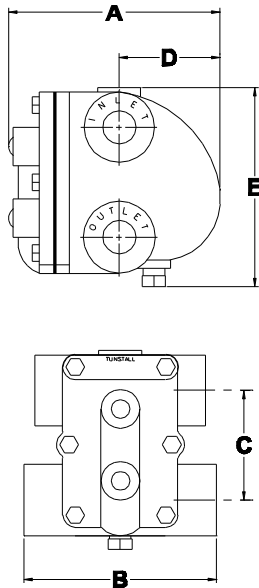

All 1-1/4", 1-1/2" TA-FT
2" TA-FT-75 & TA-FT-125

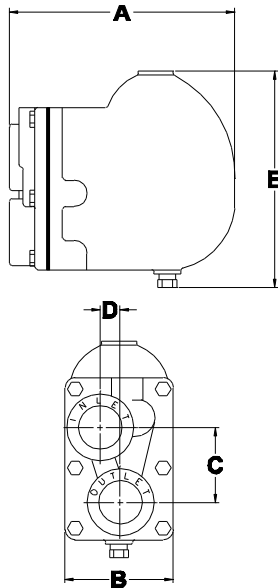

Model	Size	DIMENSIONS (Inches)					Weight (lbs.)	Repair Kit
		A	B	C	D	E		
TA-FT3-15	3/4"	6.25	5.50	3.31	3.00	5.75	9	TA-1FP-TA-15
TA-FT4-15	1"	6.25	5.50	3.31	3.00	5.75	9	TA-2FP-TA-15
TA-FT5-15	1-1/4"	6.25	5.75	3.00	3.81	5.75	9.5	TA-3FP-TA-15
TA-FT6-15	1-1/2"	8.50	4.25	3.00	0.70	8.40	18	TA-4RK-TA-15
TA-FT8-15	2"	9.81	4.94	4.94	0.12	9.12	26	TA-5RK-TA-15
TA-FT3-30	3/4"	6.25	5.50	3.31	3.00	5.75	9	TA-1FP-TA-30
TA-FT4-30	1"	6.25	5.50	3.31	3.00	5.75	9	TA-2FP-TA-30
TA-FT5-30	1-1/4"	6.25	5.75	3.00	3.81	5.75	9.5	TA-3FP-TA-30
TA-FT6-30	1-1/2"	8.50	4.25	3.00	0.70	8.40	18	TA-4RK-TA-30
TA-FT8-30	2"	9.81	4.94	4.94	0.12	9.12	26	TA-5RK-TA-30
TA-FT3-75	3/4"	6.25	5.50	3.31	3.00	5.75	9	TA-1FP-TA-75
TA-FT4-75	1"	6.25	5.50	3.31	3.00	5.75	9	TA-2FP-TA-75
TA-FT5-75	1-1/4"	8.50	4.25	3.00	0.70	8.40	18	TA-3RK-TA-75
TA-FT6-75	1-1/2"	8.50	4.25	3.00	0.70	8.40	18	TA-4RK-TA-75
TA-FT8-75	2"	9.81	4.94	4.94	0.12	9.12	26	TA-5RK-TA-75
TA-FT3-125	3/4"	6.25	5.50	3.31	3.00	5.75	9	TA-1FP-TA-125
TA-FT4-125	1"	6.25	5.50	3.31	3.00	5.75	9	TA-2FP-TA-125
TA-FT5-125	1-1/4"	8.50	4.25	3.00	0.70	8.40	18	TA-3RK-TA-125
TA-FT6-125	1-1/2"	8.50	4.25	3.00	0.70	8.40	18	TA-4RK-TA-125
TA-FT8-125	2"	9.81	4.94	4.94	0.12	9.12	26	TA-5RK-TA-125



Tunstall Corporation
118 Exchange Street · Chicopee, MA 01013

Phone (413) 594-8695 · Fax (413) 598-8109
www.maconbalancing.com

© June 2016

We reserve the right to alter designs, specifications and information without notice.

Bulletin-TA-Series-TA-FT-0814.2

Float & Thermostatic Traps