

### **Faster, Tool Free Finish.**

Hand finish, so no more finish installations on your back, in cramped spaces.

### **Repairable Valve.**

Now, at last, the finish valve is easily repairable.

### **Advances Quality.**

No more mud and paint on your stub out, preventing a quality finish valve installation.

### **Reduces Labor.**

Less labor at the rough and at the finish.

### **Reduces Material Waste.**

No more cutting off a plug and wasting material and labor.

### **Looks Professional.**

No more mud and paint on your finish installation.

### **Lead Free.**

Hubz Receivers and supply stops are made of high-quality, no lead nickel-plated brass.



# What is Hubz?

## Durability & Protection

The Hubz connection is actually three parts – the inner brass connection with o-rings, receiver, and outer black poly nut. The o-rings compress to the I.D. of the Receiver, and the nut screws onto the receiver threads.

This has two huge benefits. First, the o-rings are always protected: in transit and on the shelf they are protected by the poly nut, and after installation they are protected by the Receiver. Second, this strong connection is less likely to leak and requires no pipe dope or thread sealing tape.

Compare this to push and compression fittings. Since they compress to the O.D. of the pipe, they are less secure than Hubz and can mar the surface of the tube. They also require tools to remove – a Hubz connection is tool-free!

## Easy to Use

Hubz Receivers are available to connect to nearly any plumbing system, including sweat, PEX and CPVC. And once your receiver is installed, adding any Hubz fitting takes just seconds and requires no tools.

Hubz Receivers come with a test cap, to protect the threads from other trades and for water tests at rough. You'll never have to clean paint or mud off your finish install again.

Replacement is just as easy, since all the connections are hand-tight. Simply remove the current fitting and replace it with a new one.

## Professional Finish

Hubz supply stop ball valves are nickel-plated for a professional finish, and receivers are also nickel-plated so there's no ugly copper, PEX or CPVC to hide. Chromed escutcheons are also available for the highest quality, most aesthetically pleasing finish installation.

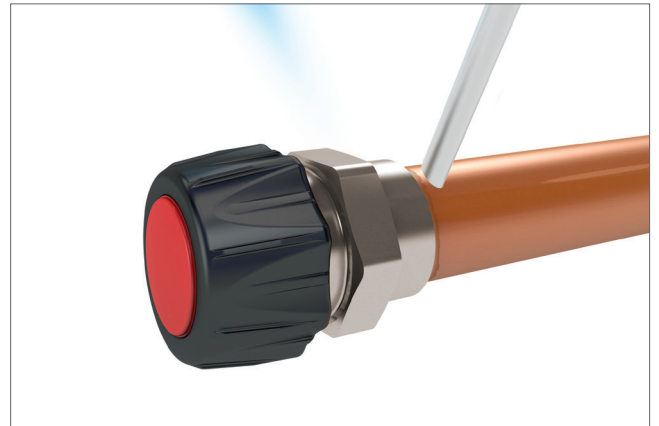

## Modular

The fundamental nature of Hubz is modular, enabling you to easily configure any installation to meet your needs on the job site. If you commonly work with multiple rough plumbing systems, Hubz is a game changer.

Hubz test caps attach to the same receiver as your fitting or finish part – protecting the receiver and saving you time. Just unscrew the test cap and screw on your fitting.

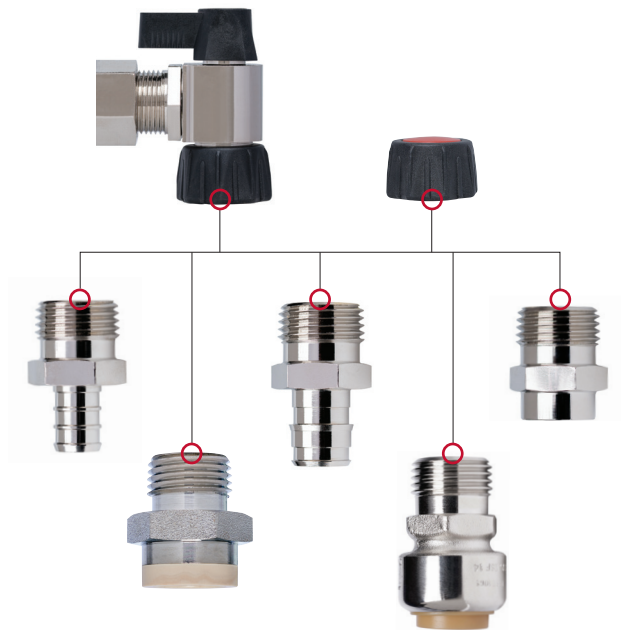

## The Hubz Line

Hubz is a revolutionary modular plumbing connection system from Tribal, providing time and cost savings to the plumber and ease of stocking and distribution to the wholesaler.

Hubz receivers are available to connect to nearly any plumbing system, and any Hubz part can connect to the receiver in seconds. So you can stock fewer parts and save time on installs, which saves you money.



## Features & Benefits

### Pain Free/Tool Free Finish

With Hubz, there's no need to lie on your back with a wrench or torch at a finish installation. Simply remove the test cap and screw on your Hubz valve – no pain, no mess, no tools.

Replacement is just as easy, since the Hubz connection is hand-tight and uses no pipe dope or thread tape, just remove the old valve and replace with a new one.

No tools means you save time – about 30 minutes per install. And saving time means you save money.



### Reduces Labor & Material Waste

In a standard installation, a test nut and cap is installed on the rough line until finish, and must be cut off before a valve can be installed wasting your time and materials.

With Hubz, the test nut and cap screws onto the Hubz Receiver with no special tool allowing you to test and protect the receiver threads from damage by other trades. At finish, simply unscrew the test nut and cap, dispose, then screw on your valve.



### Advances Quality. Aesthetically Pleasing.

Hubz supply stop ball valves are nickel-plated for a professional finish, and receivers are also nickel-plated so there's no ugly copper, PEX or CPVC to hide.







**1/4-Turn Handle**  
Provides a clean finish  
and is easy to use

**Multiple outlet options**  
1/4", 3/8" and 1/2"  
compression available



**Finish Options**  
Fully nickel-plated supply  
stops are also available

**Professional Finish**  
Nickel-plated no lead brass is  
durable and attractive

**Hubz Receiver**  
Receiver is nickel-plated, so all  
parts of the installation have an  
aesthetically pleasing finish

**Patented Hubz Connection**  
Rubber o-ring provides a  
leak proof seal and is an easy,  
firm connection

**Test Nut and Cap**  
Attaches to the same receiver as the  
valve – just unscrew and add the valve

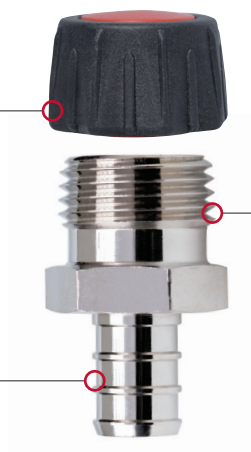

**Receiver Threads**  
Receiver threads will also accept  
standard FIP valves

**Receiver Connections**  
Available as sweat, F1807,  
F1960, push-fit or CPVC

## Problem/Solution

Most valves are not easily replaceable. In fact, it is quite the ordeal. Sweat valves, glue valves or crimped on PEX valves are very difficult to repair and replace. If there is a lack of pipe left after they are cut off, it is that much more of an issue. Push valves are not much better - as they need a special tool, scar the O.D. of the pipe and are an unsure long term seal (removing and replacing a compression valve can sometimes be a lot of work - in awkward positions and locations).



### HUBZ STRAIGHT

Hubz straight supply stops are available for all compression sizes.

### HUBZ ANGLE

Hubz angle supply stops are available for all compression sizes.



### PROBLEM

**PROBLEM: Painful Finish.** With the current method, an installer often must use a torch or a PEX tool while laying on his back, inside a cabinet or behind a fixture. This is not ideal.



### SOLUTION

**SOLUTION: No Pain.** With Hubz, you never have to lay on your back installing a valve at the finish with a tool, torch, glue or wrench. These awkward installations have been the pain of the plumber for ages. It's time for a change.



### PROBLEM

**PROBLEM: Messy Plumbing.** With the current method, a plumbing installer has to battle other trades – like the sheetrock and painter trades. Mud and paint often coat the stub out, making cleanup necessary before the finish valve is completed.

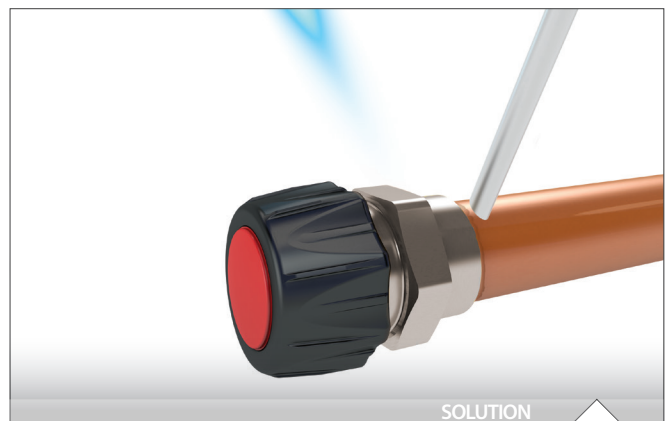

### SOLUTION

**SOLUTION: No Mess.** With Hubz, there is no mess. The test cap covers the threads and protects the Hubz receiver. This ensures a quality connection at the finish.



**SWEAT RECEIVER**  
For copper sweat connection.



**CPVC RECEIVER**  
For glue connection.



**PUSH-FIT RECEIVER**  
For PEX, copper or CPVC tube.



**ASTM F1807 RECEIVER**  
For PEX tube with copper crimp ring.



**ASTM F1960 RECEIVER**  
For PEX A tube with expansion sleeve.

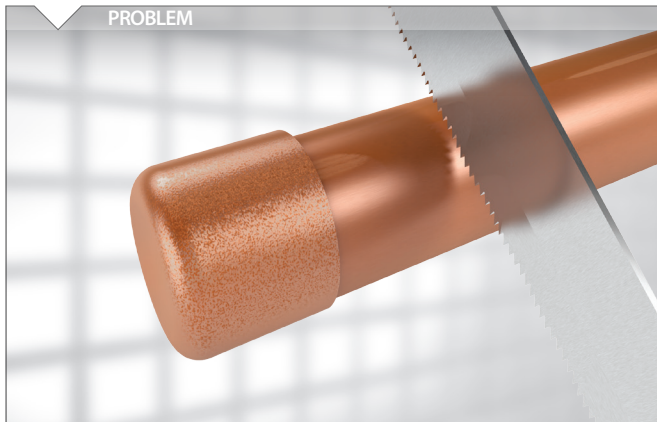

**PROBLEM: Wasted Labor & Material.** With many current methods, an installer must plug a pipe stub out and test it. After the test, and usually at the finish, the installer cuts off this plug and scraps both material and labor.



**SOLUTION: No Waste.** Hubz has no scrapped plug. Your test cap receiver is the Hubz valve receiver. This saves labor and material.



**PROBLEM: Quality Concerns.** Because messy plumbing and other more difficult installation methods in tenuous positions – under cabinets, for instance – the final installation can be more prone to leaks.



**SOLUTION: Easily Replaceable Valve.** Hubz is replaceable. It's as easy as it can get. You unscrew and swap out. No tools. No torch. No glue.

# Installation

## Installation Comparison: Common PEX Lavatory Installation

(Preformed copper stub outs with compression supply stops)

### Material Cost\*

Two PEX copper stub outs	\$8.70
Two PEX crimp rings	\$0.42
Two compression supply stops	\$7.80
Two escutcheons	\$1.20
Bracket	\$4.07
	<b>\$22.19</b>



\*Prices as of June 2017

VS.

## Installation Comparison: Hubz PEX Lavatory Installation

### Material Cost\*

Two PEX Receivers	\$2.30
Two PEX crimp rings	\$0.42
Two Hubz supply stops	\$6.84
Two escutcheons	\$1.20
Bracket	\$4.07
	<b>\$14.83</b>



**Over \$7**  
**MATERIAL SAVINGS**  
PER INSTALLATION

**74%**  
INSTALLATION  
**TIME SAVINGS**

\*Prices as of June 2017



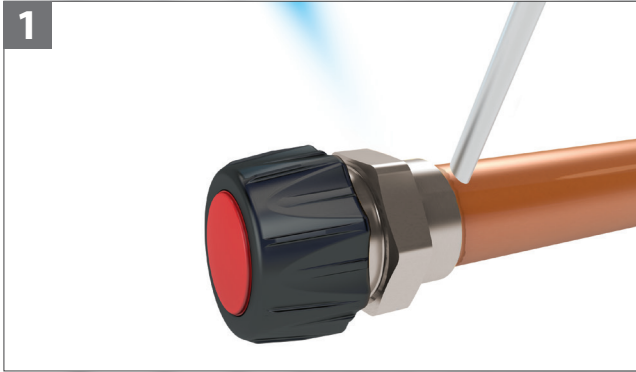

### Step One. Install Rough Receiver.

- At rough install you receive the test cap.
- Follow normal installation steps for the system you chose for your receiver
  - Note: if making sweat connection, remove test cap before soldering. Replace test cap after solder has cooled, to protect threads during remaining rough jobs



### Step Two. Install Finish Valve.

- Remove cap, install valve, take a break!
- Simply screw the valve to the receiver
  - Place the test cap on the valve to test the water connection
  - Attach the hose to the Hubz Valve
  - Turn on the valve to supply water
  - Note: if a sweat connection was made, wait for solder to cool before installing finish valve

### CALCULATED TIME SAVINGS

NO. OF INSTALLS:	1	10	100	1,000	10,000	100,000
LAVATORY	34 mins \$42.50	over 5 hours over \$375	over 56 hours over \$4,200	over 566 hours over \$42,000	over 5,000 hours over \$375,000	over 50,000 hours over \$4 Million
TOILET	29 mins \$36.25	nearly 5 hours nearly \$375	over 48 hours over \$3,600	over 483 hours over \$36,000	over 4,800 hours over \$360,000	over 48,300 hours over \$3 Million
DISHWASHER	29 mins \$36.25	nearly 5 hours nearly \$375	over 48 hours over \$3,600	over 483 hours over \$36,000	over 4,800 hours over \$360,000	over 48,300 hours over \$3 Million
ICE MAKER	29 mins \$36.25	nearly 5 hours nearly \$375	over 48 hours over \$3,600	over 483 hours over \$36,000	over 4,800 hours over \$360,000	over 48,300 hours over \$3 Million

Dollar amounts based on \$75/hour

### Contact Tribal

To order or for more information, contact Tribal Manufacturing:  
1.269.781.3901  
www.tribalmfg.com

### Coming Soon

More Hubz products are being developed and will be available soon. Keep your eyes out for manifolds, fittings, water heater connectors and more.



HSPX104



HSPX204



HSFWT04



HSCPVC04



HBZR011PF

## NICKEL-PLATED RECEIVER

ITEM NO.	DESCRIPTION	MIN QTY.	CASE QTY.
HSPX104	1/2" Hubz Receiver x 1/2" ASTM F1807 PEX	10	100
HSPX204	1/2" Hubz Receiver x 1/2" ASTM F1960 PEX	10	100
HSFWT04	1/2" Hubz Receiver x 1/2" FSWT	10	100
HSCPVC04	1/2" Hubz Receiver x 1/2" CPVC (Overmold)	10	100
HBZR011PF	1/2" Hubz Receiver x 1/2" Push-Fit	10	100



HVCMP02



HVCMP03



HVCMP04

## SUPPLY STOP BALL VALVE – STRAIGHT

ITEM NO.	DESCRIPTION	MIN QTY.	CASE QTY.
HVCMP02	1/2" Hubz x 1/4" Compression	10	100
HVCMP03	1/2" Hubz x 3/8" Compression	10	100
HVCMP04	1/2" Hubz x 1/2" Compression	10	100



HAVCMP02



HAVCMP03



HAVCMP04

## SUPPLY STOP BALL VALVE – ANGLE

ITEM NO.	DESCRIPTION	MIN QTY.	CASE QTY.
HAVCMP02	1/2" Hubz x 1/4" Compression	10	100
HAVCMP03	1/2" Hubz x 3/8" Compression	10	100
HAVCMP04	1/2" Hubz x 1/2" Compression	10	100



HVCMP02



HVCMP03



HVCMP04-1

### FULLY NICKEL-PLATED SUPPLY STOP BALL VALVE – STRAIGHT

ITEM NO.	DESCRIPTION	MIN QTY.	CASE QTY.
HVCMP02-1	1/2" Hubz x 1/4" Compression	10	100
HVCMP03-1	1/2" Hubz x 3/8" Compression	10	100
HVCMP04-1	1/2" Hubz x 1/2" Compression	10	100



HAVCMP02



HAVCMP03



HAVCMP04

### FULLY NICKEL-PLATED SUPPLY STOP BALL VALVE – ANGLE

ITEM NO.	DESCRIPTION	MIN QTY.	CASE QTY.
HAVCMP02-1	1/2" Hubz x 1/4" Compression	10	100
HAVCMP03-1	1/2" Hubz x 3/8" Compression	10	100
HAVCMP04-1	1/2" Hubz x 1/2" Compression	10	100



## SUPPLY STOP KITS

ITEM NO.	SYSTEM	KIT TYPE	VALVE	MIN QTY.	CASE QTY.
HKT.1AC02X04	F1807	Ice Maker	1/4" Comp. – Angled	1	10
HKT.1AC03X04	F1807	Toilet/Dishwasher	3/8" Comp. – Angled	1	10
HKT.2AC03X04	F1807	Lavatory	2x 3/8" Comp. – Angled	1	10
HKT.1AC04X04	F1807	High Volume	1/2" Comp. – Angled	1	10
HKT.1SC02X04	F1807	Ice Maker	1/4" Comp. – Straight	1	10
HKT.1SC03X04	F1807	Toilet/Dishwasher	3/8" Comp. – Straight	1	10
HKT.2SC03X04	F1807	Lavatory	2x 3/8" Comp. – Straight	1	10
HKT.1SC04X04	F1807	High Volume	1/2" Comp. – Straight	1	10
HKT.1AC02W04	F1960	Ice Maker	1/4" Comp. – Angled	1	10
HKT.1AC03W04	F1960	Toilet/Dishwasher	3/8" Comp. – Angled	1	10
HKT.2AC03W04	F1960	Lavatory	2x 3/8" Comp. – Angled	1	10
HKT.1AC04W04	F1960	High Volume	1/2" Comp. – Angled	1	10
HKT.1SC02W04	F1960	Ice Maker	1/4" Comp. – Straight	1	10
HKT.1SC03W04	F1960	Toilet/Dishwasher	3/8" Comp. – Straight	1	10
HKT.2SC03W04	F1960	Lavatory	2x 3/8" Comp. – Straight	1	10
HKT.1SC04W04	F1960	High Volume	1/2" Comp. – Straight	1	10
HKT.1AC02F04	Female Sweat	Ice Maker	1/4" Comp. – Angled	1	10
HKT.1AC03F04	Female Sweat	Toilet/Dishwasher	3/8" Comp. – Angled	1	10
HKT.2AC03F04	Female Sweat	Lavatory	2x 3/8" Comp. – Angled	1	10
HKT.1AC04F04	Female Sweat	High Volume	1/2" Comp. – Angled	1	10
HKT.1SC02F04	Female Sweat	Ice Maker	1/4" Comp. – Straight	1	10
HKT.1SC03F04	Female Sweat	Toilet/Dishwasher	3/8" Comp. – Straight	1	10
HKT.2SC03F04	Female Sweat	Lavatory	2x 3/8" Comp. – Straight	1	10
HKT.1SC04F04	Female Sweat	High Volume	1/2" Comp. – Straight	1	10
HKT.1AC02C04	CPVC	Ice Maker	1/4" Comp. – Angled	1	10
HKT.1AC03C04	CPVC	Toilet/Dishwasher	3/8" Comp. – Angled	1	10
HKT.2AC03C04	CPVC	Lavatory	2x 3/8" Comp. – Angled	1	10
HKT.1AC04C04	CPVC	High Volume	1/2" Comp. – Angled	1	10
HKT.1SC02C04	CPVC	Ice Maker	1/4" Comp. – Straight	1	10
HKT.1SC03C04	CPVC	Toilet/Dishwasher	3/8" Comp. – Straight	1	10
HKT.2SC03C04	CPVC	Lavatory	2x 3/8" Comp. – Straight	1	10
HKT.1SC04C04	CPVC	High Volume	1/2" Comp. – Straight	1	10

## WHAT COMES IN A KIT?

### Ice Maker Kits

1 receiver for your chosen system  
 1 straight or angled 1/4" compression Hubz supply stop  
 1 expandable escutcheon

### Lavatory Kits

2 receivers for your chosen system  
 2 straight or angled 3/8" compression Hubz supply stops  
 2 expandable escutcheons

### Toilet/Dishwasher Kits

1 receiver for your chosen system  
 1 straight or angled 3/8" compression Hubz supply stop  
 1 expandable escutcheon

### High Volume Kits (for commercial applications)

1 receiver in your chosen system  
 1 straight or angled 1/2" compression Hubz supply stop  
 1 expandable escutcheon





## FULLY NICKEL-PLATED SUPPLY STOP KITS

ITEM NO.	SYSTEM	KIT TYPE	VALVE	MIN QTY.	CASE QTY.
HKT.1AC02X04.1	F1807	Ice Maker	1/4" Comp. – Angled	1	10
HKT.1AC03X04.1	F1807	Toilet/Dishwasher	3/8" Comp. – Angled	1	10
HKT.2AC03X04.1	F1807	Lavatory	2x 3/8" Comp. – Angled	1	10
HKT.1AC04X04.1	F1807	High Volume	1/2" Comp. – Angled	1	10
HKT.1SC02X04.1	F1807	Ice Maker	1/4" Comp. – Straight	1	10
HKT.1SC03X04.1	F1807	Toilet/Dishwasher	3/8" Comp. – Straight	1	10
HKT.2SC03X04.1	F1807	Lavatory	2x 3/8" Comp. – Straight	1	10
HKT.1SC04X04.1	F1807	High Volume	1/2" Comp. – Straight	1	10
HKT.1AC02W04.1	F1960	Ice Maker	1/4" Comp. – Angled	1	10
HKT.1AC03W04.1	F1960	Toilet/Dishwasher	3/8" Comp. – Angled	1	10
HKT.2AC03W04.1	F1960	Lavatory	2x 3/8" Comp. – Angled	1	10
HKT.1AC04W04.1	F1960	High Volume	1/2" Comp. – Angled	1	10
HKT.1SC02W04.1	F1960	Ice Maker	1/4" Comp. – Straight	1	10
HKT.1SC03W04.1	F1960	Toilet/Dishwasher	3/8" Comp. – Straight	1	10
HKT.2SC03W04.1	F1960	Lavatory	2x 3/8" Comp. – Straight	1	10
HKT.1SC04W04.1	F1960	High Volume	1/2" Comp. – Straight	1	10
HKT.1AC02F04.1	Female Sweat	Ice Maker	1/4" Comp. – Angled	1	10
HKT.1AC03F04.1	Female Sweat	Toilet/Dishwasher	3/8" Comp. – Angled	1	10
HKT.2AC03F04.1	Female Sweat	Lavatory	2x 3/8" Comp. – Angled	1	10
HKT.1AC04F04.1	Female Sweat	High Volume	1/2" Comp. – Angled	1	10
HKT.1SC02F04.1	Female Sweat	Ice Maker	1/4" Comp. – Straight	1	10
HKT.1SC03F04.1	Female Sweat	Toilet/Dishwasher	3/8" Comp. – Straight	1	10
HKT.2SC03F04.1	Female Sweat	Lavatory	2x 3/8" Comp. – Straight	1	10
HKT.1SC04F04.1	Female Sweat	High Volume	1/2" Comp. – Straight	1	10
HKT.1AC02C04.1	CPVC	Ice Maker	1/4" Comp. – Angled	1	10
HKT.1AC03C04.1	CPVC	Toilet/Dishwasher	3/8" Comp. – Angled	1	10
HKT.2AC03C04.1	CPVC	Lavatory	2x 3/8" Comp. – Angled	1	10
HKT.1AC04C04.1	CPVC	High Volume	1/2" Comp. – Angled	1	10
HKT.1SC02C04.1	CPVC	Ice Maker	1/4" Comp. – Straight	1	10
HKT.1SC03C04.1	CPVC	Toilet/Dishwasher	3/8" Comp. – Straight	1	10
HKT.2SC03C04.1	CPVC	Lavatory	2x 3/8" Comp. – Straight	1	10
HKT.1SC04C04.1	CPVC	High Volume	1/2" Comp. – Straight	1	10

## WHAT COMES IN A KIT?

### Ice Maker Kits

1 receiver for your chosen system  
 1 straight or angled 1/4" compression Hubz supply stop  
 1 expandable escutcheon

### Lavatory Kits

2 receivers for your chosen system  
 2 straight or angled 3/8" compression Hubz supply stops  
 2 expandable escutcheons

### Toilet/Dishwasher Kits

1 receiver for your chosen system  
 1 straight or angled 3/8" compression Hubz supply stop  
 1 expandable escutcheon

### High Volume Kits (for commercial applications)

1 receiver in your chosen system  
 1 straight or angled 1/2" compression Hubz supply stop  
 1 expandable escutcheon



SE-2515-C



926-2



HNC

## ACCESSORIES

ITEM NO.	DESCRIPTION	MIN QTY.	CASE QTY.
SE-2515-C	Expandable Sleeve & Escutcheon, I.D. 1"*	10	100
SE-2515-C-1	Large Expandable Sleeve & Escutcheon, I.D. 1-1/4"***	10	100
E-ACT54-0	1/2" CTS Chrome-Plated ABS Split Escutcheon	10	100
E-SCT54-0	1/2" CTS Chrome-Plated Hinged Steel Escutcheon	10	100
HNC	Test – Black Nut & Red Cap	10	100
505371	1/2" F1807 PEX Copper Crimp Ring	50	500
505151	1/2" F1960 PEX Sleeve	50	500

\*For use with F1807 or FSWT Receiver

\*\*For use with F1960, push-fit or CPVC Receiver

Prices and availability are subject to change. Contact Tribal for the most up to date information.

# About Tribal

## About the Tribe

Tribal invents parts. We make parts. We market parts. But, Tribal is more than the sum of its parts. We are a tribe. And, we don't just fight for your business; we fight alongside you, to help you win new customers and grow your business. When you choose Tribal, you join our tribe, and we join yours.

## Who is the Tribe?

Tribal is a highly automated, quality-focused inventing, machining and manufacturing company with a remarkable infrastructure and equipment list. More importantly, Tribal is good people. In a time when most other companies like Tribal have shut their doors or moved their operations, Tribal stands resolute. We are proud to serve you as a quality manufacturer in the heart of Michigan and South Carolina, USA.



## Why join the Tribe?

Tribal understands that businesses are built on reputations, and they are not built overnight. To build your business, you first build your reputation. Your success was built one brick, one sale at a time. We understand that struggle and want to assist you with it, to help your business grow into the future. When you choose Tribal, you hire the tribe.



## What is the Tribe?

Tribal is one of the most efficient and capable machining operations in the world – giving us world class quality and world class pricing. We are fast and automated, due to our multi-generational industry experience and impressive fleet of equipment. We are also nimble and can master smaller orders, customized parts and fast turn-around times for new product and project development. We are cost efficient. We have low overhead to help control costs. Nevertheless, we still have an innovative development staff that allows us to add value to your organization with new ideas and value engineering.

## Why the name Tribal?

We like the idea of partnerships. It is in God's plan, we believe, that man is able to achieve more working together than he is alone. Whether it is through a family or a company or a country or a tribe, when we work together on a common cause, great things can happen ...and rather quickly too. This basic idea makes sense to us. It is what we want for those who work at Tribal. It is what we want for our customer relationships. We want great things to happen for you. And — we liked the name!



**Tribal Manufacturing, Inc.**    **450 Leggitt Road**    **Marshall, Michigan 49068**  
**P** 1-269-781-3901    **F** 1-269-781-1112    [www.tribalmfg.com](http://www.tribalmfg.com)

