

Double Basin

Simple Drain®

NO LEAKS. NO CLOGS. NO HASSLE.



**BEFORE YOU BEGIN...
REVIEW BASIC CONCEPTS ON
BACK COVER!**

SELECT YOUR LAYOUT

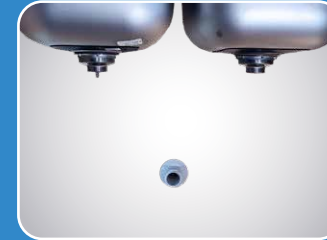

Standard P-trap
Page 1



S-TRAP
Page 2



P-trap with disposal
Pages 3-4



S-trap with disposal
Pages 5-6

Installation Guide

STOP REVIEW BASIC CONCEPTS ON BACK COVER BEFORE INSTALLING

DISHWASHER CONNECTION

A dishwasher can be added to any of these setups. Connect to disposal when possible. See back cover for connecting to Simple Drain® TEE.



PATENT PENDING
ADA 606.5 COMPLIANT

Confused? Don't be.
Watch our how-to videos!
www.simpledrain.com



WHAT'S IN THE KIT:

- 1 (2) Rubber tubes: Solid, antimicrobial, EPDM rubber. Compatible with all common household cleaners.
- 2 (1) TEE: Has three tube ports and one dishwasher port.
- 3 (1) Trap loop: Creates proper trap shape using included depth tab.
- 4 (3) Threaded fittings (6 half pieces): Connects tubes to 1.5" male thread.
- 5 (4) Hand-tighten clamps: Made from long-lasting stainless steel.
- 6 (1) Disinfecting clip: Allows for easy disinfection. Learn more at SimpleDrain.com





Standard P-trap Installation

Read the basic concepts on the back cover, then follow the instructions below to install your Simple Drain. The green and blue bubbles will guide your success.

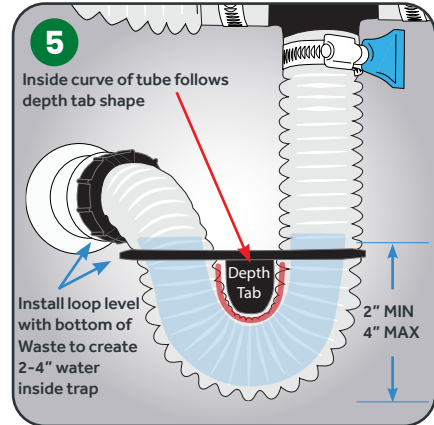
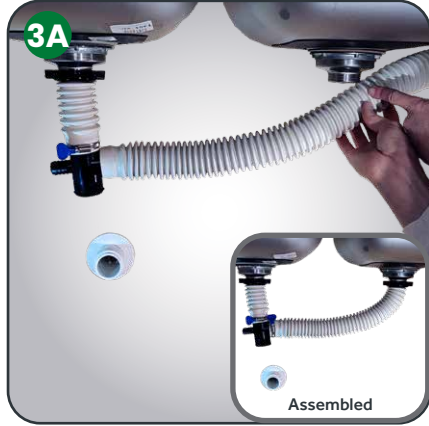
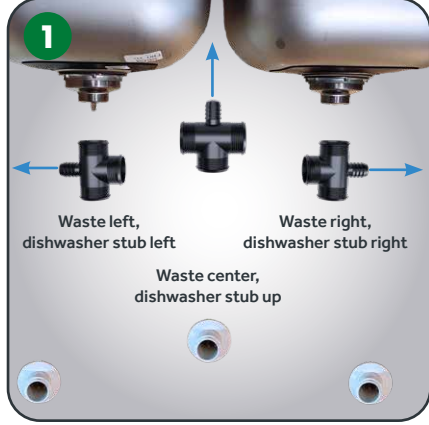

- ① Set aside one of the white rubber tubes and do not cut until STEP 8.
- ② Locate your waste pipe. The TEE will go under the sink drain closest to the waste. If generally centered, the TEE will be as well. ①
- ③ Trim hose to length. A
 - For left/right install, count 8 ribs from either end and trim. If you need to re-cut, 6 or 7 ribs will still work.
 - For a center install, count 20 ribs and trim.
- ④ Attach threaded fitting. B
- ⑤ Thread onto sink drain, then push TEE into the cuff and attach with clamp. See 2A for left/right install or 2B for center. 2A 2B C D
- ⑥ Using the tube *you already cut*, push the cuffed end over the TEE, measure over to the other side of the sink, and note which rib meets the drain. 3A or 3B
- ⑦ Remove tube from TEE, trim to length, attach threaded fitting, thread onto sink, and clamp to TEE. (See "Assembled" inset image)
- ⑧ FORM THE P-TRAP 4A 4B
 - Push the cuff of the uncut tube onto the TEE.
 - Push the loop into the valley of the tube so it is level with the bottom of the waste. 4A
 - Push the depth tab down on the loop. Bend the tube into a tight U shape making sure the inside curve follows the depth tab. 5
 - Turn tube toward waste for final measurement. Add a few ribs in case you need to re-cut. 4A 4B
 - Remove loop, pull tube off TEE, and then repeat STEPS 4 and 5.
- ⑨ Thread the tube onto the waste and reattach to bottom of TEE with hand-tighten clamp. Reapply the loop so that your trap is properly formed. 5
- ⑩ Ensure all connections are tight. Check for leaks and adjust as needed. Apply disinfecting clip to trap loop for future use.



Standard S-trap Installation

Read the basic concepts on the back cover, then follow the instructions below to install your Simple Drain. The green and blue bubbles will guide your success.

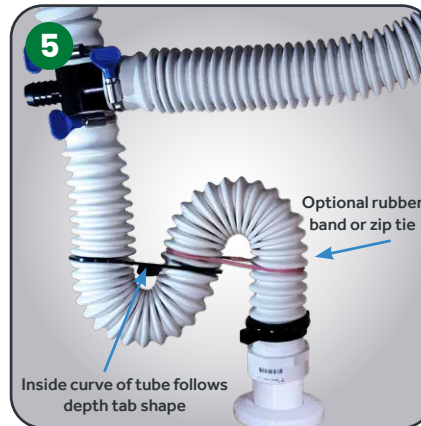
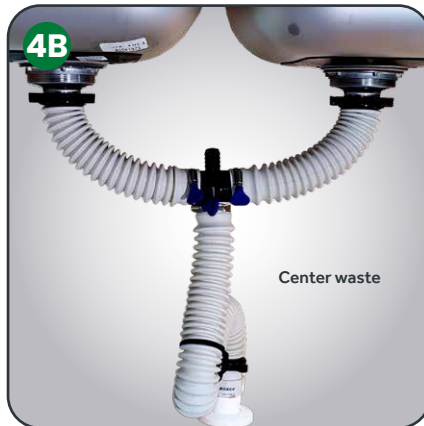
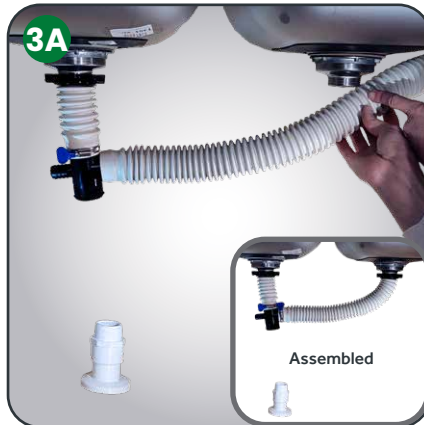

- ① Set aside one of the white rubber tubes and do not cut until STEP 8.
- ② Locate your waste pipe. The TEE will go under the sink drain closest to the waste. If generally centered, the TEE will be as well. ①
- ③ Trim hose to length. A
 - For left/right install, count 8 ribs from either end and trim. If you need to re-cut, 6 or 7 ribs will still work.
 - For a center install, count 20 ribs and trim.
- ④ Attach threaded fitting. B
- ⑤ Thread onto sink drain, then push TEE into the cuff and attach with clamp. See 2A for left/right install or 2B for center. 2A 2B C D
- ⑥ Using the tube **you already cut**, push the cuff end over the TEE and measure over to the other side of the sink and note which rib meets the drain. 3A or 3B
- ⑦ Remove tube from TEE, trim to length, attach threaded fitting, thread onto sink, and clamp to TEE. (See "Assembled" inset image)
- ⑧ FORMING THE S-TRAP 4A 4B

Hang the uncut tube from the TEE and form an "S" shape while holding the other end next to the waste to measure the length. Use the loop and depth tab to help make sure the trap portion of the "S" is correct. Helpful tips:

 - Try to keep the bottom of the trap above the top of the waste if possible.
 - Leave extra length when you cut because you may want make adjustments once installed.
 - Remove tube from TEE before you cut to length.
 - S-traps are never to code, but it is still important to form a proper trap using the loop and depth guide as shown.
- ⑨ Once satisfied with the trap shape, measure, cut, and attach the threaded fitting to the tube.
- ⑩ Thread tube to the waste. Attach tube to bottom of TEE with hand-tighten clamp and ensure all other connections are tight. Check for leaks and adjust as needed. Apply disinfecting clip to trap loop for future use. Optional rubber band or zip tie may help keep upper bend in place. 5

P-TRAP WITH DISPOSAL

This page is for waste lines located opposite the disposal.

PAGE 3
P-TRAP WITH WASTE
OPPOSITE DISPOSAL

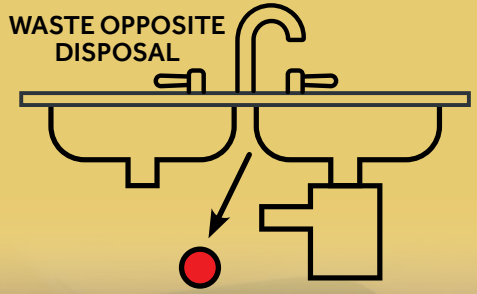

P-trap with disposal installation (waste OPPOSITE disposal)

Read the basic concepts section on the back cover, then follow the instructions below to install your double basin Simple Drain. The green and blue bubble will guide your success.

- 1 Locate waste and save one tube until STEP 8.
- 2 Point dishwasher stub on TEE away from disposal and align top of TEE side port to bottom of disposal outlet as shown by dashed blue line. **2A**
- 3 Push tube onto the TEE and hold in position below the drain. Mark the rib where it meets the sink drain, adding an extra rib or two in case you need to re-cut. Trim tube to length. **3A A**
- 4 Attach threaded fitting. **B**
- 5 Thread onto sink drain and then attach TEE with clamp. It should look something like the inset box **3A C D**
- 6 Using remaining portion of the first tube, push cuff onto the side of the TEE facing the disposal and measure over to the disposal outlet so that 4 ribs go over the outlet. If outlet is straight, run tube directly across and ensure tube slopes down to TEE. Remove tube from TEE and then cut to length. **4A**
- 7 Clamp cuffed end to TEE. For cut end, put clamp into first valley, push 4 ribs onto disposal outlet, and clamp tightly. **5A**
- 8 FORM THE P-TRAP
 - To form the trap, hang the uncut tube from the TEE and push loop into the valley of the tube where it is level with bottom of waste. **6**
- 9 Push the depth tab down on the loop. Bend the tube into a tight U shape making sure the inside curve follows the depth tab. **6**
 - Turn tube toward waste for final measurement. **7**
 - Remove from TEE and cut to length.
 - Install threaded fitting and thread to waste.
- 10 Clamp tube to bottom of TEE, reapply loop, and ensure all other connections are tight.
- 11 Check for leaks and adjust as needed.
- 12 Apply disinfecting clip to trap loop for future use.

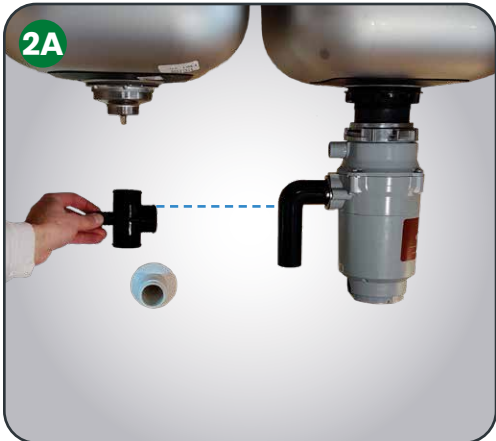

Confused? Don't be.
Watch our how-to videos!



FORMING

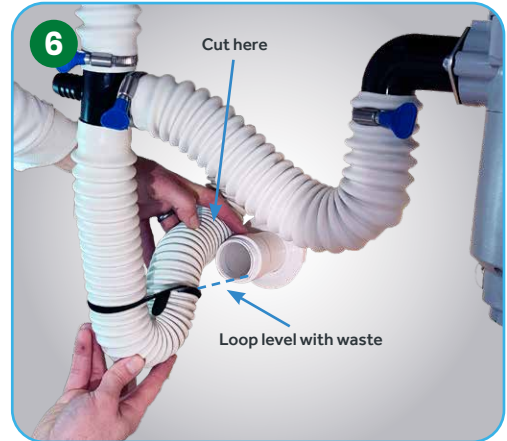
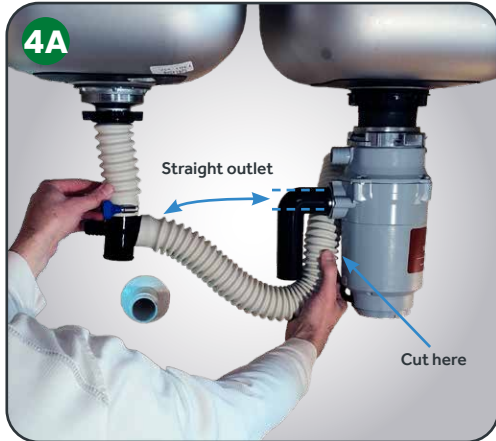
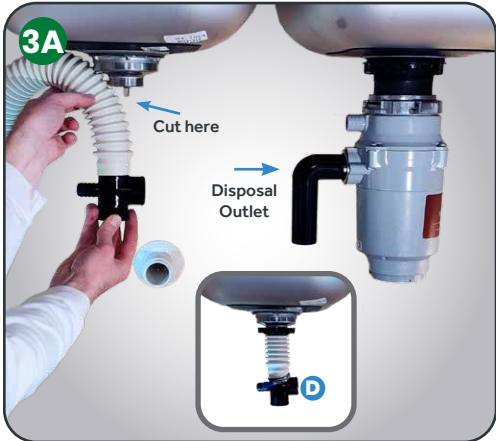

P-TRAP WITH DISPOSAL

This page is for waste lines located behind or past your disposal.

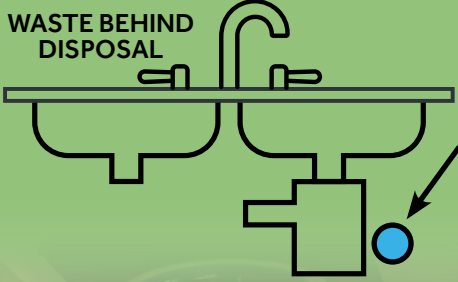

PAGE 4 P-TRAP WITH WASTE BEHIND DISPOSAL

P-trap with disposal installation (waste BEHIND disposal)

Read the basic concepts section on the back cover, then follow the instructions below to install your double basin Simple Drain. The green and blue bubble will guide your success.

① _____
Locate waste and save one tube until STEP 5.

② _____
Trim tube 4 ribs in from the cuff. **A**

③ _____
Clamp to disposal outlet:

- ELBOW outlet: Push cuff onto top of TEE (with dishwasher stub pointing toward disposal) and clamp. Push clamp into the first valley on raw end of tube then slide all 4 ribs over disposal elbow and tighten. **2B D**
- STRAIGHT outlet: With dishwasher stub upward, push cuff onto side of TEE facing disposal and clamp. Slide 4 ribs over disposal outlet and clamp in the first valley on the raw end. **2C**

④ _____
Attach to sink:

- Using remaining portion of the first tube, push cuff onto TEE facing the sink drain and measure. Remove tube from TEE and cut to length. **3B or 2C**
- Attach threaded fitting. **B**
- Thread onto sink drain. **C**
- Setup should look like either figure **2C** or **4B**

⑤ _____
FORM THE P-TRAP

- To form the trap, hang the uncut tube from the TEE and push loop into the valley of the tube where it is level with bottom of waste. **6**

⑥ _____
Push the depth tab down on the loop. Bend the tube into a tight U shape making sure the inside curve follows the depth tab. **6**

- Turn tube toward waste for final measurement. **7**

- Remove from TEE and cut to length.

- Install threaded fitting and thread to waste. **7**

⑦ _____
Clamp tube to bottom of TEE, reapply loop, and ensure all other connections are tight.

⑧ _____
Check for leaks and adjust as needed.

⑨ _____
Apply disinfecting clip to trap loop for future use.



Double Basin
Simple Drain
NO LEAKS. NO CLOGS. NO HASSLE.

THE TRAP

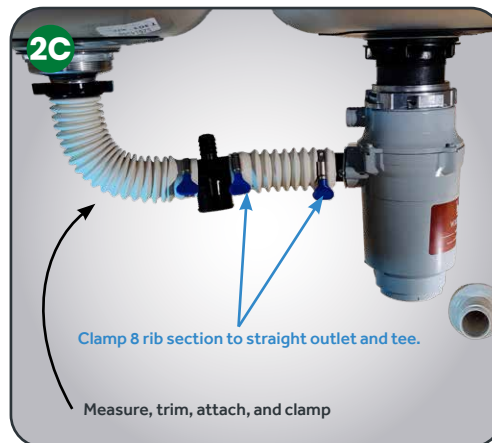
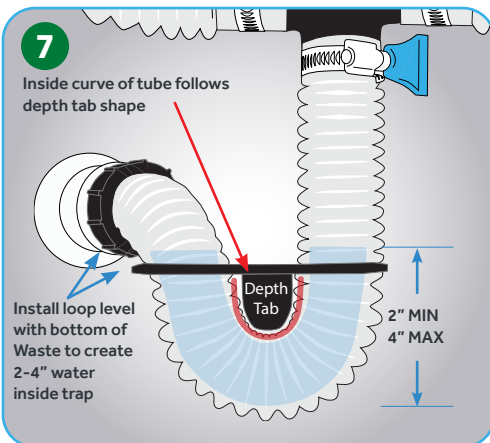

Confused? Don't be.
Watch our how-to videos!



S-TRAP WITH DISPOSAL

This page is for waste lines located opposite the disposal.

PAGE 5
S-TRAP WITH WASTE
OPPOSITE DISPOSAL

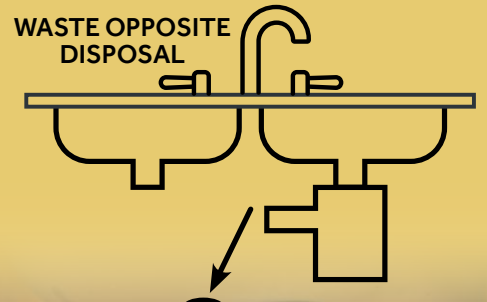

S-trap with disposal installation (waste OPPOSITE disposal)

Read the basic concepts section on the back cover, then follow the instructions below to install your double basin Simple Drain. The green and blue bubble will guide your success.

- 1 Set one tube aside until you finish STEP 8. **1A**
- 2 Point dishwasher stub on TEE away from disposal and align top of TEE side port to bottom of disposal outlet as shown by dashed blue line. **2A**
- 3 Push tube onto the TEE and hold in position below the drain. Mark the rib where it meets the sink drain. **Add an extra rib or two in case you need to re-cut and trim tube.** **3A A**
- 4 Attach threaded fitting. **B**
- 5 Thread onto sink drain and then attach TEE with clamp. It should look something like the inset box **3A C D**
- 6 Using remaining portion of the first tube, push cuff onto the side of the TEE facing the disposal and measure over to the disposal outlet so that 4 ribs go over the outlet. If outlet is straight, run tube directly across and ensure tube slopes down to TEE. Remove tube from TEE and then cut to length. **4A**
- 7 Clamp cuffed end to TEE. For cut end, put clamp into first valley, push 4 ribs onto disposal outlet, and clamp tightly. **5A**

FORMING THE S-TRAP

Hang the uncut tube from the TEE and form an "S" shape while holding the other end next to the waste to measure the length. Use the loop and depth tab to help make sure the trap portion of the "S" is correct. Helpful tips: **6 7**

- Try to keep the bottom of the trap above the top of the waste if possible. **6**
- Leave extra length when you cut because you may want make adjustments once installed.
- Remove tube from TEE before you cut to length.
- S-traps are never to code, but it is still important to form a proper trap using the loop and depth guide as shown.

8 Once satisfied with the trap shape, measure, cut, and attach the threaded fitting to the tube.

9 Thread tube to the waste. Attach tube to bottom of TEE with hand-tighten clamp and ensure all other connections are tight. Check for leaks and adjust as needed. Apply disinfecting clip to trap loop for future use. Optional rubber band or zip tie may help keep upper bend in place. **7**

Confused? Don't be.
Watch our how-to videos!

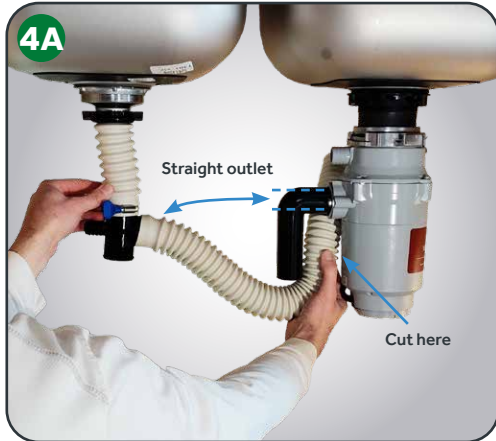
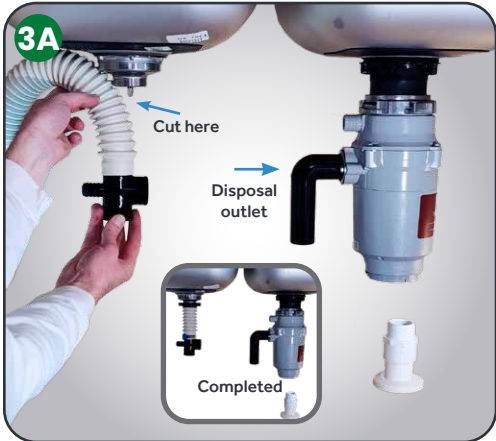
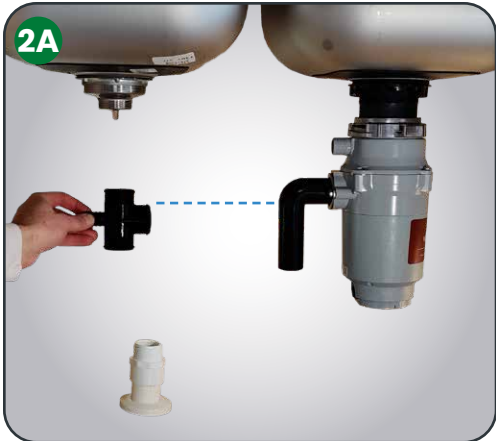

FORMING

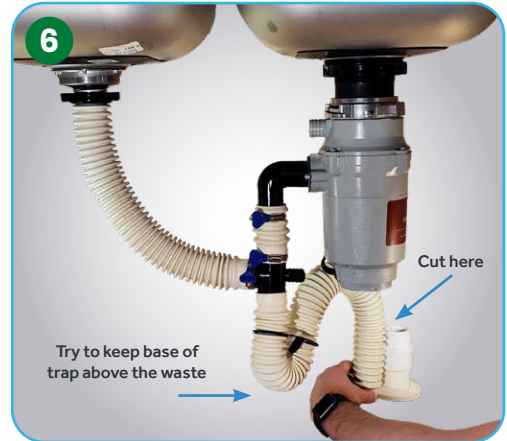

S-TRAP WITH DISPOSAL

This page is for waste lines located behind or past your disposal.

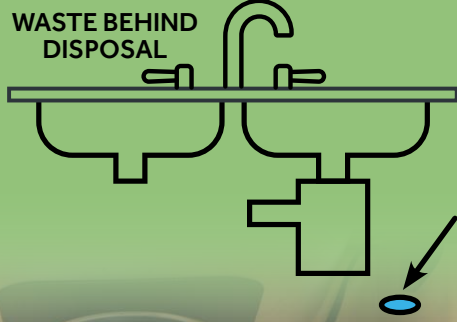

WASTE BEHIND DISPOSAL



Double Basin Simple Drain
NO LEAKS. NO CLOGS. NO HASSLE.

PAGE 6 S-TRAP WITH WASTE BEHIND DISPOSAL

S-trap with disposal installation (waste BEHIND disposal)

Read the basic concepts section on the back cover, then follow the instructions below to install your double basin Simple Drain. The green and blue bubble will guide your success.

① _____

Set one tube aside until you finish STEP 4. **1B**

② _____

Trim tube 4 ribs in from the cuff. **A**

③ _____

Clamp to disposal outlet:

- ELBOW outlet: Push cuff onto top of TEE (with dishwasher stub pointing toward disposal) and clamp. Apply a second clamp into the first valley on the raw end of the tube. Push ribs over the elbow until it hits the TEE and tighten. **2B D**
- STRAIGHT outlet: With dishwasher stub upward, push cuff onto side of TEE facing disposal and clamp. Apply a second clamp into the first valley on the raw end of the tube. Push ribs over disposal outlet until it hits the TEE and tighten. **2C**

④ _____

Attach to sink:

- Using remaining piece of tube from STEP 2, push cuff onto TEE facing the sink drain and measure. Remove tube from TEE and cut to length. **3B or 2C**
- Attach threaded fitting. **B**
- Thread onto sink drain. **C**
- Setup should look like either figure **2C** or **4B**

⑤ _____

FORMING THE S-TRAP

Hang the uncut tube from the TEE and form an "S" shape while holding the other end next to the waste to measure the length. Use the loop and depth tab to help make sure the trap portion of the "S" is correct. Helpful tips: **6 7**

- Try to keep the bottom of the trap above the top of the waste if possible. **6**
- Leave extra length when you cut because you may want make adjustments once installed.
- Remove tube from TEE before you cut to length.
- S-traps are never to code, but it is still important to form a proper trap using the loop and depth guide as shown.

⑥ _____

Once satisfied with the trap shape, measure, cut, and attach the threaded fitting to the tube.

⑦ _____

Thread tube to the waste. Attach tube to bottom of TEE with hand-tighten clamp and ensure all other connections are tight. Check for leaks and adjust as needed. Apply disinfecting clip to trap loop for future use. Optional rubber band or zip tie may help keep upper bend in place. **7**

Confused? Don't be.
Watch our how-to videos!



THE TRAP

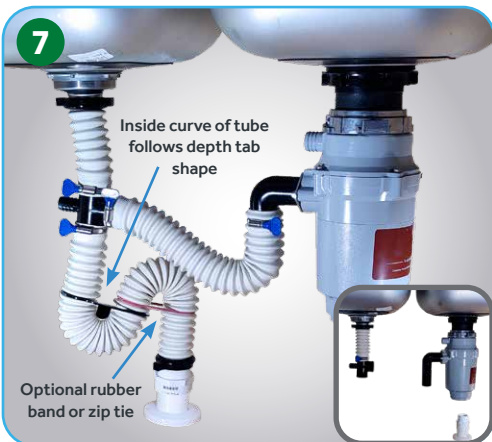

BASIC CONCEPTS:

Cutting, fitting, clamping, and attaching hoses



PATENT PENDING
ADA 606.5 COMPLIANT

Confused? Don't be.
Watch our how-to videos!



REQUIRED READ BEFORE INSTALL

SEE BELOW FOR GLOSSARY AND CONNECTING DISHWASHER

HOW TO CUT TUBE

Pinch tube, snip a small hole in valley, and cut around circumference to leave a clean edge. DO NOT try and cut through in one chop.

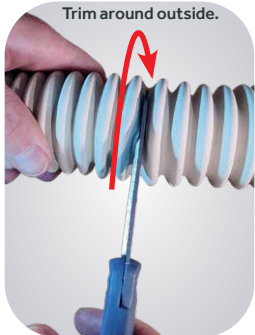
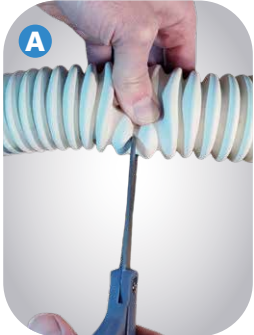

ATTACHING THREADED FITTING

Capture last rib between male and female half of a fitting by locking one tab and then carefully push the other into place.

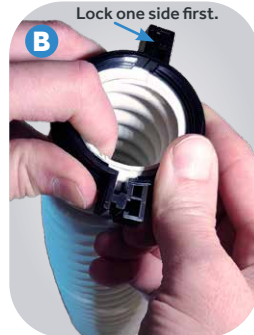

THREAD TO SINK OR WASTE

Thread fitting by hand onto bottom of sink (shown) or onto waste until snug. The goal is to compress the rubber rib to create a seal. Never use a wrench. It may help to twist counterclockwise for 1/4 turn to align the threads.



UNDER-THE-SINK KNOWLEDGE

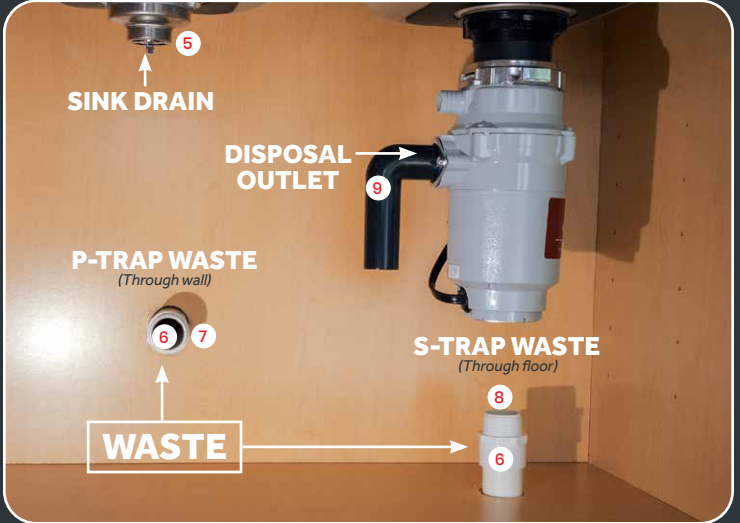
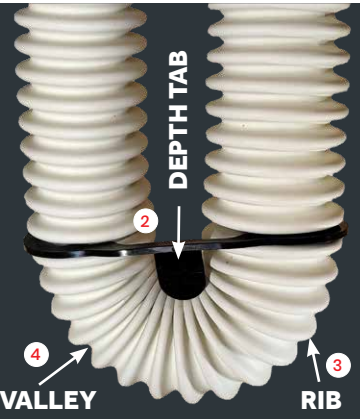

GLOSSARY

- 1 **CUFF:** Smooth end of the tube for connecting to TEE.
- 2 **DEPTH TAB:** Curved tab on the trap loop. Tube should follow outer edge as shown (left) to create a proper sized trap.
- 3 **RIB:** Raised area of tube. Could also be called a "bump" or "ridge." Acts as a sealing surface when used with our threaded fitting.
- 4 **VALLEY:** Low spot between two ribs.
- 5 **SINK DRAIN:** Male threaded bottom of the sink. Simple Drain® threaded fittings will connect here using one rib to create a water-tight seal.
- 6 **WASTE:** 1.5" male threaded connection to your home's drain system. Should be in the wall (P-TRAP), but may be in the floor (S-TRAP).
- 7 **P-TRAP:** Wall-mounted trap that captures water to prevent sewer gas backup.
- 8 **S-TRAP:** Floor-mounted trap that captures water to prevent sewer gas backup. S-TRAP installations, regardless of the product used, do not meet code as they can go dry during normal use.
- 9 **DISPOSAL OUTLET:** The straight or elbowed drain outlet on the side of your disposal. **Make sure that the area you clamp to is smooth and does not have embossed print or other imperfections as this will result in a poor seal and potential leaks.

CLAMPING TUBE TO TEE

Slide clamp onto the TEE and turn it so that when it is in final position, one tube port is facing the other sink or disposal and one port is facing down. Push TEE into the cuff until it can go no further and tighten by hand until snug. Pull to make sure it does not move.



Connect dishwasher (If necessary)

IMPORTANT! If you have a disposal **DO NOT** remove knock-out plug on the Simple Drain® TEE. Instead, connect dishwasher drain tube to your disposal following manufacturer instructions.

If you have a dishwasher but do not have a disposal, you must remove the knock-out plug on the Simple Drain® TEE first. Failure to do so could cause damage to the dishwasher, drain tube, TEE, sink cabinet, or all of the above.

Remove knock-out plug by tapping on the top with a hammer and screwdriver to break the plug. Pry out remaining pieces until smooth.

Push dishwasher drain tube over the barb on the TEE and attach with clamp (not included).

