



Note: RoHS applies only to 304 SS and 316 SS versions

Description & Features:

- On steam service, the syphon will prevent hot steam from entering a pressure gauge, diaphragm seal or transmitter
- Available in brass/steel for non-corrosive applications and stainless steel for corrosive applications
- CRN registered
- 1 year warranty

Applications:

- Recommended for applications involving temperatures above 100°F (37°C)

Specifications

Material	Schedule 40 steel coil welded, schedule 40 brass seamless, schedule 40, 80, 160 steel coil seamless, 304 SS seamless, or 316 SS seamless
Style	180 degree coil
Connection	1/4" NPT male x 1/4" NPT male or 1/2" NPT male x 1/2" NPT male
Maximum Operating Pressure	Schedule 40 welded: Steel suitable up to 175 psi at 340°F (171°C) Schedule 40 seamless: Brass, steel, 304 SS, 316 SS suitable up to 500 psi at 680°F (360°C) Schedule 80 seamless: Steel, 304 SS, 316 SS suitable up to 1,650 psi at 630°F (332°C) Schedule 160 seamless: Steel, 304 SS, 316 SS suitable up to 3,200 psi at 1,100°F (548°C)

Order Codes (products in bold are normally in stock)

Material	1/4" NPT	1/2" NPT
Schedule 40 Steel (welded)	SSP525	-
Schedule 40 Brass	SSP545	SSP559
Schedule 40 Steel	-	SSP555
Schedule 40 304 SS	SSP535	SSP585
Schedule 40 316 SS	SSP554	SSP557
Schedule 80 Carbon Steel	SSP556	-
Schedule 80 304 SS	SSP595	-
Schedule 80 316 SS	-	-
Schedule 160 Carbon Steel	-	-
Schedule 160 304 SS	-	-
Schedule 160 316 SS	-	-

Note: Schedule 80 316 SS and extra-extra strong schedule available

1/4" Syphon

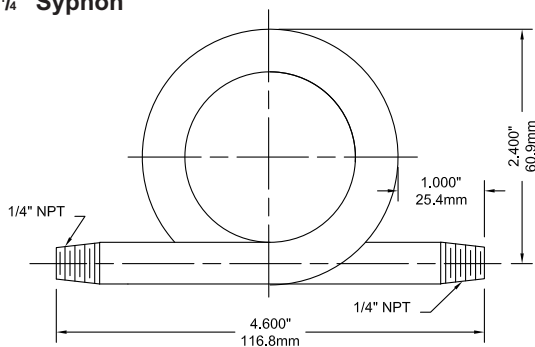

1/2" Syphon

