

REPAIR PARTS

CASED & UNCASED [U/UC] EVAPORATOR COILS

U-18
U-24
U-29
U-30
U-31
U-32
U-35
U-36
U-42
U-47
U-48
U-49
U-59
U-60
U-61
U-62
UC-18
UC-24
UC-29
UC-30
UC-32
UC-35
UC-36
UC-42
UC-47
UC-48
UC-49
UC-59
UC-60
UC-61
UC-62
UD-24
UD-36
UD-48
UD-60



Goodman Manufacturing Company, L.P.
5151 San Felipe, Suite 500
Houston, TX 77056

www.goodmanmfg.com



This manual is to be used by qualified technicians only.

RP-106F
May 2008

This manual replaces all RP-106 revisions.
Copyright © 1994-2008 Goodman Manufacturing Company, L.P

Important Information

Index

Functional Parts List	3
Illustration and Parts	4 - 7

Views shown are for parts illustrations only, not servicing procedures.

Text Codes:

AR - As Required

NA - Not Available

NS - Not Shown

00000000 - See Note

QTY - Quantity Example (QTY 3) (If Quantity not shown, Quantity = 1)

M - Model Example (M1) (If M Code not shown, then part is used on all Models)

Expanded Model Nomenclature:

Example M1 - Model#1 M2 - Model#2 M3 - Model#3

Goodman Manufacturing Company, L.P. is not responsible for personal injury or property damage resulting from improper service. Review all service information before beginning repairs.

Warranty service must be performed by an authorized technician, using authorized factory parts. If service is required after the warranty expires, Goodman Manufacturing Company, L.P. also recommends contacting an authorized technician and using authorized factory parts.

Goodman Manufacturing Company, L.P. reserves the right to discontinue, or change at any time, specifications or designs without notice or without incurring obligations.

For assistance within the U.S.A. contact:
Consumer Affairs Department
Goodman Manufacturing Company, L.P.
7401 Security Way
Houston, Texas 77040
877-254-4729-Telephone
713-863-2382-Facsimile

For assistance outside the U.S.A. contact:
International Division
Goodman Manufacturing Company, L.P.
7401 Security Way
Houston, Texas 77040
713-861-2500-Telephone
713-863-2382-Facsimile

Functional Parts

Part

No: Description:

SPECIAL PARTS

RP-106F

REPAIR PARTS MANUAL

Expanded Model Nomenclature

M1 - U-18
M2 - U-24
M3 - U-29
M4 - U-30
M5 - U-31
M6 - U-32
M7 - U-35
M8 - U-36
M9 - U-42
M10 - U-47
M11 - U-48
M12 - U-49
M13 - U-59
M14 - U-60
M15 - U-61
M16 - U-62
M17 - UC-18
M18 - UC-24
M19 - UC-29
M20 - UC-30
M21 - UC-32
M22 - UC-35
M23 - UC-36
M24 - UC-42
M25 - UC-47
M26 - UC-48
M27 - UC-49
M28 - UC-59
M29 - UC-60
M30 - UC-61
M31 - UC-62
M32 - UD-24
M33 - UD-36
M34 - UD-48
M35 - UD-60

Replacement Parts List

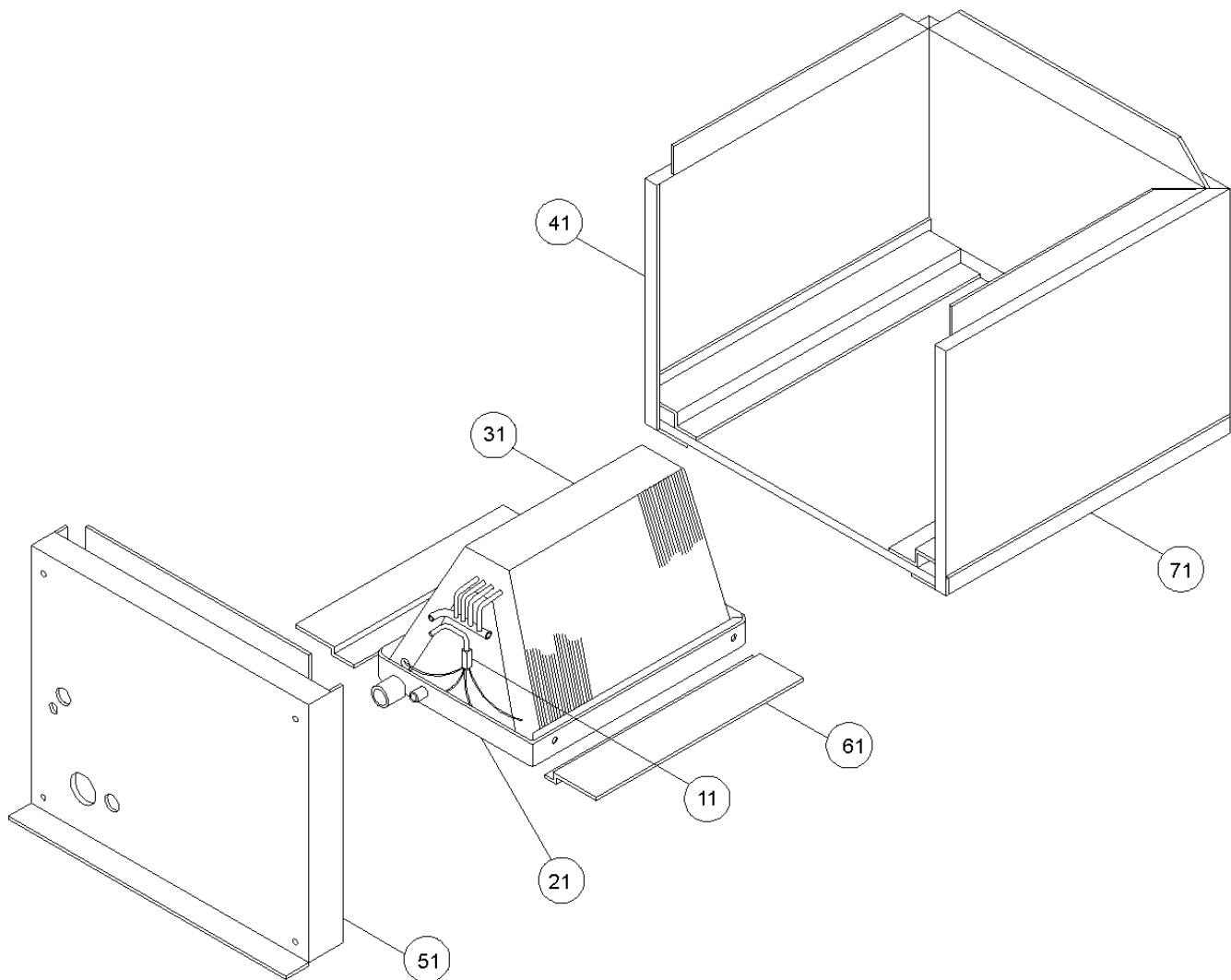

NOTE: IF A REPLACEMENT DRAIN PAN IS REQUIRED FOR HIGH TEMPERATURE APPLICATIONS (OIL FURNACES OR FURNACES THAT EXCEED 300°F) USE THE FOLLOWING METAL DRAIN PANS: ORDER PART NO.'S 1523618 (U18-35) AND 1523620 (U49-62).

NOTES: "R" IN THE COIL PAN ASSY AND FRONT PANEL PART NO. DENOTES PRIMARY AND SECONDARY CONDENSATE DRAINS ON RIGHT HAND SIDE.

Replacement Parts List

Ref. Part No:	No:	Description:	Ref. Part No:	No:	Description:
<i>Image 1:</i>			Expanded Model Nomenclature		
11	B1314452	FLOWRATOR .052 (M1, M17)	M1	-	U-18
11	B1313459	FLOWRATOR .059 (M2, M18, M32)	M2	-	U-24
11	B1314459	FLOWRATOR .059 (M3, M19)	M3	-	U-29
11	B1314465	FLOWRATOR .065 (M4)	M4	-	U-30
11	B1313468	FLOWRATOR .068 (M20)	M5	-	U-31
11	B1314668	FLOWRATOR .068 (M6, M21)	M6	-	U-32
11	B1313471	FLOWRATOR .071 (M33)	M7	-	U-35
11	B1314471	FLOWRATOR .071 (M7, M8, M22, M23)	M8	-	U-36
11	B1313678	FLOWRATOR .078 (M9, M24)	M9	-	U-42
11	B1313682	FLOWRATOR .082 (M10, M12, M25, M26, M27, M34, M35)	M10	-	U-47
11	B1313690	FLOWRATOR .090 (M13, M14, M28, M29)	M11	-	U-48
11	B1313890	FLOWRATOR .090 (M15, M16, M30, M31)	M12	-	U-49
11	B1313493	FLOWRATOR .093 (M20)	M13	-	U-59
21	1755913N	PLASTIC DRAIN PAN (M2, M18)	M14	-	U-60
21	1755920N	PLASTIC DRAIN PAN (M34, M35)	M15	-	U-61
21	1755923N	PLASTIC DRAIN PAN (M11, M26)	M16	-	U-62
21	B1755913HR	PLASTIC DRAIN PAN (M1, M3, M4, M6, M7, M17, M19, M20, M21, M22)	M17	-	UC-18
21	B1755917H	PLASTIC DRAIN PAN (M8, M9, M10, M23, M24, M25)	M18	-	UC-24
21	B1755919H	PLASTIC DRAIN PAN (M12, M13, M16, M20, M27, M28, M31)	M19	-	UC-29
21	B1755923H	PLASTIC DRAIN PAN (M14, M15, M29, M30)	M20	-	UC-30
31	158540124NS	SERVICE COIL ASSY (COMPLETE) (M2, M18, M32)	M21	-	UC-32
31	158540336NS	SERVICE COIL ASSY (COMPLETE) (M33)	M22	-	UC-35
31	158540848NS	SERVICE COIL ASSY (COMPLETE) (M11, M26)	M23	-	UC-36
31	158541248NS	SERVICE COIL ASSY (COMPLETE) (M34)	M24	-	UC-42
31	158541260NS	SERVICE COIL ASSY (COMPLETE) (M35)	M25	-	UC-47
31	P1400U18HR	SERVICE COIL ASSY (COMPLETE) (M1, M17)	M26	-	UC-48
31	P1400U29HR	SERVICE COIL ASSY (COMPLETE) (M3, M19)	M27	-	UC-49
31	P1400U30HR	SERVICE COIL ASSY (COMPLETE) (M4)	M28	-	UC-59
31	P1400U31HR	SERVICE COIL ASSY (COMPLETE) (M5, M20)	M29	-	UC-60
31	P1400U32HR	SERVICE COIL ASSY (COMPLETE) (M6, M21)	M30	-	UC-61
31	P1400U35HR	SERVICE COIL ASSY (COMPLETE) (M7, M22)	M31	-	UC-62
31	P1400U36H	SERVICE COIL ASSY (COMPLETE) (M8, M23)	M32	-	UD-24
31	P1400U42H	SERVICE COIL ASSY (COMPLETE) (M9, M24)	M33	-	UD-36
31	P1400U47H	SERVICE COIL ASSY (COMPLETE) (M10, M25)	M34	-	UD-48
31	P1400U49H	SERVICE COIL ASSY (COMPLETE) (M12, M27)	M35	-	UD-60
31	P1400U59H	SERVICE COIL ASSY (COMPLETE) (M13, M20, M28)			
31	P1400U60H	SERVICE COIL ASSY (COMPLETE) (M14, M29)			
31	P1400U61H	SERVICE COIL ASSY (COMPLETE) (M15, M30)			
31	P1400U62H	SERVICE COIL ASSY (COMPLETE) (M16, M31)			

Replacement Parts List

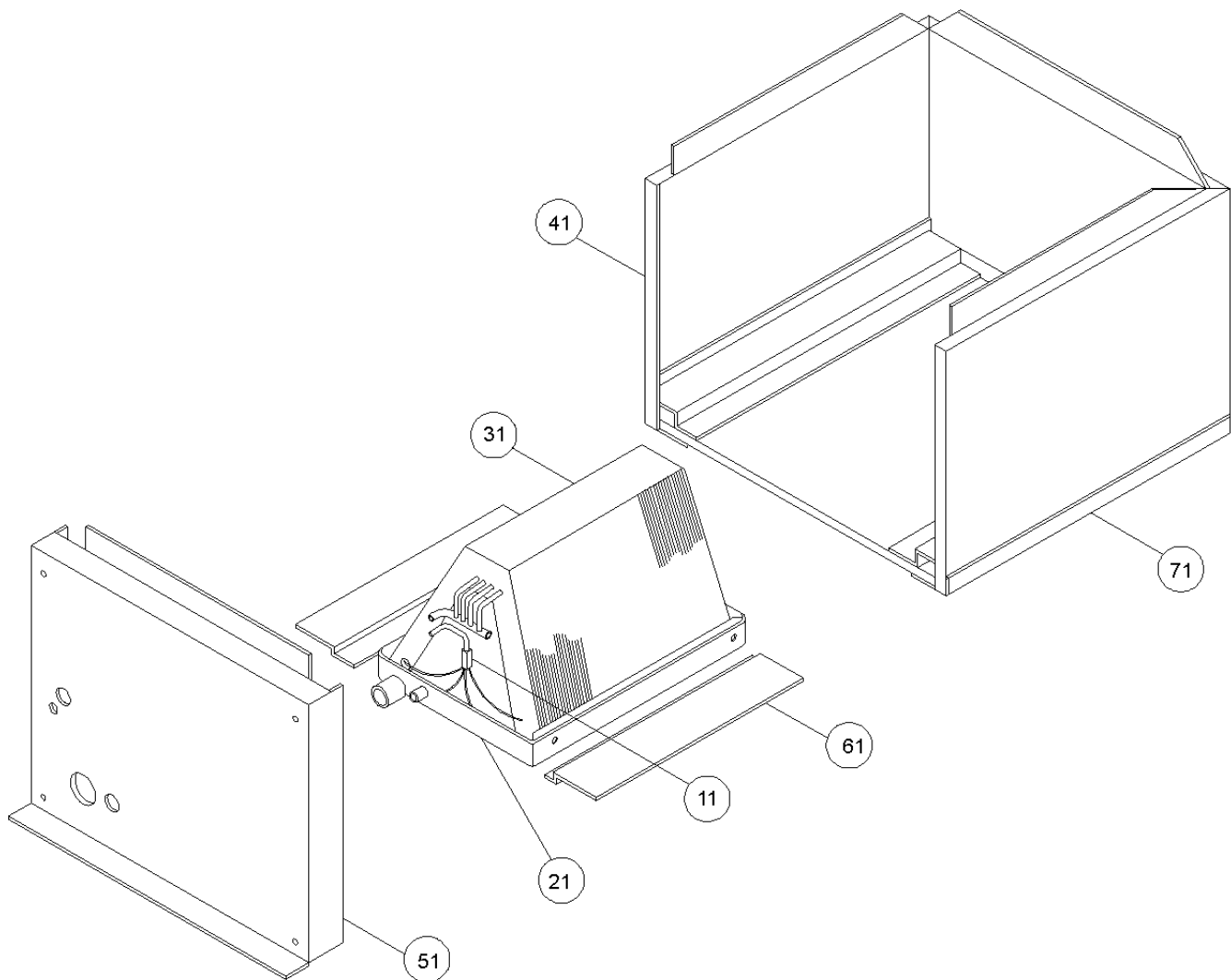

NOTE: IF A REPLACEMENT DRAIN PAN IS REQUIRED FOR HIGH TEMPERATURE APPLICATIONS (OIL FURNACES OR FURNACES THAT EXCEED 300°F) USE THE FOLLOWING METAL DRAIN PANS: ORDER PART NO.'S 1523618 (U18-35) AND 1523620 (U49-62).

NOTES: "R" IN THE COIL PAN ASSY AND FRONT PANEL PART NO. DENOTES PRIMARY AND SECONDARY CONDENSATE DRAINS ON RIGHT HAND SIDE.

Replacement Parts List

Ref. Part No:	No:	Description:	Ref. Part No:	No:	Description:
<i>Image 1:</i>			Expanded Model Nomenclature		
41	1877513	DOWNFLOW CABINET ASSY (M32, M33)	M1	-	U-18
41	1877514	DOWNFLOW CABINET ASSY (M34, M35)	M2	-	U-24
41	1577706	UPFLOW CABINET ASSY (M4, M6, M8, M9, M10, M20)	M3	-	U-29
41	1577707	UPFLOW CABINET ASSY (M11, M14, M15)	M4	-	U-30
41	1577710	UPFLOW CABINET ASSY (M1, M2, M3, M7, M20)	M5	-	U-31
41	1577722	UPFLOW CABINET ASSY (M1, M3, M7, M12, M13, M16)	M6	-	U-32
51	1577713	FRONT PANEL (M10)	M7	-	U-35
51	1577715	FRONT PANEL (M2)	M8	-	U-36
51	1577717	FRONT PANEL (M8, M9)	M9	-	U-42
51	1577718	FRONT PANEL (M11, M14, M15)	M10	-	U-47
51	1577719R	FRONT PANEL (M4, M6, M20)	M11	-	U-48
51	1577721	FRONT PANEL (M12, M13, M16)	M12	-	U-49
51	1577724R	FRONT PANEL (M1, M3, M20)	M13	-	U-59
51	1577726R	FRONT PANEL (M7)	M14	-	U-60
51	1877520	FRONT PANEL (M32)	M15	-	U-61
51	1877521	FRONT PANEL (M33)	M16	-	U-62
51	1877522	FRONT PANEL (M34, M35)	M17	-	UC-18
61	1725300	ZEE COIL SUPPORT (M4, M6, M20)	M18	-	UC-24
61	1725301	ZEE COIL SUPPORT (M1, M3, M4, M6, M7, M8, M9, M10, M12, M13, M14, M15, M16, M19)	M19	-	UC-29
71	1577508	FILLER PLATE (M4, M6, M8, M9, M20)	M20	-	UC-30
71	1577509	FILLER PLATE (M4, M6, M8, M9, M10, M11, M12, M13, M14, M15, M16)	M21	-	UC-32
71	1577510	FILLER PLATE (M4, M6, M8, M9, M10, M12, M13, M14, M15, M16)	M22	-	UC-35
			M23	-	UC-36
			M24	-	UC-42
			M25	-	UC-47
			M26	-	UC-48
			M27	-	UC-49
			M28	-	UC-59
			M29	-	UC-60
			M30	-	UC-61
			M31	-	UC-62
			M32	-	UD-24
			M33	-	UD-36
			M34	-	UD-48
			M35	-	UD-60