



# MODA™ SUREVENT® AIR ADMITTANCE VALVE BOX TECHNICAL SPECIFICATION

Job Name _____	Item # _____
Location _____	
Engineer _____	Contractor _____
PO # _____	Tag _____
Representative _____	

## SPECIFICATIONS

Oatey Sure-Vent® air admittance valves provide a method of allowing air to enter the plumbing drainage system without the use of a vent extended to open air and to prevent sewer gases from escaping into a building. An air admittance valve is a one way valve designed to allow air to enter the plumbing drainage system when negative pressures develop in the piping system. The device shall close by gravity and seal the vent terminal at zero differential pressure (no flow conditions) and under positive internal pressures. Valves shall be 100% functionally tested at 1/4" H<sub>2</sub>O and 30" H<sub>2</sub>O water column. The valves shall utilize a soft-centered, silicone membrane with Sweet Spot™ technology, allowing valve to open at -0.01 psi and seals at 0 psi and above. The MODA supply box shall have inter-locking wing flanges allowing installation on a single stud, between two studs or on separate walls, without the need for additional components. Box shall be manufactured of PVC, allowing solvent welded joints to be prepared in accordance with ASTM D2855 for PVC drainage systems (without the use of specialty cements).

## INSTALLATION

Always consult local plumbing codes prior to installing a Sure-Vent®. Individual, branch and circuit vents are permitted to terminate with a connection to a SureVent® AAV. Reference detailed instructions on oatey.com for specific guidance on Sure-Vent® AAV placement within a plumbing system.

## APPROVALS & LISTINGS

Listings	ASSE 1050 & 1051 ICC ESR-1664 NSF Standard 14 IAPMO - Classified Mark ASTM D 2665
Code Approvals	International Plumbing Code 2012 Uniform Plumbing Code 2012



## Accessory Components Included:



Faceplate



Side Brackets (2)



Sticker Cover  
(For Debris Protection)



Faceplate  
Insert

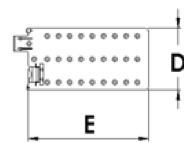
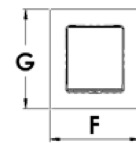
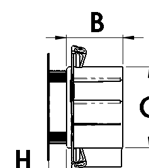
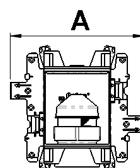

## FEATURES & MATERIALS

Outlet Box & Brackets	PVC
Valve	PVC with 2" NPT Threads
Box Connection	PVC 1/4 Turn Adapter with Sealing Gasket

## PERFORMANCE SPECIFICATIONS

Temperature Range	-40° F/-40° C to 150° F/66° C
DFU Rating	20 (stack or branch)

## PRODUCT SELECTOR

✓	Product Number	Description	Ctn. Qty.
	37981	MODA Surevent, 160 Branch, 24 Stack DFU AAV	12

## DIMENSIONS

[A]:	Box Width	8.00"	[E]:	Bracket Length	8.00"
[B]:	Box Depth	3.38"	[F]:	Faceplate Width	6.00"
[C]:	Box Height	4.85"	[G]:	Faceplate Height	6.45"
[D]:	Bracket Width	4.00"	[H]:	Faceplate Depth	1.25"

Access BIM/Revit content through [www.oatey.com](http://www.oatey.com)