

Extreme Angle Master Flash®

INSTALLATION GUIDE

Extreme Angle Size and Trimming

Extreme Angle Pipe Range

| Closed Top | | Closed Top | |
|------------|-----------------------------|------------|-----------------------------|
| #1 | #2 | #1 | #2 |
| 1 | 2-1/2" - 3-1/4" (64-83mm) | 1 | 4" - 4-1/2" (101-114mm) |
| 2 | 3-3/4" - 4" (83-102mm) | 2 | 4-1/2" - 4-7/8" (114-123mm) |
| 3 | 4" - 4-1/2" (102-114mm) | 3 | 4-7/8" - 5-3/8" (123-136mm) |
| 4 | 4-1/2" - 5-1/4" (114-133mm) | 4 | 5-1/2" - 6" (139-152mm) |
| 5 | 5-1/4" - 5-3/4" (133-146mm) | 5 | 6" - 6-5/8" (152-168mm) |
| | | 6 | 6-5/8" - 7-1/4" (168-184mm) |
| | | 7 | 7-1/4" - 8" (184-203mm) |

* Note This is the #1 Extreme Angle For Reference

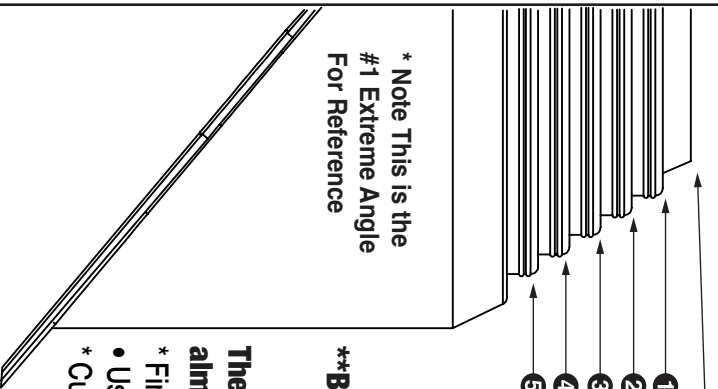

**Base Dimension: #1 1" (279mm) | #2 14-1/4" (362mm)

The built in 20° pitch allows adaptability to almost any roof pitch including 45°

- * Find pipe size in table and trim Extreme Angle Master Flash® as shown on outline.
- Use one size larger Extreme Angle Master Flash® on steep roofs or deep corrugation.
- * Cut the flashing at least 20% less than the pipe Outer Diameter

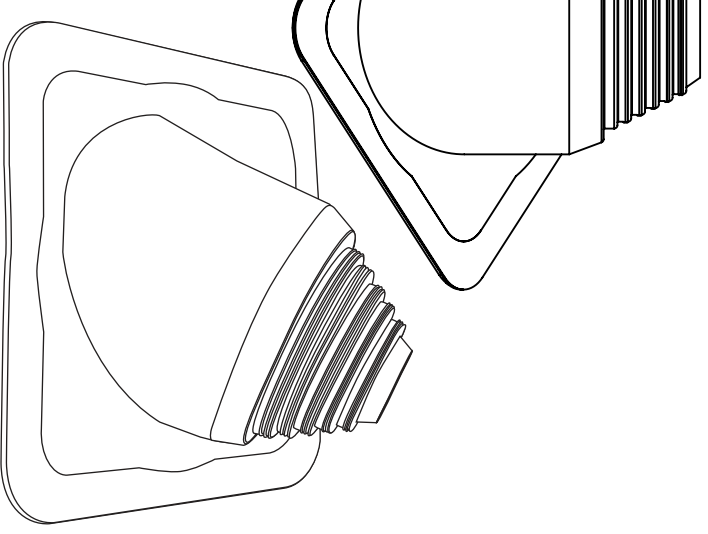

- 5 Easy Steps Installation Materials:** Extreme Angle Master Flash® | Fasteners | Washers | Snips/Scissors | Measuring Tape | Marker/Pencil | Sealant
- Measure & Trim**
- Slide**
- Form**
- Seal**
- Complete**

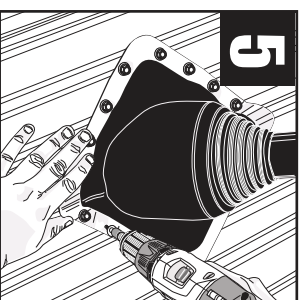
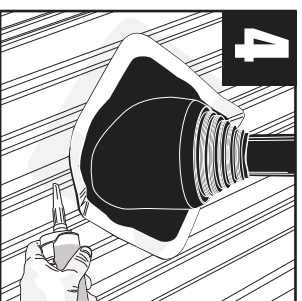
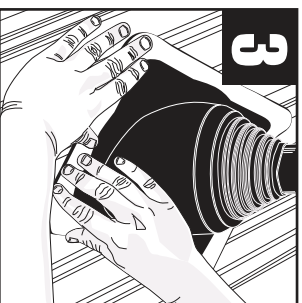
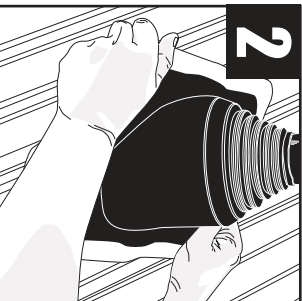
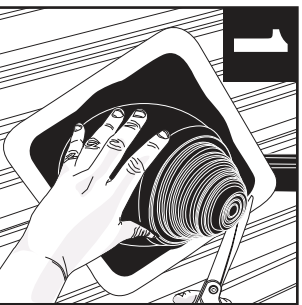

Note: Properly installed the base with Master Seal® Bonded Washers and fasteners. Fasteners should be 1" - 1-1/2" apart around the entire base for a tight secure seal.



Installation Video: <http://www.aztecwasher.com/installationvideos>

Extreme Angle Master Flash® is a product of Aztec Washer Company 4/2020

Extreme Angle Master Flash®

INSTALLATION GUIDE

Specifically designed for Metal Roofing Industry

For applications with a 3/12 to 16/12 pitch, while accepting & responding to the most commonly encountered pipe penetrations.

| | | | |
|---|----------------------------|------------------------------------|---|
| Advanced Ozone Resistance tested to... | | EPDM 70 hour @ 500 pphm | HIGH TEMP GRAY SILICONE 70 hour @ 500 pphm |
| High Temperature Resistance Tested to | Intermittent Continuous | +135°C (+275°F) +100°C (+212°F) | +260°C (+500°F) +225°C (+437°F) |
| Low Temperature Resistance tested to... | | -55°C (-67°F) | -74°C (-101°F) |
| Compression Set Maximum... | | 25% | 50% |

*Complete specification data and testing methods are available upon request.



Pipe diameters can be seen clearly for proper fitting.

Unique compression seal technology

Adaptable Base

The base is designed to mold to most panel configurations and roof pitches regardless of pipe location.

EPDM or High Temp Red or Gray Silicone,
These flashings are compounded specifically for maximum resistance to weathering due to ozone and ultraviolet light.

The built in 12/12 pitch
Allows to handle any extreme roof pitch (3/12 - 16/12), sleeve flexibility accommodates vibration and pipe movement caused by expansion/contraction. Easy on-site customization accommodates all normal installations.

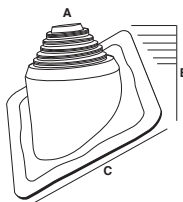
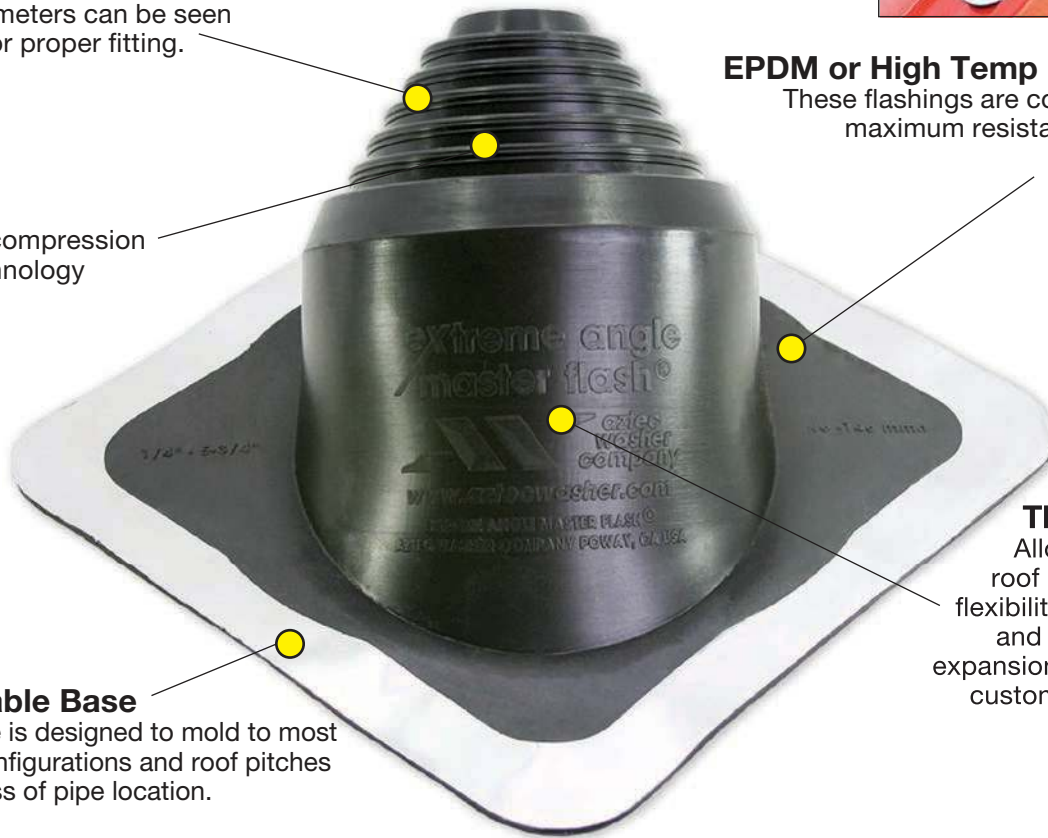

#1 Extreme Angle Pipe Range: Closed - 5-3/4" (0 - 146mm)

| COMPOUND | PART NO. | FLASHING DETAILS |
|---------------|----------|---|
| Black EPDM | EA101BA | A-Top opening diameter - Closed |
| Red Silicone | EA102RA | B-Cut to suit pipe size - Closed- 5-3/4" (0 -146mm) |
| Gray Silicone | EA102GX | C-Base dimensions - 11" (279mm) |

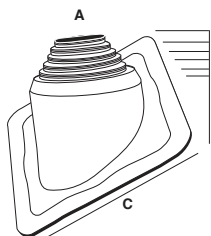

#2 Extreme Angle Pipe Range: 4" - 8" (101 - 203mm)

| COMPOUND | PART NO. | FLASHING DETAILS |
|---------------|----------|--|
| Black EPDM | EA201BA | A-Top opening diameter - 4" (101mm) |
| Red Silicone | EA202RA | B-Cut to suit pipe size - 4"- 8" (101-203mm) |
| Gray Silicone | EA202GX | C-Base dimensions - 14-1/4" (362mm) |