

# HS29-072 AND HS29-090 CONTROL BOX

NOVEMBER 16, 2000

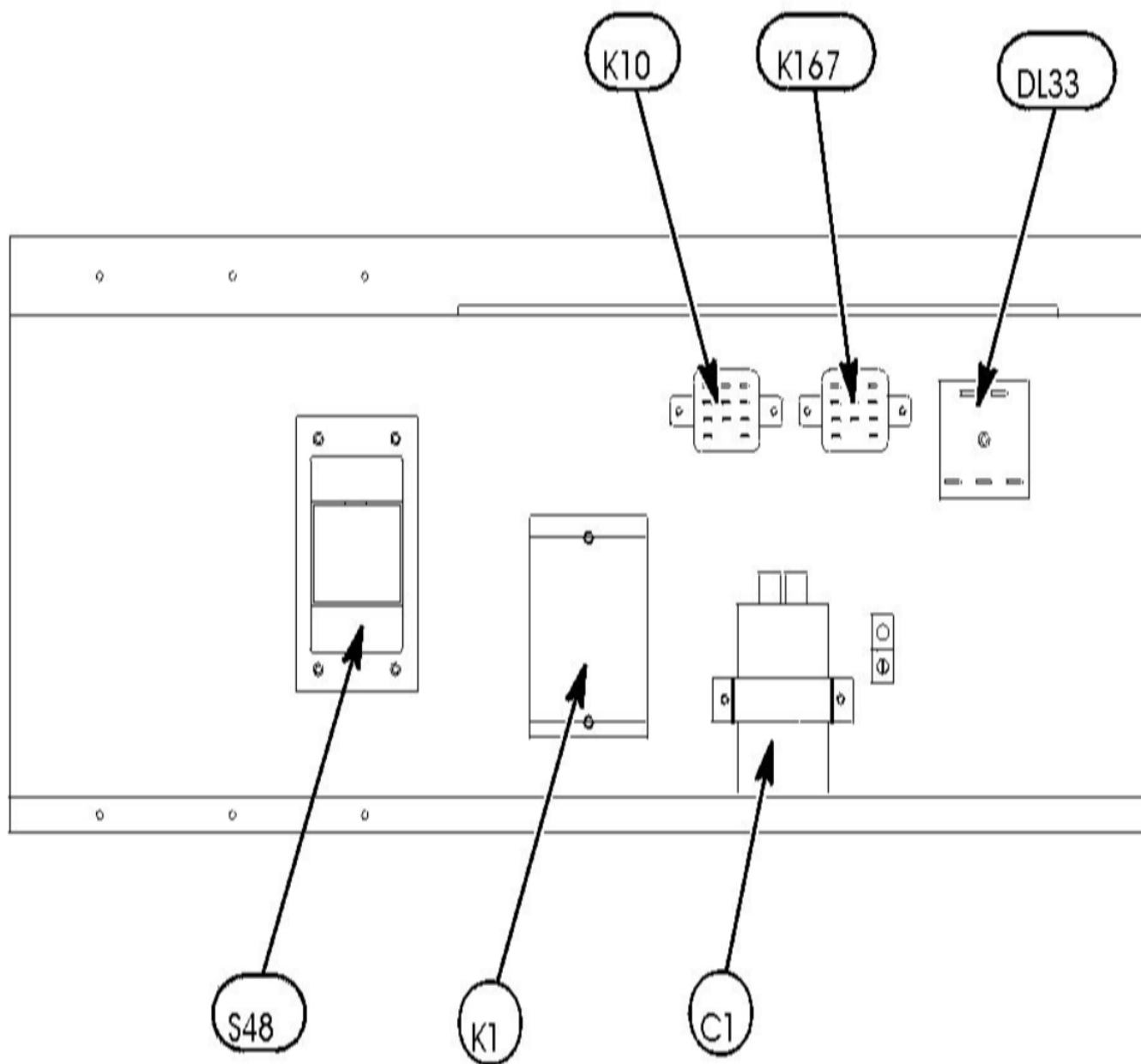

# HS29-072 AND HS29-090 SERIES

NOVEMBER 16, 2000

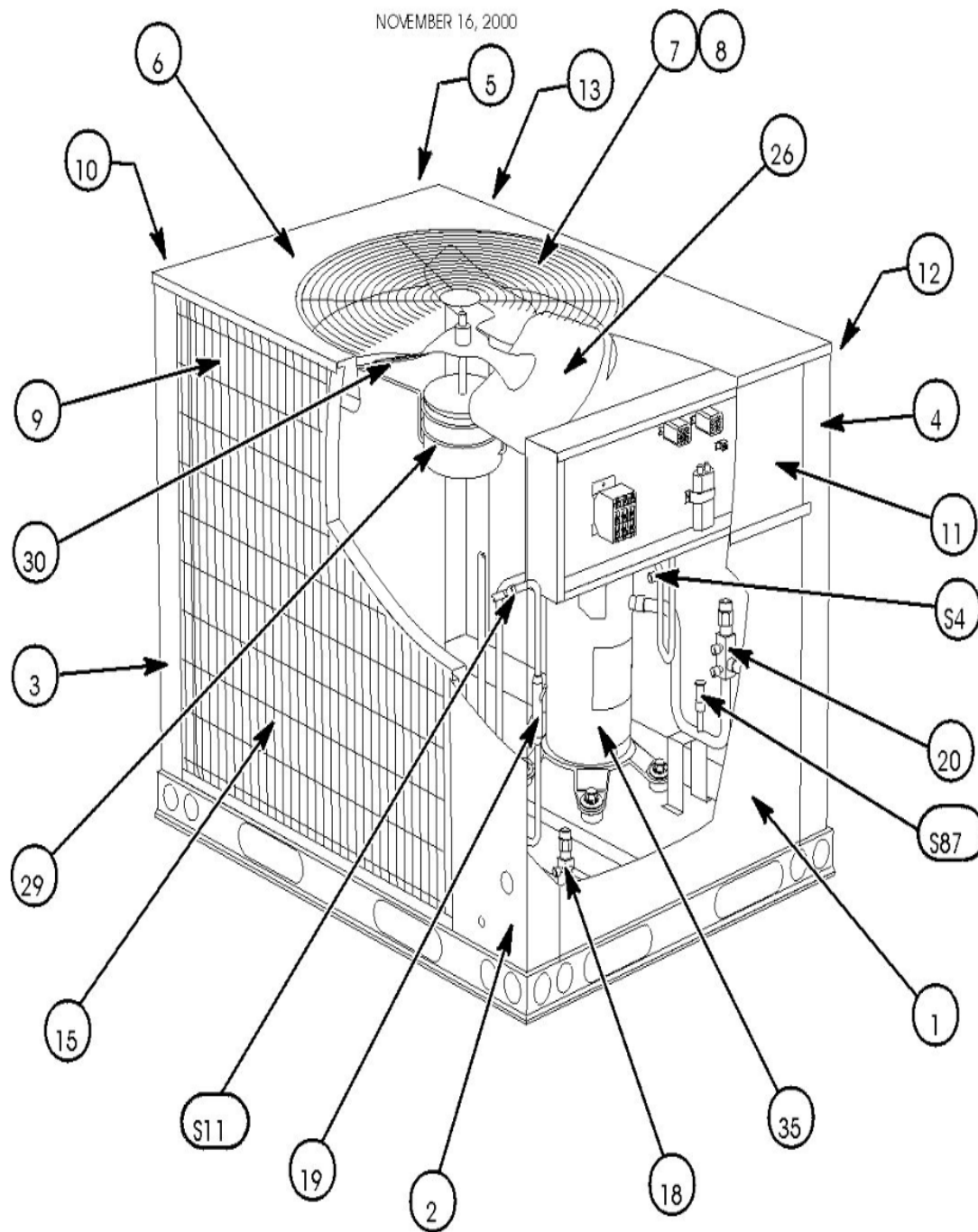

Revision Number - 2

## \*OPTIONAL PARTS-FIELD INSTALLED

Callout	Name	Quantity	Description
A	VALVE Cat #: 85K64 Model/Part #: 85K6401	1	DE-SUPERHEATING
B	VALVE Cat #: 85K63 Model/Part #: 85K6301	1	HOT GAS BYPASS
C	VALVE-CHECK Cat #: 57927 Model/Part #: P-8-1697	2	VALVE, CHECK 3/8" SOLDER
D	VALVE Cat #: 85K63 Model/Part #: 85K6301	1	HOT GAS BYPASS
E	VALVE-SERVICE Cat #: 68J11 Model/Part #: 68J1101	1	LIQUID
HG KIT	HOT GAS BYPASS KIT Cat #: 79K90 Model/Part #: LB-93143B	1	SUCTION-INC NEXT 2 PARTS
HG KT2	HOT GAS BYPASS KIT Cat #: 93K77 Model/Part #: LB-93156B	1	INC NEXT 3 PARTS

## CABINET PARTS

Callout	Name	Quantity	Description
	HINGE Cat #: 63K26 Model/Part #: 63K2601	1	CONTROL BOX COVER
	MULLION Cat #: 39M44 Model/Part #: LB-89947	1	COND-RIGHT SIDE
	SUPPORT Cat #: 47L80 Model/Part #: LB-89949	1	CONTROL BOX
	COVER Cat #: LB-90097 Model/Part #: LB-90097	1	DIS/GFI
	COVER-CONTROL BOX Cat #: LB-90102 Model/Part #: LB-90102	1	DIS OR GFI BOX
	COVER Cat #: LB-90610 Model/Part #: LB-90610	1	GFI

<b>Callout</b>	<b>Name</b>	<b>Quantity</b>	<b>Description</b>
	COVER Cat #: LB-91545 Model/Part #: LB-91545	1	DIS OR GFI
1	PANEL Cat #: 34L49 Model/Part #: LB-89783	1	ACCESS-COMP
2	POST-CORNER Cat #: LB-95228 Model/Part #: LB-95228	1	LEFT-FRONT
3	POST-CORNER Cat #: 39M42 Model/Part #: LB-93148	1	RIGHT-REAR
4	POST-CORNER Cat #: 39M43 Model/Part #: LB-95227	1	RIGHT-FRONT
5	POST-CORNER Cat #: 39M42 Model/Part #: LB-93148	1	RIGHT-REAR
6	PANEL-TOP Cat #: 89K85 Model/Part #: LB-89765	1	(ORDER ORIFICE ASSY W/TOP PANEL)
7	GRILLE-DISCHARGE Cat #: 21J31 Model/Part #: 21J3101	1	GRILLE, FAN GUARD
8	RING-ORIFICE Cat #: 16M55 Model/Part #: LB-100110A	1	(2 PC ASSY)
9	GUARD Cat #: 41K64 Model/Part #: 41K6401	1	"OUTDOOR COIL, SIDE-LEFT"
10	GUARD Cat #: 41K63 Model/Part #: 41K6301	1	"OUTDOOR COIL, REAR"
11	COVER-CONTROL BOX Cat #: 40L53 Model/Part #: LB-89781	1	COVER-CONTROL BOX
11	COVER-CONTROL BOX Cat #: LB-90099 Model/Part #: LB-90099	1	DIS/GFI
12	PANEL Cat #: 59L71 Model/Part #: LB-89948	1	ACCESS-SIDE
13	GUARD Cat #: 49K18 Model/Part #: 49K1801	1	"OUTDOOR COIL, SIDE-RIGHT"

## CONTROL PANEL PARTS

<b>Callout</b>	<b>Name</b>	<b>Quantity</b>	<b>Description</b>
	GFI Cat #: 79J98 Model/Part #: 79J9801	1	15AMP
	COVER Cat #: 86H85 Model/Part #: 86H8501	2	GFI/DIS
C1	CAPACITOR Cat #: 39H61 Model/Part #: 39H6101	1	"10MFD,370VAC(575V)"
C1	CAPACITOR Cat #: 53H05 Model/Part #: 39H6201	1	"12.5MFD,370VAC(460V,575V& INTL)"
C1	CAPACITOR Cat #: 53H06 Model/Part #: 39H6301	1	"15MFD,370VAC(208-230V)"
DL33	CONTROL-TIMED OFF Cat #: 49K02 Model/Part #: 49K0201	1	TIMER, MINIMUM RUN
K1	CONTACTOR Cat #: 38113 Model/Part #: P-8-7716	1	"3PDT,24V(208-230V)"
K1	CONTACTOR Cat #: 38393 Model/Part #: P-8- 7736	1	"3PDT,24V(460V,575V,& INTL)"
K10	RELAY Cat #: 69J57 Model/Part #: 69J5701	1	"FAN, DPDT,24V"
K167	RELAY Cat #: 39H98 Model/Part #: 39H9801	1	"DPDT,24V"
S48	SWITCH-DISCONNECT Cat #: 93J31 Model/Part #: 93J3101	1	"80AMP,600V"

## COOLING PARTS

<b>Callout</b>	<b>Name</b>	<b>Quantity</b>	<b>Description</b>
	MOUNT PKG-COMP Cat #: 45K17 Model/Part #: 45K1701PR	1	MOUNT PKG-COMP

<b>Callout</b>	<b>Name</b>	<b>Quantity</b>	<b>Description</b>
	FITTING PRESS TAP Cat #: 86G64 Model/Part #: 86G6401	4	FITTING, PRESSURE TAP
	HEATER-CRANKCASE Cat #: 99K42 Model/Part #: 99K4201	1	"EXTERNAL(460V,380/420V)"
	HEATER-CRANKCASE Cat #: 99K46 Model/Part #: 99K4601	1	EXTERNAL(575V)
	HEATER-CRANKCASE Cat #: 99K47 Model/Part #: 99K4701	1	EXTERNAL(208/230V
	HARNESS-WIRING Cat #: 91K96 Model/Part #: LB-90103C	1	COMP(208/230V)
	HARNESS-WIRING Cat #: 93K14 Model/Part #: LB-90103D	1	COMP(575V)
	HARNESS-WIRING Cat #: 93K19 Model/Part #: LB-90106	1	COOLING CTL(P36)(J36)
	HARNESS-WIRING Cat #: 68M30 Model/Part #: LB-99212C	1	O.D. FAN
	DRIER Cat #: 87326 Model/Part #: P-8-10807	1	DRIER
	VALVE CORE Cat #: 66820 Model/Part #: P-8-1897	4	VALVE, CORE 8075910047
	CAP-SEAL Cat #: 58114 Model/Part #: P-8-3187	5	CAP, BRASS
	SHIELD-RAIN Cat #: 32621 Model/Part #: P-8-6142	1	SHIELD, MOTOR
15	COIL-OUTDOOR Cat #: 90K96 Model/Part #: LB-92979B	1	W/MANIFOLD
18	VALVE-SERVICE Cat #: 68J11 Model/Part #: 68J1101	2	"LIQUID LINE-5/8""
20	VALVE-SERVICE Cat #: 60L52 Model/Part #: 60L5201	1	"SUCTION LINE,1-3/8""

<b>Callout</b>	<b>Name</b>	<b>Quantity</b>	<b>Description</b>
26	FAN Cat #: 16C01 Model/Part #: 16C0101	1	"1/2""BORE,24""DIA,4 BLADE"
29	MOTOR-FAN Cat #: 27J07 Model/Part #: 27J0701	1	"1/2HP,1075RPM,460/60/1 & INTL"
29	MOTOR-FAN Cat #: 27J30 Model/Part #: 27J3001	1	"1/2HP,1075RPM,208-230/60/1"
29	MOTOR-FAN Cat #: 27J31 Model/Part #: 27J3101	1	"1/2HP,1075RPM,575/60/1"
30	BRACKET Cat #: 78L41 Model/Part #: 78L4101	1	MOUNT, MOTOR
35	COMPRESSOR Cat #: 12L31 Model/Part #: 12L3101	1	7.5TON,460/60/3,COPE
35	COMPRESSOR Cat #: 12L32 Model/Part #: 12L3201	1	7.5TON,575/60/3,COPE
35	COMPRESSOR Cat #: 99K43 Model/Part #: 99K4301	1	7.5TON,208-230/60/3,COPE
35A	COMPRESSOR Cat #: 12L31 Model/Part #: 12L3101	1	7.5TON,380-420/50/3,COPE
S11	SWITCH-LO AMBIENT Cat #: 18J74 Model/Part #: 18J7401	1	"OUT 150PSIG, IN 275PSIG"
S4	SWITCH-HI PRESS Cat #: 85C87 Model/Part #: 85C8701	1	CUTOUT 410PSIG
S87	SWITCH-LO PRESS Cat #: 85C23 Model/Part #: 85C2301	1	"IN 55+5PSIG,OUT 25+5PSIG"

**Note:**

There are no technical notes for this product.