

HS29-072 AND HS29-090 CONTROL BOX

NOVEMBER 16, 2000

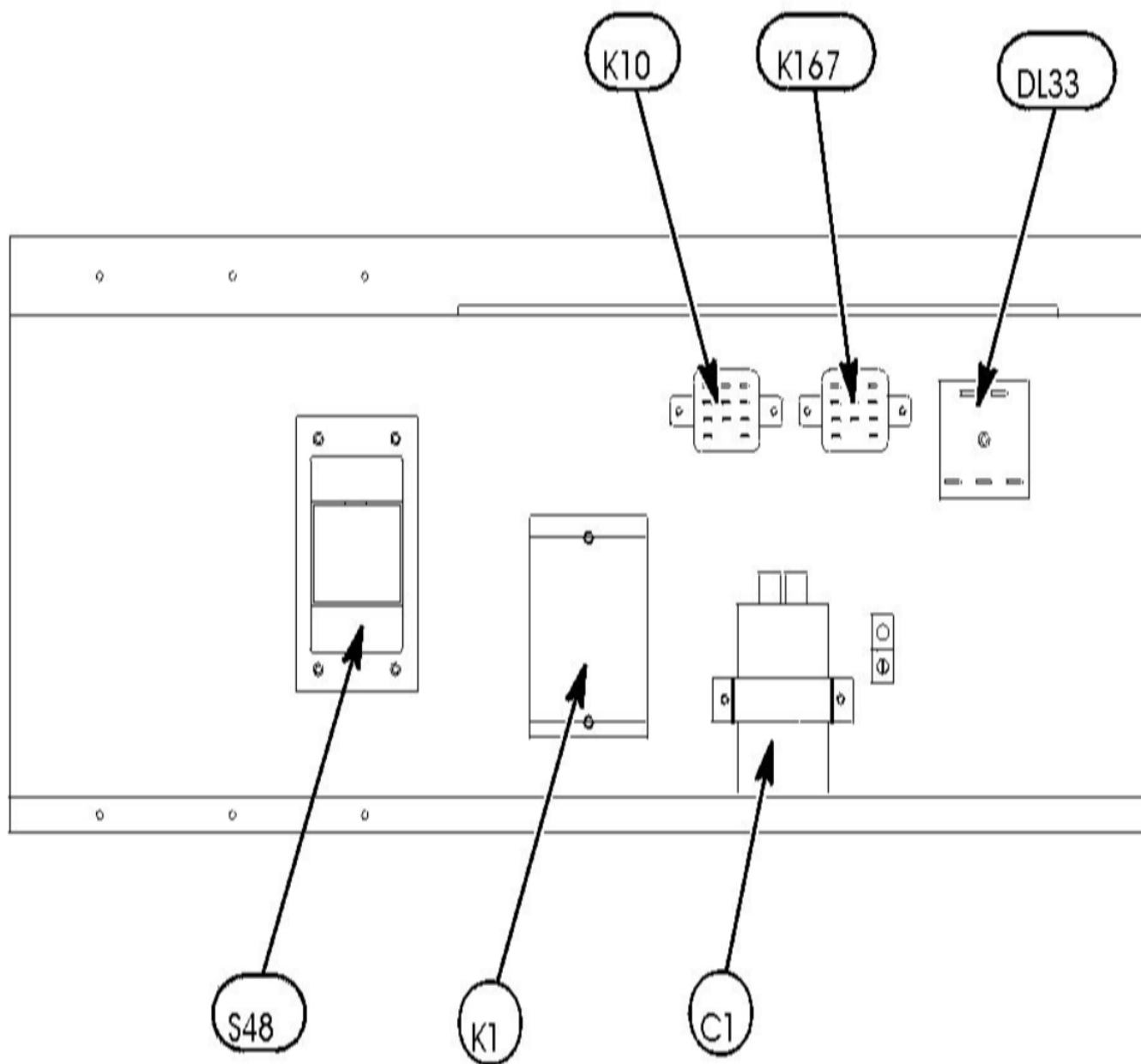

HS29-072 AND HS29-090 SERIES

NOVEMBER 16, 2000

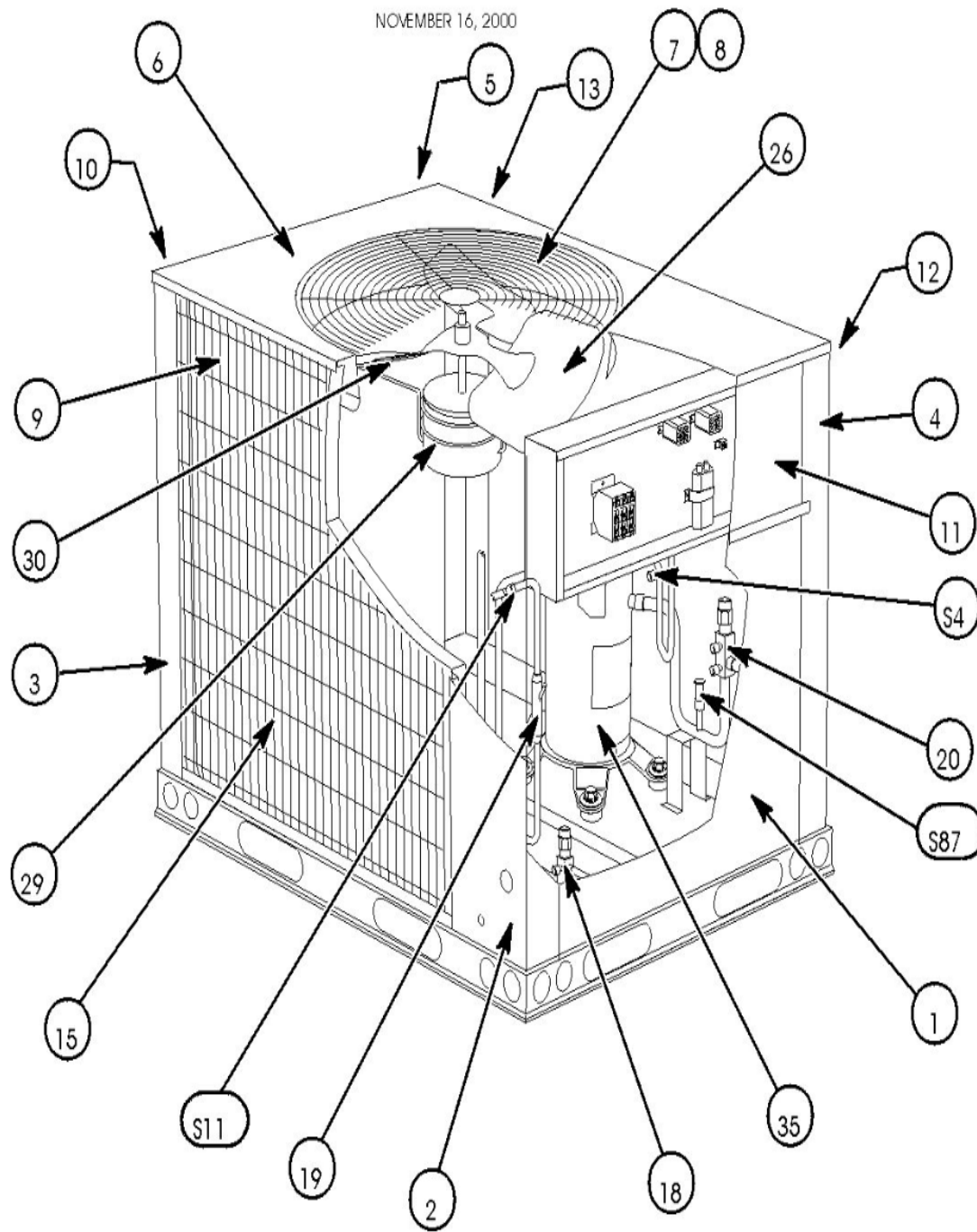

Revision Number - 3

*OPTIONAL PARTS-FIELD INSTALLED

Callout	Name	Quantity	Description
	VALVE-BALL Cat #: 15M40 Model/Part #: 15M4001	1	VALVE, BALL
	VALVE-SERVICE Cat #: 68J11 Model/Part #: 68J1101	1	LIQUID LINE-5/8 in.
	VALVE Cat #: 85K63 Model/Part #: 85K6301	1	VALVE, SERVICE - HOT GAS BYPASS
	VALVE Cat #: 85K64 Model/Part #: 85K6401	1	VALVE, DESUPERHEATING
	VALVE-CHECK Cat #: 57927 Model/Part #: P-8-1697	2	VALVE, CHECK 3/8" SOLDER
A	VALVE Cat #: 85K64 Model/Part #: 85K6401	1	DESUPERHEATING
B	VALVE Cat #: 85K63 Model/Part #: 85K6301	1	HOT GAS BYPASS
C	VALVE-BALL Cat #: 15M40 Model/Part #: 15M4001	1	7/8 X 1 1/8
D	VALVE-CHECK Cat #: 57927 Model/Part #: P-8-1697	2	VALVE, CHECK 3/8" SOLDER
E	VALVE Cat #: 85K63 Model/Part #: 85K6301	1	HOT GAS BYPASS
F	VALVE-SERVICE Cat #: 68J11 Model/Part #: 68J1101	1	LIQUID LINE-5/8 in.
G	VALVE-BALL Cat #: 15M40 Model/Part #: 15M4001	1	7/8 X 1 1/8
HG KIT	HOT GAS BYPASS KIT Cat #: 28M73 Model/Part #: LB-93143D	1	SUCTION-INC NEXT 3 PARTS
HG KT2	HOT GAS BYPASS KIT Cat #: 28M72 Model/Part #: LB-93156D	1	EVAP-INC NEXT 4 PARTS
HG KT3	HOT GAS BYPASS KIT Cat #: 48M59 Model/Part #: LB-93143G	1	INC NEXT 3 PARTS

Callout	Name	Quantity	Description
HG KT4	HOT GAS BYPASS KIT Cat #: 48M60 Model/Part #: LB-93156G	1	INC NEXT 4 PARTS

CABINET PARTS

Callout	Name	Quantity	Description
	HINGE Cat #: 63K26 Model/Part #: 63K2601	1	CONTROL BOX COVER
	SUPPORT Cat #: 47L80 Model/Part #: LB-89949	1	CONTROL BOX COVER
	COVER Cat #: LB-90097 Model/Part #: LB-90097	1	DIS/GFI
	COVER Cat #: LB-90610 Model/Part #: LB-90610	1	DIS OR GFI
1	PANEL Cat #: 93M93 Model/Part #: LB-100952	1	ACCESS-COMP
2	POST-CORNER Cat #: LB-100949 Model/Part #: LB-100949	1	LEFT-FRONT
3/5	POST CORNER Cat #: LB-100951 Model/Part #: LB-100951	2	LEFT/RIGHT REAR
4	POST-CORNER Cat #: LB-100950 Model/Part #: LB-100950	1	RIGHT-FRONT
6	PANEL-TOP Cat #: 45M97 Model/Part #: LB-100340	1	PANEL, TOP
7	GRILLE-DISCHARGE Cat #: 63K60 Model/Part #: 63K6001	1	GRILLE- DISCHARGE
9	GUARD Cat #: 29M2101 Model/Part #: 29M2101	1	OUTDOOR COIL- LEFT SIDE
10	GUARD Cat #: 29M2201 Model/Part #: 29M2201	1	OUTDOOR COIL- REAR
11	COVER-CONTROL BOX Cat #: 40L53 Model/Part #: LB-89781	1	COVER- CONTROL BOX
11	COVER-CONTROL BOX	1	DISCONNECT/GFI

Callout	Name	Quantity	Description
	Cat #: LB-90099 Model/Part #: LB-90099		
12	PANEL Cat #: 67M48 Model/Part #: LB-100953	1	ACCESS-SIDE

CONTROL PANEL PARTS

Callout	Name	Quantity	Description
	GFI Cat #: 79J98 Model/Part #: 79J9801	1	15AMP
	COVER Cat #: 86H85 Model/Part #: 86H8501	2	GFI/DIS
C1	CAPACITOR Cat #: 39H61 Model/Part #: 39H6101	1	"10MFD,370VAC (575V)"
C1	CAPACITOR Cat #: 53H05 Model/Part #: 39H6201	1	"12.5MFD,370VAC (460V & INTL)"
C1	CAPACITOR Cat #: 53H06 Model/Part #: 39H6301	1	"15MFD,370VAC (208-230V)"
DL33	CONTROL-TIMED OFF Cat #: 49K02 Model/Part #: 49K0201	1	TIMER, MINIMUM RUN
K1	CONTACTOR Cat #: 38113 Model/Part #: P-8-7716	1	"3PDT,24V(208-230V)"
K1	CONTACTOR Cat #: 38393 Model/Part #: P-8-7736	1	"3PDT,24V(460V,575V & INTL)"
K10	RELAY Cat #: 67K65 Model/Part #: 67K6501	1	"FAN,DPDT,24V"
K167	RELAY Cat #: 39H98 Model/Part #: 39H9801	1	"DPDT,24V"
S48	SWITCH-DISCONNECT Cat #: 93J31 Model/Part #: 93J3101	1	"80AMP,600V"

COOLING PARTS

Callout	Name	Quantity	Description
	RELAY-OVERLOAD COMP-INTERNAL Cat #: Model/Part #:	1	
	HEATER-CRANKCASE Cat #: 25M06 Model/Part #: 25M0601	1	(208-230V)
	HEATER-CRANKCASE Cat #: 25M07 Model/Part #: 25M0701	1	(460V & 380V)
	HEATER-CRANKCASE Cat #: 25M08 Model/Part #: 25M0801	1	(575V)
	MOUNT PKG-COMP Cat #: 74J30 Model/Part #: 74J3001PR	1	MOUNT PKG-COMP
	FITTING PRESS TAP Cat #: 86G64 Model/Part #: 86G6401	5	FITTING, PRESSURE TAP
	HARNESS-WIRING Cat #: 28W47 Model/Part #: LB-100974	1	COOLING CTL (P36-J36)
	HARNESS-WIRING Cat #: 68M30 Model/Part #: LB-99212C	1	O.D. FAN
	HARNESS-WIRING Cat #: 47M96 Model/Part #: LB-99230C	1	COMP(575V) (MOLDED PLUG)
	HARNESS-WIRING Cat #: 47M98 Model/Part #: LB-99230E	1	COMP(208-230V) (MOLDED PLUG)
	HARNESS-WIRING Cat #: 39M09 Model/Part #: LB-99231C	1	COMP(460V & INTL) (MOLDED PLUG)
	DRIER Cat #: 87326 Model/Part #: P-8-10807	1	DRIER
	VALVE CORE Cat #: 66820 Model/Part #: P-8-1897	5	VALVE, CORE
	CAP-SEAL Cat #: 58114 Model/Part #: P-8-3187	2	CAP, BRASS
	SHIELD-RAIN Cat #: 32621 Model/Part #: P-8-6142	1	SHIELD, MOTOR
15	COIL-OUTDOOR Cat #: 28M66 Model/Part #: LB-100948A	1	W/MANIFOLD

Callout	Name	Quantity	Description
18	VALVE-SERVICE Cat #: 68J11 Model/Part #: 68J1101	1	LIQUID LINE-5/8 in.
20	VALVE-BALL Cat #: 15M40 Model/Part #: 15M4001	1	"SUCTION LINE,7/8""(AFTER-7-12- 01)"
26	FAN Cat #: 16C01 Model/Part #: 16C0101	1	"1/2""BORE,24""DIA,4 BLADE"
29	MOTOR-FAN Cat #: 27J07 Model/Part #: 27J0701	1	"1/2HP,1075RPM,460/60/1 & INTL"
29	MOTOR-FAN Cat #: 27J30 Model/Part #: 27J3001	1	"1/2HP,1075RPM,208- 230/60/1"
29	MOTOR-FAN Cat #: 27J31 Model/Part #: 27J3101	1	"1/2HP,1075RPM,575/60/1"
30	BRACKET Cat #: 63K65 Model/Part #: 63K6501	1	MOUNT-MOTOR
35	COMPRESSOR Cat #: 25M87 Model/Part #: 25M8701	1	"6TON,208- 230/60/3,COPE" (MOLDED PLUG)
35	COMPRESSOR Cat #: 25M88 Model/Part #: 25M8801	1	"6TON,460/60/3,COPE" (MOLDED PLUG)
35	COMPRESSOR Cat #: 25M89 Model/Part #: 25M8901	1	"6TON,575/60/3, COPE" (MOLDED PLUG)
S11	SWITCH-LO AMBIENT Cat #: 18J74 Model/Part #: 18J7401	1	"IN 275PSI, OUT 150PSI"
S4	SWITCH-HI PRESS Cat #: 10M51 Model/Part #: 10M5101	1	CUTOUT 450 PSIG
S87	SWITCH-LO PRESS Cat #: 85C23 Model/Part #: 85C2301	1	"IN 55+5PSI, OUT 25+5PSI"

Note:

There are no technical notes for this product.