



REPAIR PARTS

GSX16 Remote Condensing Unit

GSX160181GA
GSX160241GA
GSX160301GA
GSX160361GA
GSX160421GA
GSX160481GA



This manual is to be used by qualified technicians only.

© 2022 Goodman Manufacturing Company, L.P. ♦ 5151 San Felipe St, Suite 500 ♦ Houston, TX 77056

Important Information

Index

Functional Parts List	3
Illustration and Parts	4 - 9

Views shown are for parts illustrations only, not servicing procedures.

Text Codes:

AR - As Required

NA - Not Available

NS - Not Shown

00000000 - See Note

QTY - Quantity Example (QTY 3) (If Quantity not shown, Quantity = 1)

M - Model Example (M1) (If M Code not shown, then part is used on all Models)

Expanded Model Nomenclature:

Example M1 - Model#1 M2 - Model#2 M3 - Model#3

Goodman Manufacturing Company, L.P. is not responsible for personal injury or property damage resulting from improper service. Review all service information before beginning repairs.

Warranty service must be performed by an authorized technician, using authorized factory parts. If service is required after the warranty expires, Goodman Manufacturing Company, L.P. also recommends contacting an authorized technician and using authorized factory parts.

Goodman Manufacturing Company, L.P. reserves the right to discontinue, or change at any time, specifications or designs without notice or without incurring obligations.

For assistance within the U.S.A. contact:
Homeowner Support
Goodman Manufacturing Company, L.P.
19001 Kermier Road
Waller, Texas 77484
877-254-4729-Telephone
713-863-2382-Facsimile

For assistance outside the U.S.A. contact:
International Division
Goodman Manufacturing Company, L.P.
19001 Kermier Road
Waller, Texas 77484
713-861-2500-Telephone
713-863-2382-Facsimile

Functional Parts

Part

No: Description:

50N382YV-ZAKQ	1.5T RECHI COMPRESSOR (4-LEGS) (M1)
50N492ZV-ZAKM	2.0TONRECHI COMPR.4 LEGS (M2)
0151R00185	BASE VALVE 3/4" (M1, M2)
0151R00187	BASE VALVE 3/8"
0151R00186	BASE VALVE 7/8" (M3, M4, M5)
0151R00182	BASE VALVE 7/8" (M6)
CAP050350440CS	CAPACITOR 5/35/440V (M1)
CAP050400440CT	CAPACITOR 5/40/440V/DUAL RD (M3)
CAP050450440CT	CAPACITOR 5/45/440V/DUAL RD (M2, M4, M5, M6)
0130R00116	CAPACITOR, HARD START (M1, M2)
ZP24K5EPFV130	COMP,24000,208/230/60/1 (M3)
ZP29K5EPFV130	COMP,29000,208/230/60/1 (M4)
ZP34K5EPFV130	COMPRESSOR 34500, 208/230/60/1 (M5)
ZP36K5EPFV130	COMPRESSOR 36200, 208/230/60/1 (M6)
CONT1P030024V	CONTACTOR 30 AMP, 1P, 24V
0150M00008	FAN BLADE, 22" TNT2203-25 (M1, M2, M3, M4)
0150M00066	FAN BLADE, 26" (M5, M6)
0131M00807	MOTOR, 1/4HP,1SP,8PL,AL (M6)
0131M00753	MOTOR, 1/6HP, 1SP, 8PL, AL (M1, M2, M3, M4, M5)
0130M00441	RELAY, HARD START (M1, M2)
0130M00089	SW-CUTOUT HI PRESS (M1, M2)

SPECIAL PARTS

0161R00092 NAMEPLATE, GOODMAN

Expanded Model Nomenclature

M1 - GSX160181GA
M2 - GSX160241GA
M3 - GSX160301GA
M4 - GSX160361GA
M5 - GSX160421GA
M6 - GSX160481GA

Control Box Assembly

CONTROL PANEL
REFERENCE ONLY

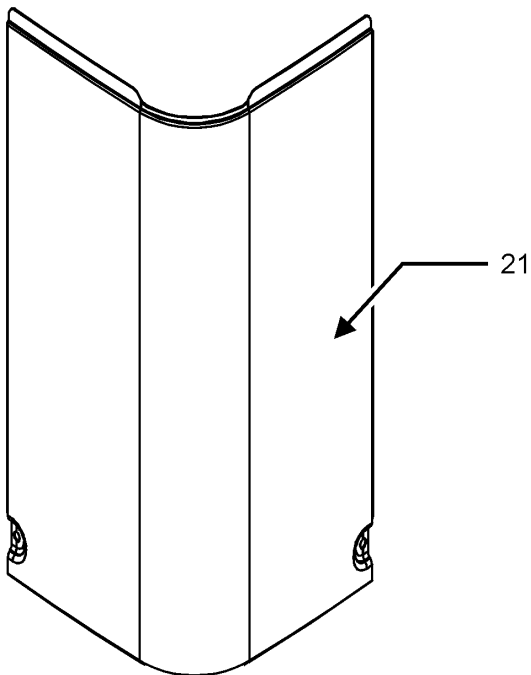
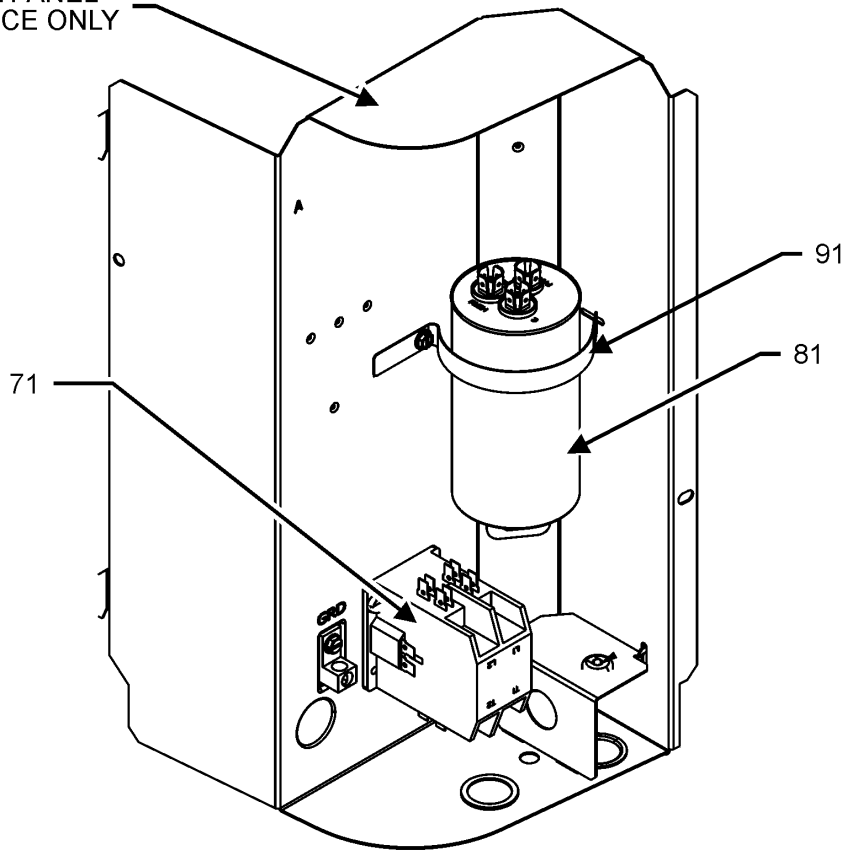

UPPER PANEL ACCESS

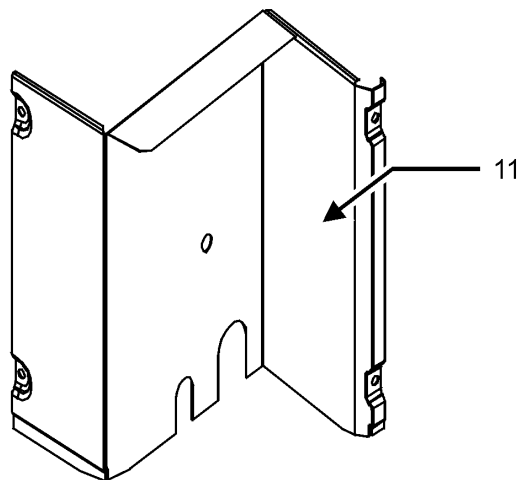

LOWER PANEL ACCESS

Control Box Assembly

Ref. Part No:	No:	Description:	Ref. Part No:	No:	Description:
---------------	-----	--------------	---------------	-----	--------------

Image 1:

11	0121R00909PDG	PNL, LWR ACCESS (M4, M6)
11	0121R00912PDG	PNL, LWR ACCESS (M3, M5)
11	0121R00919PDG	PNL, LWR ACCESS (M1, M2)
21	0121R00937PDG	CONTROL COVER, PNT
71	CONT1P030024V	CONTACTOR 30 AMP, 1P, 24V
81	CAP050350440CS	CAPACITOR 5/35/440V (M1)
81	CAP050400440CT	CAPACITOR 5/40/440V/DUAL RD (M3)
81	CAP050450440CT	CAPACITOR 5/45/440V/DUAL RD (M2, M4, M5, M6)
91	4400065	CAPACITOR STRAP
NS	0130R00116	CAPACITOR, HARD START (M1, M2)
NS	0161R00092	NAMEPLATE, GOODMAN
NS	0130M00441	RELAY, HARD START (M1, M2)

Expanded Model Nomenclature

M1 - GSX160181GA
M2 - GSX160241GA
M3 - GSX160301GA
M4 - GSX160361GA
M5 - GSX160421GA
M6 - GSX160481GA

Cabinet Top and Louver Side Panel Assy

TOP PANEL ASSEMBLY
TOP VIEW

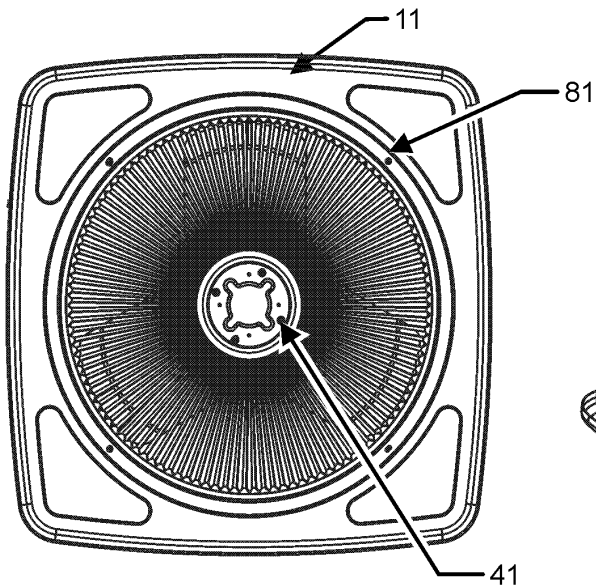

TOP PANEL ASSEMBLY
BOTTOM VIEW

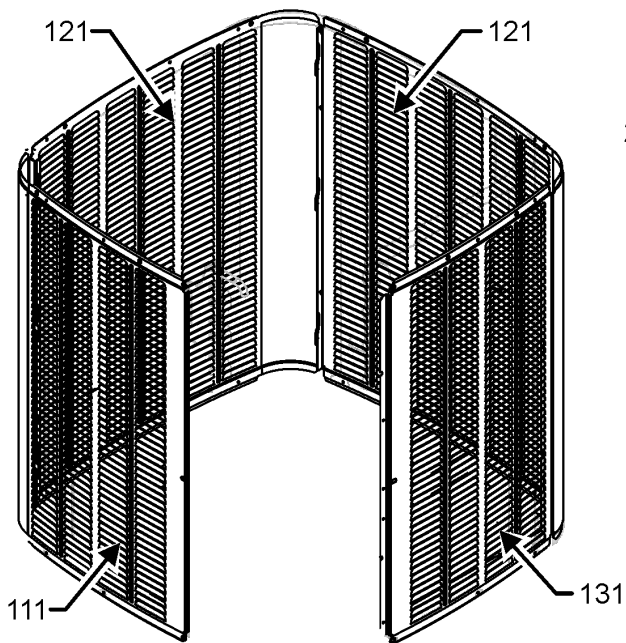
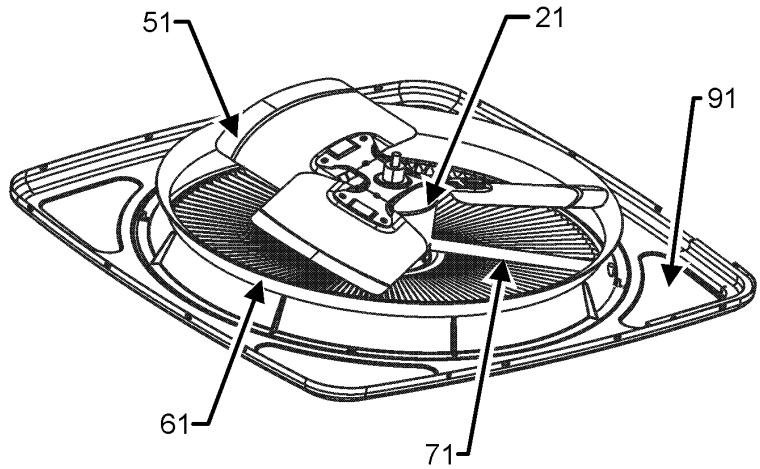

LOUVER PANEL ASSEMBLY
STYLE 1

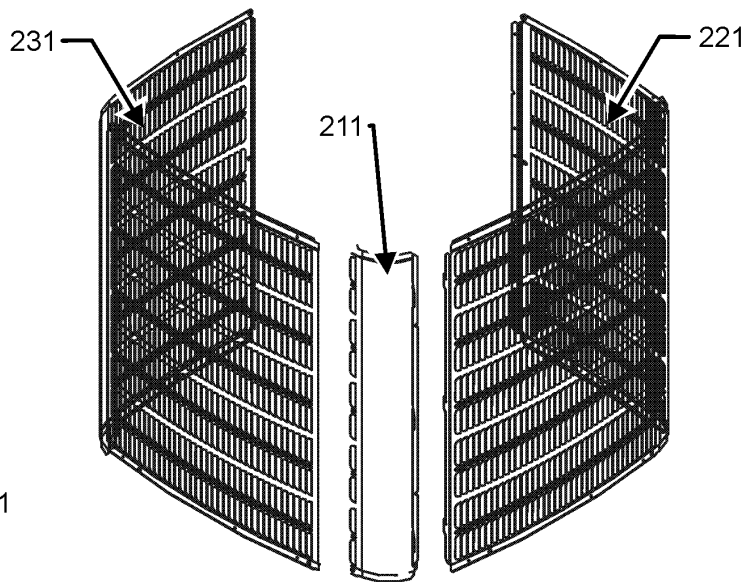

LOUVER PANEL ASSEMBLY
STYLE 2

Cabinet Top and Louver Side Panel Assy

Ref. Part No: No:	Description:	Ref. Part No: No:	Description:
-------------------	--------------	-------------------	--------------

Image 1:

11	0121R00010PDG	TOP PANEL 29" (M1, M2, M3, M4)
11	0121R00269PDG	Top Panel, 35" Pnt (M5, M6)
21	0131M00807	MOTOR, 1/4HP,1SP,8PL,AL (M6)
21	0131M00753	MOTOR, 1/6HP, 1SP, 8PL, AL (M1, M2, M3, M4, M5)
41	0163M00006P	ACORN NUT 5/16 HEX BLACK (QTY 4)
51	0150M00008	FAN BLADE, 22" TNT2203-25 (M1, M2, M3, M4)
51	0150M00066	FAN BLADE, 26" (M5, M6)
61	0161L00000	VENTURI RING 22" (M1, M2, M3, M4)
61	0161R00007P	VENTURI RING 35" (M5, M6)
71	0161R00002P	CONDUIT (M1, M2, M3, M4)
71	0161R00004P	CONDUIT (M5, M6)
81	0163M00004	SCREW #10X3/4", BLACK (QTY 4)
91	0154R00045	GASKET, CONTROL PANEL
111	0121R00228PDGB	LOUVERED SIDE PANEL [LT OF CNTL PNL] (M5)
111	0121R00229PDGB	LOUVERED SIDE PANEL [LT OF CNTL PNL] (M6)
121	0121R00232PDGB	LOUVERED PANEL (M6)
121	0121R00231PDGB	LOUVERED SIDE PANEL (M5)
131	0121R00234PDG	LOUVERED SIDE PANEL [RT OF CNTL PNL] (M5)
131	0121R00235PDG	LOUVERED SIDE PANEL [RT OF CNTL PNL] (M6)
211	0121R00350PDG	Louver Post, PDG 28.73 (M1, M2)
211	0121R00352PDG	Louver Post, PDG 32.51 (M3)
211	0121R00354PDG	Louver Post, PDG 36.30 (M4)
221	0121R00342PDGRS	Louver Panel, PDG 29" _28.73 (M1, M2)
221	0121R00344PDGRS	Louver Panel, PDG 29" _32.51 (M3)
221	0121R00346PDGRS	Louver Panel, PDG 29" _36.30 (M4)
231	0121R00342PDGLS	LOUVERED PANEL (M1, M2)
231	0121R00344PDGLS	LOUVERED PANEL (M3)
231	0121R00346PDGLS	LOUVERED PANEL (M4)
NS	0163M00005P	WASHER, BLACK (.50 OD .218D) (QTY 4)

Expanded Model Nomenclature

M1 - GSX160181GA
M2 - GSX160241GA
M3 - GSX160301GA
M4 - GSX160361GA
M5 - GSX160421GA
M6 - GSX160481GA

Compressor and Tubing Assembly

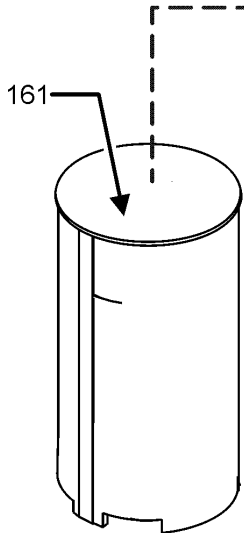
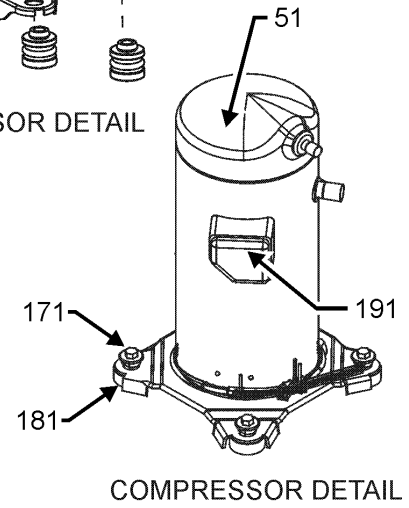
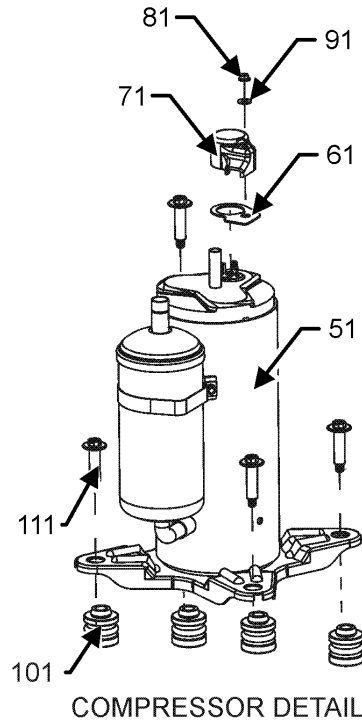
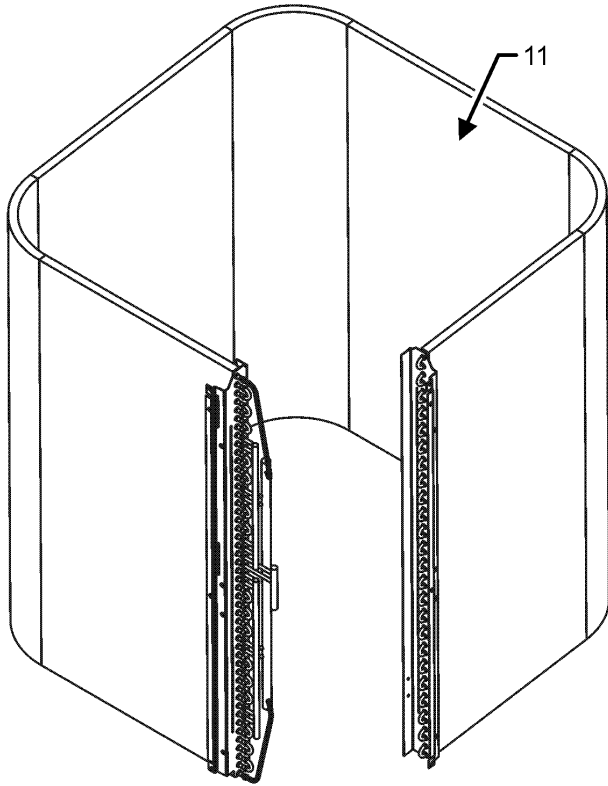

SEE COMPRESSOR
DETAIL

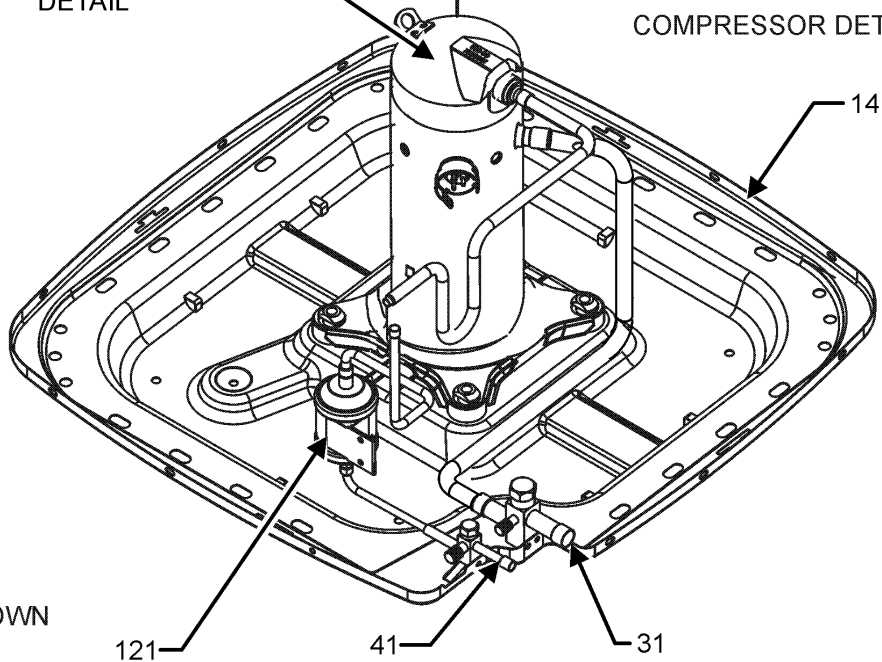

TUBING ASSEMBLY MAY
DIFFER FROM WHAT IS SHOWN

Compressor and Tubing Assembly

Ref. Part No:	Ref. Part No:	Description:	Description:
Image 1:			
11	0201R00236	COIL TUBING ASSY (M4)	
11	0201R00296	COIL TUBING ASSY (M1, M2)	
11	0201R00311	COIL TUBING ASSY (M5)	
11	0201R00315	COIL TUBING ASSY (M3)	
11	0201R00433	COIL TUBING ASSY (M6)	
31	0151R00185	BASE VALVE 3/4" (M1, M2)	
31	0151R00182	BASE VALVE 7/8" (M6)	
31	0151R00186	BASE VALVE 7/8" (M3, M4, M5)	
41	0151R00187	BASE VALVE 3/8"	
51	50N382YV-ZAKQ	1.5T RECHI COMPRESSOR (4-LEGS) (M1)	
51	50N492ZV-ZAKM	2.0TONRECHI COMPR.4 LEGS (M2)	
51	ZP24K5EPFV130	COMP,24000,208/230/60/1 (M3)	
51	ZP29K5EPFV130	COMP,29000,208/230/60/1 (M4)	
51	ZP34K5EPFV130	COMPRESSOR 34500, 208/230/60/1 (M5)	
51	ZP36K5EPFV130	COMPRESSOR 36200, 208/230/60/1 (M6)	
61	60100107	TERMINAL COVER GASKET (M1, M2)	
71	60100317	TERMINAL COVER (M1, M2)	
81	60100401	TERMINAL NUT - RECHI COMP (M1, M2)	
91	60100201	WASHER - RECHI COMPRESSOR (M1, M2)	
101	60140209	GROMMET - RECHI COMPRESSOR (M1, M2)	
111	0163M00186	SCREW-SHOULDER TF (M1, M2)	
121	0162R00057	FILTER DRIER	
141	0121R00006PDG	BASE PAN 29" (M1, M2, M3, M4)	
141	0121R00007PDG	BASE PAN 35" (M5, M6)	
161	0160M00036	COMPRESSOR BLANKET (M1, M2)	
171	M0221641	TF SHOULDER SCREW (M3, M4, M5, M6)	
181	B1339533	COMPRESSOR GROMMET (M3, M4, M5, M6)	
191	0159R00001P	HARNESS, COMP SCROLL 130 42" (M3, M4)	
191	0159R00002P	HARNESS, COMP SCROLL 130 46" (M5, M6)	
NS	B1789853	FLOW CHECK PISTON KIT (M1)	
NS	B1789865	FLOW CHECK PISTON KIT (M3)	
NS	B1789872	FLOW CHECK PISTON KIT (M4)	
NS	B1789874	FLOW CHECK PISTON KIT (M5)	
NS	B1789878	FLOW CHECK PISTON KIT (M6)	
NS	B1789860	KIT, FLOW CHECK PISTON (M2)	
NS	0163M00004	SCREW,#10X3/4",BLK (QTY 4)	
NS	0130M00089	SW-CUTOUT HI PRESS (M1, M2)	

Expanded Model Nomenclature

M1 - GSX160181GA
M2 - GSX160241GA
M3 - GSX160301GA
M4 - GSX160361GA
M5 - GSX160421GA
M6 - GSX160481GA