



BASO Gas Products LLC

G196 Series BASOTROL® Combination Gas Valve with Manual Shutoff Valve



Description

The G196 Series valve is a combination, dual operator, automatic gas valve with a pressure regulator and manual "A" valve. Typical applications include unit heaters, rooftop units, agricultural heaters, commercial cooking equipment, and similar applications. The G196 can be used with natural gas or LP gas at pressures up to 0.5 psi and comes with an adjustable regulator which is field convertible with a conversion kit. The G196 is available with various voltages and cover options.

Specifications

- Maximum inlet pressure is 0.5 psi
- Natural Gas Capacity Btu/hr at 1 in. pressure drop is 175,000 (G196NGH-1 is 155,000)
- Permissible ambient (surface) temperature is -20 to 175°F (-29 to 79°C)

Agency Listing

- CSA (AGA/CGA) Certificate Number 229521-1656041
- Australian Gas Association Certificate Number 3495

Electrical Connections

- #18 AWG stranded wire or 1/4 in. male quick-connect terminals

To Order

To order genuine BASO products, call 1-877-227-6427 (1-877-BASOGAS). Specify the code number from the following selection chart. The G196 valves are factory set for either natural gas or LP gas. Order the correct model for your requirements.

Other configurations can be made available. Contact BASO Gas Products for availability of products not shown.

Selection Chart

| Code Number | Inlet and Outlet Female NPT | VAC (60 Hz) | Pilot Tap (in.) NPT | Pressure Tap (in.) NPT | Regulator Adjustment Location | Electrical Connection |
|-------------|-----------------------------|-------------|-----------------------|------------------------|-------------------------------|-----------------------|
| G196HGH-2 | 1/2 in. x 1/2 in. | 25 | 1/4 cc right | 1/8-27 bottom | Bottom | 1/4 in. male spade |
| G196HGH-7 | | 25 | 1/8-27 left and right | 1/8-27 bottom | Bottom | 18 in. leads |
| G196HGK-2 | | 25 | 1/8-27 left and right | 1/8-27 bottom | Bottom | 18 in. leads |
| G196JGA-1 | 1/2 in. x 3/4 in. | 25 | 1/8-27 left and right | 1/8-27 bottom | Top right | 1/4 in. male spade |
| G196NGH-1 | 1/2 in. x 3/8 in. | 25 | 1/4 cc right | 1/8-27 bottom | Bottom | 1/4 in. male spade |

Conversion Kit Selection Chart

| Conversion Kit | Regulator Adjustment Location | Part Number |
|--|-------------------------------|-------------|
| Conversion Kit for 6 to 12 in. W.C. (15 to 30 mbar) Regulation | Top | Y71GF-4 |
| Conversion Kit for 3 to 6 in. W.C. (7.5 to 15 mbar) Regulation | Top | Y71QH-2 |
| Conversion Kit for 8 to 12 in. W.C. (20 to 30 mbar) Regulation | Bottom | Y71GF-3 |
| Conversion Kit for 3 to 6 in. W.C. (7.5 to 15 mbar) Regulation | Bottom | Y71QH-3 |

2.948 Turning
74.87 Radius

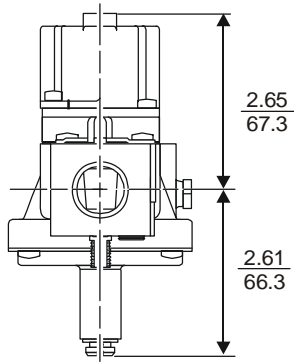

**Inlet View
Bottom Adjust Regulator**

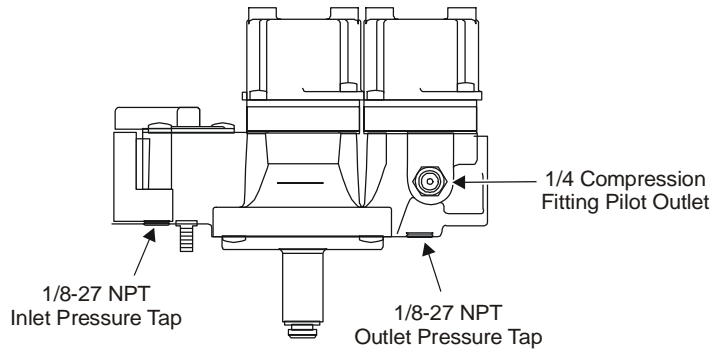

**Right Side View
Bottom Adjust Regulator**

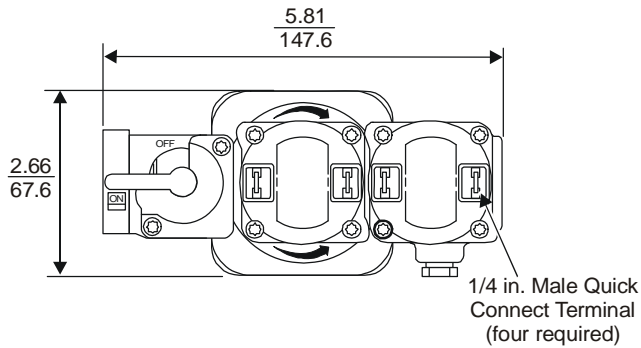

**Top View
Top Adjust Regulator**

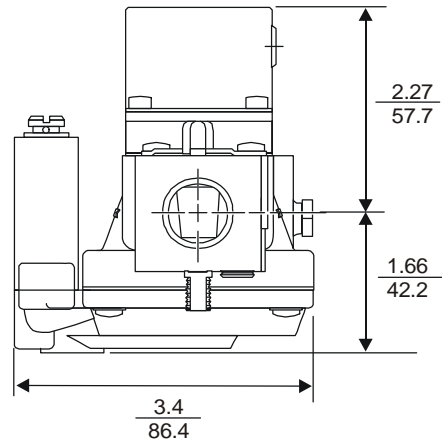

**Inlet View
Top Adjust Regulator**

G196 Dimensions (in./mm)

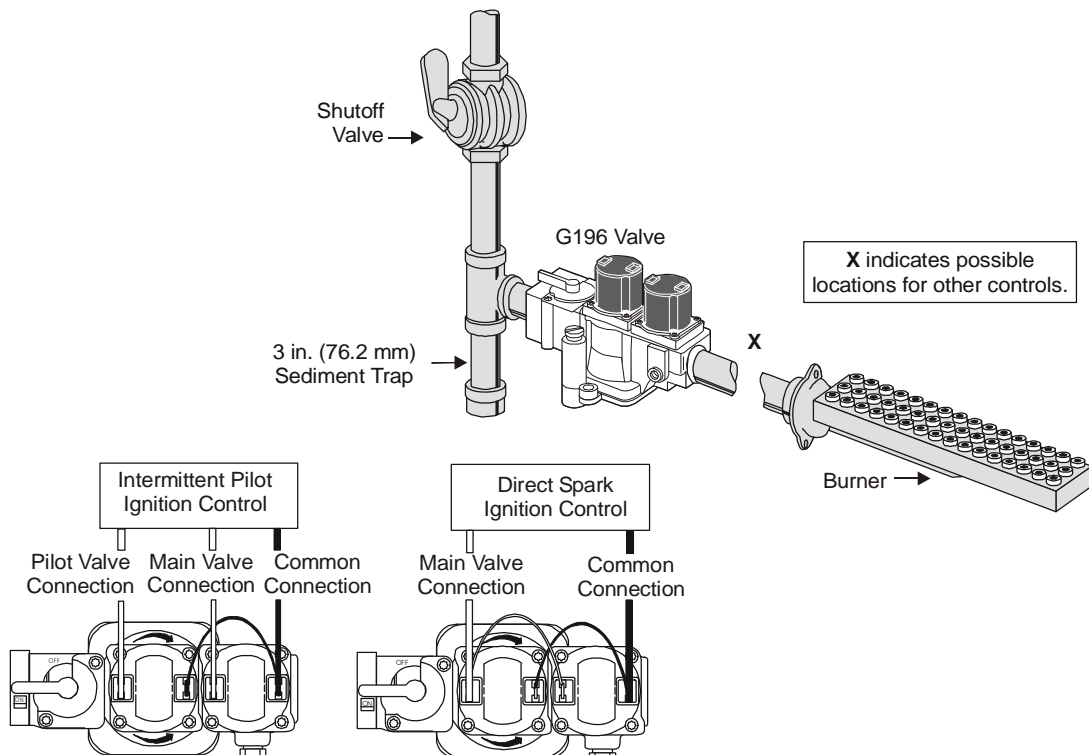

Typical G196 Installation and Wiring