

## For Residential and Commercial Applications

Job Name \_\_\_\_\_

Contractor \_\_\_\_\_

Job Location \_\_\_\_\_

Approval \_\_\_\_\_

Engineer \_\_\_\_\_

Contractor's P.O. No. \_\_\_\_\_

Approval \_\_\_\_\_

Representative \_\_\_\_\_

# LEAD FREE\*

## Series 605T, 605C

### 2-Piece, Full Port, Brass Ball Valves

Sizes: 1/4" – 3"

Series 605T, 605C 2-Piece, Full Port, Brass Ball Valves are suitable for a full range of liquids and gases in residential and commercial applications.

These valves feature an adjustable packing for longer service life, a bottom loaded blow-out proof stem for safety, a fluorocarbon elastomer stem O-ring to prevent stem leaking at installation, and are rated to 600psi WOG/150psi WSP 1/4"– 3".

#### Features

- CSA approved threaded valves only 1/4" – 3"
- Certified to NSF/ANSI Standard 61/8
- Metal-to-metal adapter body seal to eliminate adapter leaks after soldering
- Adjustable stem packing gland provides longer service life
- Bottom loaded blowout proof stem
- PTFE stem packing seal and seats
- Machined chrome plated Lead Free brass ball for sizes 1/4" - 1" and stainless steel for sizes 1 1/4" - 3"
- Complies with MSS-SP-110

#### Models

605T 1/4" – 3" threaded end connections

605C 1/2" – 3" solder end connections\*

#### Specifications

Approved valves shall be 2-piece full port design constructed of a forged Lead Free brass body and end adapter. Seats and stem packing shall be PTFE. Stem to be bottom-loaded, blowout proof design with a fluorocarbon elastomer O-ring to prevent stem leakage. Valves required to have an adjustable packing gland and 1/2" - 1" chromed plated Lead Free brass ball and stainless steel for 1 1/4" - 3". Threaded valves 1/4" – 2" shall be CSA approved to 1/2 psig and 5 psig and certified to NSF/ANSI Standard 61/8. Solder valves also required to be certified to NSF/ANSI Standard 61/8. Valve sizes 1/4" – 2" pressure rated to 600 psi WOG and 150 psi WSP. Sizes 2 1/2" - 3" pressure rated to 400 psi WOG and 125psi WSP.



#### Approvals

1/4" – 3"

1/2" – 3"

Certified to NSF/ANSI Standard 61/8



#### Gas Approvals (Threaded Valves Only)

1/4" – 2"

CSA

1/2 psig, 5 psig

@ -40°F to 125°F



#### Pressure – Temperature

Temperature Range: -40°F to 400°F (-40°C to 204°C)

Pressure Rating: 1/4"– 3"

600psi (41.4 bar) WOG non-shock

150psi (10.3 bar) WSP

2 1/2"– 3"

400psi (27) WOG non-shock

125psi WSP

#### Installation Information

Apply heat with the flame directed **AWAY** from the center of the valve body. Excessive heat can harm the seats. After soldering, the packing nut may have to be tightened.

\*This valve is designed to be soft soldered into lines without disassembly, using a low temperature solder to 420°F (216°C). Higher temperature solders may damage the seat material.

\*The wetted surface of this product contacted by consumable water contains less than 0.25% of lead by weight.



## Materials

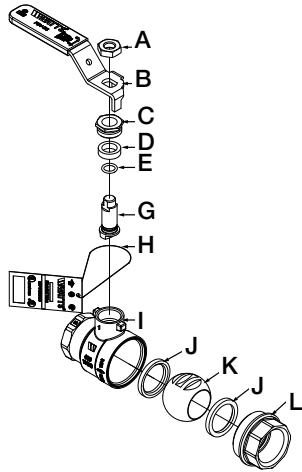

- |                           |  |
|---------------------------|--|
| <b>A. Handle Nut</b>      | Zinc plated carbon steel                                     |
| <b>B. Handle Assembly</b> | Zinc plated carbon steel with vinyl insulator                |
| <b>C. Packing Nut</b>     | Brass  |
| <b>D. Stem Packing</b>    | Virgin PTFE  |
| <b>E. O-Ring</b>          | EPDM   |
| <b>G. Stem</b>            | Lead Free brass  |
| <b>H. Tag</b>             | Cardboard, Mylar coated both sides                           |
| <b>I. Body</b>            | Forged Lead Free brass                                       |
| <b>J. Seats</b>           | Virgin PTFE  |
| <b>K. Ball</b>            | Lead Free brass (1/4" - 1")<br>Stainless steel (1 1/4" - 3") |
| <b>L. Adaptor</b>         | Forged brass   |

## Dimensions-Weights

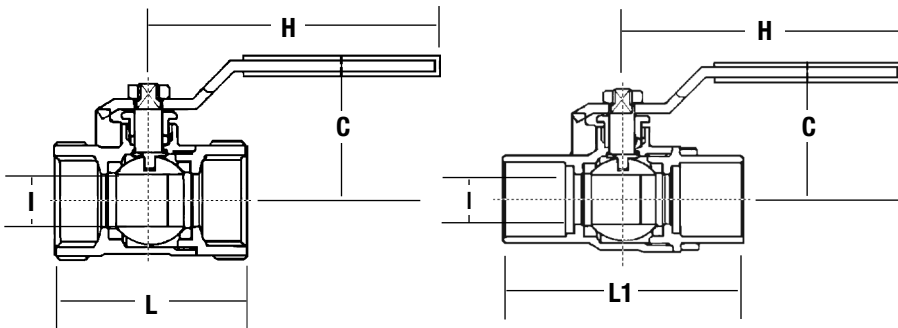

SIZE	C		H		I		L		L1	
in.	in.	mm	in.	mm	in.	mm	in.	mm	in.	mm
1/4	1 13/16	46	3 7/16	87	7/16	11	1 3/4	45	—	—
3/8	1 13/16	46	3 7/16	87	1/2	13	1 3/4	45	—	—
1/2	1 3/8	36	3	78	1/2	13	2	52	1 7/8	50
3/4	1 1/2	39	4 1/8	105	1 1/16	18	2 5/16	59	1 13/16	69
1	1 13/16	45	4 3/16	105	1 5/16	24	2 13/16	71	3 3/16	83
1 1/4	1 7/8	50	4 15/16	125	1 3/16	30.5	3 3/16	80	3 3/16	92
1 1/2	2 1/2	63	4 15/16	125	1 3/8	37	3 1/2	89	4 5/16	109
2	2 11/16	68	7	180	1 7/8	49.5	4 3/16	107	5 5/16	136
2 1/2	4 5/8	118	9 3/8	240	2 5/8	67	5 5/8	141	6 1/2	164
3	5	128	9 3/8	240	3 1/8	79.5	6 3/8	162	7 1/2	191