



www.esbe.eu

Distributed by Danfoss in North America  
www.NA.Heating.Danfoss.com



**SERIES CRA112**  
**Setpoint Temperature Controller**



**NO.1 IN HYDRONIC SYSTEM CONTROL**

Mtrl.nr: 9814 09 32 Ritn.nr: 8419 utg. A • Rev. 1506



Series CRA112

CE  
LVD 2006/95/EC  
EMC 2004/108/EC  
RoHS 2002/95/EEC

Ambient temp:	23°F to 131°F (-5°C to 55°C)
Flow temp. range:	41°F to 200°F (5°C to 95°C)
Power supply:	24 ± 10%, 60 Hz
Power consumption:	3VA
Max run time at max speed:	30 seconds
Weight:	2 lbs (0,9 kg)
Torque:	53.1 in.lbs (6 Nm)
Enclosure rating:	NEMA 2 (IP41)

Mountable to ESBE 3MG, 4MG, Type G and VRG valves up to 2"

**1** Temperature Sensor Installation

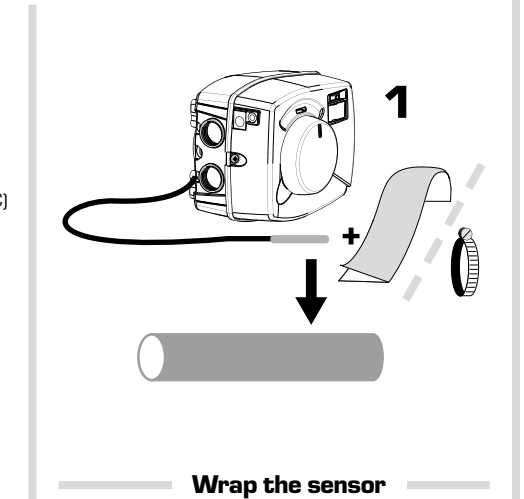

**Wrap the sensor**

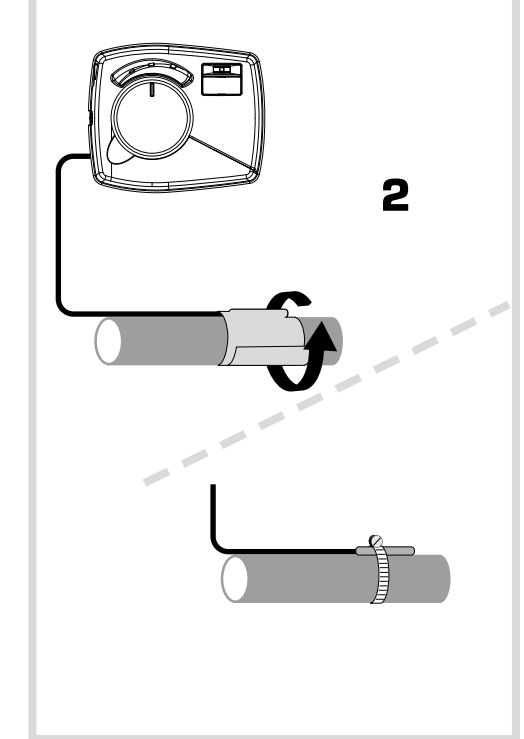

**2**

**2** Selection Operation

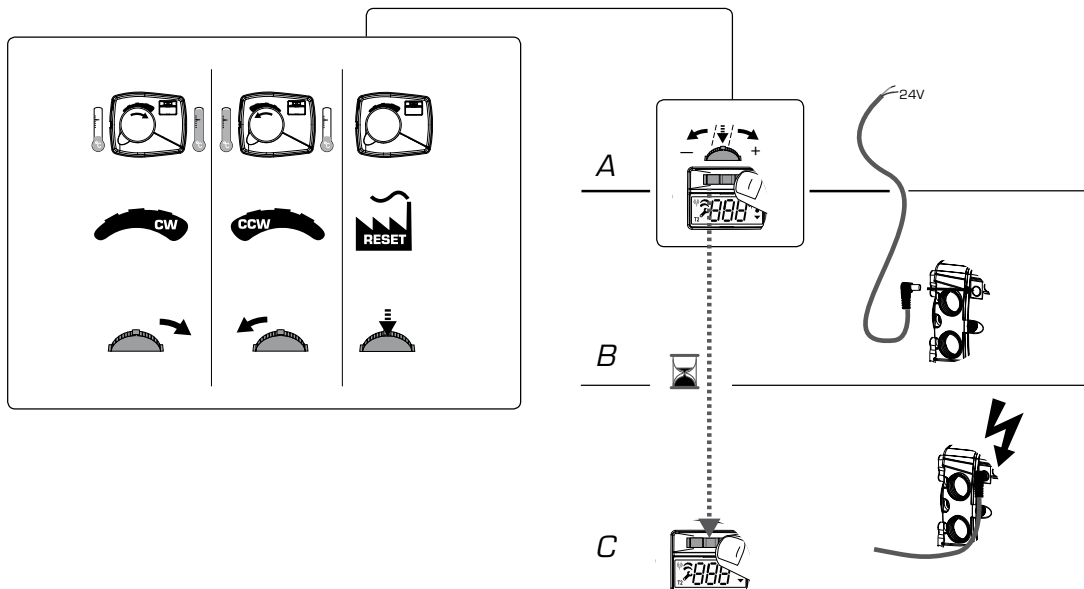

**Start up**

1. Set the required rotation of the controller by pushing the rocker to the right for clockwise opening or left for counter clockwise opening [A].
2. Keep the rocker in the desired direction and connect power [B].
3. Wait 2 seconds before releasing the rocker [C], the desired controller rotation is now set.



### Maximum Temperature Limitation



= MAX °F

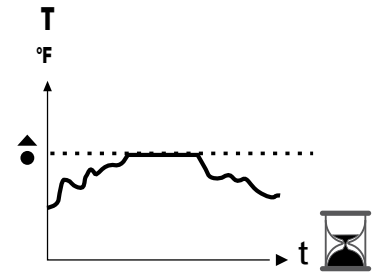
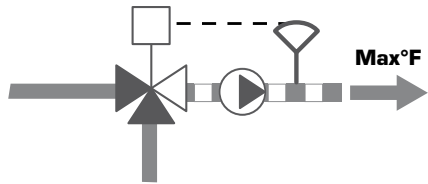

Default: 120°F (49°C)

Maximum temperature setting: 200°F (95°C)

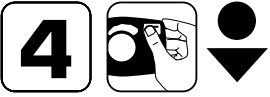
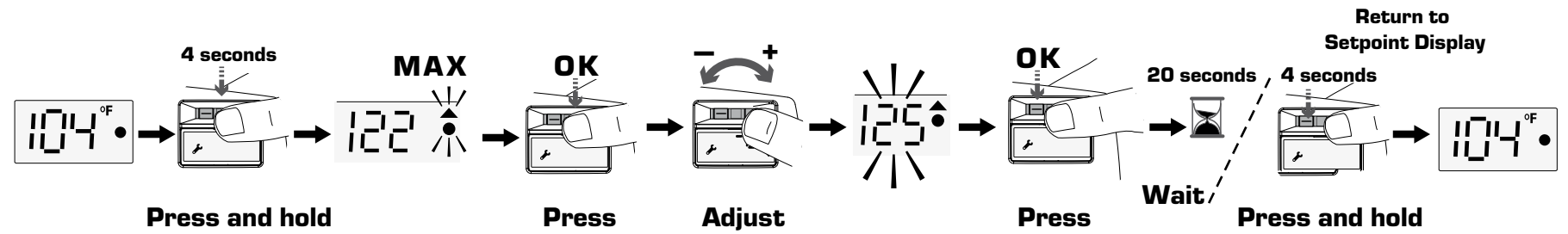

### Minimum Temperature Limitation



= MIN °F

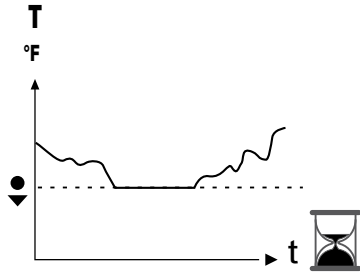
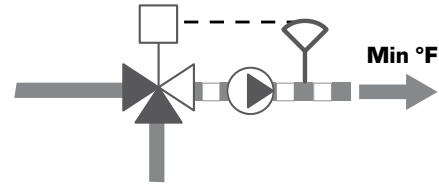

Default: 41°F (5°C)

Minimum temperature setting: 41°F (5°C)

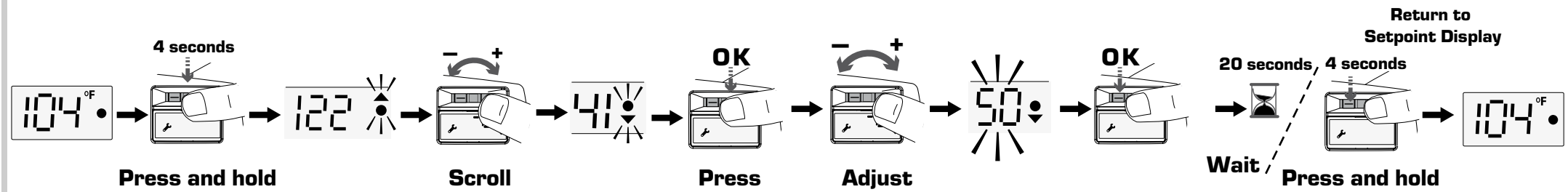

**5** **T**

**Changing of Setpoint, Primary**

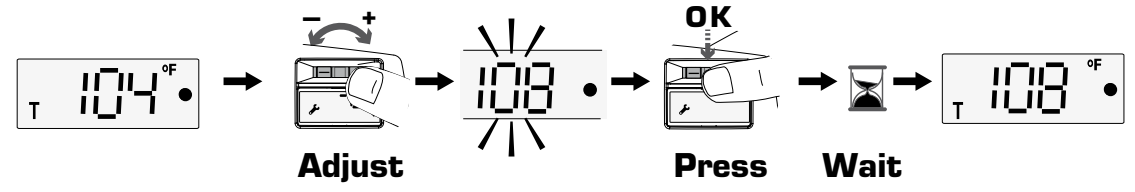
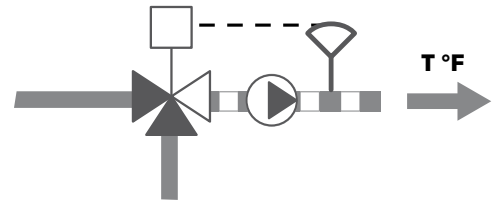
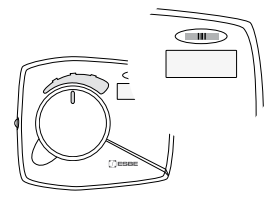

**i**

**°F / °C Temperature Unit Display**

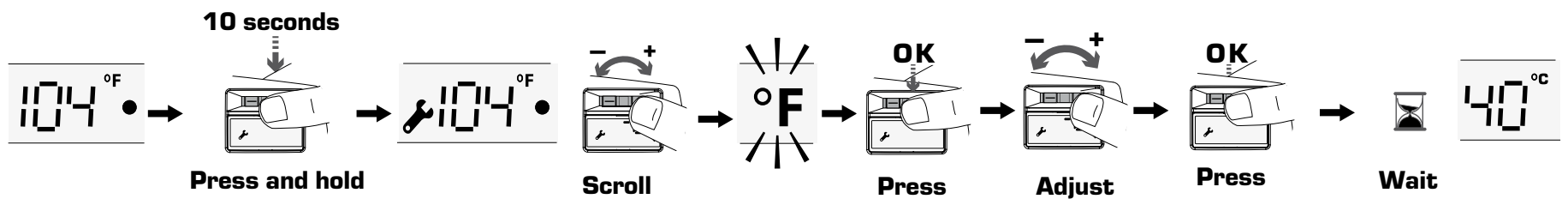

6



# T2 - Secondary Temperature Setpoint (activated by external signal)



**Remove power to the actuator!**

Externally Wired Relay

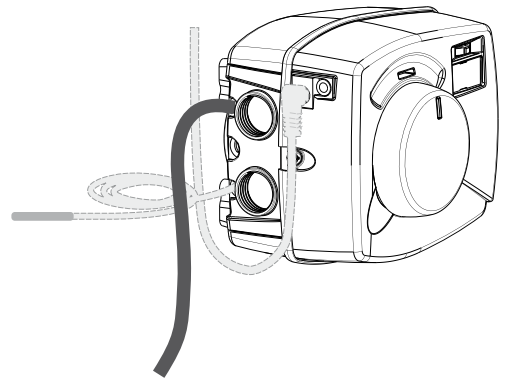
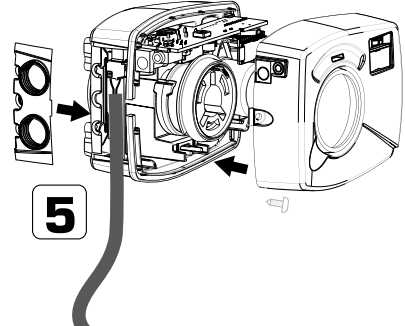
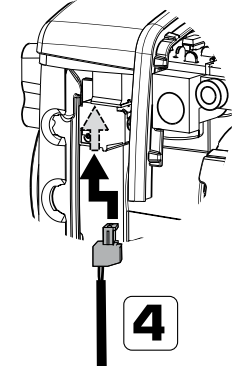
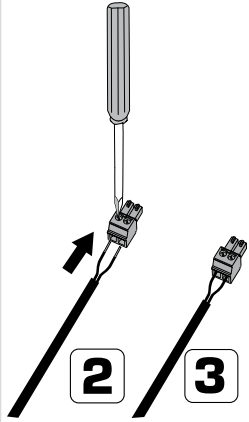
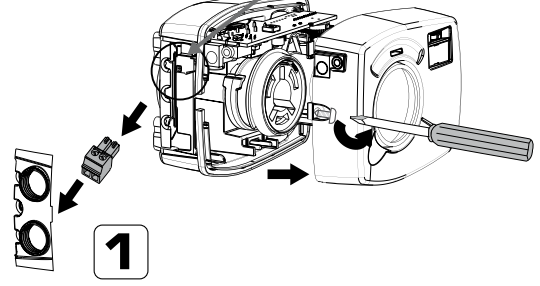
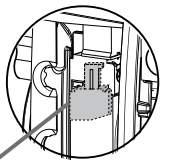

## Changing of Setpoint Secondary Temperature

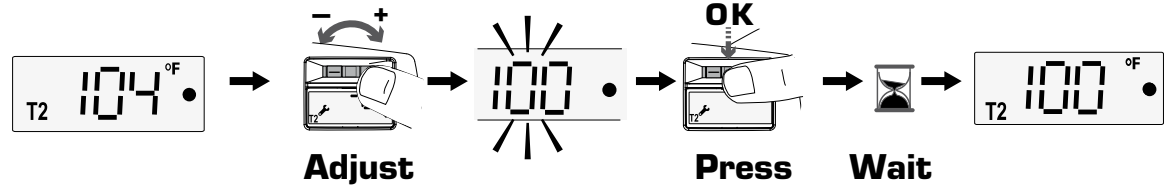
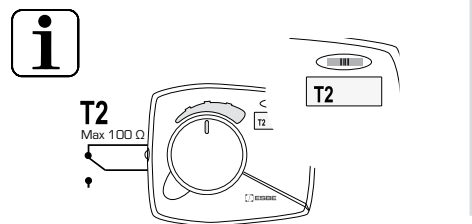

# T

## Changing of Setpoint Primary Temperature

