

Danfoss



Danfoss Inc.
6711 Mississauga Road, Suite 410
Mississauga, ON, L5N 2W3
Tel.: 905-285-2050, Fax: 905-285-2055

Danfoss Inc.
7941 Corporate Drive
Baltimore, MD 21236 USA
Tel.: 443 512 0266, Fax: 443 512 0270



4 Way Valves Type G & F

For Mixing & Diverting Applications



www.na.heating.danfoss.com

Typical Installation

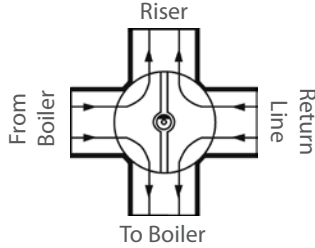
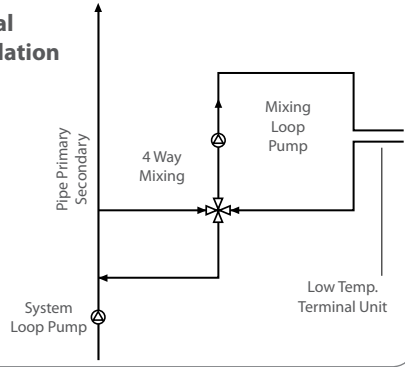

The ESBE 4-way valves are designed for use in commercial or residential heating and cooling systems, to control and distribute water or non-corrosive liquids to different zones.

The ESBE four-way valve features a double mixing function. When hot water from the boiler is mixed with the return water, the temperature of the returned water rises (higher than can be achieved with a 3-Way valve), reducing the risk of condensation and assuring a longer life of the boiler.

The mixing proportions can be adjusted manually, or in automatically controlled applications, by means of a control motor. The scale is graduated on both sides and can be turned, allowing a choice of mounting positions.

Technical Data:

- Valve Body: Cast Iron
- Stem: Stainless Steel
- Slider: Brass
- Bonnet: Cast Iron
- O-rings: EPDM
- Sizes: 1-1/2" to 6"
- Max. Pressure: 90psi (6bar)
- Max. Differential Pressure Drop: 8psi (50kPa) 1-1/2" to 2", 5psi (30kPa) 2-1/2" - 6"
- Max. Temperature: 230°F (110°C)
- Leakage in % of flow: 1.5%

Required Motor Torque:

- Valve size max. 2" - 45in.lb.
- Valve size max. 4" - 85in.lb.
- Valve size max. 6" - 130in.lb.

Valve Characteristics

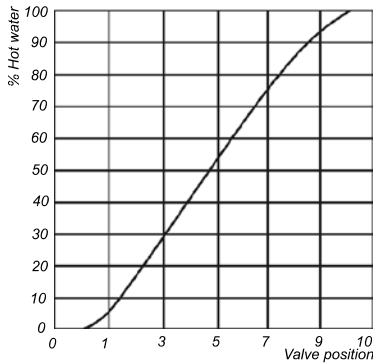

Capacity Diagram

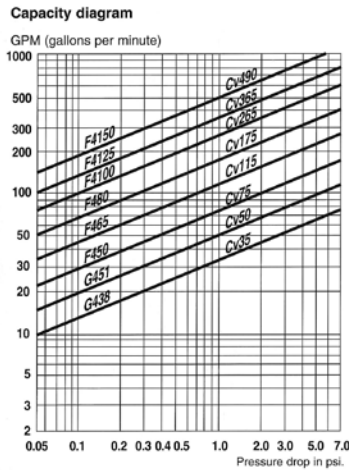

Type G
With threaded connections

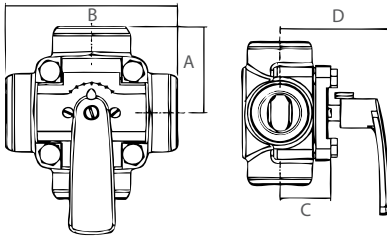

Type F
With flanged connections

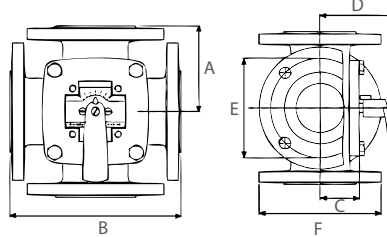

Ordering Information:

Code No.	Reference	Connections	A	B	C	D	E	F	Weight in lbs
065B8979	4 G 40	1-1/2" NPT	2.4"	4.7"	1.5"	3.2"	-	-	6.6
065B8980	4 G 50	2" NPT	3.1"	6.1"	1.8"	3.5"	-	-	11.0
065B6150	4 F 50	2" Flanged	3.8"	7.7"	2.0"	3.6"	4.3"	5.5"	24.3
065B6165	4 F 65	2-1/2" Flanged	3.9"	7.9"	2.0"	3.6"	5.1"	6.3"	26.9
065B6180	4 F 80	3" Flanged	4.7"	9.4"	2.6"	4.3"	5.9"	7.5"	44.1
065B6200	4 F 100	4" Flanged	5.2"	10.4"	3.2"	4.9"	6.7"	8.3"	55.1
065B6225	4 F 125	5" Flanged	5.9"	11.8"	3.2"	4.9"	7.9"	9.4"	77.2
065B6050	4 F 150	6" Flanged	6.9"	13.8"	3.5"	5.2"	8.9"	10.4"	99.2

