

Commercial 12.5 Ton 2-Speed Package Heat Pump

DCH1500163VJXAAB
DCH1500164VBBXAB
DCH1500164VWDDAB
DCH1500303VHXXAB
DCH1500303VWXXAB
DCH150XXX3V1DDAB
DCH150XXX3VRXNAB
DCH150XXX3VXXXAA
DCH150XXX3VXXXAB
DCH150XXX4VFXXAB
DCH150XXX4VHXAAB
DCH150XXX4VHXNAB
DCH150XXX4VXDBAB
DCH150XXX4VXXOAB
DCH150XXX4VXXXAA
DCH150XXX4VXXXAB
DCH150XXX7VXXXAA
DCH150XXX7VXXXAB



This manual is to be used by qualified technicians only.

This manual replaces RP-D1046H.

© 2013 - 2014, 2016 - 2019 **DAIKIN COMPANY, L.P.** ♦ 5151 San Felipe St, Suite 500 ♦ Houston, TX 77056

Important Information

Index

Functional Parts List	3
Illustration and Parts	4 - 15

Views shown are for parts illustrations only, not servicing procedures

Text Codes:

AR - As Required

NA - Not Available

NS - Not Shown

00000000 - See Note

QTY - Quantity Example (QTY 3) (If Quantity not shown, Quantity = 1)

M - Model Example (M1) (If M Code not shown, then part is used on all Models)

Expanded Model Nomenclature:

Example M1 - Model#1 M2 - Model#2 M3 - Model#3

Daikin Company, L.P. is not responsible for personal injury or property damage resulting from improper service. Review all service information before beginning repairs.

Warranty service must be performed by an authorized technician, using authorized factory parts. If service is required after the warranty expires, Daikin Company, L.P. also recommends contacting an authorized technician and using authorized factory parts.

Daikin Company, L.P. reserves the right to discontinue, or change at any time, specifications or designs without notice or without incurring obligations.

For assistance within the U.S.A. contact:

Equipment Support
Daikin North America, LLC
19001 Kermier Road
Waller, Texas 77484
855-770-5678-Telephone
713-863-2382-Facsimile

For assistance outside the U.S.A. contact:

International Division
Daikin North America, LLC
19001 Kermier Road
Waller, Texas 77484
713-861-2500-Telephone
713-863-2382-Facsimile

Functional Parts

Part No: **Description:**

Part No:	Description:	Expanded Model Nomenclature
03-78497	BLOWER WHEEL	M1 - DCH150XXX3VRXNAB
CAP100000370LA	CAPACITOR 10/370V (M1, M2, M3, M4, M5, M6, M7, M8, M9, M10, M11, M14, M15, M16, M17, M18)	M2 - DCH150XXX3VXXXAA
CAP050000370LA	CAPACITOR 5/370V (M12)	M3 - DCH150XXX3VXXXAB
CAP050000440LA	CAPACITOR 5/440V (M13)	M4 - DCH150XXX3V1DDAB
ZP67KCETFD130	COMP, 67000,460/60/3 (M5, M6, M7, M8, M9, M10, M11, M15, M16)	M5 - DCH150XXX4VFXXAB
ZP67KCETF5130	COMP, 67500,200/230/60/3 (M1, M2, M3, M4, M14, M17, M18)	M6 - DCH150XXX4VHXAAB
ZP67KCETFE130	COMP, 67500,575/60/3 (M12, M13)	M7 - DCH150XXX4VHXNAB
0131M00430	COND MOTOR 1/3 HP, 1 SP, 6 PL (M1, M2, M3, M4, M14, M17, M18)	M8 - DCH150XXX4VXDBAB
0131M00179	COND MOTOR 1/3 HP, 6 PL, 575V (M12)	M9 - DCH150XXX4VXXOAB
CONT3P030024V	CONTACTOR 30 AMP, 3P, 24V (QTY 4)	M10 - DCH150XXX4VXXXAA
CONT2P040024V	CONTACTOR 40 AMP, 2P, 24V	M11 - DCH150XXX4VXXXAB
0130M00104	CONTROL, DEFROST	M12 - DCH150XXX7VXXXAA
0130M00103	CONTROL, DEFROST	M13 - DCH150XXX7VXXXAB
PCBDM101	DEFROST CONTROL BOARD	M14 - DCH1500163VJXAAB
0130L00112	Duct Temp Sensor (M1, M5, M15)	M15 - DCH1500164VBBXAB
PCBFM103	ELECTRONIC BLOWER TIME DELAY	M16 - DCH1500164VWDDAB
0164L00019	FAN BELT, NOTCHED	M17 - DCH1500303VHXXAB
10625733	FAN BLADE 22" ALUM CCW (QTY 2)	M18 - DCH1500303VWXXAB
0130M00074	HIGH PRESSURE SWITCH (QTY 2)	
0130M00075	LOW PRESSURE SWITCH (QTY 2)	
0131M00774	MOTOR, 1/3 HP, OD (M5, M6, M7, M8, M9, M10, M11, M15, M16)	
0131M00858	MOTOR, 1/3 HP, OD (M13)	
0131L00024	MOTOR, 3 HP BELT DRIVE 230V (M1, M2, M3, M4, M14, M17, M18)	
0131L00030	MOTOR, 3 HP BELT DRIVE 460 V (M5, M6, M7, M8, M9, M10, M11, M15, M16)	
0131L00027	MOTOR, 3 HP BELT DRIVE 575 V (M12, M13)	
0130L00108	OD Air Temp Sensor (M1, M5, M15)	
PCBCG103	PCB, CONTROL, HP, GAS ,AC (M1, M5, M15)	
10135604	RELAY (QTY 4)	
0130M00242	RELAY, 24V (QTY 3)	
0151R00070	REVERSING VALVE (QTY 2)	
0130M00274	TERMINAL BOARD (M1, M5, M15)	
0130M00275	TERMINAL BOARD (M1, M5, M15)	
0130M00038	TERMINAL BOARD	
0130M00594	TRANSFORMER (M1, M2, M3, M4, M14, M17, M18)	
0130M00148	TRANSFORMER 575V to 24V, 75VA (M12)	
0130M00595	TRANSFORMER, 75VA, 480V TO 24V (M5, M6, M7, M8, M9, M10, M11, M15, M16)	
0130M00598	TRANSFORMER, 75VA, 575V TO 24V (M13)	

Cabinet Assembly

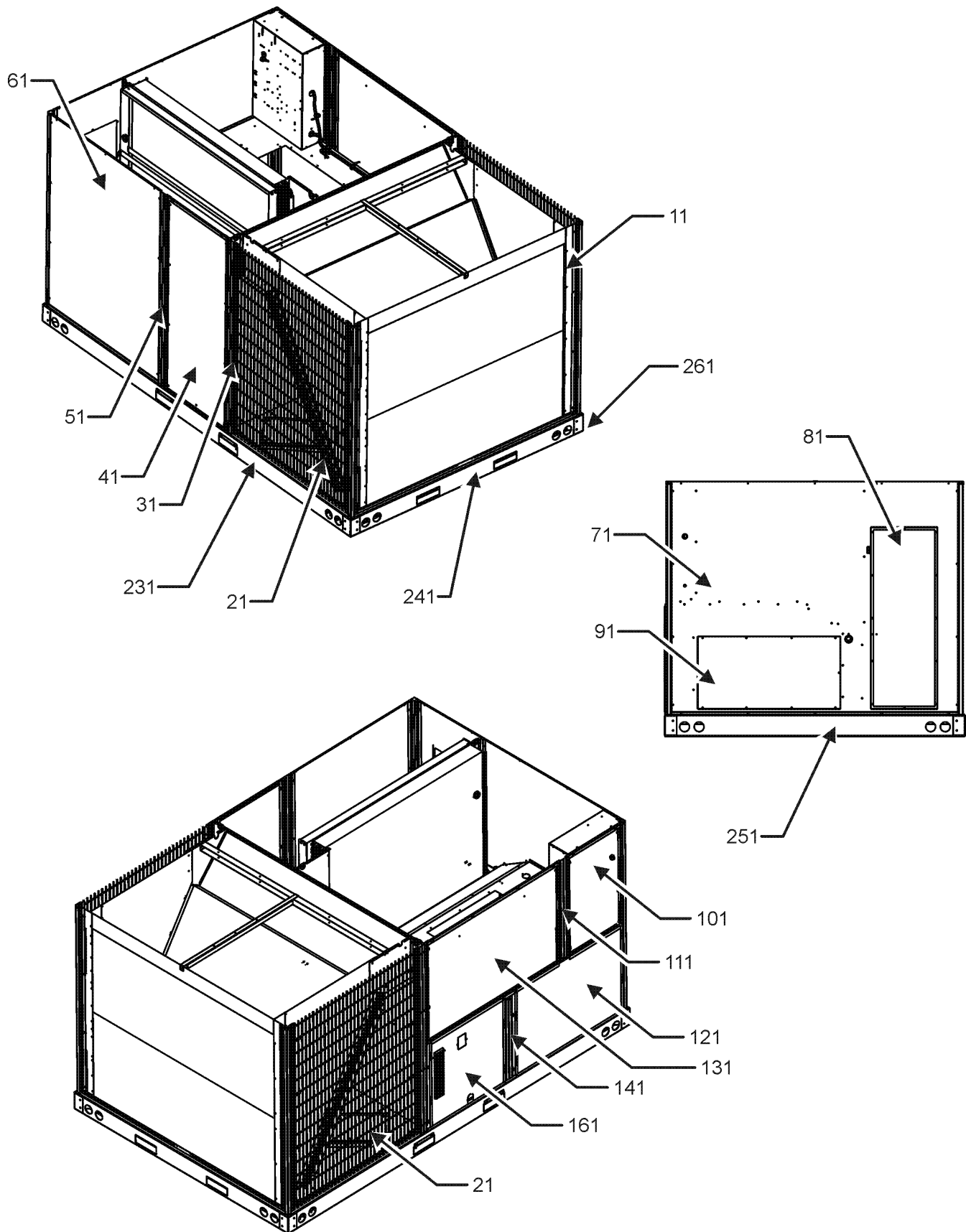

Cabinet Assembly

Ref. Part

No: No: Description:

Ref. Part

No: No: Description:

Image 1:

11	0121L00979RFNG	CORNER POST (QTY 4)
11	0121L01421RFNG	CORNER POST, RF PAINTED (M4, M8, M16)
21	0152L00001	GRILLE-CONDENSER (QTY 2)
31	0121L00980RFNG	ROLL FORM SIDE POST (M1, M2, M3, M5, M6, M7, M9, M10, M11, M12, M13, M14, M15, M17, M18)
31	0121L01423RFNG	SIDE POST (M4, M8, M16)
41	0121L00759NG	FILTER DOOR
51	0121L00757RFNG	FILTER DOOR POST (M1, M2, M3, M5, M6, M7, M9, M10, M11, M12, M13, M14, M15, M17, M18)
51	0121L01433RFNG	FILTER DOOR POST (M4, M8, M16)
61	0121L00378NG	ECONOMIZER DOOR (M1, M2, M3, M4, M5, M6, M7, M8, M9, M10, M11, M12, M13, M15, M17)
71	0121L01287NG	DUCT PANEL (M2, M3, M5, M8, M9, M10, M11, M12, M13, M15)
71	0121L01367NG	DUCT PANEL (M1, M4, M6, M7, M14, M16, M17, M18)
81	0121L00082NG	RETURN DUCT COVER
91	0121L00099NG	SUPPLY DUCT COVER
101	0121L01078NG	CONTROL DOOR
111	0121L02305RFNG	PAINTED CONTROL POST 12.5 (M1, M2, M3, M5, M6, M7, M9, M10, M11, M12, M13, M14, M15, M17, M18)
111	0121L02518RFNG	RF, PNT CNTL POST HINGED 12.5 (M4, M8, M16)
121	0121L00767NG	ELECTRIC HEAT DOOR
131	0121L00819NG	BLOWER DOOR
141	0121L00765RFNG	BURNER BOX POST
161	0121L00828NG	BURNER AREA DOOR
231	0121L01099RF	RAIL, BASE SIDES RF (QTY 2)
241	0121L00834RF	RAIL-BASE COND END
251	0121L00071RF	RAIL, BASE DUCT END
261	0121G00301	RAIL CORNER BRACKET (QTY 4)
NS	0121L00055	BRACKET-FORK BOARD (QTY 4)
NS	0121L00727	ECONOMIZER COVER (M16, M18)
NS	0121L01310	ECONOMIZER COVER (M14)
NS	0141L00006X	FORK BOARD (QTY 2)
NS	0164L00009	GASKET-RUBBER, CPOST (QTY 3)
NS	0164L00011	GASKET-RUBBER, SIDE POST (QTY 5)

Expanded Model Nomenclature

M1 - DCH150XXX3V RXNAB
M2 - DCH150XXX3V XXXAA
M3 - DCH150XXX3V XXXAB
M4 - DCH150XXX3V DDDAB
M5 - DCH150XXX4V FFXAB
M6 - DCH150XXX4V HXAAB
M7 - DCH150XXX4V HXNAB
M8 - DCH150XXX4V XDBAB
M9 - DCH150XXX4V X XOAB
M10 - DCH150XXX4V XXXAA
M11 - DCH150XXX4V XXXAB
M12 - DCH150XXX7V XXXAA
M13 - DCH150XXX7V XXXAB
M14 - DCH1500163V JXAAB
M15 - DCH1500164V BXBAB
M16 - DCH1500164V WDDAB
M17 - DCH1500303V HXXAB
M18 - DCH1500303V WXXAB

Top Panel and Tubing Assembly

IMAGE 1

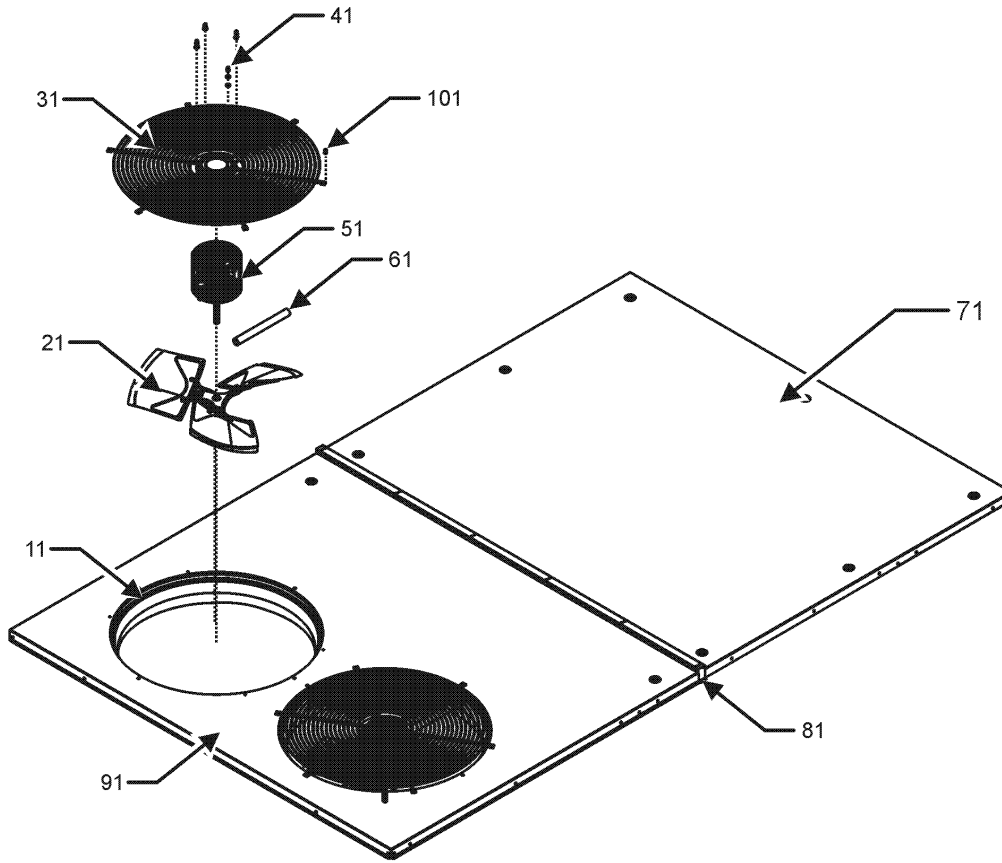
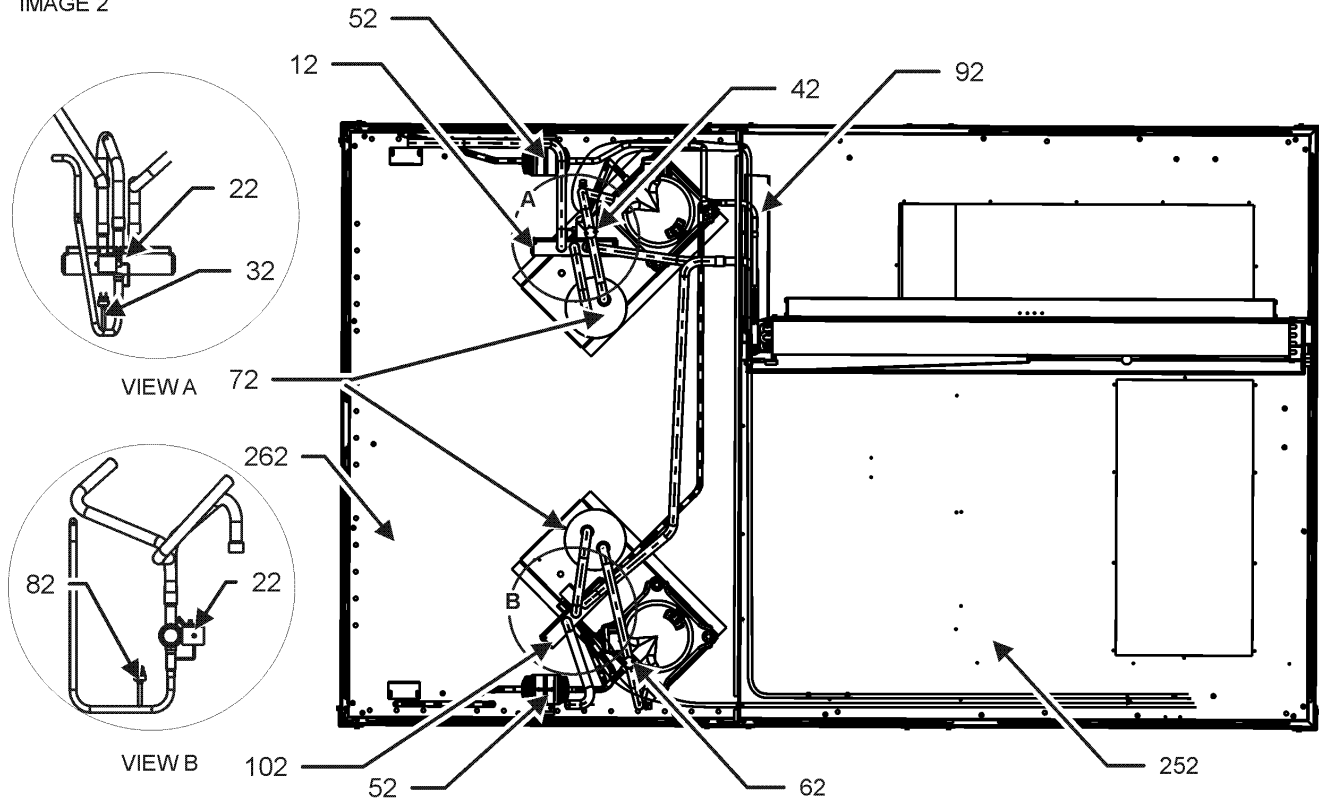

IMAGE 2



Top Panel and Tubing Assembly

**Ref. Part
No: No:**

Description:

**Ref. Part
No: No:**

Description:

Image 1:

11	0161L00000	VENTURI RING 22" (QTY 2)
21	10625733	FAN BLADE 22" ALUM CCW (QTY 2)
31	0152G00003	FAN GRILLE (M12)
31	0152G00000	FAN GRILLE, RAISED (M1, M2, M3, M4, M5, M6, M7, M8, M9, M10, M11, M13, M14, M15, M16, M17, M18)
41	0163M00006P	ACORN NUT 5/16 HEX BLACK (QTY 8)
51	0131M00430	COND MOTOR 1/3 HP, 1 SP, 6 PL (M1, M2, M3, M4, M14, M17, M18)
51	0131M00179	COND MOTOR 1/3 HP, 6 PL, 575V (M12)
51	0131M00774	MOTOR, 1/3 HP, OD (M5, M6, M7, M8, M9, M10, M11, M15, M16)
51	0131M00858	MOTOR, 1/3 HP, OD (M13)
61	0163M00386	CONDUIT-FLEXIBLE (QTY 2)
71	0121L01119NG	PAINTED TOP PANEL INDOOR (M1, M3, M4, M5, M6, M7, M8, M9, M11, M13, M14, M15, M16, M17, M18)
71	0121L00497NG	TOP INDOOR (M2, M10, M12)
81	20455902	SPLICE GASKET .50 X .25 (QTY 5)
91	0121L01118NG	PAINTED TOP PANEL OUTDOOR (M1, M3, M4, M5, M6, M7, M8, M9, M11, M13, M14, M15, M16, M17, M18)
91	0121L01105NG	TOP OUTDOOR (M2, M10, M12)
101	0163M00004	SCREW #10X3/4", BLACK (QTY 4)
NS	0163M00175	CAP WITH O-RING (M4)
NS	0259L00511	HARNESS COND MOTOR
NS	0259L00512	HARNESS COND MOTOR
NS	0163M00005P	WASHER, BLACK (.50 OD .218ID) (QTY 8)

Image 2:

12	0151R00070	REVERSING VALVE
22	B1225022	SOLENOID COIL
32	0130M00074	CUT-OUT SWITCH, HIGH PRESSURE
42	0130M00075	CUT-OUT SWITCH, LOW PRESSURE
52	0151M00012	BI-FLOW FILTER DRIER
62	0130M00075	CUT-OUT SWITCH, LOW PRESSURE
72	0151L00001	ACCUMULATOR (QTY 2)
82	0130M00074	CUT-OUT SWITCH, HIGH PRESSURE
92	0121L02362	DRIP SHIELD - EVAP
102	0151R00070	REVERSING VALVE
252	0121L00944	BASE PAN - INDOOR
262	0121L02129	BASEPAN, OUTDOOR
NS	B1373315	ACCESS FITTING (QTY 4)

Expanded Model Nomenclature

M1 - DCH150XXX3V RXNAB
M2 - DCH150XXX3V XXXAA
M3 - DCH150XXX3V XXXAB
M4 - DCH150XXX3V 1DDAB
M5 - DCH150XXX4V FXXAB
M6 - DCH150XXX4V HXAAB
M7 - DCH150XXX4V HXNAB
M8 - DCH150XXX4V XDBAB
M9 - DCH150XXX4V XXOAB
M10 - DCH150XXX4V XXXAA
M11 - DCH150XXX4V XXXAB
M12 - DCH150XXX7V XXXAA
M13 - DCH150XXX7V XXXAB
M14 - DCH1500163V JXAAB
M15 - DCH1500164V BBXAB
M16 - DCH1500164V WDDAB
M17 - DCH1500303V HXXAB
M18 - DCH1500303V WXXAB

Partition, Evaporator, Condenser Assy

EVAPORATOR COIL ASSEMBLY

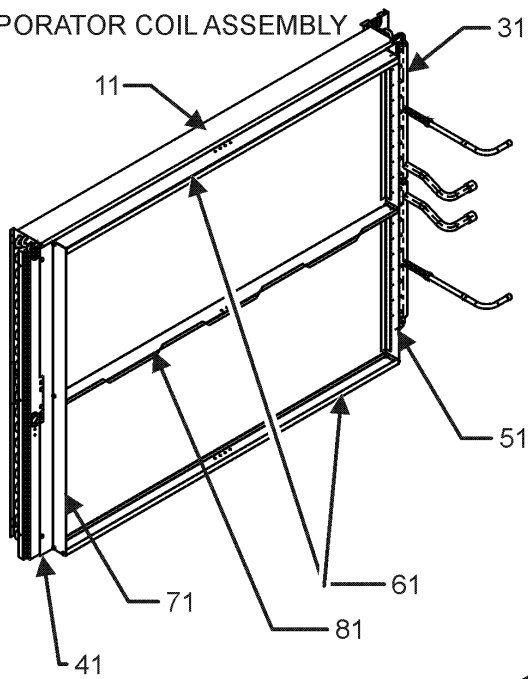

CONDENSER ASSEMBLY

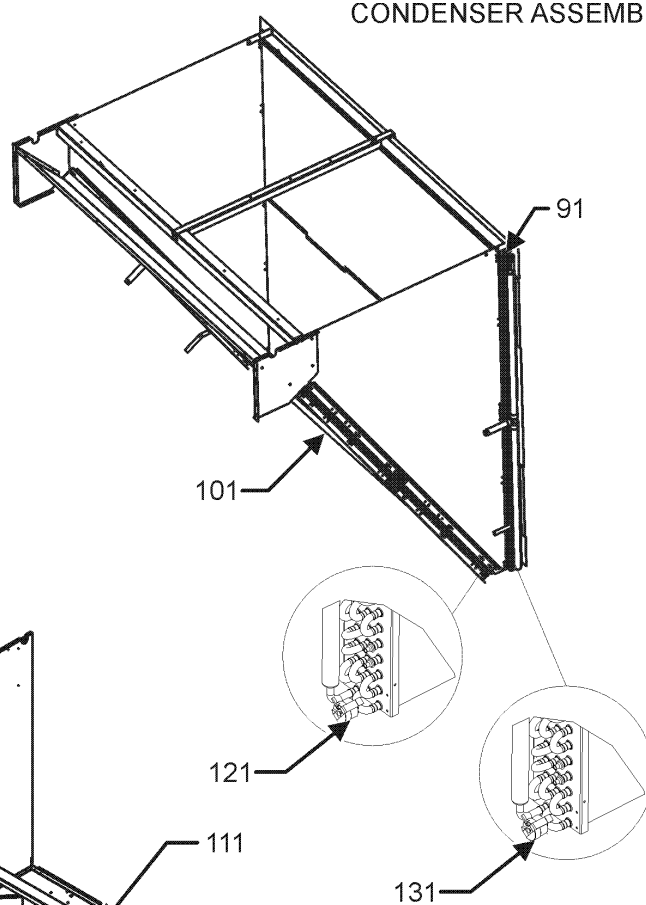

COMPRESSOR ASSEMBLY

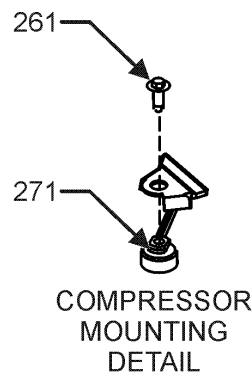
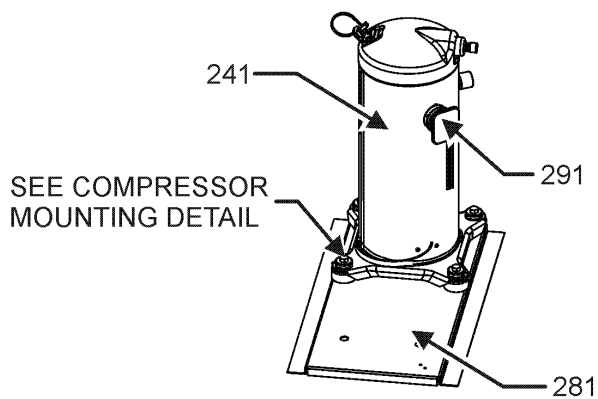

Partition, Evaporator, Condenser Assy

Ref. Part No: No:	Description:	Ref. Part No: No:	Description:
Image 1:		Expanded Model Nomenclature	
11	0202L00044	EVAP COIL ASSY (M2, M10, M12)	M1 - DCH150XXX3V RXNAB
11	0202L00086	EVAP COIL ASSY (M1, M3, M4, M5, M6, M7, M8, M9, M11, M13, M14, M15, M16, M17, M18)	M2 - DCH150XXX3V XXXAA
31	0121L00517	BLOCKOFF-EVAPORATOR, RET END	M3 - DCH150XXX3V XXXAB
41	0121L00845	EVAP EXTENSION-HAIRPIN SIDE	M4 - DCH150XXX3V1DDAB
51	0121L02099	FILTER ANGLE-VERTICAL (HAIRPIN SIDE)	M5 - DCH150XXX4V FXXAB
61	0121L00399	FILTER ANGLE-HORIZONTAL (QTY 2)	M6 - DCH150XXX4V HXAAB
71	0121L02099	FILTER ANGLE-VERTICAL (HAIRPIN SIDE)	M7 - DCH150XXX4V HXNAB
81	0121L01258	ANGLE-FILTER HORIZONTAL	M8 - DCH150XXX4V XDBAB
91	0201L00204	CONDENSER COIL ASSY, C1 (M2, M10, M12)	M9 - DCH150XXX4V XXOAB
91	0201L00218	CONDENSER COIL ASSY, C1 (M1, M3, M4, M5, M6, M7, M8, M9, M11, M13, M14, M15, M16, M17, M18)	M10 - DCH150XXX4V XXXAA
101	0201L00203	CONDENSER COIL ASSY, C2 (M2, M10, M12)	M11 - DCH150XXX4V XXXAB
101	0201L00217	CONDENSER COIL ASSY, C2 (M1, M3, M4, M5, M6, M7, M8, M9, M11, M13, M14, M15, M16, M17, M18)	M12 - DCH150XXX7V XXXAA
111	0121L02997	SUPPORT, PAN, DRAIN	M13 - DCH150XXX7V XXXAB
121	0130M00104	CONTROL, DEFROST	M14 - DCH1500163V JXAAB
131	0130M00103	CONTROL, DEFROST	M15 - DCH1500164V BBXAB
141	0161L00002	DRAIN PAN	M16 - DCH1500164V WDDAB
151	0121L00374	DECK SIDE CHANNEL	M17 - DCH1500303V HXXAB
161	0121L00365	ELECTRIC HEAT PANEL	M18 - DCH1500303V WXXAB
171	0121L00168	BLOWER TRANSITION, RH END	
181	0121L00177	ELECTRIC HEAT COVER	
191	0121L00092	BLOWER TRANSITION, FRONT	
201	0121L03117	DECK-BLOWER	
211	0121L00169	BLOWER TRANSITION, LH END	
221	0121L00094	BLOWER TRANSITION, BACK	
231	0154L00009	DRAIN PAN GASKET	
241	ZP67KCETFD130	COMP, 67000,460/60/3 (M5, M6, M7, M8, M9, M10, M11, M15, M16)	
241	ZP67KCETF5130	COMP, 67500,200/230/60/3 (M1, M2, M3, M4, M14, M17, M18)	
241	ZP67KCETFE130	COMP, 67500,575/60/3 (M12, M13)	
241	0163L00071	PLUG, DRAIN	
261	M0221641	TF SHOULDER SCREW (QTY 8)	
271	B1339533	COMPRESSOR GROMMET (QTY 8)	
281	0121L02128	MOUNTING PLATE, COMP (QTY 2)	
291	0159L00066	Harness, comp s croll (M5, M6, M7, M8, M9, M10, M11, M12, M13, M15, M16)	
291	0159L00068	Harness, comp s croll (M1, M2, M3, M4, M14, M17, M18)	
291	0159L00069	Harness, comp s croll (M1, M2, M3, M4, M14, M17, M18)	
291	0159L00070	Harness, compmpressor 460V (M5, M6, M7, M8, M9, M10, M11, M12, M13, M15, M16)	
311	0121L00369	BRACE-CONDENSER (QTY 2)	
NS	0160L00137	Air Filter 20x25x2 (QTY 4)	
NS	0121L01079	BLOCKOFF, CONTROL BOX	
NS	0121L01398	DECK, SUPPORT BLOWER (M4, M8, M16)	
NS	0121L01402	DECK, SUPPORT CONTROL (M4, M8, M16)	
NS	0121L00321	SMOKE DETECTOR COVER (QTY 2)	

Blower Assembly

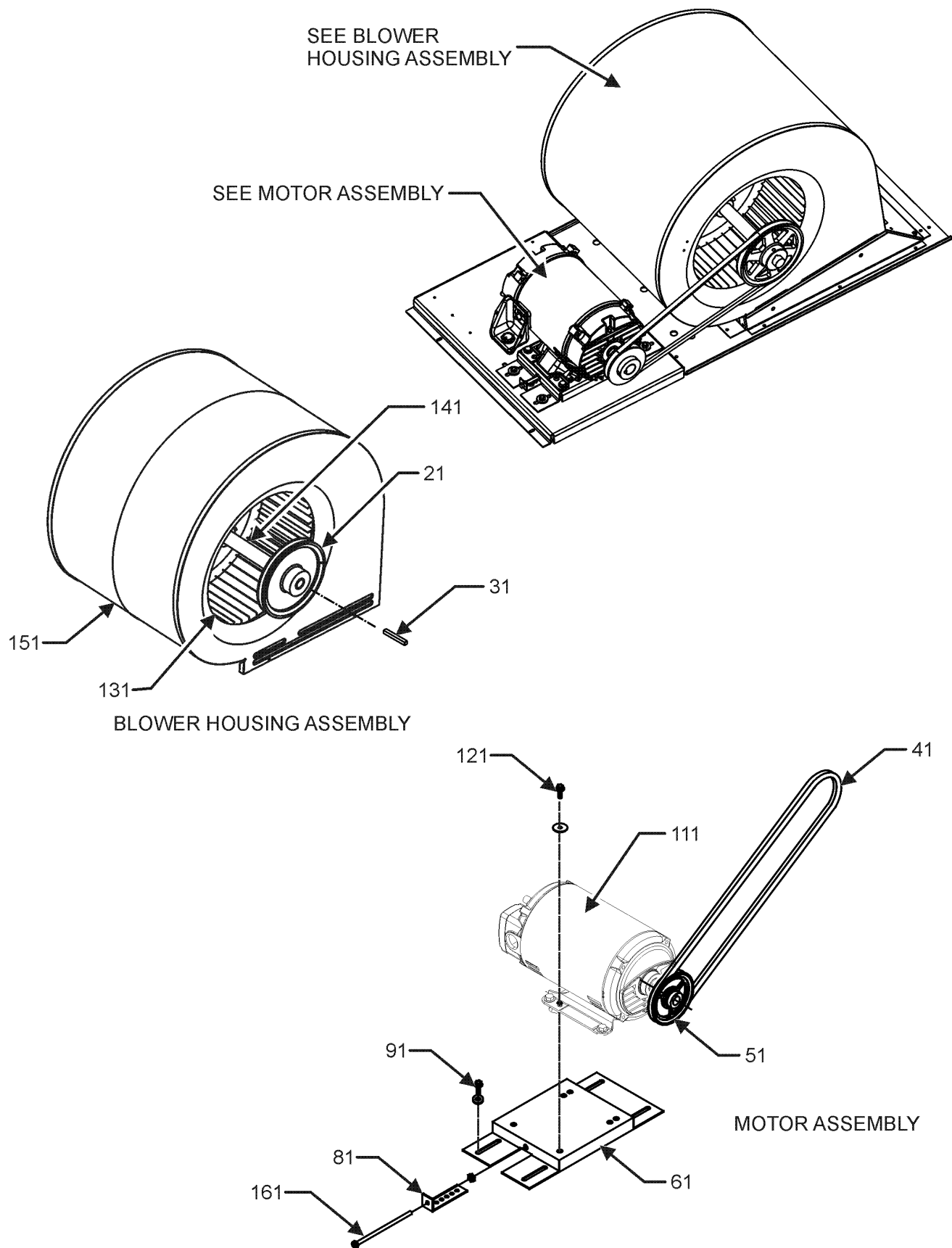

Blower Assembly

Ref. Part No:	Ref. Part No:	Description:	Description:
Image 1:			
21	0163L00142	SHEAVE, FIXED AK71H	
31	0163M00407	MACHINE KEY, SPECIAL	
41	0164L00019	FAN BELT, NOTCHED	
51	0163L00066	VP SHEAVE	
61	0121L01504	MOTOR BASE	
71	0163M00045	BOLT 1/4-20 X 4"	
81	3225000F	BELT TIGHTENER ANGLE	
91	B1393738	BOLT, 1/4-20 X 3/4 (QTY 4)	
111	0131L00024	MOTOR, 3 HP BELT DRIVE 230V (M1, M2, M3, M4, M14, M17, M18)	
111	0131L00030	MOTOR, 3 HP BELT DRIVE 460 V (M5, M6, M7, M8, M9, M10, M11, M15, M16)	
111	0131L00027	MOTOR, 3 HP BELT DRIVE 575 V (M12, M13)	
121	B1446707	SCREW, 5/1618 X 1" (QTY 8)	
131	03-78497	BLOWER WHEEL	
141	04-11526	BLOWER SHAFT	
151	04-01526	BLOWER HOUSING	
161	0163M00045	BOLT, 1/4-20 X3/4	
NS	04-02196	BEARING & FRAME ASSY	
NS	0259L00160	HARNES-BELT DRIVE 2 SP MOTOR	
NS	B1392918	WASHER, FLAT 1/4 ID X 1OD (QTY 4)	

Expanded Model Nomenclature

M1 - DCH150XXX3VRXNAB
M2 - DCH150XXX3VXXXAA
M3 - DCH150XXX3VXXXAB
M4 - DCH150XXX3V1DDAB
M5 - DCH150XXX4VFXXAB
M6 - DCH150XXX4VHXAAB
M7 - DCH150XXX4VHXNAB
M8 - DCH150XXX4VXDBAB
M9 - DCH150XXX4VXXOAB
M10 - DCH150XXX4VXXXAA
M11 - DCH150XXX4VXXXAB
M12 - DCH150XXX7VXXXAA
M13 - DCH150XXX7VXXXAB
M14 - DCH1500163VJXAAB
M15 - DCH1500164VBBXAB
M16 - DCH1500164VWDDAB
M17 - DCH1500303VHXXAB
M18 - DCH1500303VWXXAB

Control Box Assembly

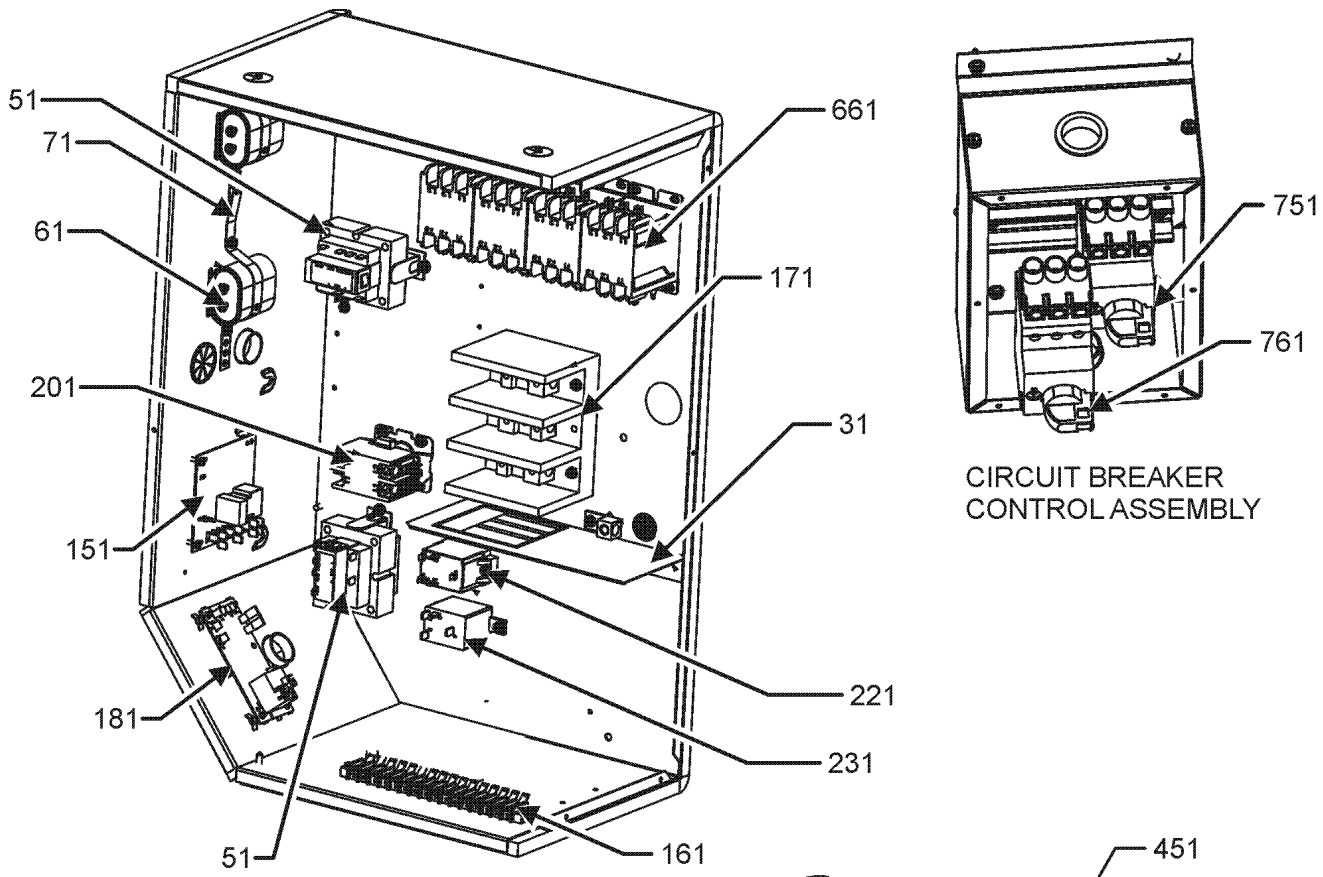

CONTROL BOX FOR MODELS WITH DDC CONTROL

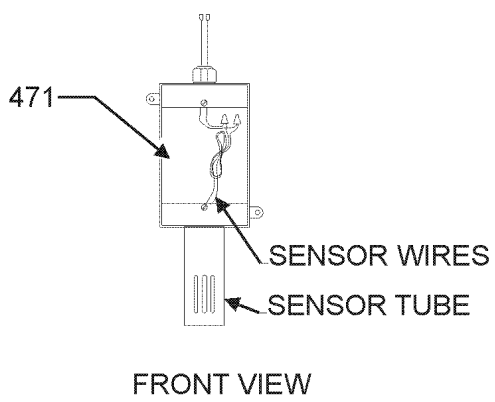
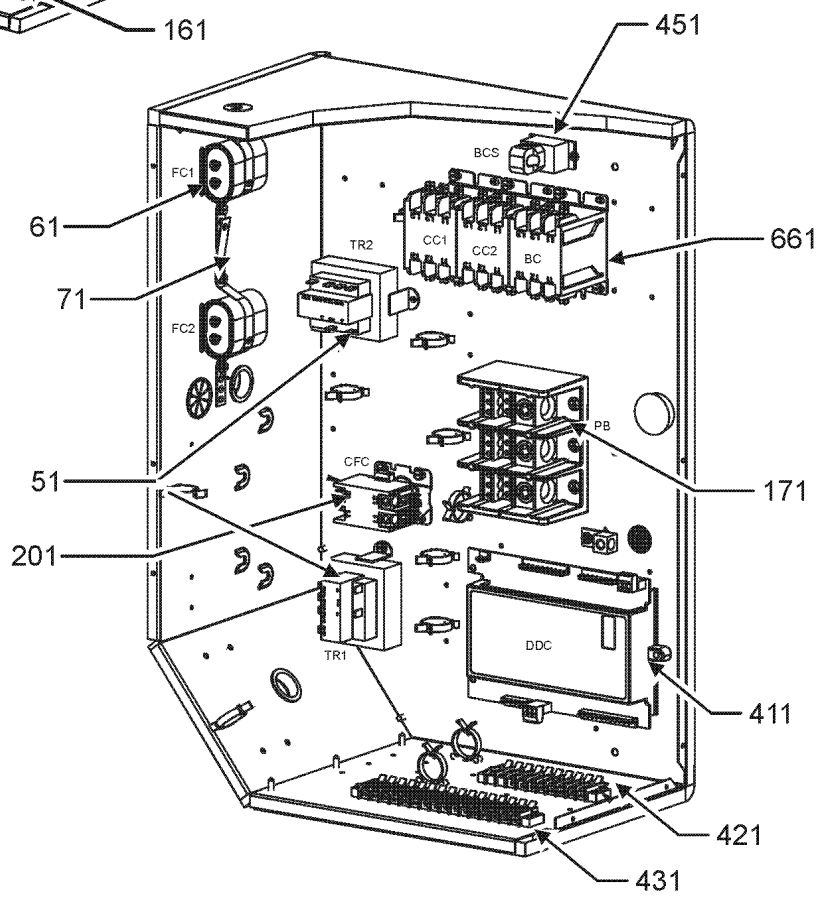

FRONT VIEW

Control Box Assembly

Ref. Part No:	Ref. Part No:	Description:	Description:	
Image 1:		Image 1:		
31	0121G00491	VOLTAGE BARRIER	NS 0259L00496 HARNESS, NON POW, CONV, OUT (M6, M14)	
51	0130M00594	TRANSFORMER (M1, M2, M3, M4, M14, M17, M18)	NS 0259L00160 HARNESS-BELT DRIVE 2 SP MOTOR	
51	0130M00148	TRANSFORMER 575V to 24V, 75VA (M12)	NS 0259L00092 HARNESS-SMOKE DETECTOR SENSOR (M1, M4, M7, M9, M16)	
51	0130M00595	TRANSFORMER, 75VA, 480V TO 24V (M5, M6, M7, M8, M9, M10, M11, M15, M16)	NS 0259L00032 LCM HARNESS, ELECTRIC HEAT	
51	0130M00598	TRANSFORMER, 75VA, 575V TO 24V (M13)	NS 0259L00494 WIRE HARN, SMOKE DET MED DDC (M1)	
61	CAP100000370LA	CAPACITOR 10/370V (M1, M2, M3, M4, M5, M6, M7, M8, M9, M10, M11, M14, M15, M16, M17, M18)	NS 0259L00502 WIRE HARNESS	
61	CAP050000370LA	CAPACITOR 5/370V (M12)	NS 0259L00503 WIRE HARNESS (M1, M5, M15)	
61	CAP050000440LA	CAPACITOR 5/440V (M13)	NS 0259L00148 WIRE HARNESS ASSY	
71	20520901	CAPACITOR STRAP (QTY 2)	NS 0259L00149 WIRE HARNESS ASSY	
151	PCBDM101	DEFROST CONTROL BOARD	NS 0259L00150 WIRE HARNESS ASSY	
161	0130M00038	TERMINAL BOARD	NS 0259L00151 WIRE HARNESS ASSY	
171	0130M00042	BLOCK, POWER	NS 0259L00152 WIRE HARNESS ASSY	
181	PCBFM103	ELECTRONIC BLOWER TIME DELAY	NS 0259L00156 WIRE HARNESS ASSY	
201	CONT2P040024V	CONTACTOR 40 AMP, 2P, 24V	NS 0259L00158 WIRE HARNESS ASSY	
221	10135604	RELAY (QTY 4)	NS 0259L00090 WIRE HARNESS-SMOKE DETECTOR (M4, M7, M9, M16)	
231	0130M00242	RELAY, 24V (QTY 3)	NS 0259L00557 WIRING HARNESS (M4)	
411	PCBCG103	PCB, CONTROL, HP, GAS ,AC (M1, M5, M15)	Expanded Model Nomenclature	
421	0130M00274	TERMINAL BOARD (M1, M5, M15)	M1 - DCH150XXX3VRXNAB	
431	0130M00275	TERMINAL BOARD (M1, M5, M15)	M2 - DCH150XXX3VXXXAA	
451	0259L00368	CURRENT SWITCH WITH TERMS (M1, M5, M15)	M3 - DCH150XXX3VXXXAB	
471	0130L00108	OD Air Temp Sensor (M1, M5, M15)	M4 - DCH150XXX3V1DDAB	
661	CONT3P030024V	CONTACTOR 30 AMP, 3P, 24V (QTY 4)	M5 - DCH150XXX4VFXXAB	
751	0130L00070	ROTARY MANUAL MOTOR PROTECTOR (M5, M6, M7, M8, M9, M10, M11, M15, M16)	M6 - DCH150XXX4VHXAAB	
751	0130L00082	ROTARY MANUAL MOTOR PROTECTOR (M12, M13)	M7 - DCH150XXX4VHXNAB	
751	0130L00084	ROTARY MANUAL MOTOR PROTECTOR (M1, M2, M3, M4, M14, M17, M18)	M8 - DCH150XXX4VXDBAB	
761	0130L00082	ROTARY MANUAL MOTOR PROTECTOR (M12, M13)	M9 - DCH150XXX4VXXOAB	
761	0130L00083	ROTARY MANUAL MOTOR PROTECTOR (M1, M2, M3, M4, M5, M6, M7, M8, M9, M10, M11, M14, M15, M16, M17, M18)	M10 - DCH150XXX4VXXXAA	
NS	0259L00153	2 SPEED CONTROL HARNESS	M11 - DCH150XXX4VXXXAB	
NS	0259L00154	2 SPEED HP HARNESS	M12 - DCH150XXX7VXXXAA	
NS	0259L00155	2 SPEED RELAY HARNESS	M13 - DCH150XXX7VXXXAB	
NS	0259L00161	CIRCUIT BREAKER HARNESS	M14 - DCH1500163VJXAAB	
NS	0259L00147	COND FAN/ TRANSFORMER HARNESS (M12)	M15 - DCH1500164VBBXAB	
NS	0259L00303	COND FAN/TRANSFORMER HARNESS (M1, M2, M3, M4, M5, M6, M7, M8, M9, M10, M11, M13, M14, M15, M16, M17, M18)	M16 - DCH1500164VWDDAB	
NS	0259L00159	DEFROST BOARD HARNESS	M17 - DCH1500303VHXXAB	
NS	0259L00157	DEFROST RELAY HARNESS	M18 - DCH1500303VWXXAB	
NS	0130L00112	Duct Temp Sensor (M1, M5, M15)		
NS	0259L00165	ECONOMIZER HARNESS		
NS	0259L00379	HARN, BINARY INPUT, DDC (M1, M5, M15)		
NS	0259L00382	HARN, CNTL PWR, DDC (M1, M5, M15)		
NS	0259L00385	HARN, CNTL, HEAT PLUG INTERCON (M1, M5, M15)		
NS	0259L00383	HARN, CNTL, TR1-TR2-CFC (M1, M5, M15)		
NS	0259L00418	HARN, RELAY OUTPUT, DDC 2 SP (M1, M5, M15)		
NS	0259L00511	HARNESS COND MOTOR		
NS	0259L00512	HARNESS COND MOTOR		

Accessory Parts List

ACCESSORY PARTS LIST

NOTE: NOT ALL OPTIONS AVAILABLE FOR ALL PRODUCTS

1 LOW AMBIENT KITS

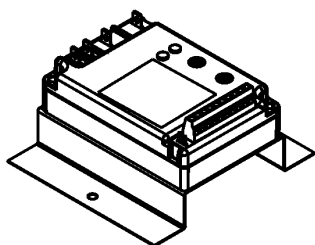

2 GFCI CONVENIENCE OUTLET

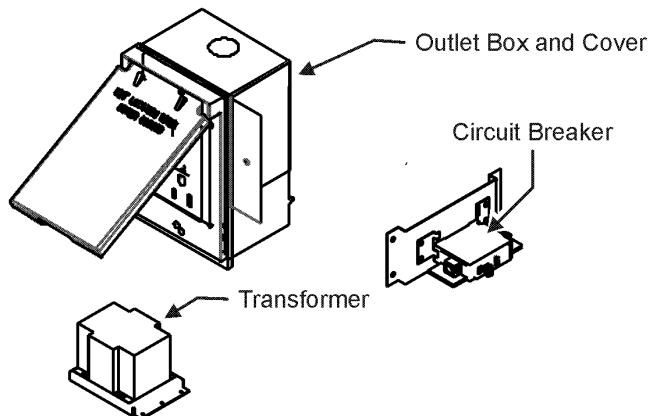

3 DISCONNECT MODULE (NON-FUSED)

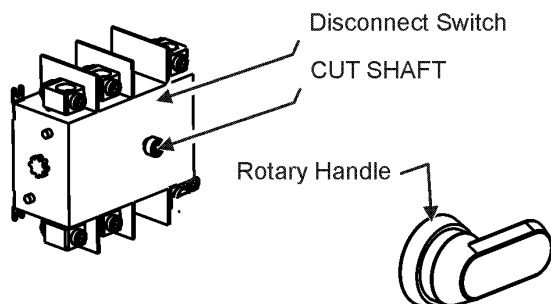

4 SMOKE DETECTORS

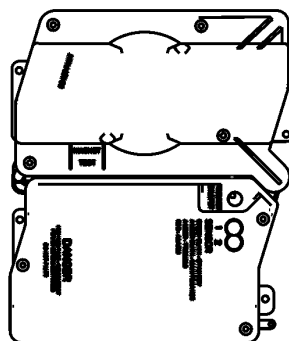

5 DDC CONTROL

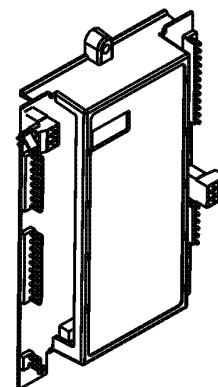

6 HINGED DOOR ASSEMBLIES

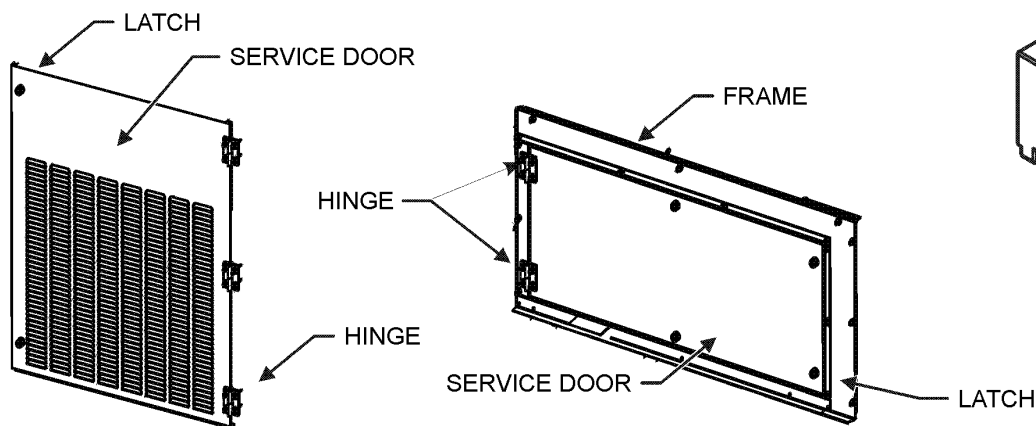

7 PHASE MONITOR

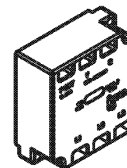

Accessory Parts List

Ref. Part No:	Ref. Part No:	Description:	Description:
Image 1:		Expanded Model Nomenclature	
NS EHK3-16	NS	15 KW 208-230/3 ELECTRIC HEAT (M14)	M1 - DCH150XXX3VRXNAB
NS EHK4-16	NS	15 KW 460/3 ELECTRIC HEAT (M15, M16)	M2 - DCH150XXX3VXXXAA
NS DDNECNJ90150B	NS	7.5-12.5 TON DFLOW ECON (M16, M18)	M3 - DCH150XXX3VXXXAB
NS 1036610B	NS	7.5-12.5 TON DFLOW ECONOMIZER (M14)	M4 - DCH150XXX3V1DDAB
NS 10366D10B	NS	7.5-12.5T DFLOW ECON, DDC (M1, M5)	M5 - DCH150XXX4VFXAB
NS 0121L00316	NS	BRACKET-CONV OUTLET MOUNT (M1, M6, M7, M8, M9, M14)	M6 - DCH150XXX4VHXAAB
NS 0121L00768	NS	BRACKET-SMOKE DETECTOR (M1, M4, M7, M9, M16)	M7 - DCH150XXX4VHXNAB
NS 0130M00065	NS	CIRCUIT BREAKER, CONVENIENCE OUTLET (M1, M7, M8, M9)	M8 - DCH150XXX4VXDBAB
NS 0121L00973NG	NS	DISCONNECT SWITCH COVER (M1, M4, M6, M7, M14, M16, M17, M18)	M9 - DCH150XXX4VXXOAB
NS 0121L01414NG	NS	DOOR FRAME, BLOWER (M4, M8, M16)	M10 - DCH150XXX4VXXXAA
NS 0121L01417NG	NS	DOOR FRAME, CONTROL (M4, M8, M16)	M11 - DCH150XXX4VXXXAB
NS 0121L02483NG	NS	DOOR, SERVICE, BACK, BLOWER (M4, M8, M16)	M12 - DCH150XXX7VXXXAA
NS 0121L02482NG	NS	DOOR, SERVICE, FRONT, BLOWER (M4, M8, M16)	M13 - DCH150XXX7VXXXAB
NS EHK3-30	NS	ELECTRIC HEATER KIT (M17, M18)	M14 - DCH1500163VJXAAB
NS 0130L00012	NS	GANG BOX-GFCI OUTLET (M1, M6, M7, M8, M9, M14)	M15 - DCH1500164VBBXAB
NS 0130L00039	NS	HANDLE, ROTARY (M1, M6, M7, M14, M16, M17, M18)	M16 - DCH1500164VWDDAB
NS 0163M00307	NS	HINGE, LEFT HAND (M4, M8, M16)	M17 - DCH1500303VHXXAB
NS 0163M00308	NS	HINGE, RIGHT HAND (M4, M8, M16)	M18 - DCH1500303VWXXAB
NS 0163M00322	NS	LATCH (M4, M8, M16)	
NS 0121L02221NG	NS	PNT, DOOR FRAME, FILTER (M4, M8, M16)	
NS 0121L02222NG	NS	PNT, SERVICE DOOR BACK FILTER (M4, M8, M16)	
NS 0121L02219NG	NS	PNT, SERVICE DOOR FRONT FILTER (M4, M8, M16)	
NS 0161G00012	NS	POWER OUTLET BOX (M1, M6, M7, M8, M9, M14)	
NS 0130L00103	NS	RECEPTACLE-GFCI OUTLET (M1, M6, M7, M8, M9, M14)	
NS RS400	NS	REMOTE SENSOR (M4)	
NS SP400	NS	SENSOR PACK (M4)	
NS 0121L01416NG	NS	SERVICE DOOR BACK, CONTROL (M4, M8, M16)	
NS 0121L01415NG	NS	SERVICE DOOR FRONT, CONTROL (M4, M8, M16)	
NS 0130L00043	NS	SHAFT, CUT (M1, M7, M14)	
NS 0130L00056	NS	SHAFT, CUT (M6)	
NS 0130L00057	NS	SHAFT, CUT (M16)	
NS 0130L00049	NS	SHAFT, DISCONNECT (M1, M4, M6, M7, M14, M16, M17, M18)	
NS D4120	NS	SMOKE DETECTOR, PHOTO 4WIRE (M1, M4, M7, M9, M16)	
NS D4S	NS	SMOKE DETECTOR, SENSOR ONLY (M9)	
NS ECP400-5	NS	SURVEYOR ECP (M4)	
NS 0130L00027	NS	SWITCH-DISCONNECT 100A (M6)	
NS 0130L00033	NS	SWITCH-DISCONNECT 200A (M1, M4, M7, M14, M17, M18)	
NS 0130L00046	NS	SWITCH-DISCONNECT 60A (M16)	
NS 0130M00061	NS	TRANSFORMER, CONVENIENCE OUTLET (M1, M7, M8, M9)	
NS 0259L00557	NS	WIRE HARNESS (M4)	