

Commercial 8.5 Ton Package Heat Pump Unit

DCH1020304BHXBAB
DCH1020454BXXBAC
DCH102XXX3BAXXAA
DCH102XXX3BHDDAB
DCH102XXX3BXDXAB
DCH102XXX3BXXXAA
DCH102XXX3BXXXAB
DCH102XXX4BXXXAA
DCH102XXX4BXXXAB
DCH102XXX4BXXXAC
DCH102XXX7BXXXAA
DCH102XXX7BXXXAB
DCH102XXX7BXXXAC

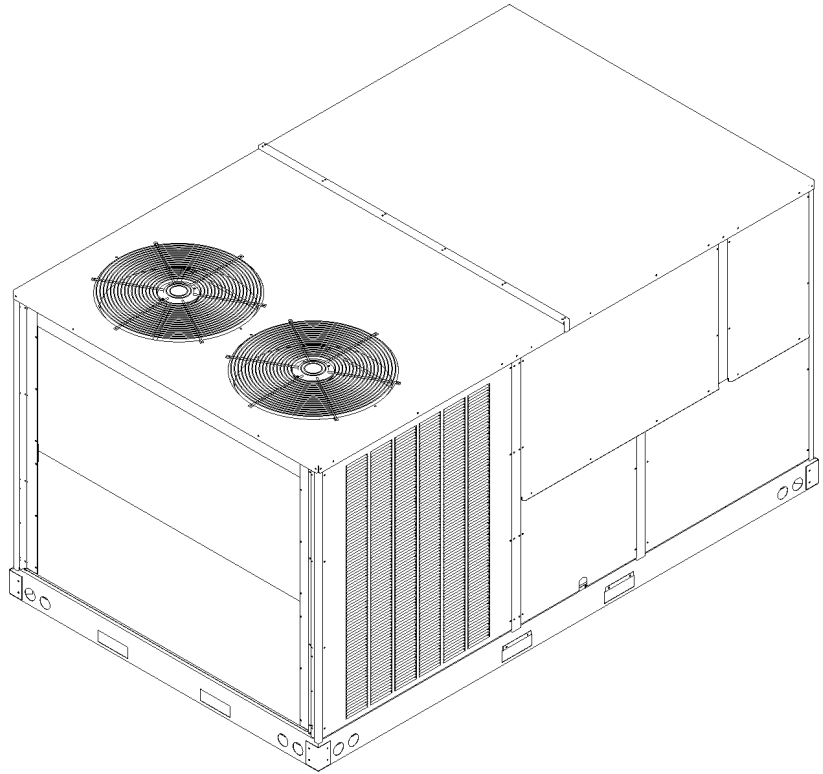

This manual is to be used by qualified technicians only.

This manual replaces RP-D1036G.

© 2013 - 2014, 2016 - 2017 **DAIKIN COMPANY, L.P.** ♦ 5151 San Felipe St., Suite 500 ♦ Houston, TX 77056

Important Information

Index

Functional Parts List	3
Illustration and Parts	4 - 15

Views shown are for parts illustrations only, not servicing procedures

Text Codes:

AR - As Required

NA - Not Available

NS - Not Shown

00000000 - See Note

QTY - Quantity Example (QTY 3) (If Quantity not shown, Quantity = 1)

M - Model Example (M1) (If M Code not shown, then part is used on all Models)

Expanded Model Nomenclature:

Example M1 - Model#1 M2 - Model#2 M3 - Model#3

Daikin Company, L.P. is not responsible for personal injury or property damage resulting from improper service. Review all service information before beginning repairs.

Warranty service must be performed by an authorized technician, using authorized factory parts. If service is required after the warranty expires, Daikin Company, L.P. also recommends contacting an authorized technician and using authorized factory parts.

Daikin Company, L.P. reserves the right to discontinue, or change at any time, specifications or designs without notice or without incurring obligations.

For assistance within the U.S.A. contact:

Equipment Support
Daikin North America, LLC
19001 Kermier Road
Waller, Texas 77484
855-770-5678-Telephone
713-863-2382-Facsimile

For assistance outside the U.S.A. contact:

International Division
Daikin North America, LLC
19001 Kermier Road
Waller, Texas 77484
713-861-2500-Telephone
713-863-2382-Facsimile

Functional Parts

Part No: **Description:**

B3240006	BELT DRIVE MOTOR 2 HP (M1, M2, M3, M4, M5, M6, M7, M8, M12, M13)
0131L00005	BELT DRIVE MOTOR 2 HP 575 V (M9, M10, M11)
CAP100000370LA	CAPACITOR 10/370V (M5, M8, M11, M13)
CAP030000440LA	CAPACITOR 3/440V (M10)
CAP050000370LA	CAPACITOR 5/370V (M1, M4, M6, M9)
CAP075000370LA	CAPACITOR 7.5/370V (M7, M12)
ZP44K5ETF5130	COMPRESSOR 44000, 200/230/60/3 (M1, M4, M5)
ZP44K5ETFD130	COMPRESSOR 44000, 460/60/3 (M6, M7, M8, M12, M13)
ZP44K5ETFE130	COMPRESSOR 44000, 575/60/3 (M9, M10, M11)
B13400269	COND MOTOR 380/460 50/60 CYCLE (M6)
0131M00432	COND MOTOR 380/460/50/60 CYCLE (M7, M12)
0131M00431	COND MOTOR 575V (M10)
0131M00098	COND MOTOR 575V (M9)
CONT3P025024V	CONTACTOR 25 AMP, 3P, 24V (QTY 3)
CONT2P040024V	CONTACTOR 40 AMP, 2P, 24V
0130M00102	CONTROL, DEFROST (M1, M4, M5, M6, M7, M8, M9, M10, M11, M12, M13)
0130M00103	CONTROL, DEFROST (M1, M4, M5, M6, M7, M8, M9, M10, M11, M12, M13)
0130M00031	CUT-OUT SWITCH, HIGH PRESSURE
0130M00030	CUT-OUT SWITCH, HIGH PRESSURE
0130L00002	CUT-OUT SWITCH, LOW PRESSURE (M6)
0130L00003	CUT-OUT SWITCH, LOW PRESSURE (QTY 2)
PCBDM101	DEFROST CONTROL BOARD (M1, M4, M5, M6, M7, M8, M9, M10, M11, M12, M13)
PCBFM103	ELECTRONIC BLOWER TIME DELAY (M1, M4, M5, M6, M7, M8, M9, M10, M11, M12, M13)
0131M00840	MOTOR, 1/3 HP, OD (M2, M3, M5)
0131M00841	MOTOR, 1/3 HP, OD (M8, M13)
0131M00842	MOTOR, 1/3 HP, OD (M11)
0131M00847	MOTOR, 1/4 HP, 1 SP, 6 PL (M1, M4)
10135604	RELAY
0130M00242	RELAY, 24V
0151R00071	REVERSING VALVE
B1225022	SOLENOID COIL
0130M00038	TERMINAL BOARD (M1, M4, M5, M6, M7, M8, M9, M10, M11, M12, M13)
0130M00144	TRANSFORMER (M1, M4, M5)
0130M00145	TRANSFORMER 480V to 24V, 75VA (M6, M7, M8, M12, M13)
0130M00148	TRANSFORMER 575V to 24V, 75VA (M9, M10, M11)

Expanded Model Nomenclature

M1 - DCH102XXX3BAXXAA
M2 - DCH102XXX3BHDDAB
M3 - DCH102XXX3BXDXAB
M4 - DCH102XXX3BXXXAA
M5 - DCH102XXX3BXXXAB
M6 - DCH102XXX4BXXXAA
M7 - DCH102XXX4BXXXAB
M8 - DCH102XXX4BXXXAC
M9 - DCH102XXX7BXXXAA
M10 - DCH102XXX7BXXXAB
M11 - DCH102XXX7BXXXAC
M12 - DCH1020304BHXBAB
M13 - DCH1020454BXXBAC

Cabinet Assembly

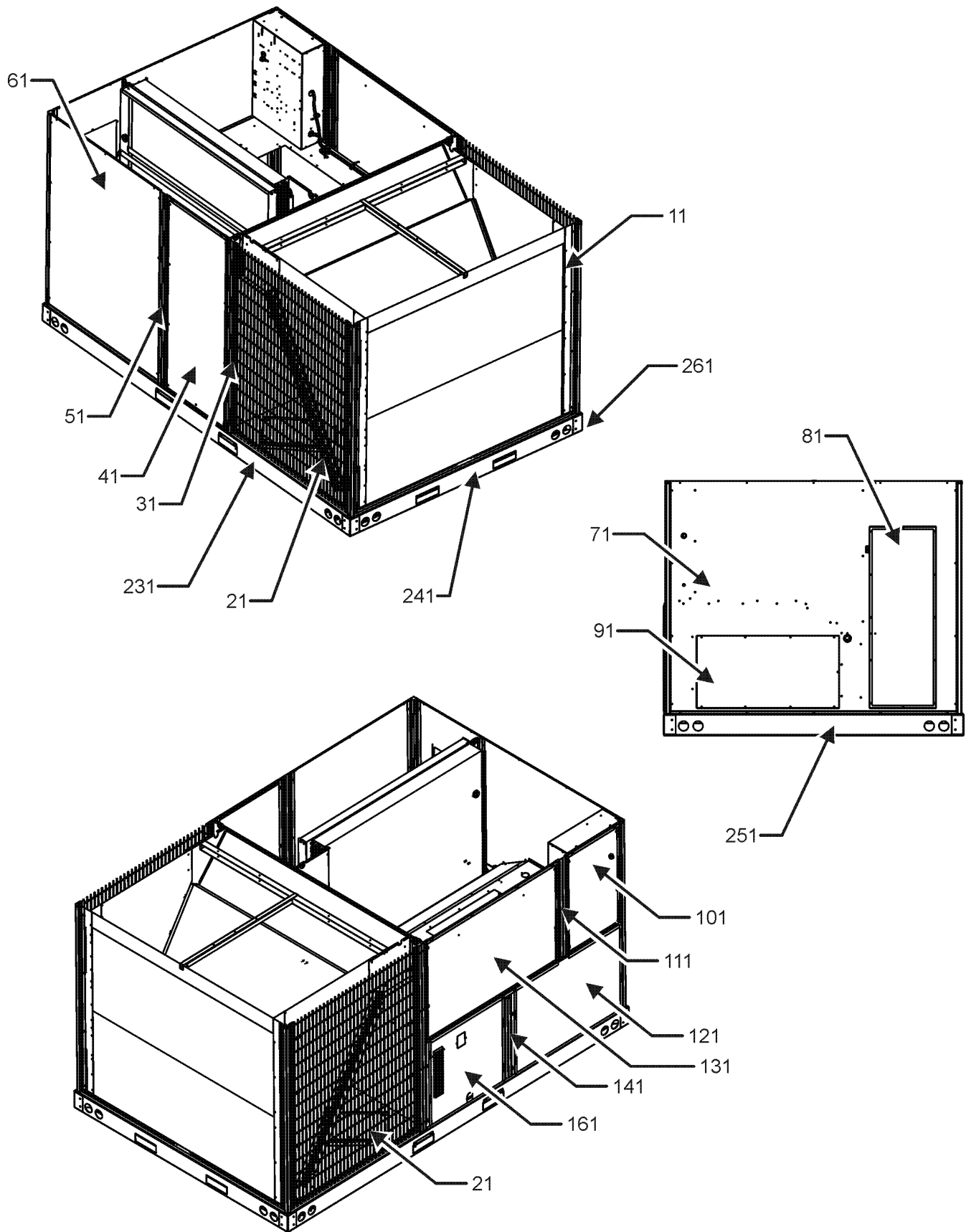

Cabinet Assembly

Ref. Part No:	Description:	Ref. Part No:	Description:
---------------	--------------	---------------	--------------

Image 1:

11	0121L00065RFNG	CORNER POST (QTY 4)
11	0121L01407RFNG	CORNER POST (M2, M3)
21	0121L00511NG	LOUVERED SIDE PANEL (QTY 2)
31	0121L00738RFNG	ROLL FORM SIDE POST (M1, M4, M5, M6, M7, M8, M9, M10, M11, M12, M13)
31	0121L01400RFNG	SIDE POST (M2, M3)
41	0121L00737NG	FILTER DOOR
51	0121L00739RFNG	FILTER DOOR POST (M1, M4, M5, M6, M7, M8, M9, M10, M11, M12, M13)
51	0121L01432RFNG	FILTER DOOR POST (M2, M3)
61	0121L00510NG	ECONOMIZER DOOR (M2, M3, M4, M5, M6, M7, M8, M9, M10, M11, M12, M13)
71	0121L01364NG	DUCT PANEL (M1, M4, M5, M6, M7, M8, M9, M10, M11, M13)
71	0121L01365NG	DUCT PANEL (M2, M12)
81	0121L00082NG	RETURN DUCT COVER
91	0121L00099NG	SUPPLY DUCT COVER
101	0121L00974NG	CONTROL DOOR
111	0121L02474RFNG	POST, CNTRL BOX, RLLD FRM, PNT (M1, M4, M5, M6, M7, M8, M9, M10, M11, M12, M13)
111	0121L02476RFNG	POST, CNTRL BX, RLLD FORM, PNT (M2, M3)
121	0121L00767NG	ELECTRIC HEAT DOOR
131	0121L00763NG	BLOWER DOOR
141	0121L00765RFNG	BURNER BOX POST
161	0121L00828NG	BURNER AREA DOOR
231	0121L01099RF	RAIL, BASE SIDES RF (QTY 2)
241	0121L00834RF	RAIL-BASE COND END
251	0121L00071RF	RAIL, BASE DUCT END
261	0121G00301	RAIL CORNER BRACKET (QTY 4)
NS	0121L00055	BRACKET-FORK BOARD (QTY 4)
NS	0121L01310	ECONOMIZER COVER (M1)
NS	0141L00006X	FORK BOARD (QTY 2)
NS	0164L00009	GASKET-RUBBER, CPOST (QTY 3)
NS	0164L00009	GASKET-RUBBER, CPOST (QTY 3)
NS	0164L00011	GASKET-RUBBER, SIDE POST (QTY 4)
NS	0164L00011	GASKET-RUBBER, SIDE POST (QTY 4)

Expanded Model Nomenclature

- M1 - DCH102XXX3BAXXAA
- M2 - DCH102XXX3BHDDAB
- M3 - DCH102XXX3BXDXAB
- M4 - DCH102XXX3BXXXAA
- M5 - DCH102XXX3BXXXAB
- M6 - DCH102XXX4BXXXAA
- M7 - DCH102XXX4BXXXAB
- M8 - DCH102XXX4BXXXAC
- M9 - DCH102XXX7BXXXAA
- M10 - DCH102XXX7BXXXAB
- M11 - DCH102XXX7BXXXAC
- M12 - DCH1020304BHXBAB
- M13 - DCH1020454BXXBAC

Top Panel and Tubing Assembly

IMAGE 1

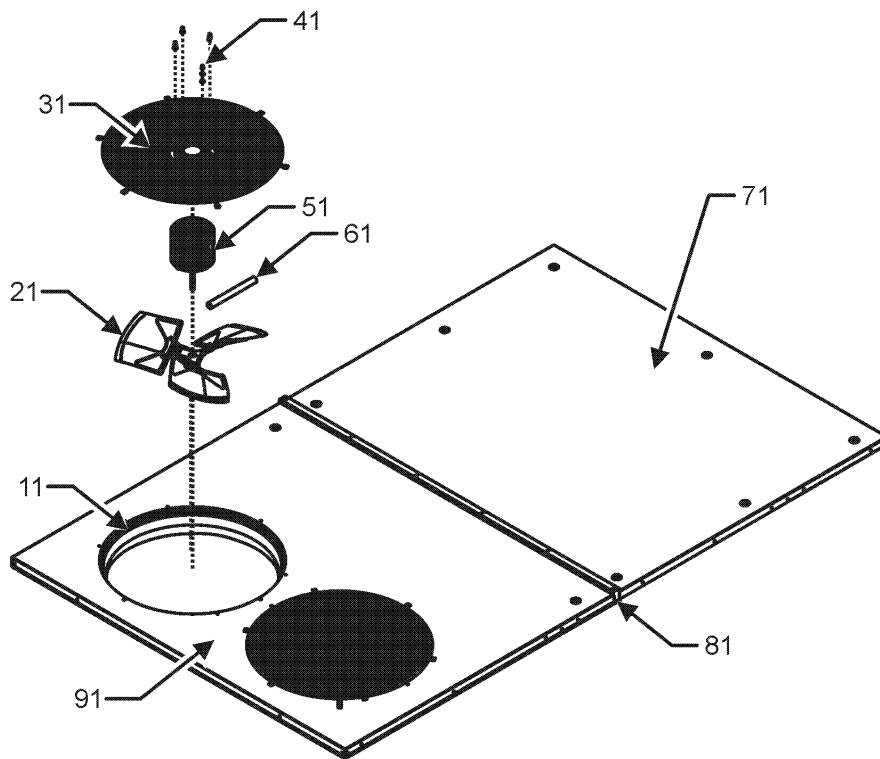
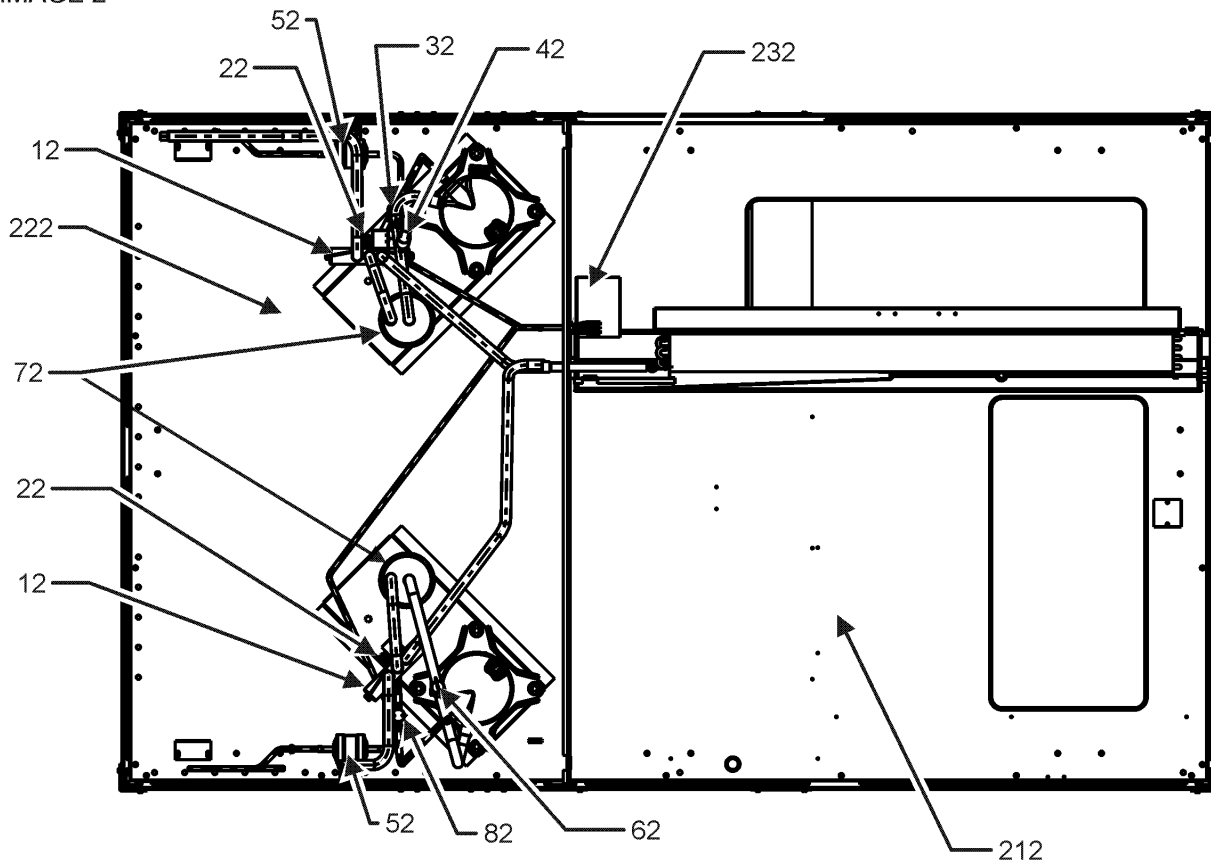

IMAGE 2



Top Panel and Tubing Assembly

Ref. Part No: No:	Description:	Ref. Part No: No:	Description:
Image 1:		Expanded Model Nomenclature	
11	0161L00000	VENTURI RING 22" (QTY 2)	M1 - DCH102XXX3BAXXAA
21	0150G00001	FAN BLADE (M1, M4, M6, M7, M9, M10, M12)	M2 - DCH102XXX3BHDDAB
21	10625733	FAN BLADE 22" ALUM CCW (M2, M3, M5, M8, M11, M13)	M3 - DCH102XXX3BXDXAB
31	0152G00003	FAN GRILLE (M6, M9)	M4 - DCH102XXX3BXXXAA
31	0152G00000	FAN GRILLE, RAISED (M1, M2, M3, M4, M5, M7, M8, M10, M11, M12, M13)	M5 - DCH102XXX3BXXXAB
41	0163M00006P	ACORN NUT 5/16 HEX BLACK (QTY 8)	M6 - DCH102XXX4BXXXAA
51	B13400269	COND MOTOR 380/460 50/60 CYCLE (M6)	M7 - DCH102XXX4BXXXAB
51	0131M00432	COND MOTOR 380/460/50/60 CYCLE (M7, M12)	M8 - DCH102XXX4BXXXAC
51	0131M00098	COND MOTOR 575V (M9)	M9 - DCH102XXX7BXXXAA
51	0131M00431	COND MOTOR 575V (M10)	M10 - DCH102XXX7BXXXAB
51	0131M00840	MOTOR, 1/3 HP, OD (M2, M3, M5)	M11 - DCH102XXX7BXXXAC
51	0131M00841	MOTOR, 1/3 HP, OD (M8, M13)	M12 - DCH1020304BHXBAB
51	0131M00842	MOTOR, 1/3 HP, OD (M11)	M13 - DCH1020454BXXBAC
51	0131M00847	MOTOR, 1/4 HP, 1 SP, 6 PL (M1, M4)	
61	17788000083F	PVC CONDUIT 8.25" (QTY 2)	
71	0121L00497NG	TOP INDOOR	
81	20455902	SPLICE GASKET .50 X .25 (QTY 5)	
91	0121L01105NG	TOP OUTDOOR	
NS	0163M00175	CAP WITH O-RING (QTY 4)	
NS	0259L00025	COND MOTOR HARNESS 230V (M1, M2, M3, M4, M5, M8, M9, M10, M11, M13)	
NS	0259L00027	COND MOTOR HARNESS 230V (M1, M2, M3, M4, M5, M8, M9, M10, M11, M13)	
NS	0259L00026	COND MOTOR HARNESS 460V (M6, M7, M12)	
NS	0259L00028	COND MOTOR HARNESS 460V (M6, M7, M12)	
NS	0163M00004	SCREW #10X3/4", BLACK (QTY 20)	
NS	0163M00005P	WASHER, BLACK (.50 OD .218ID) (QTY 8)	
Image 2:			
12	0151R00071	REVERSING VALVE	
22	B1225022	SOLENOID COIL	
32	0130M00031	CUT-OUT SWITCH, HIGH PRESSURE	
42	0130L00003	CUT-OUT SWITCH, LOW PRESSURE	
52	B1219204	BI-FLOW FILTER DRIER (QTY 2)	
62	0130L00002	CUT-OUT SWITCH, LOW PRESSURE (M6)	
62	0130L00003	CUT-OUT SWITCH, LOW PRESSURE (M1, M2, M3, M4, M5, M7, M8, M9, M10, M11, M12, M13)	
72	B1226207	ACCUMULATOR .875 (M1, M4, M5, M6, M7, M8, M9, M10, M11, M12, M13)	
82	0130M00030	CUT-OUT SWITCH, HIGH PRESSURE	
212	0121L02129	BASEPAN, OUTDOOR	
222	0121L00944	BASE PAN-INDOOR	
232	0121L00359	SHIELD-EVAPORATOR DRIP (M1, M4, M5, M6, M7, M8, M9, M10, M11, M12, M13)	
NS	B1373315	ACCESS FITTING (M1, M4, M5, M6, M7, M8, M9, M10, M11, M12, M13)	

Evaporator and Condenser Assembly

EVAPORATOR ASSEMBLY

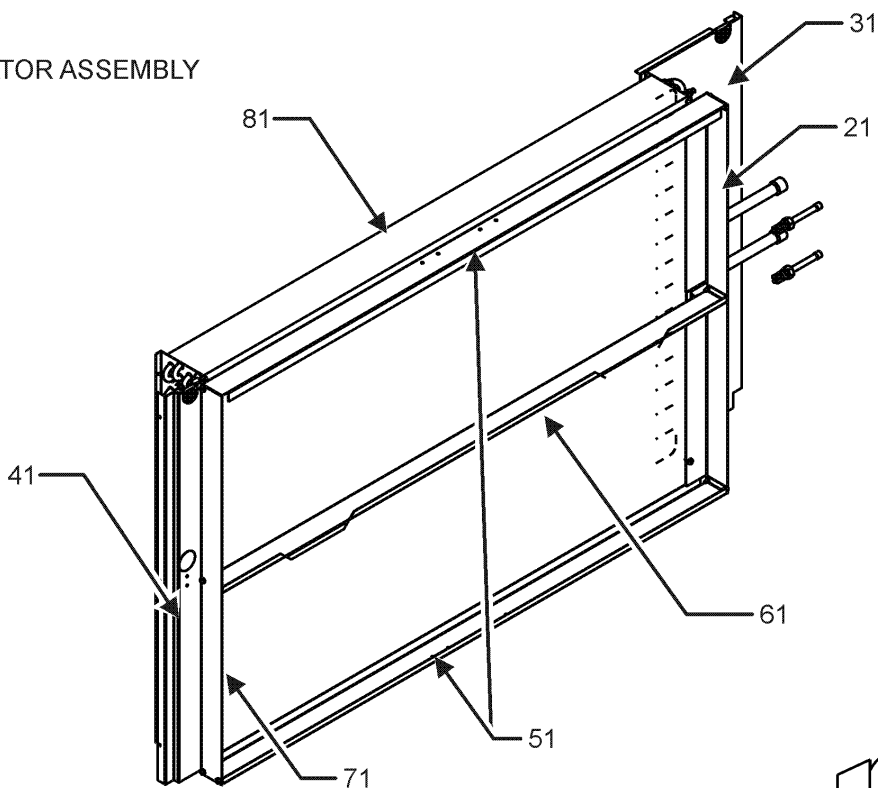

CONDENSER ASSEMBLY

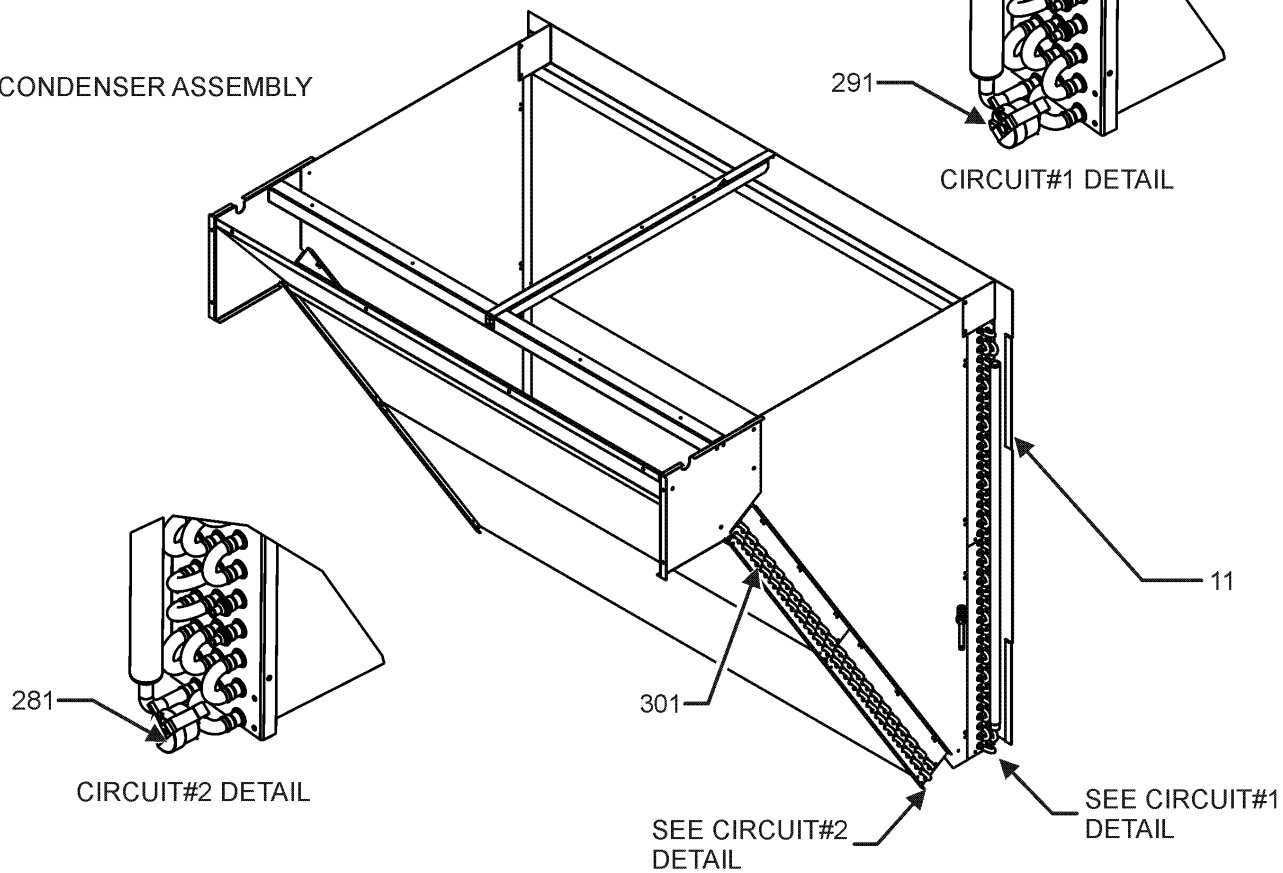

Evaporator and Condenser Assembly

Ref. Part No:	No:	Description:	Ref. Part No:	No:	Description:
Image 1:					
11	0201L00096	TUBING ASSY, COND COIL C1 (M1, M4, M5, M6, M7, M8, M9, M10, M11, M12, M13)			
21	0121L00650	FILTER ANGLE-VERTICAL (RETURN SIDE) (M1, M4, M5, M6, M7, M8, M9, M10, M11, M12, M13)			
31	0121L00210	EVAP EXTENSION-RETURN SIDE (M1, M4, M5, M6, M7, M8, M9, M10, M11, M12, M13)			
41	0121L00843	EVAP EXTENSION-HAIRPIN SIDE (M1, M4, M5, M6, M7, M8, M9, M10, M11, M12, M13)			
51	0121L00649	FILTER ANGLE - HORIZONTAL (M1, M4, M5, M6, M7, M8, M9, M10, M11, M12, M13)			
61	0121L01257	FILTER ANGLE - VERTICAL (M1, M4, M5, M6, M7, M8, M9, M10, M11, M12, M13)			
71	0121L00358	FILTER ANGLE-VERTICAL (HAIRPIN SIDE) (M1, M4, M5, M6, M7, M8, M9, M10, M11, M12, M13)			
81	0202L00050	EVAP COIL TUBING ASSY (M1, M4, M6, M7, M9, M10, M12)			
81	0202L00190	EVAP COIL TUBING ASSY (M5, M8, M11, M13)			
171	0121L00090	BLOWER TRANSITION, RH END (M1, M4, M5, M6, M7, M8, M9, M10, M11, M12, M13)			
191	0121L00092	BLOWER TRANSITION, FRONT (M1, M4, M5, M6, M7, M8, M9, M10, M11, M12, M13)			
281	0130M00102	CONTROL, DEFROST (M1, M4, M5, M6, M7, M8, M9, M10, M11, M12, M13)			
291	0130M00103	CONTROL, DEFROST (M1, M4, M5, M6, M7, M8, M9, M10, M11, M12, M13)			
301	0201L00097	TUBING ASSY, COND COIL C2 (M1, M4, M5, M6, M7, M8, M9, M10, M11, M12, M13)			
NS	0160L00175	AIR FILTER 16 X 24 X 2 (M1, M4, M5, M6, M7, M8, M9, M10, M11, M12, M13)			

Expanded Model Nomenclature

M1 - DCH102XXX3BAXXAA
M2 - DCH102XXX3BHDDAB
M3 - DCH102XXX3BXDXAB
M4 - DCH102XXX3BXXXAA
M5 - DCH102XXX3BXXXAB
M6 - DCH102XXX4BXXXAA
M7 - DCH102XXX4BXXXAB
M8 - DCH102XXX4BXXXAC
M9 - DCH102XXX7BXXXAA
M10 - DCH102XXX7BXXXAB
M11 - DCH102XXX7BXXXAC
M12 - DCH1020304BHXBAB
M13 - DCH1020454BXXBAC

Compressor and Partition Assembly

PARTITION PANEL ASSEMBLY

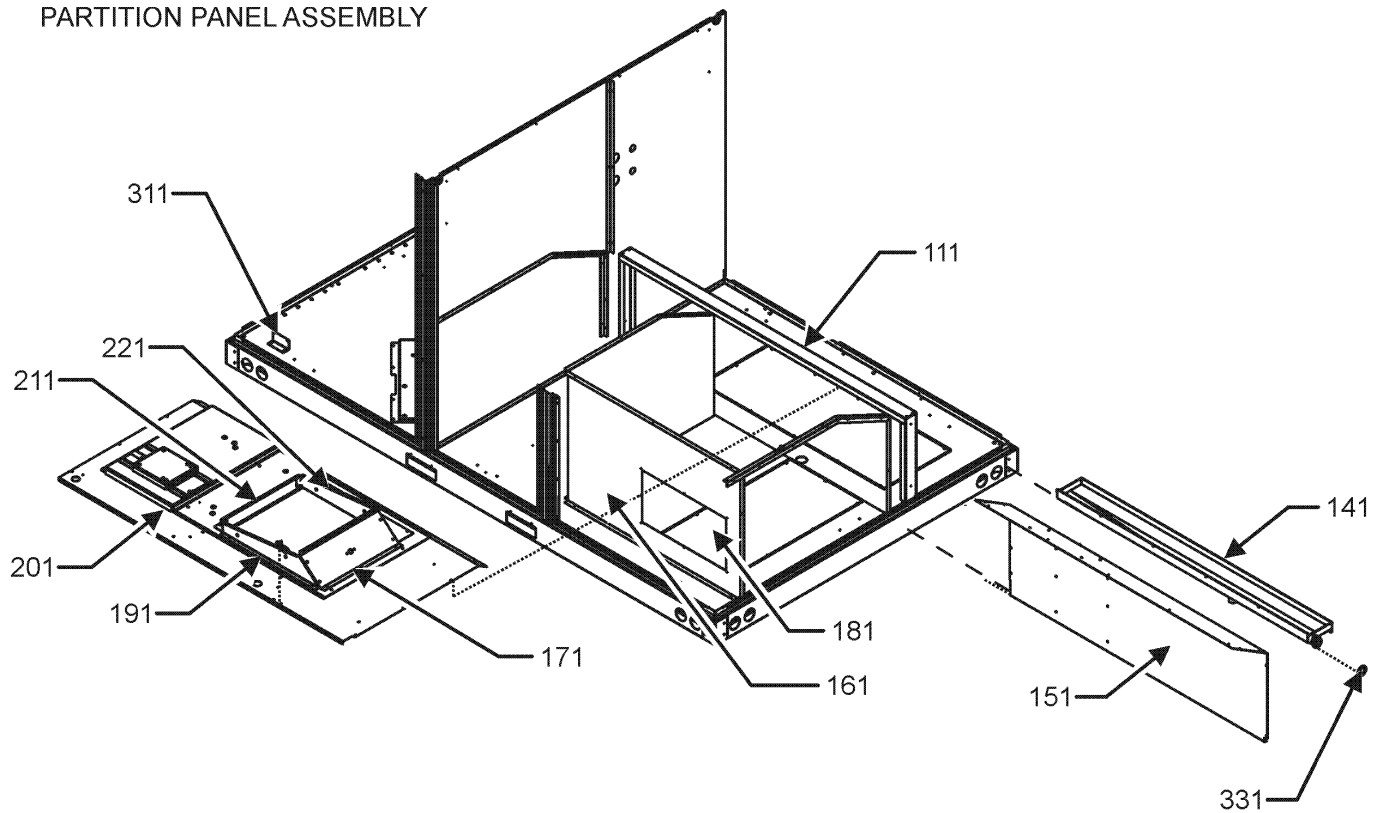

COMPRESSOR ASSEMBLY

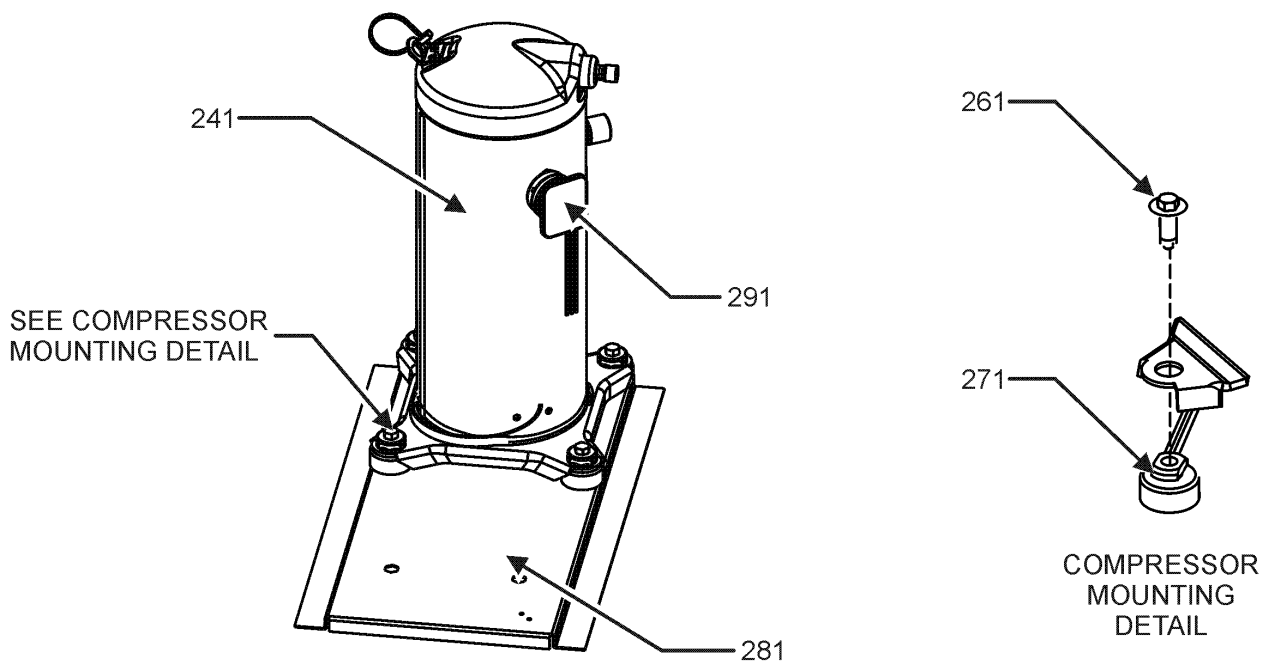

Compressor and Partition Assembly

Ref. Part No:	No:	Description:	Ref. Part No:	No:	Description:
Image 1:					
111	0121L00508	DRAIN PAN SUPPORT (M1, M4, M5, M6, M7, M8, M9, M10, M11, M12, M13)			
141	0161L00002	DRAIN PAN (M1, M4, M5, M6, M7, M8, M9, M10, M11, M12, M13)			
151	0121L00374	DECK SIDE CHANNEL			
161	0121L00365	ELECTRIC HEAT PANEL (M1, M4, M5, M6, M7, M8, M9, M10, M11, M12, M13)			
171	0121L00090	BLOWER TRANSITION, RH END (M1, M4, M5, M6, M7, M8, M9, M10, M11, M12, M13)			
181	0121L00177	ELECTRIC HEAT COVER (M1, M4, M5, M6, M7, M8, M9, M10, M11)			
191	0121L00092	BLOWER TRANSITION, FRONT (M1, M4, M5, M6, M7, M8, M9, M10, M11, M12, M13)			
201	0121L02106	DECK-BLOWER (M1, M4, M5, M6, M7, M8, M9, M10, M11, M12, M13)			
211	0121L00097	BLOWER TRANSITION, LH END (M1, M4, M5, M6, M7, M8, M9, M10, M11, M12, M13)			
221	0121L00145	BLOWER TRANSITION, BACK (M1, M4, M5, M6, M7, M8, M9, M10, M11, M12, M13)			
241	ZP44K5ETF5130	COMPRESSOR 44000, 200/230/60/3 (M1, M4, M5)			
241	ZP44K5ETFD130	COMPRESSOR 44000, 460/60/3 (M6, M7, M8, M12, M13)			
241	ZP44K5ETFE130	COMPRESSOR 44000, 575/60/3 (M9, M10, M11)			
261	M0221641	TF SHOULDER SCREW (M1, M4, M5, M6, M7, M8, M9, M10, M11, M12, M13)			
271	B1339533	COMPRESSOR GROMMET (M1, M4, M5, M6, M7, M8, M9, M10, M11, M12, M13)			
281	0121L02128	MOUNTING PLATE, COMP (QTY 2)			
291	0159L00066	COMPRESSOR SCROLL HARNESS (M1, M4, M5, M6, M7, M8, M9, M10, M11, M12, M13)			
311	0121L00513	BRACE-CONDENSER (M1, M4, M5, M6, M7, M8, M9, M10, M11, M12, M13)			
331	0154L00009	DRAIN PAN GASKET (M1, M4, M5, M6, M7, M8, M9, M10, M11, M12, M13)			
NS	0121L01398	DECK, SUPPORT BLOWER			
NS	0121L01402	DECK, SUPPORT CONTROL			
NS	0121L00321	SMOKE DETECTOR COVER (M1, M4, M5, M6, M7, M8, M9, M10, M11, M12, M13)			

Expanded Model Nomenclature

M1 - DCH102XXX3BAXXAA
M2 - DCH102XXX3BHDDAB
M3 - DCH102XXX3BXDXAB
M4 - DCH102XXX3BXXXAA
M5 - DCH102XXX3BXXXAB
M6 - DCH102XXX4BXXXAA
M7 - DCH102XXX4BXXXAB
M8 - DCH102XXX4BXXXAC
M9 - DCH102XXX7BXXXAA
M10 - DCH102XXX7BXXXAB
M11 - DCH102XXX7BXXXAC
M12 - DCH1020304BHXBAB
M13 - DCH1020454BXXBAC

Blower and Control Box Assembly

IMAGE 1

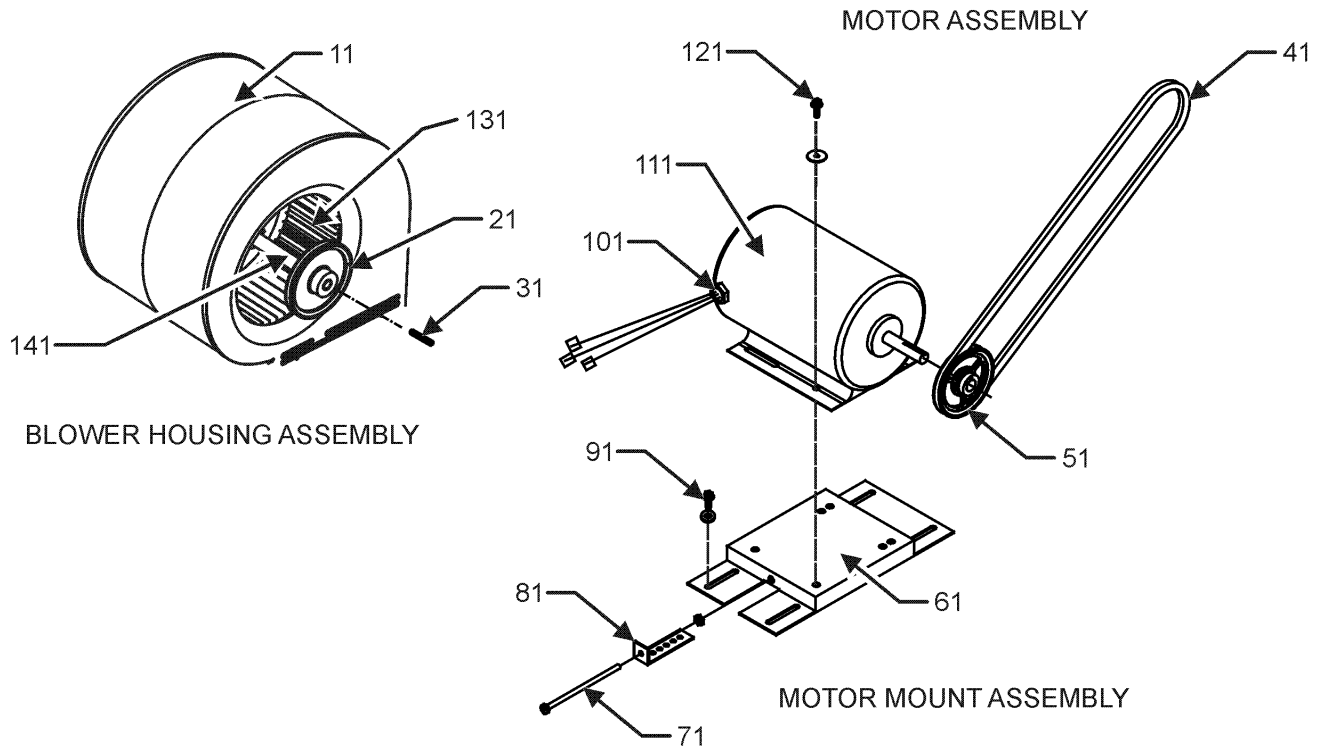
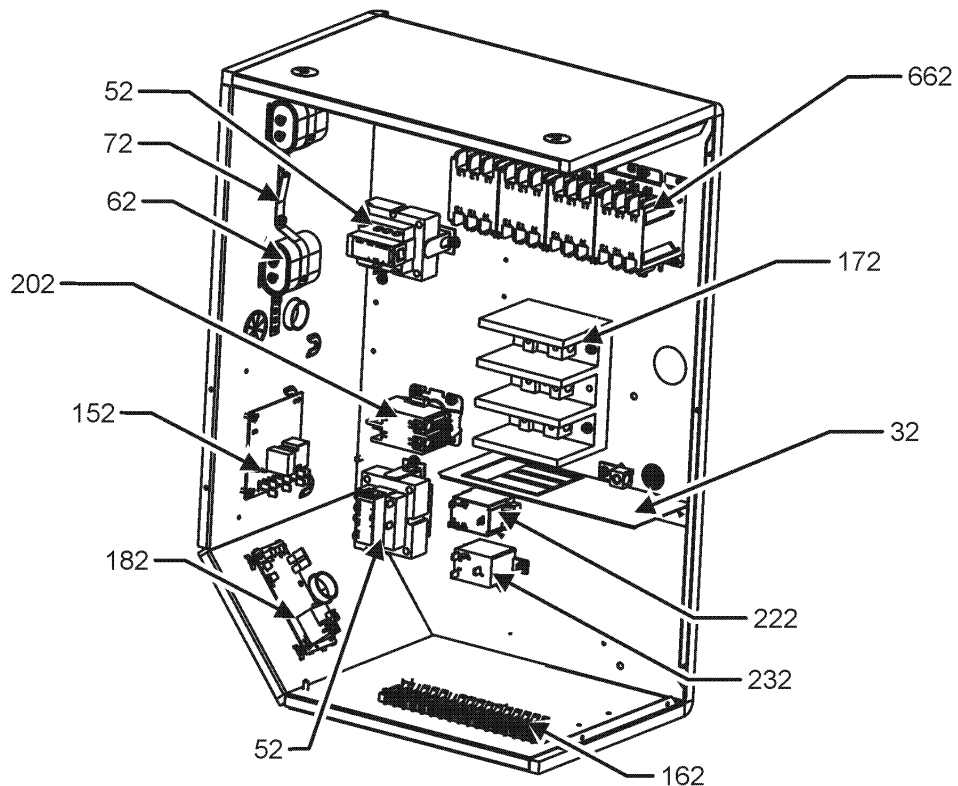

IMAGE 2



Blower and Control Box Assembly

Ref. Part No:	Ref. Part No:	Description:	Description:		
Image 1:		Image 2:			
11	04-01525	BLOWER HOUSING	152	PCBDM101	DEFROST CONTROL BOARD (M1, M4, M5, M6, M7, M8, M9, M10, M11, M12, M13)
21	0163L00134	SHEAVE, FIXED AK74H (M1, M4, M5, M6, M7, M8, M9, M10, M11, M12, M13)	162	0130M00038	TERMINAL BOARD (M1, M4, M5, M6, M7, M8, M9, M10, M11, M12, M13)
31	B1398604	STEEL KEY (000158812) 2.0" (M1, M4, M5, M6, M7, M8, M9, M10, M11, M12, M13)	172	0130M00042	BLOCK, DISTRIB. 7.5-25 TON (M1, M4, M5, M6, M7, M8, M9, M10, M11, M12, M13)
41	0164L00000	NOTCHED FAN BELT AX51	182	PCBFM103	ELECTRONIC BLOWER TIME DELAY (M1, M4, M5, M6, M7, M8, M9, M10, M11, M12, M13)
51	0163L00012	VARIABLE PITCH SHEAVE VL40	202	CONT2P040024V	CONTACTOR 40 AMP, 2P, 24V
61	0121L01504	MOTOR BASE (M1, M4, M5, M6, M7, M8, M9, M10, M11, M12, M13)	222	10135604	RELAY
71	0163M00045	BOLT 1/4-20 X 4"	232	0130M00242	RELAY, 24V
81	3225000F	BELT TIGHTENER ANGLE	662	CONT3P025024V	CONTACTOR 25 AMP, 3P, 24V (QTY 3)
91	B1446707	SCREW 5/16-18 X 1" (QTY 4)	Expanded Model Nomenclature		
101	B1393726	ELECT. CONNECTING BUSHING	M1 - DCH102XXX3BAXXAA		
111	B3240006	BELT DRIVE MOTOR 2 HP (M1, M2, M3, M4, M5, M6, M7, M8, M12, M13)	M2 - DCH102XXX3BHDDAB		
111	0131L00005	BELT DRIVE MOTOR 2 HP 575 V (M9, M10, M11)	M3 - DCH102XXX3BXDXAB		
121	B1393738	BOLT 1/4-20 X 3/4" (M1, M4, M5, M6, M7, M8, M9, M10, M11, M12, M13)	M4 - DCH102XXX3BXXXAA		
131	03-77429	BLOWER WHEEL	M5 - DCH102XXX3BXXXAB		
141	04-11525	BLOWER SHAFT	M6 - DCH102XXX4BXXXAA		
NS	04-02196	BEARING & FRAME ASSY	M7 - DCH102XXX4BXXXAB		
NS	0259L00303	COND FAN/TRANSFORMER HARNESS (M1, M4, M5, M6, M7, M8, M9, M10, M11, M12, M13)	M8 - DCH102XXX4BXXXAC		
NS	0259L00159	DEFROST BOARD HARNESS (M1, M4, M5, M6, M7, M8, M9, M10, M11, M12, M13)	M9 - DCH102XXX7BXXXAA		
NS	0259L00157	DEFROST RELAY HARNESS (M1, M4, M5, M6, M7, M8, M9, M10, M11, M12, M13)	M10 - DCH102XXX7BXXXAB		
NS	0259L00165	ECONOMIZER HARNESS (M1, M4, M5, M6, M7, M8, M9, M10, M11, M12, M13)	M11 - DCH102XXX7BXXXAC		
NS	0259L00092	HARNESS-SMOKE DETECTOR SENSOR	M12 - DCH1020304BHXBAB		
NS	0259L00032	LCM HARNESS, ELECTRIC HEAT (M1, M4, M5, M6, M7, M8, M9, M10, M11, M12, M13)	M13 - DCH1020454BXXBAC		
NS	0259L00502	WIRE HARNESS (M1, M4, M5, M6, M7, M8, M9, M10, M11, M12, M13)			
NS	0259L00148	WIRE HARNESS ASSY (M1, M4, M5, M6, M7, M8, M9, M10, M11, M12, M13)			
NS	0259L00150	WIRE HARNESS ASSY (M1, M4, M5, M6, M7, M8, M9, M10, M11, M12, M13)			
NS	0259L00151	WIRE HARNESS ASSY (M1, M4, M5, M6, M7, M8, M9, M10, M11, M12, M13)			
NS	0259L00156	WIRE HARNESS ASSY (M1, M4, M5, M6, M7, M8, M9, M10, M11, M12, M13)			
NS	0259L00158	WIRE HARNESS ASSY (M1, M4, M5, M6, M7, M8, M9, M10, M11, M12, M13)			
NS	0259L00090	WIRE HARNESS-SMOKE DETECTOR			
Image 2:					
32	0121G00491	VOLTAGE BARRIER			
52	0130M00144	TRANSFORMER (M1, M4, M5)			
52	0130M00145	TRANSFORMER 480V to 24V, 75VA (M6, M7, M8, M12, M13)			
52	0130M00148	TRANSFORMER 575V to 24V, 75VA (M9, M10, M11)			
62	CAP100000370LA	CAPACITOR 10/370V (M5, M8, M11, M13)			
62	CAP030000440LA	CAPACITOR 3/440V (M10)			
62	CAP050000370LA	CAPACITOR 5/370V (M1, M4, M6, M9)			
62	CAP075000370LA	CAPACITOR 7.5/370V (M7, M12)			
72	20520901	CAPACITOR STRAP (QTY 2)			

ACCESSORY PARTS LIST

NOTE: NOT ALL OPTIONS AVAILABLE FOR ALL PRODUCTS

1 LOW AMBIENT KITS

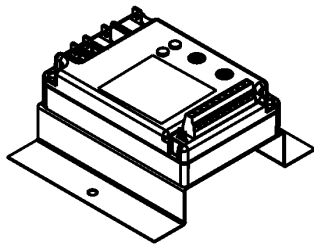

2 GFCI CONVENIENCE OUTLET

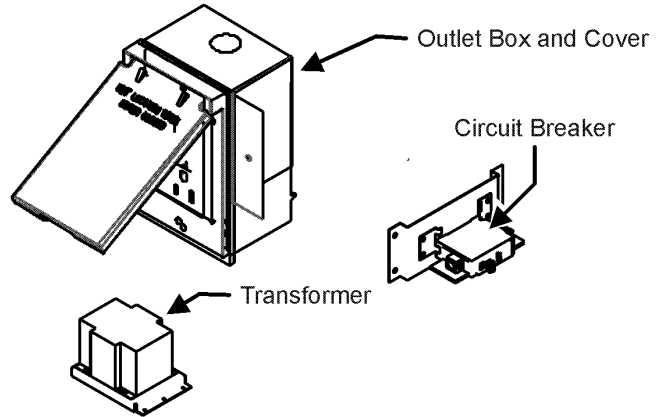

3 DISCONNECT MODULE (NON-FUSED)

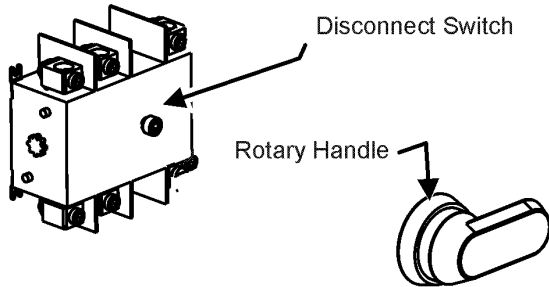

4 SMOKE DETECTORS

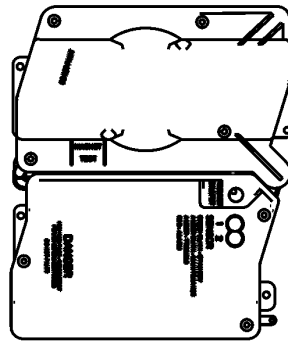

5 DDC CONTROL

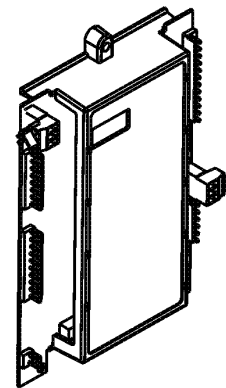

6 HINGED DOOR ASSEMBLIES

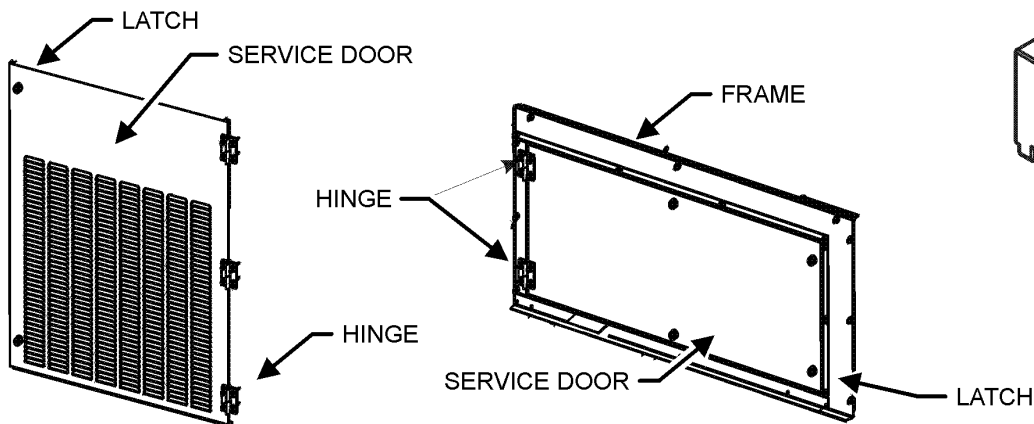

7 PHASE MONITOR

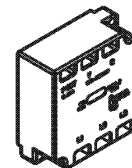

Accessory Parts

Ref. Part No:	Description:	Ref. Part No:	Description:
Image 1:			
NS EHK4-16	15 KW 460/3 (M13)		
NS 1036610B	7.5-12.5 TON DFLOW ECONOMIZER (M1)		
NS 0121L00316	BRACKET-CONV OUTLET MOUNT (M12, M13)		
NS 0121L00768	BRACKET-SMOKE DETECTOR (M2)		
NS 0130M00065	CIRCUIT BREAKER, CONVENIENCE OUTLET (M12, M13)		
NS 0121L00973NG	DISCONNECT SWITCH COVER (M2, M12)		
NS 0121L01397NG	DOOR FRAME, BLOWER (M2, M3)		
NS 0121L01406NG	DOOR FRAME, CONTROL (M2, M3)		
NS 0121L02481NG	DOOR, SERVICE, BACK, BLOWER (M2, M3)		
NS 0121L02480NG	DOOR, SERVICE, FRONT, BLOWER (M2, M3)		
NS EHK4-30	ELECTRIC HEATER KIT (M12)		
NS 0130L00012	GANG BOX-GFCI OUTLET (M12, M13)		
NS 0130L00039	HANDLE, ROTARY (M2, M12)		
NS 0163M00307	HINGE, LEFT HAND (M2, M3)		
NS 0163M00308	HINGE, RIGHT HAND (M2, M3)		
NS 0163M00322	LATCH (M2, M3)		
NS 0121L02220NG	PNT, DOOR FRAME FILTER (M2, M3)		
NS 0121L02223NG	PNT, SERVICE DOOR BACK FILTER (M2, M3)		
NS 0121L02218NG	PNT, SERVICE DOOR FRONT FILTER (M2, M3)		
NS 0161G00012	POWER OUTLET BOX (M12, M13)		
NS 0130L00103	RECEPTACLE-GFCI OUTLET (M12, M13)		
NS 0121L01404NG	SERVICE DOOR BACK, CONTROL (M2, M3)		
NS 0121L01403NG	SERVICE DOOR FRONT, CONTROL (M2, M3)		
NS 0130L00043	SHAFT, CUT (M2)		
NS 0130L00056	SHAFT, CUT (M12)		
NS 0130L00049	SHAFT, DISCONNECT (M2, M12)		
NS D4120	SMOKE DETECTOR, PHOTO 4WIRE (M2)		
NS 0130L00027	SWITCH-DISCONNECT 100A (M12)		
NS 0130L00033	SWITCH-DISCONNECT 200A (M2)		
NS 0130M00061	TRANSFORMER, CONVENIENCE OUTLET (M12, M13)		

Expanded Model Nomenclature

- M1 - DCH102XXX3BAXXAA
- M2 - DCH102XXX3BHDDAB
- M3 - DCH102XXX3BXDXAB
- M4 - DCH102XXX3BXXXAA
- M5 - DCH102XXX3BXXXAB
- M6 - DCH102XXX4BXXXAA
- M7 - DCH102XXX4BXXXAB
- M8 - DCH102XXX4BXXXAC
- M9 - DCH102XXX7BXXXAA
- M10 - DCH102XXX7BXXXAB
- M11 - DCH102XXX7BXXXAC
- M12 - DCH1020304BHXBAB
- M13 - DCH1020454BXXBAC