

Commercial 6 Ton Package Heat Pump

DCH0720103BHXMAB
DCH0720104BJXFAC
DCH0720153BXXCAB
DCH0720153BXXLAA
DCH0720154BH XOAC
DCH0720157BJXXAB
DCH0720203BAXNAB
DCH0720203BHXXAA
DCH0720204BAXBAB
DCH0720204BXXAAB
DCH072XXX3BAXHAB
DCH072XXX3BAXZAB
DCH072XXX3BJXLAA
DCH072XXX3BXXBAA
DCH072XXX3BXXJAB
DCH072XXX3BXXOAA
DCH072XXX3BXXWAA
DCH072XXX3BXXXAA
DCH072XXX3BXXXAB
DCH072XXX3BXXXAC
DCH072XXX4BXXBAC
DCH072XXX4BXXXAA
DCH072XXX4BXXXAB
DCH072XXX4BXXXAC
DCH072XXX4BXXXAD
DCH072XXX7BXXXAA
DCH072XXX7BXXXAB



This manual is to be used by qualified technicians only.

This manual replaces RP-D1034J.

Important Information

Index

Functional Parts List	3
Illustration and Parts	4 - 13

Views shown are for parts illustrations only, not servicing procedures

Text Codes:

AR - As Required

NA - Not Available

NS - Not Shown

00000000 - See Note

QTY - Quantity Example (QTY 3) (If Quantity not shown, Quantity = 1)

M - Model Example (M1) (If M Code not shown, then part is used on all Models)

Expanded Model Nomenclature:

Example M1 - Model#1 M2 - Model#2 M3 - Model#3

Daikin Company, L.P. is not responsible for personal injury or property damage resulting from improper service. Review all service information before beginning repairs.

Warranty service must be performed by an authorized technician, using authorized factory parts. If service is required after the warranty expires, Daikin Company, L.P. also recommends contacting an authorized technician and using authorized factory parts.

Daikin Company, L.P. reserves the right to discontinue, or change at any time, specifications or designs without notice or without incurring obligations.

For assistance within the U.S.A. contact:

Equipment Support
Daikin North America, LLC
19001 Kermier Road
Waller, Texas 77484
855-770-5678-Telephone
713-863-2382-Facsimile

For assistance outside the U.S.A. contact:

International Division
Daikin North America, LLC
19001 Kermier Road
Waller, Texas 77484
713-861-2500-Telephone
713-863-2382-Facsimile

Functional Parts

Part No: **Description:**

0130M00025	24V RELAY (M11, M12, M13, M14, M15, M16, M17, M19, M22, M23, M26, M27)
B1368056	BELT DRIVE BLOWER WHEEL
B3240007	BELT DRIVE MOTOR 1.5 HP (M1, M2, M3, M4, M5, M6, M7, M8, M9, M10, M11, M12, M13, M14, M15, M18, M19, M20, M21, M22, M24, M25, M26, M27)
0131L00004	BELT DRIVE MOTOR 1.5 HP 575V (M16, M17, M23)
CAP100000440LA	CAP 10 MFD/440V/OVAL (M1, M2, M5, M9, M10, M11, M14, M15, M18, M19, M20, M22, M24)
CAP100000370LA	CAPACITOR 10/370V (M3, M4, M6, M7, M8, M13, M21, M25, M26, M27)
CAP050000370LA	CAPACITOR 5/370V (M12, M16)
CAP050000440LA	CAPACITOR 5/440V (M17, M23)
ZP61KCETF5130	COMPRESSOR 61500, 200/230/60/3 (M1, M2, M3, M4, M5, M6, M7, M8, M9, M10, M18, M20, M21, M24, M25)
ZP61KETFDF130	COMPRESSOR 61500, 460/60/3 (M11, M12, M13, M14, M15, M19, M22, M26, M27)
ZP61KETFDFE130	COMPRESSOR 61500, 575/60/3 (M16, M17, M23)
0131M00430	COND MOTOR 1/3 HP, 1 SP, 6 PL (M1, M2, M3, M4, M5, M6, M7, M8, M9, M10, M18, M20, M21, M24, M25)
B13400249	COND MOTOR 1/3 HP, 460V (M12)
0131M00179	COND MOTOR 1/3 HP, 6 PL, 575V (M16)
0131M00500	COND MOTOR 1/3 HP, OD, LAK (M17, M23)
CONT3P025024V	CONTACTOR 25 AMP, 3P, 24V (M11, M12, M13, M14, M15, M16, M17, M19, M22, M23, M26, M27)
CONT3P030024V	CONTACTOR 30 AMP, 3P, 24V (M1, M2, M3, M4, M5, M6, M7, M8, M9, M10, M18, M20, M21, M24, M25)
0130M00101	CONTROL, DEFROST
0130L00019	CRANK CASE HEATER, 70W, 575V (M16, M17, M23)
0130L00017	CRANK CASE HEATER-70W 240V (M1, M2, M3, M4, M5, M6, M7, M8, M9, M10, M18, M20, M21, M24, M25)
0130L00018	CRANK CASE HEATER-70W, 480V (M11, M12, M13, M14, M15, M19, M22, M26, M27)
0130M00074	CUT-OUT SWITCH, HIGH PRESSURE
0130M00075	CUT-OUT SWITCH, LOW PRESSURE
PCBDM133	DEFROST CONTROL BOARD
0130M00106	DISC THERMOSTAT CRNKCS HTR SW
PCBFM103	ELECTRONIC BLOWER TIME DELAY
0164L00010	FAN BELT, NOTCHED
0150G00004	FAN BLADE (M16, M17, M23)
B1086765	FAN BLADE TYPE 3 (M1, M2, M3, M4, M5, M6, M7, M8, M9, M10, M11, M12, M13, M14, M15, M18, M19, M20, M21, M22, M24, M25, M26, M27)
0131M00774	MOTOR, 1/3 HP, OD (M11, M13, M14, M15, M19, M22, M26, M27)
0151R00071	REVERSING VALVE
B1225022	SOLENOID COIL
0130M00038	TERMINAL BOARD
0130M00144	TRANSFORMER (M1, M2, M5, M9, M10, M18, M20, M24)
0130M00138	TRANSFORMER 208/230, 24V (M3, M4, M6, M7, M8, M21, M25)
0130M00145	TRANSFORMER 480V to 24V, 75VA (M11, M12, M13, M14, M15, M19, M22, M26, M27)

0130M00148 TRANSFORMER 575V to 24V, 75VA (M16, M17, M23)

Expanded Model Nomenclature

M1 - DCH072XXX3BAXHAB
M2 - DCH072XXX3BAXZAB
M3 - DCH072XXX3BJXLAA
M4 - DCH072XXX3BXXBAA
M5 - DCH072XXX3BXXJAB
M6 - DCH072XXX3BXXOAA
M7 - DCH072XXX3BXXWAA
M8 - DCH072XXX3BXXXAA
M9 - DCH072XXX3BXXXAB
M10 - DCH072XXX3BXXXAC
M11 - DCH072XXX4BXXBAC
M12 - DCH072XXX4BXXXAA
M13 - DCH072XXX4BXXXAB
M14 - DCH072XXX4BXXXAC
M15 - DCH072XXX4BXXXAD
M16 - DCH072XXX7BXXXAA
M17 - DCH072XXX7BXXXAB
M18 - DCH0720103BHXMBAB
M19 - DCH0720104BJXFAC
M20 - DCH0720153BXXCAB
M21 - DCH0720153BXXLAA
M22 - DCH0720154BHXXOAC
M23 - DCH0720157BJXXAB
M24 - DCH0720203BAXNAB
M25 - DCH0720203BHXAA
M26 - DCH0720204BAXBAB
M27 - DCH0720204BXXAAB

Top Panel and Tubing Assembly

IMAGE 1

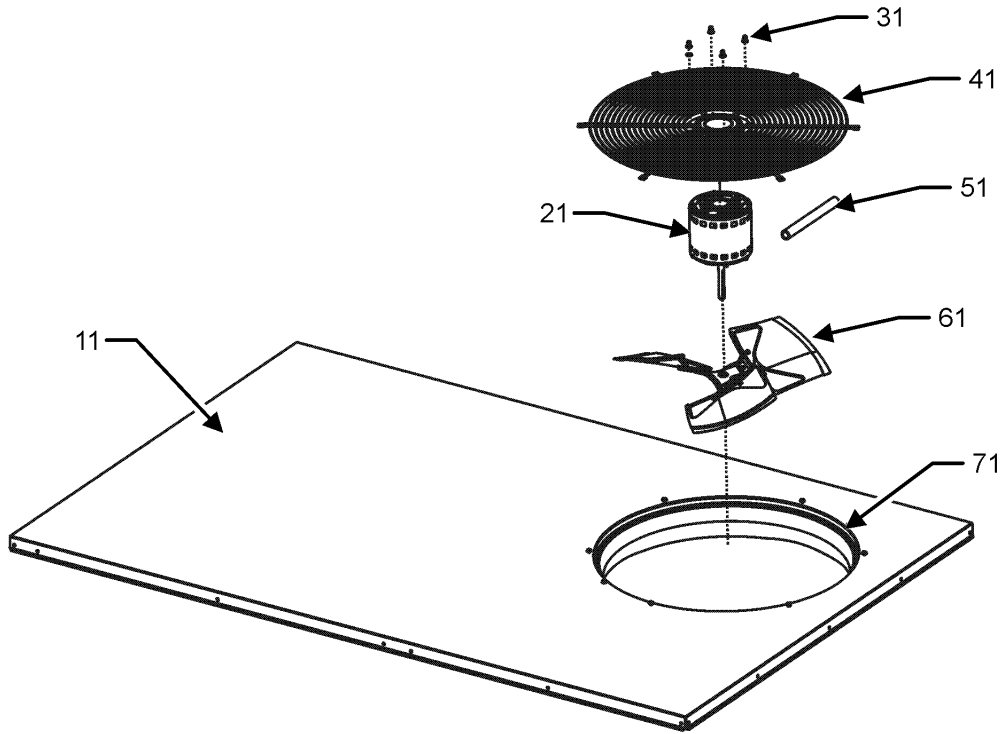
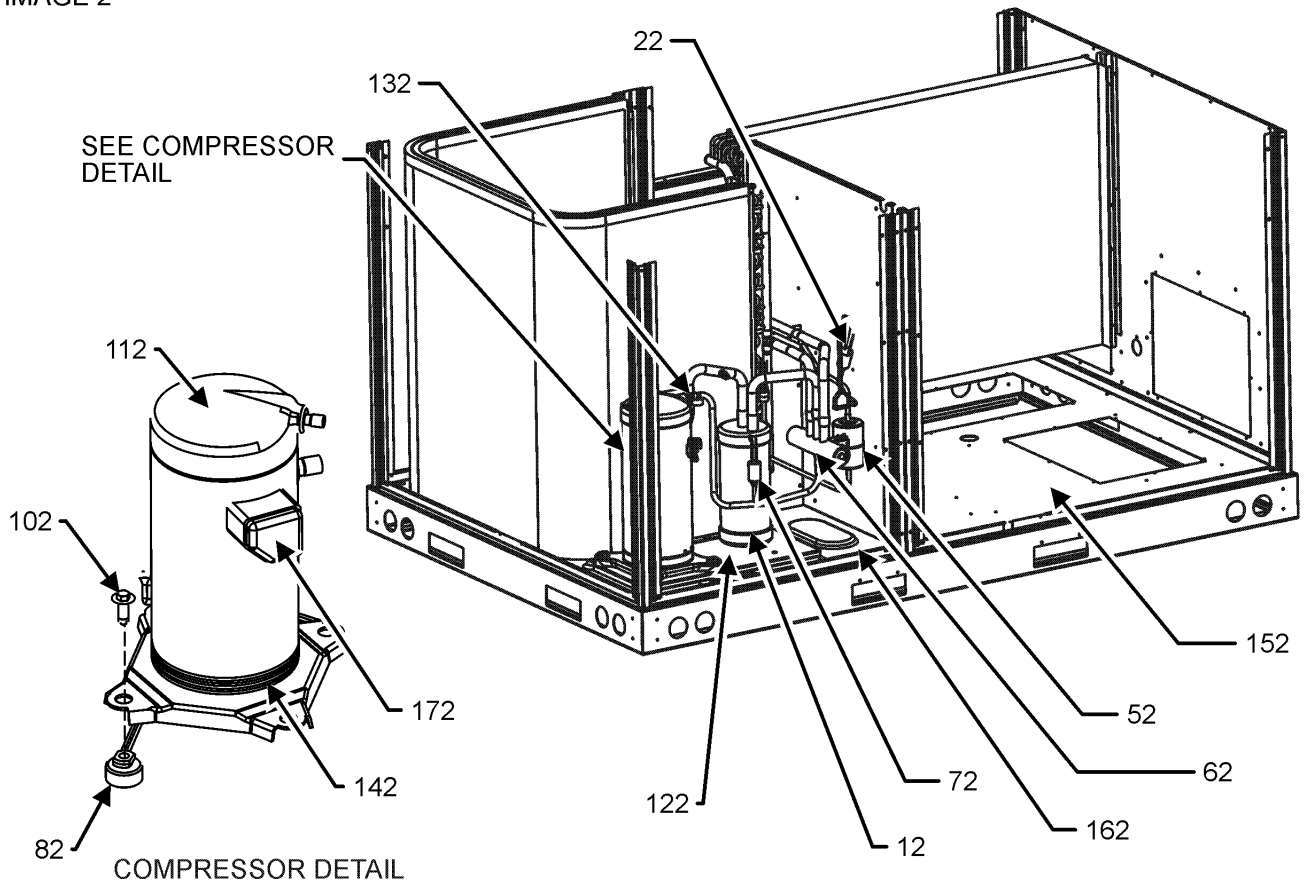

IMAGE 2



Top Panel and Tubing Assembly

**Ref. Part
No: No:**

Description:

**Ref. Part
No: No:**

Description:

Image 1:

11	0121L00235NG	TOP PANEL
21	0131M00430	COND MOTOR 1/3 HP, 1 SP, 6 PL (M1, M2, M3, M4, M5, M6, M7, M8, M9, M10, M18, M20, M21, M24, M25)
21	B13400249	COND MOTOR 1/3 HP, 460V (M12)
21	0131M00179	COND MOTOR 1/3 HP, 6 PL, 575V (M16)
21	0131M00500	COND MOTOR 1/3 HP, OD, LAK (M17, M23)
21	0131M00774	MOTOR, 1/3 HP, OD (M11, M13, M14, M15, M19, M22, M26, M27)
31	0163M00006P	ACORN NUT 5/16 HEX BLACK (QTY 4)
41	0152G00003	FAN GRILLE
51	17788000083F	PVC CONDUIT 8.25"
61	0150G00004	FAN BLADE (M16, M17, M23)
61	B1086765	FAN BLADE TYPE 3 (M1, M2, M3, M4, M5, M6, M7, M8, M9, M10, M11, M12, M13, M14, M15, M18, M19, M20, M21, M22, M24, M25, M26, M27)
71	0161L00000	VENTURI RING 22"
NS	0163M00004	SCREW #10X3/4", BLACK (QTY 8)
NS	0163M00005P	WASHER, BLACK (.50 OD .218ID) (QTY 4)

Image 2:

12	B1226207	ACCUMULATOR .875
22	0130M00075	CUT-OUT SWITCH, LOW PRESSURE
52	20485201	BI-FLOW FILTER DRIER
62	0151R00071	REVERSING VALVE
72	0130M00074	CUT-OUT SWITCH, HIGH PRESSURE
82	B1339533	COMPRESSOR GROMMET (QTY 4)
102	M0221641	TF SHOULDER SCREW (QTY 4)
112	ZP61KCETF5130	COMPRESSOR 61500, 200/230/60/3 (M1, M2, M3, M4, M5, M6, M7, M8, M9, M10, M18, M20, M21, M24, M25)
112	ZP61KCETFD130	COMPRESSOR 61500, 460/60/3 (M11, M12, M13, M14, M15, M19, M22, M26, M27)
112	ZP61KCETFE130	COMPRESSOR 61500, 575/60/3 (M16, M17, M23)
122	0121L01308	MOUNTING PLATE-COMPRESSOR
132	0130M00106	DISC THERMOSTAT CRNKCS HTR SW
142	0130L00019	CRANK CASE HEATER, 70W, 575V (M16, M17, M23)
142	0130L00017	CRANK CASE HEATER-70W 240V (M1, M2, M3, M4, M5, M6, M7, M8, M9, M10, M18, M20, M21, M24, M25)
142	0130L00018	CRANK CASE HEATER-70W, 480V (M11, M12, M13, M14, M15, M19, M22, M26, M27)
152	0121L02619	BASE PAN, INDOOR
162	0121L01990	BASE PAN, OUTDOOR
172	0159L00065	COMPRESSOR SCROLL HARNESS
NS	B1373315	ACCESS FITTING (QTY 2)
NS	0163M00175	CAP WITH O-RING (QTY 2)
NS	B1225022	SOLENOID COIL

Expanded Model Nomenclature

M1 - DCH072XXX3BAXHAB
M2 - DCH072XXX3BAXZAB
M3 - DCH072XXX3BJXLAA
M4 - DCH072XXX3BXXBAA
M5 - DCH072XXX3BXXJAB
M6 - DCH072XXX3BXXOAA
M7 - DCH072XXX3BXXWAA
M8 - DCH072XXX3BXXXAA
M9 - DCH072XXX3BXXXAB
M10 - DCH072XXX3BXXXAC
M11 - DCH072XXX4BXXBAC
M12 - DCH072XXX4BXXXAA
M13 - DCH072XXX4BXXXAB
M14 - DCH072XXX4BXXXAC
M15 - DCH072XXX4BXXXAD
M16 - DCH072XXX7BXXXAA
M17 - DCH072XXX7BXXXAB
M18 - DCH0720103BHXMAB
M19 - DCH0720104BJXFAC
M20 - DCH0720153BXXCAB
M21 - DCH0720153BXXLAA
M22 - DCH0720154BHXXOAC
M23 - DCH0720157BJXXAB
M24 - DCH0720203BAXNAB
M25 - DCH0720203BHXXXAA
M26 - DCH0720204BAXBAB
M27 - DCH0720204BXXAAB

Cabinet Assembly

IMAGE 1

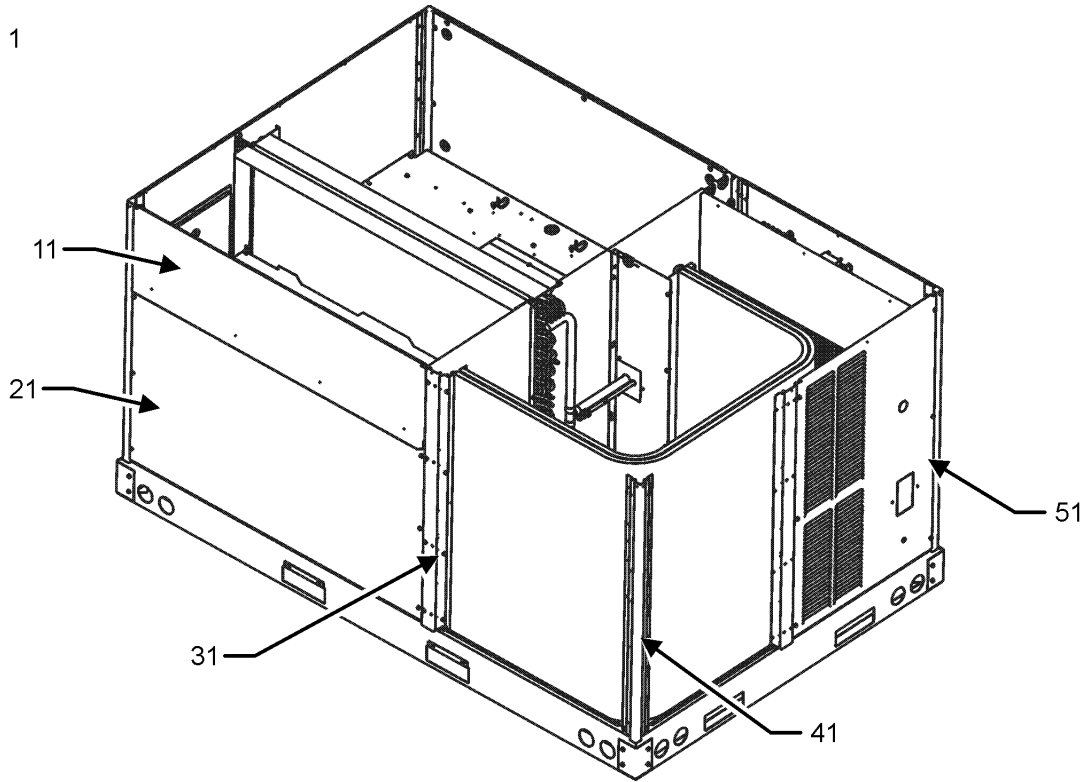
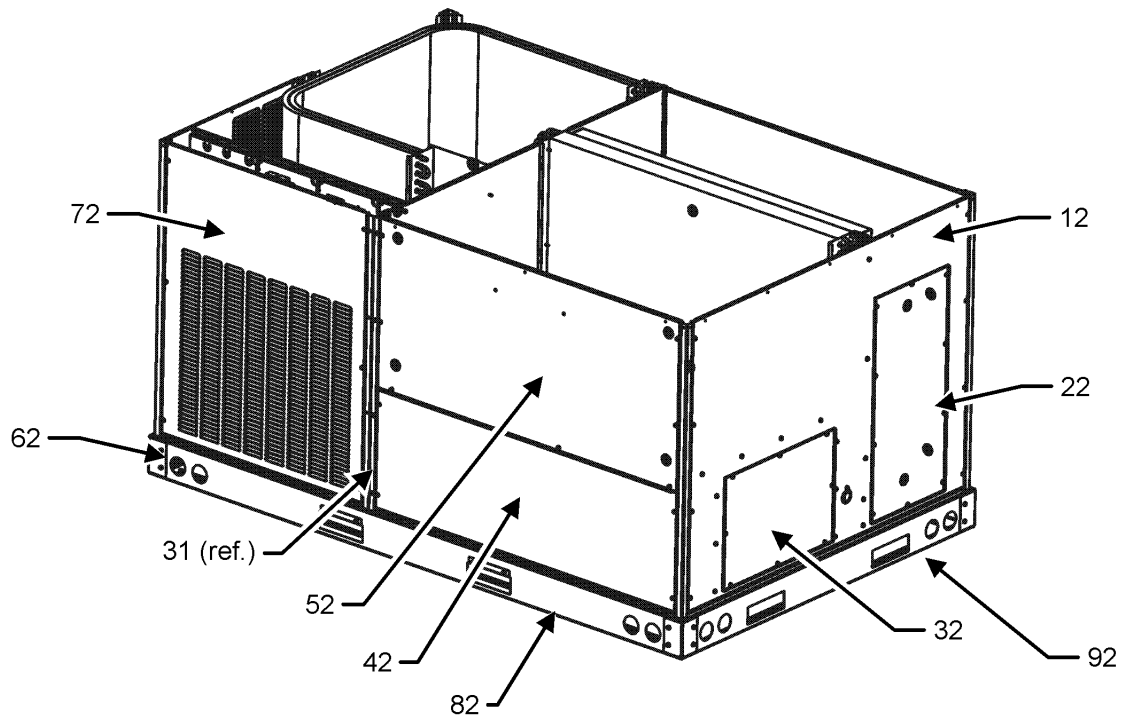

IMAGE 2



Cabinet Assembly

Ref. Part No:	Description:	Ref. Part No:	Description:
Image 1:		Expanded Model Nomenclature	
11	0270L00363NG FILTER DOOR	M1	DCH072XXX3BAXHAB
21	0121L00976NG ECONOMIZER DOOR (M2, M4, M5, M6, M7, M8, M9, M10, M11, M12, M13, M14, M15, M16, M17, M18, M20, M21, M22, M25, M27)	M2	DCH072XXX3BAXZAB
31	0121L00343RFNG POST-SIDE RF PAINTED (QTY 2)	M3	DCH072XXX3BJXLAA
31	0121L01169RFNG SIDE POST (M1, M2, M5, M9, M10, M11, M14, M15, M17, M18, M19, M20, M22, M23, M24)	M4	DCH072XXX3BXXBAA
41	0121L00344RFNG CORNER POST (QTY 4)	M5	DCH072XXX3BXXJAB
51	0121L00354NG LOUVERED COMPRESSOR PANEL (M1, M2, M4, M5, M6, M7, M8, M9, M10, M11, M12, M13, M14, M15, M16, M17, M20, M21, M24, M26, M27)	M6	DCH072XXX3BXXOAA
51	0121L00354NG LOUVERED COMPRESSOR PANEL	M7	DCH072XXX3BXXWAA
51	0121L00840NG LOUVERED COMPRESSOR PANEL (M3, M18, M19, M22, M23, M25)	M8	DCH072XXX3BXXXAA
NS	0121L01309 ECONOMIZER COVER (M1, M2, M3, M19, M23, M24, M26)	M9	DCH072XXX3BXXXAB
NS	0164L00009 GASKET-RUBBER, CPOST (QTY 3)	M10	DCH072XXX3BXXXAC
NS	0164L00011 GASKET-RUBBER, SIDE POST (QTY 2)	M11	DCH072XXX4BXXBAC
Image 2:		M12	DCH072XXX4BXXXAA
12	0121L00342NG DUCT PANEL	M13	DCH072XXX4BXXXAB
22	0121L00023NG RETURN DUCT COVER	M14	DCH072XXX4BXXXAC
32	0121L00024NG SUPPLY DUCT COVER	M15	DCH072XXX4BXXXAD
42	0121L00279NG ELECTRIC HEAT DOOR (M3, M4, M6, M7, M8, M12, M13, M16, M21, M25, M26, M27)	M16	DCH072XXX7BXXXAA
42	0121L01176NG ELECTRIC HEAT DOOR (M1, M2, M5, M9, M10, M11, M14, M15, M17, M18, M19, M20, M22, M23, M24)	M17	DCH072XXX7BXXXAB
52	0121L00346NG BLOWER DOOR (M3, M4, M6, M7, M8, M12, M13, M16, M21, M25, M26, M27)	M18	DCH0720103BHXMA B
52	0121L01172NG BLOWER DOOR (M1, M2, M5, M9, M10, M11, M14, M15, M17, M18, M19, M20, M22, M23, M24)	M19	DCH0720104BJXFAC
62	0121G00301 RAIL CORNER BRACKET (QTY 4)	M20	DCH0720153BXXCAB
72	0121L00353NG LOUVERED CONTROL PANEL (M3, M4, M6, M7, M8, M12, M13, M16, M21, M25, M26, M27)	M21	DCH0720153BXXLAA
72	0121L01170NG LOUVERED CONTROL PANEL (M1, M2, M5, M9, M10, M11, M14, M15, M17, M18, M19, M20, M22, M23, M24)	M22	DCH0720154BH XOAC
82	0121L00244RF SIDE RAIL (QTY 2)	M23	DCH0720157BJXXAB
92	0121L00245 END RAIL (QTY 2)	M24	DCH0720203BAXNAB
		M25	DCH0720203BHXXAA
		M26	DCH0720204BAXBAB
		M27	DCH0720204BXXAAB

Condenser/Evaporator/Partition Assembly

EVAPORATOR ASSEMBLY

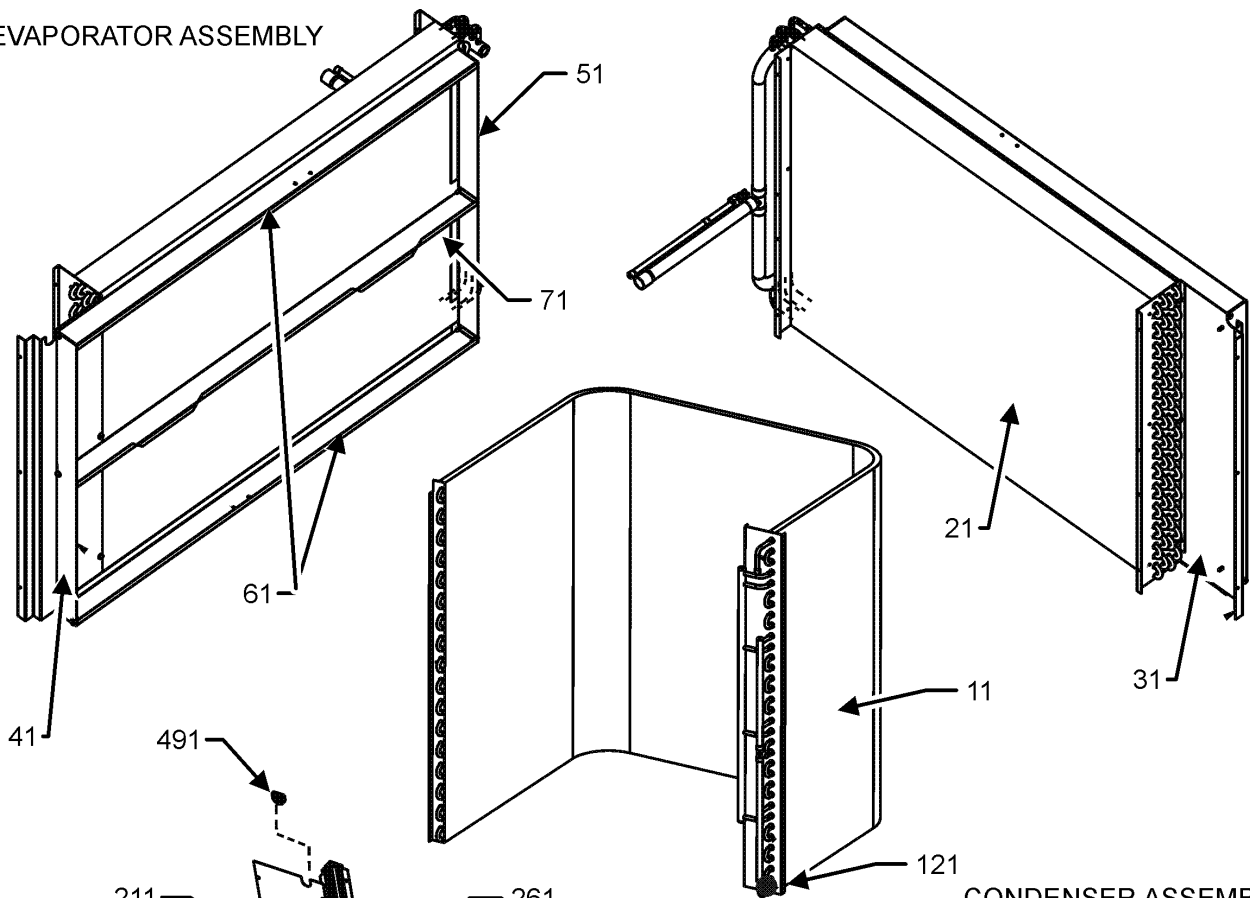

CONDENSER ASSEMBLY

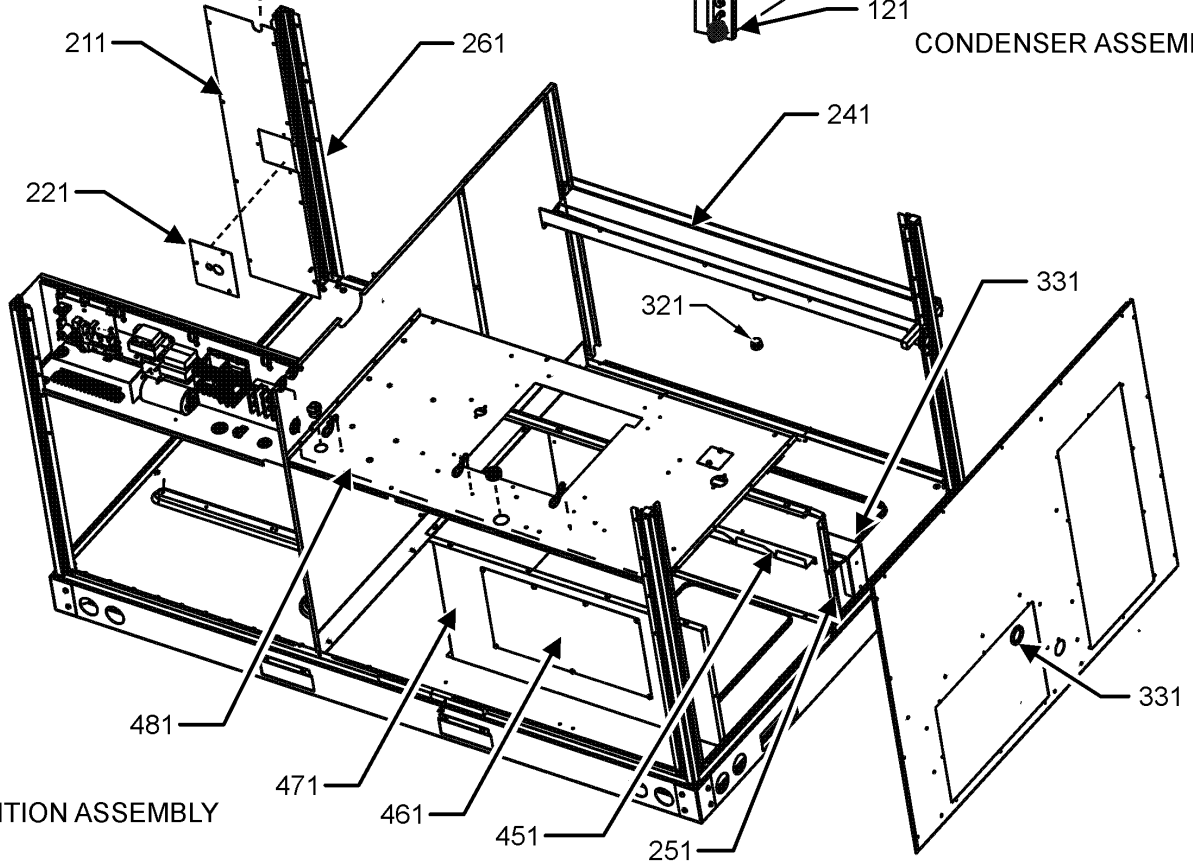

PARTITION ASSEMBLY

Condenser/Evaporator/Partition Assembly

Ref. Part No: No:	Description:	Ref. Part No: No:	Description:
Image 1:		Expanded Model Nomenclature	
11	0201L00053	TUBING ASSY, COND COIL	M1 - DCH072XXX3BAXHAB
21	0202L00032	TUBING ASSY, EVAP COIL	M2 - DCH072XXX3BAXZAB
31	0121L00345	BLOCKOFF-EVAPORATOR	M3 - DCH072XXX3BJXLAA
41	0121L00358	FILTER ANGLE-VERTICAL (HAIRPIN SIDE)	M4 - DCH072XXX3BXXBAA
51	0121L00357	FILTER ANGLE-VERTICAL (RETURN SIDE)	M5 - DCH072XXX3BXXJAB
61	0121L00932	FILTER ANGLE-HORIZONTAL (QTY 2)	M6 - DCH072XXX3BXXOAA
71	0121L01255	ANGLE-FILTER CENTER	M7 - DCH072XXX3BXXWAA
121	0130M00101	CONTROL, DEFROST	M8 - DCH072XXX3BXXXAA
211	0121L00348	COND BLOCK-OFF	M9 - DCH072XXX3BXXXAB
221	0121L00939	CONDENSER BLOCKOFF PLATE	M10 - DCH072XXX3BXXXAC
231	0121L00238	DRAIN PAN SUPPORT	M11 - DCH072XXX4BXXBAC
241	0161L00005	DRAIN PAN	M12 - DCH072XXX4BXXXAA
251	0121L02123	CHANNEL-DECK SIDE	M13 - DCH072XXX4BXXXAB
261	0121L00349	COND MOUNTING ANGLE	M14 - DCH072XXX4BXXXAC
321	0163L00071	DRAIN PLUG	M15 - DCH072XXX4BXXXAD
331	0154L00009	DRAIN PAN GASKET	M16 - DCH072XXX7BXXXAA
451	0121L00288	ELECTRIC HEAT RETAINER	M17 - DCH072XXX7BXXXAB
461	0121L00144	ELECTRIC HEAT COVER	M18 - DCH0720103BHXMAB
471	0121L00256	ELECTRIC HEAT PANEL	M19 - DCH0720104BJXFAC
481	0121L01205	BLOWER DECK (M3, M4, M6, M7, M8, M12, M13, M16, M21, M25, M26, M27)	M20 - DCH0720153BXXCAB
481	0121L01575	BLOWER DECK (M1, M2, M5, M9, M10, M11, M14, M15, M17, M18, M19, M20, M22, M23, M24)	M21 - DCH0720153BXXLAA
491	A4568804	GROMMET-D (QTY 4)	M22 - DCH0720154BHXXOAC
NS	0160L00174	AIR FILTER 16 X 20 X 2 (M1, M2, M3, M4, M5, M6, M7, M8, M9, M10, M11, M13, M14, M15, M16, M17, M18, M19, M20, M21, M22, M23, M24, M25, M26, M27)	M23 - DCH0720157BJXXAB
NS	B1369608	AIR FILTER 20 X 16 X 2 (M12)	M24 - DCH0720203BAXNAB
NS	0121L00321	SMOKE DETECTOR COVER	M25 - DCH0720203BHXXXAA
			M26 - DCH0720204BAXBAB
			M27 - DCH0720204BXXAAB

Blower and Control Panel Assembly

IMAGE 1

BLOWER HOUSING AND MOTOR ASSEMBLY

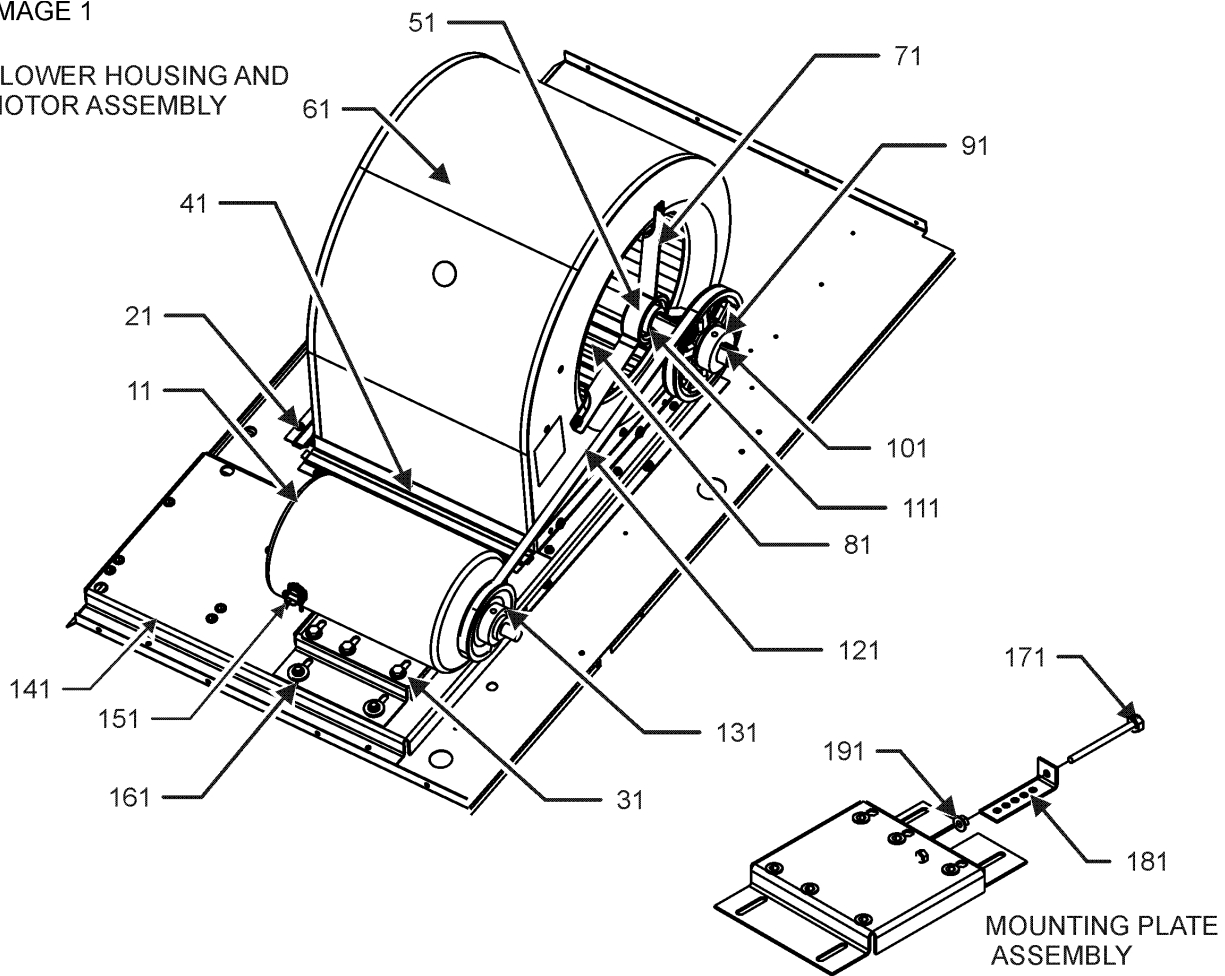
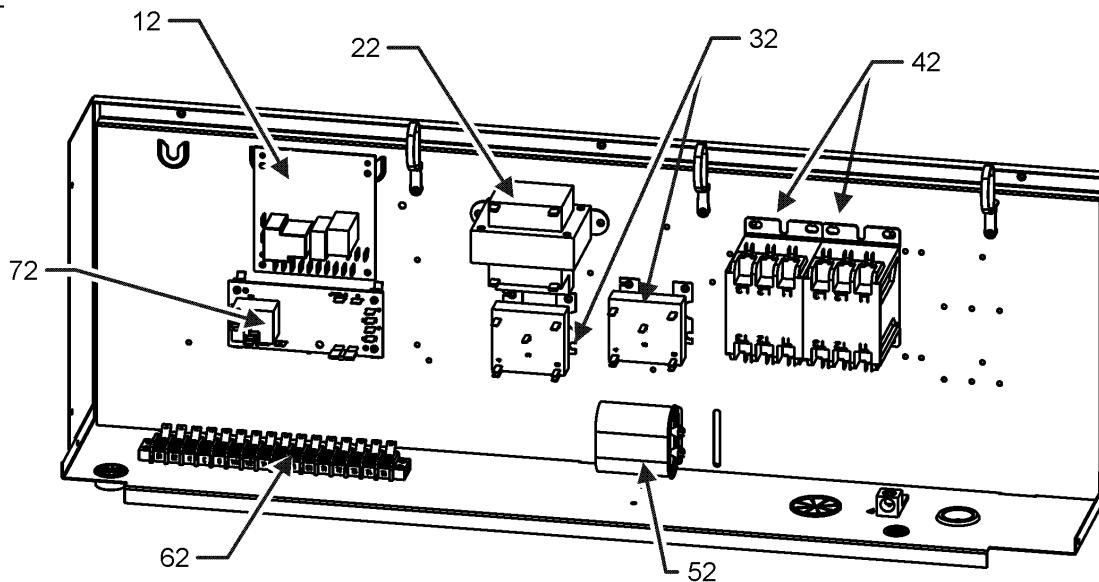

IMAGE 2



Blower and Control Panel Assembly

Ref. Part No: No:	Description:	Ref. Part No: No:	Description:
Image 1:		Image 2:	
11 B3240007	BELT DRIVE MOTOR 1.5 HP (M1, M2, M3, M4, M5, M6, M7, M8, M9, M10, M11, M12, M13, M14, M15, M18, M19, M20, M21, M22, M24, M25, M26, M27)	NS 0259L00078	DEFROST HARNESS (M11, M12, M13, M14, M15, M16, M17, M19, M22, M23, M26, M27)
11 0131L00004	BELT DRIVE MOTOR 1.5 HP 575V (M16, M17, M23)	NS 0259L00178	HARNESS, ECONOMIZER
21 0121L00297	BLOWER SIDE ANGLE (QTY 3)	NS 0259L00092	HARNESS-SMOKE DETECTOR SENSOR (M2, M3, M5, M6, M21, M22)
31 0121L01619	MOTOR BASE	NS 0259L00122	WIRE HARNESS, CONTROL
41 0121L00281	BLOWER MOUNTING ANGLE	NS 0259L00090	WIRE HARNESS-SMOKE DETECTOR (M1, M2, M3, M5, M6, M7, M21, M22)
51 0163L00005	BELT DRIVE BLOWER SHAFT		
61 2539302F	BLOWER HOUSING 11 X 10	NS 0259L00070	WIRING HARNESS (M1, M2, M3, M4, M5, M6, M7, M8, M9, M10, M11, M13, M14, M15, M16, M17, M18, M19, M20, M21, M22, M23, M24, M25, M26, M27)
71 B3201300	MOUNTING BRACKET BEARING (QTY 2)	NS 0259L00071	WIRING HARNESS (M12)
81 B1368056	BELT DRIVE BLOWER WHEEL	NS 0259L00094	WIRING HARNESS
91 0163L00136	SHEAVE, FIXED AK59H		
101 B1398604	STEEL KEY (000158812) 2.0"		
111 B1399500	BALL BEARING 1.00" (QTY 2)		
121 0164L00010	FAN BELT, NOTCHED		
131 B2120001	VARIABLE PITCH SHEAVE 1VL44 X 3/8" (M16, M17, M23)		
131 B2120014	VARIABLE PITCH SHEAVE 1VL44 X 7/8" (M1, M2, M3, M4, M5, M6, M7, M8, M9, M10, M11, M12, M13, M14, M15, M18, M19, M20, M21, M22, M24, M25, M26, M27)		
141 0121L01203	BLOWER PLATE SUPPORT (M3, M4, M6, M7, M8, M12, M13, M16, M21, M25, M26, M27)		
151 B1393726	ELECT. CONNECTING BUSHING		
161 B1393738	BOLT 1/4-20 X 3/4" (QTY 4)		
171 0163M00045	BOLT 1/4-20 X 4"		
181 3225000F	BELT TIGHTENER ANGLE		
191 B1393023	NUT / LOCK .25-20		
NS 1864703F	BLOWER CUT-OFF		
NS B1398603	STEEL KEY (000158812) 4.5"		
Image 2:		Expanded Model Nomenclature	
12 PCBDM133	DEFROST CONTROL BOARD	M1 - DCH072XXX3BAXHAB	
22 0130M00144	TRANSFORMER (M1, M2, M5, M9, M10, M18, M20, M24)	M2 - DCH072XXX3BAXZAB	
22 0130M00138	TRANSFORMER 208/230, 24V (M3, M4, M6, M7, M8, M21, M25)	M3 - DCH072XXX3BJXLAA	
22 0130M00145	TRANSFORMER 480V to 24V, 75VA (M11, M12, M13, M14, M15, M19, M22, M26, M27)	M4 - DCH072XXX3BXXBAA	
22 0130M00148	TRANSFORMER 575V to 24V, 75VA (M16, M17, M23)	M5 - DCH072XXX3BXXJAB	
32 0130M00025	24V RELAY (M11, M12, M13, M14, M15, M16, M17, M19, M22, M23, M26, M27)	M6 - DCH072XXX3BXXOAA	
42 CONT3P025024V	CONTACTOR 25 AMP, 3P, 24V (M11, M12, M13, M14, M15, M16, M17, M19, M22, M23, M26, M27)	M7 - DCH072XXX3BXXWAA	
42 CONT3P030024V	CONTACTOR 30 AMP, 3P, 24V (M1, M2, M3, M4, M5, M6, M7, M8, M9, M10, M18, M20, M21, M24, M25)	M8 - DCH072XXX3BXXXAA	
52 CAP100000440LA	CAP 10 MFD/440V/OVAL (M1, M2, M5, M9, M10, M11, M14, M15, M18, M19, M20, M22, M24)	M9 - DCH072XXX3BXXXAB	
52 CAP100000370LA	CAPACITOR 10/370V (M3, M4, M6, M7, M8, M13, M21, M25, M26, M27)	M10 - DCH072XXX3BXXXAC	
52 CAP050000370LA	CAPACITOR 5/370V (M12, M16)	M11 - DCH072XXX4BXXBAC	
52 CAP050000440LA	CAPACITOR 5/440V (M17, M23)	M12 - DCH072XXX4BXXXAA	
62 0130M00038	TERMINAL BOARD	M13 - DCH072XXX4BXXXAB	
72 PCBFM103	ELECTRONIC BLOWER TIME DELAY	M14 - DCH072XXX4BXXXAC	
NS 20520901	CAPACITOR STRAP (QTY 4)	M15 - DCH072XXX4BXXXAD	
NS 0259L00077	DEFROST HARNESS (M1, M2, M3, M4, M5, M6, M7, M8, M9, M10, M18, M20, M21, M24, M25)	M16 - DCH072XXX7BXXXAA	
		M17 - DCH072XXX7BXXXAB	
		M18 - DCH0720103BHXMA B	
		M19 - DCH0720104BJXFAC	
		M20 - DCH0720153BXXCAB	
		M21 - DCH0720153BXXLAA	
		M22 - DCH0720154BHXOAC	
		M23 - DCH0720157BJXXAB	
		M24 - DCH0720203BAXNAB	
		M25 - DCH0720203BHXXAA	
		M26 - DCH0720204BAXBAB	
		M27 - DCH0720204BXXAAB	

Accessory Parts

ACCESSORY PARTS LIST

NOTE: NOT ALL OPTIONS AVAILABLE FOR ALL PRODUCTS

1 LOW AMBIENT KITS

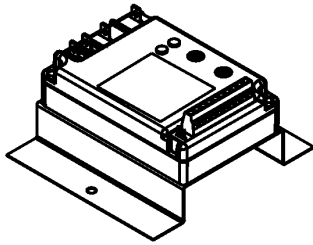

2 GFCI CONVENIENCE OUTLET

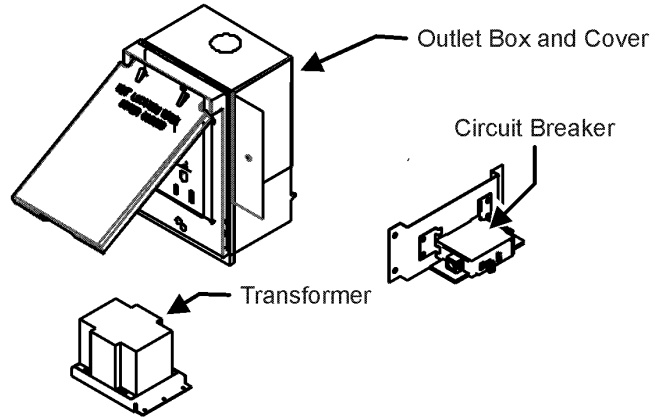

3 DISCONNECT MODULE (NON-FUSED)

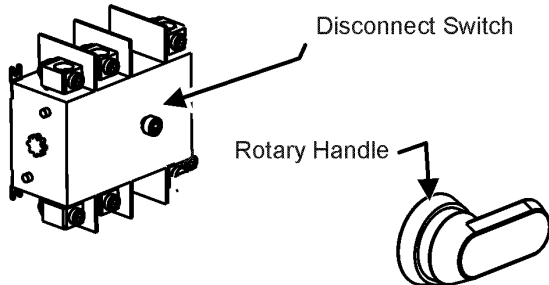

4 SMOKE DETECTORS

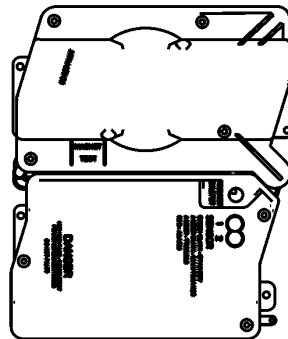

5 DDC CONTROL

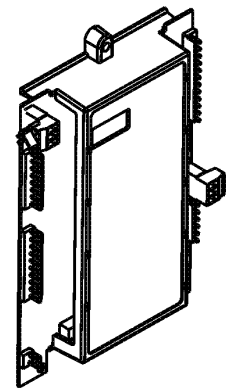

6 HINGED DOOR ASSEMBLIES

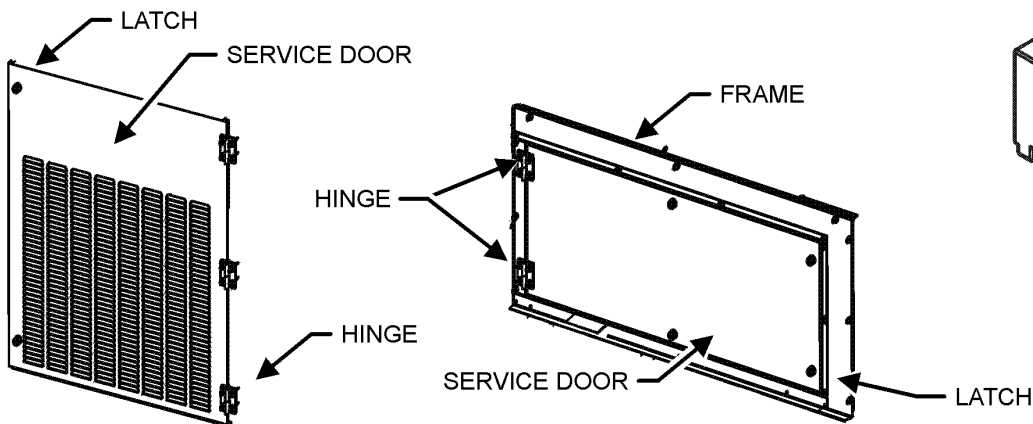

7 PHASE MONITOR

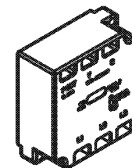

Accessory Parts

Ref. Part No: No:	Description:	Ref. Part No: No:	Description:
Image 1:		Expanded Model Nomenclature	
NS EHK3-10	10 KW 203-230/3 ELECTRIC EHAT (M18)	M1 - DCH072XXX3BAXHAB	
NS EHK4-10	10 KW 460/3 ELECTRIC HEAT (M19)	M2 - DCH072XXX3BAXZAB	
NS EHK3-15	15 KW 208-230/3 ELECTRIC HEAT (M20, M21)	M3 - DCH072XXX3BJXLAA	
NS EHK4-15	15 KW 460/3 (M22)	M4 - DCH072XXX3BXXBAA	
NS EHK7-15	15 KW 575/3 ELECTRIC HEAT (M23)	M5 - DCH072XXX3BXXJAB	
NS EHK3-20	20 KW 208-230/3 ELECTRIC HEAT (M24, M25)	M6 - DCH072XXX3BXXOAA	
NS EHK4-20	20 KW 460/3 ELECTRIC HEAT (M26, M27)	M7 - DCH072XXX3BXXWAA	
NS 1036609C	3-6 TON DFLOW ECONOMIZER (M1, M2, M3, M19, M23, M24, M26)	M8 - DCH072XXX3BXXXAA	
NS 0121L00316	BRACKET-CONV OUTLET MOUNT (M1, M3, M4, M5, M6, M11, M18, M19, M21, M22, M24, M26, M27)	M9 - DCH072XXX3BXXXAB	
NS 0121L00835	BRACKET-DISCONNECT SWITCH (M3, M18, M19, M22, M23, M25)	M10 - DCH072XXX3BXXXAC	
NS 0121L01934	BRACKET-SMOKE DETECTOR (M2, M3, M5, M6, M21, M22)	M11 - DCH072XXX4BXXBAC	
NS 0130M00065	CIRCUIT BREAKER, CONVENIENCE OUTLET (M4, M6, M11, M18, M22, M24, M26, M27)	M12 - DCH072XXX4BXXXAA	
NS 0121L00837NG	DISCONNECT COVER (M3, M18, M19, M22, M23, M25)	M13 - DCH072XXX4BXXXAB	
NS 0130L00012	GANG BOX-GFCI OUTLET (M1, M3, M4, M5, M6, M11, M18, M19, M21, M22, M24, M26, M27)	M14 - DCH072XXX4BXXXAC	
NS 0130L00039	HANDLE, ROTARY (M3, M18, M19, M22, M23, M25)	M15 - DCH072XXX4BXXXAD	
NS LAKT03	LOW AMBIENT KIT (M3, M7, M18, M19, M20, M21)	M16 - DCH072XXX7BXXXAA	
NS 0161G00012	POWER OUTLET BOX (M1, M3, M4, M5, M6, M11, M18, M19, M21, M22, M24, M26, M27)	M17 - DCH072XXX7BXXXAB	
NS 0130L00103	RECEPTACLE-GFCI OUTLET (M1, M3, M4, M5, M6, M11, M18, M19, M21, M22, M24, M26, M27)	M18 - DCH0720103BHXMAAB	
NS 0130L00040	SHAFT, CUT (M3)	M19 - DCH0720104BJXFAC	
NS 0130L00042	SHAFT, CUT (M19, M22, M23)	M20 - DCH0720153BXXCAB	
NS 0130L00049	SHAFT, DISCONNECT (M3, M18, M19, M22, M23, M25)	M21 - DCH0720153BXXLAA	
NS D4120	SMOKE DETECTOR, PHOTO 4WIRE (M2, M3, M5, M6, M21, M22)	M22 - DCH0720154BHXXOAC	
NS D4S	SMOKE DETECTOR, SENSOR ONLY (M2, M3, M5, M6, M21, M22)	M23 - DCH0720157BJXXAB	
NS 0130L00027	SWITCH-DISCONNECT 100A (M18, M25)	M24 - DCH0720203BAXNAB	
NS 0130L00028	SWITCH-DISCONNECT 150A (M3)	M25 - DCH0720203BHXXAA	
NS 0130L00046	SWITCH-DISCONNECT 60A (M19, M22, M23)	M26 - DCH0720204BAXBAB	
NS 0130M00061	TRANSFORMER, CONVENIENCE OUTLET (M4, M6, M11, M18, M22, M24, M26, M27)	M27 - DCH0720204BXXAAB	