

Commercial 3 Ton Package Heat Pump Units

DCH0360103BAXFAA
DCH0360103BAXXAB
DCH0360104BHXFAC
DCH0360104BJXQAB
DCH0360153BHXFAB
DCH036XXX3BJXLAA
DCH036XXX3BXXCAA
DCH036XXX3BXXJAB
DCH036XXX3BXXXAA
DCH036XXX3BXXXAB
DCH036XXX4BXXXAA
DCH036XXX4BXXXAB
DCH036XXX4BXXXAC
DCH036XXX7BXXXAA
DCH036XXX7BXXXAB

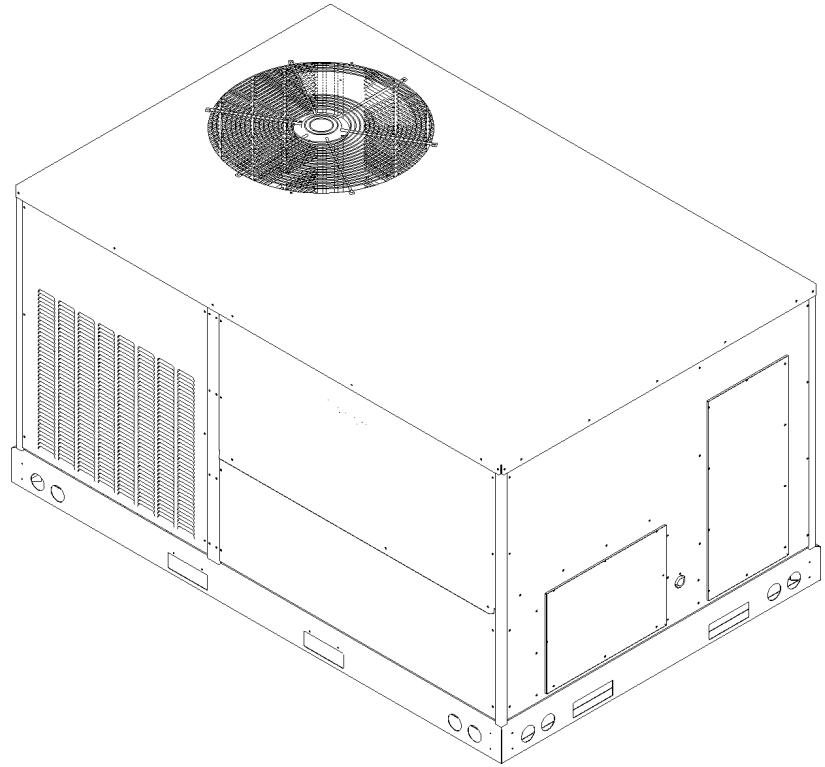

This manual is to be used by qualified technicians only.

This manual replaces RP-D1029F.

© 2013 - 2016 **DAIKIN COMPANY, L.P.** ♦ 5151 San Felipe St., Suite 500 ♦ Houston, TX 77056

Important Information

Index

Functional Parts List	3
Illustration and Parts	4 - 13

Views shown are for parts illustrations only, not servicing procedures

Text Codes:

AR - As Required

NA - Not Available

NS - Not Shown

00000000 - See Note

QTY - Quantity Example (QTY 3) (If Quantity not shown, Quantity = 1)

M - Model Example (M1) (If M Code not shown, then part is used on all Models)

Expanded Model Nomenclature:

Example M1 - Model#1 M2 - Model#2 M3 - Model#3

Daikin Company, L.P. is not responsible for personal injury or property damage resulting from improper service. Review all service information before beginning repairs.

Warranty service must be performed by an authorized technician, using authorized factory parts. If service is required after the warranty expires, Daikin Company, L.P. also recommends contacting an authorized technician and using authorized factory parts.

Daikin Company, L.P. reserves the right to discontinue, or change at any time, specifications or designs without notice or without incurring obligations.

For assistance within the U.S.A. contact:

Homeowner Support
Daikin North America, LLC
19001 Kermier Road
Waller, Texas 77484
855-770-5678-Telephone
713-863-2382-Facsimile

For assistance outside the U.S.A. contact:

International Division
Daikin North America, LLC
19001 Kermier Road
Waller, Texas 77484
713-861-2500-Telephone
713-863-2382-Facsimile

Functional Parts

Part

No: Description:

0130M00025	24V RELAY
B1368056	BELT DRIVE BLOWER WHEEL
0131L00003	BELT DRIVE MOTOR 1 HP (M1, M2, M3, M4, M5, M6, M7, M8, M11, M12, M13, M14, M15)
0131L00004	BELT DRIVE MOTOR 1.5 HP 575V (M9, M10)
CAP030000440LA	CAPACITOR 3/440V
CAP050000370LA	CAPACITOR 5/370V
CAP075000370LA	CAPACITOR 7.5/370V
ZP31K5ETFE130	COMPRESSOR 31100, 575/60/3 (M9, M10)
ZP31K5ETF5130	COMPRESSOR 31200, 200/230/60/3 (M1, M2, M3, M4, M5, M11, M12, M15)
ZP31K5ETFD130	COMPRESSOR 31200, 460/60/3 (M6, M7, M8, M13, M14)
0131M00429	COND MOTOR 1/4 HP, 1 SP,6 PL (M1, M2, M3, M4, M5, M11, M12, M15)
B13400269	COND MOTOR 380/460 50/60 CYCLE (M6)
0131M00432	COND MOTOR 380/460/50/60 CYCLE (M7, M8, M13, M14)
0131M00098	COND MOTOR 575V (M9)
0131M00431	COND MOTOR 575V (M10)
CONT3P025024V	CONTACTOR 25 AMP, 3P, 24V
CONT3P030024V	CONTACTOR 30 AMP, 3P, 24V
0130M00074	CUT-OUT SWITCH, HIGH PRESSURE
0130M00075	CUT-OUT SWITCH, LOW PRESSURE
0130M00100	DEFROST CONTROL (M1, M2, M3, M4, M5, M6, M7, M8, M11, M12, M13, M14, M15)
PCBDM133	DEFROST CONTROL BOARD
0130M00048	DEFROST THERMOSTAT (34°/60°) (M9, M10)
PCBFM103	ELECTRONIC BLOWER TIME DELAY
0164L00010	FAN BELT, NOTCHED
0151R00069	REVERSING VALVE
0130M00038	TERMINAL BOARD
0130M00144	TRANSFORMER
0130M00138	TRANSFORMER 208/230, 24V
0130M00145	TRANSFORMER 480V to 24V, 75VA
0130M00148	TRANSFORMER 575V to 24V, 75VA

Expanded Model Nomenclature

M1 - DCH036XXX3BJXLAA
M2 - DCH036XXX3BXXCAA
M3 - DCH036XXX3BXXJAB
M4 - DCH036XXX3BXXXAA
M5 - DCH036XXX3BXXXAB
M6 - DCH036XXX4BXXXAA
M7 - DCH036XXX4BXXXAB
M8 - DCH036XXX4BXXXAC
M9 - DCH036XXX7BXXXAA
M10 - DCH036XXX7BXXXAB
M11 - DCH0360103BAXFAA
M12 - DCH0360103BAXXAB
M13 - DCH0360104BHXFAC
M14 - DCH0360104BJXQAB
M15 - DCH0360153BHXFAB

Top Panel and Tubing Assembly

IMAGE 1

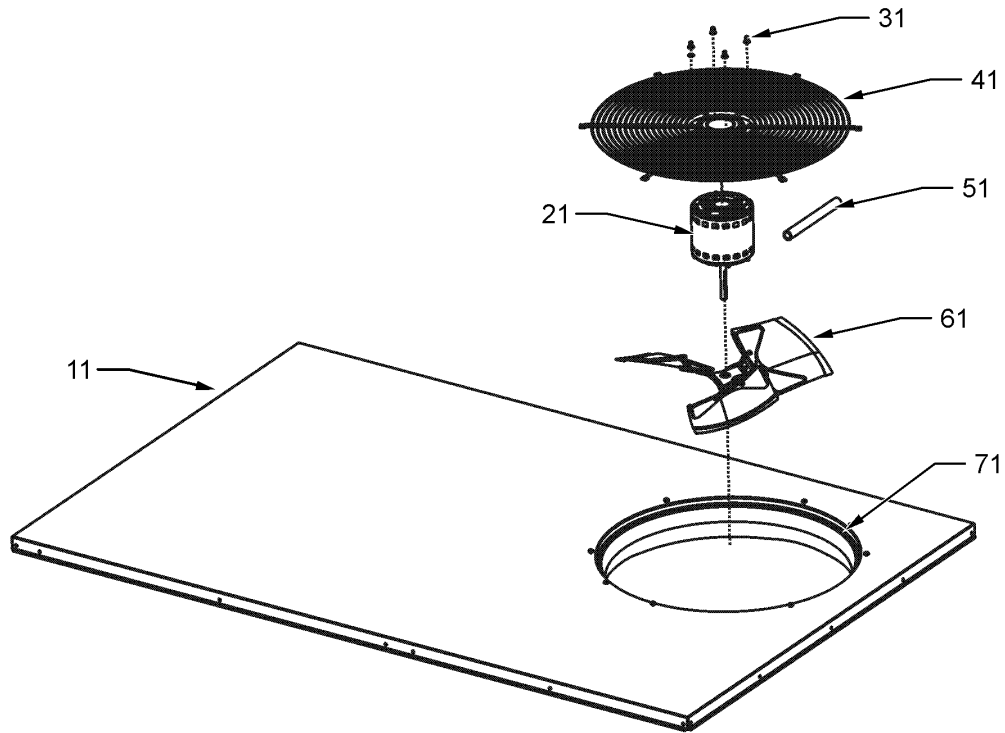
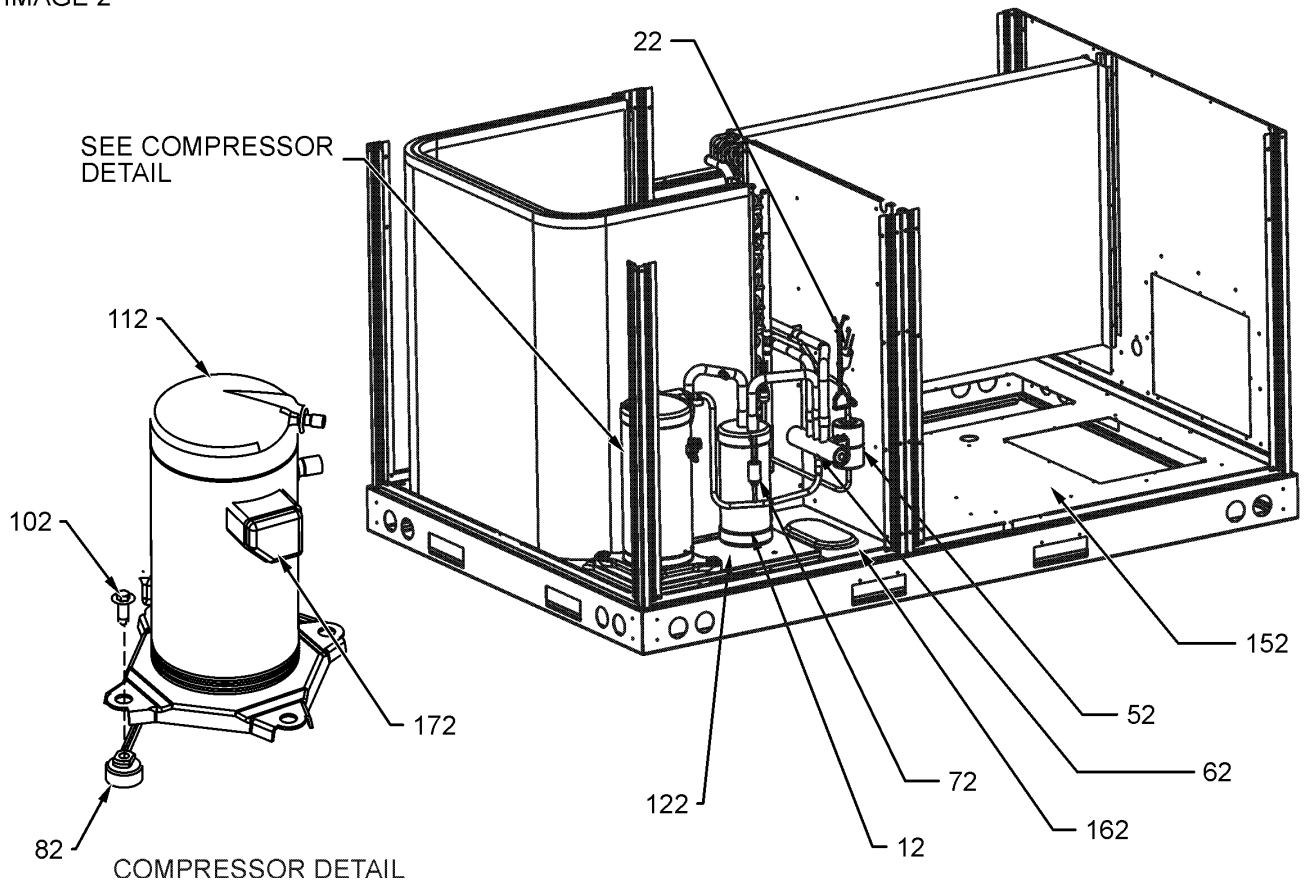

IMAGE 2



Top Panel and Tubing Assembly

Ref. Part No: No:	Description:	Ref. Part No: No:	Description:
-------------------	--------------	-------------------	--------------

Image 1:

11	0121L00235NG	TOP PANEL
21	0131M00429	COND MOTOR 1/4 HP, 1 SP,6 PL (M1, M2, M3, M4, M5, M11, M12, M15)
21	B13400269	COND MOTOR 380/460 50/60 CYCLE (M6)
21	0131M00432	COND MOTOR 380/460/50/60 CYCLE (M7, M8, M13, M14)
21	0131M00098	COND MOTOR 575V (M9)
21	0131M00431	COND MOTOR 575V (M10)
31	0163M00006P	ACORN NUT 5/16 HEX BLACK (QTY 4)
41	0152G00003	FAN GRILLE
51	17788000083F	PVC CONDUIT 8.25"
61	0150G00004	FAN BLADE
71	0161L00000	VENTURI RING 22"
NS	0163M00004	SCREW #10X3/4", BLACK (QTY 8)
NS	0163M00005P	WASHER, BLACK (.50 OD .218ID) (QTY 4)

Image 2:

12	B1226206	ACCUMULATOR
22	0130M00075	CUT-OUT SWITCH, LOW PRESSURE
52	B1219204	BI-FLOW FILTER DRIER
62	0151R00069	REVERSING VALVE
72	0130M00074	CUT-OUT SWITCH, HIGH PRESSURE
82	B1339533	COMPRESSOR GROMMET (QTY 4)
102	M0221641	TF SHOULDER SCREW (QTY 4)
112	ZP31K5ETFE130	COMPRESSOR 31100, 575/60/3 (M9, M10)
112	ZP31K5ETF5130	COMPRESSOR 31200, 200/230/60/3 (M1, M2, M3, M4, M5, M11, M12, M15)
112	ZP31K5ETFD130	COMPRESSOR 31200, 460/60/3 (M6, M7, M8, M13, M14)
122	0121L01308	MOUNTING PLATE-COMPRESSOR
152	0121L00943	BASE PAN-INDOOR
162	0121L01307	BASE PAN-OUTDOOR
172	0159L00028	COMPRESSOR SCROLL HARNESS
NS	B1373315	ACCESS FITTING (QTY 2)
NS	0163M00175	CAP WITH O-RING (QTY 2)

Expanded Model Nomenclature

M1 - DCH036XXX3BJXLAA
M2 - DCH036XXX3BXXCAA
M3 - DCH036XXX3BXXJAB
M4 - DCH036XXX3BXXXAA
M5 - DCH036XXX3BXXXAB
M6 - DCH036XXX4BXXXAA
M7 - DCH036XXX4BXXXAB
M8 - DCH036XXX4BXXXAC
M9 - DCH036XXX7BXXXAA
M10 - DCH036XXX7BXXXAB
M11 - DCH0360103BAXFAA
M12 - DCH0360103BAXXAB
M13 - DCH0360104BHXFAC
M14 - DCH0360104BJXQAB
M15 - DCH0360153BHXFAB

Cabinet Assembly

IMAGE 1

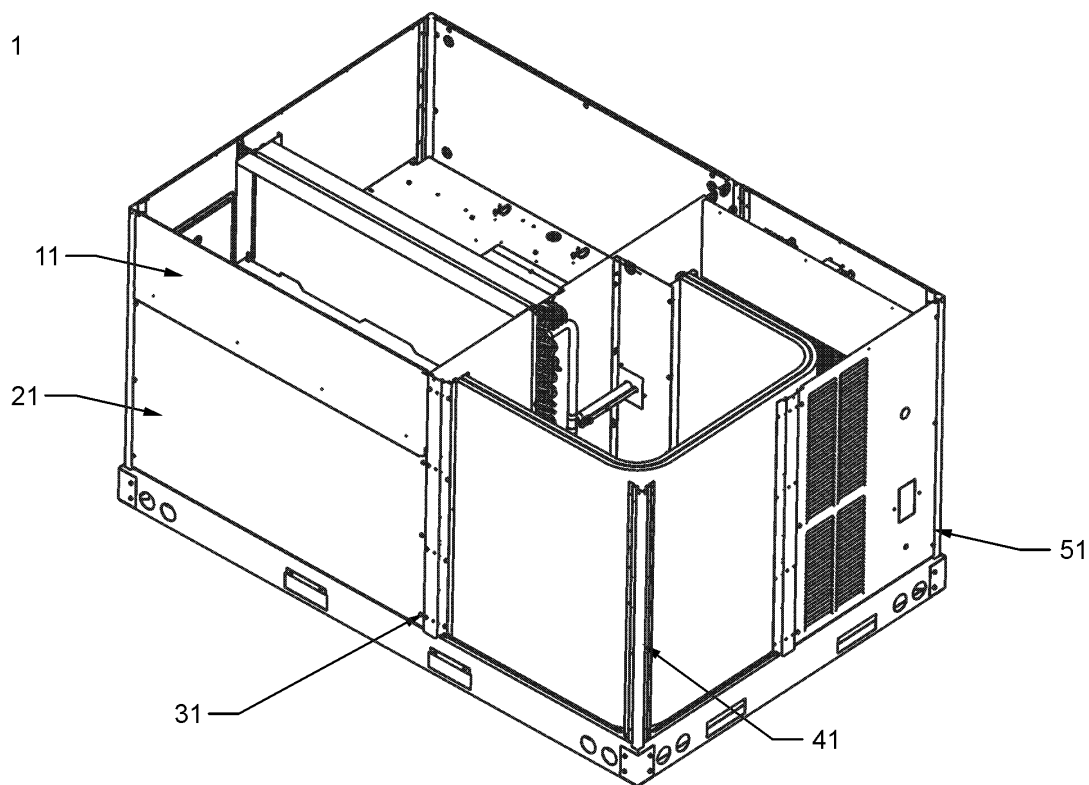
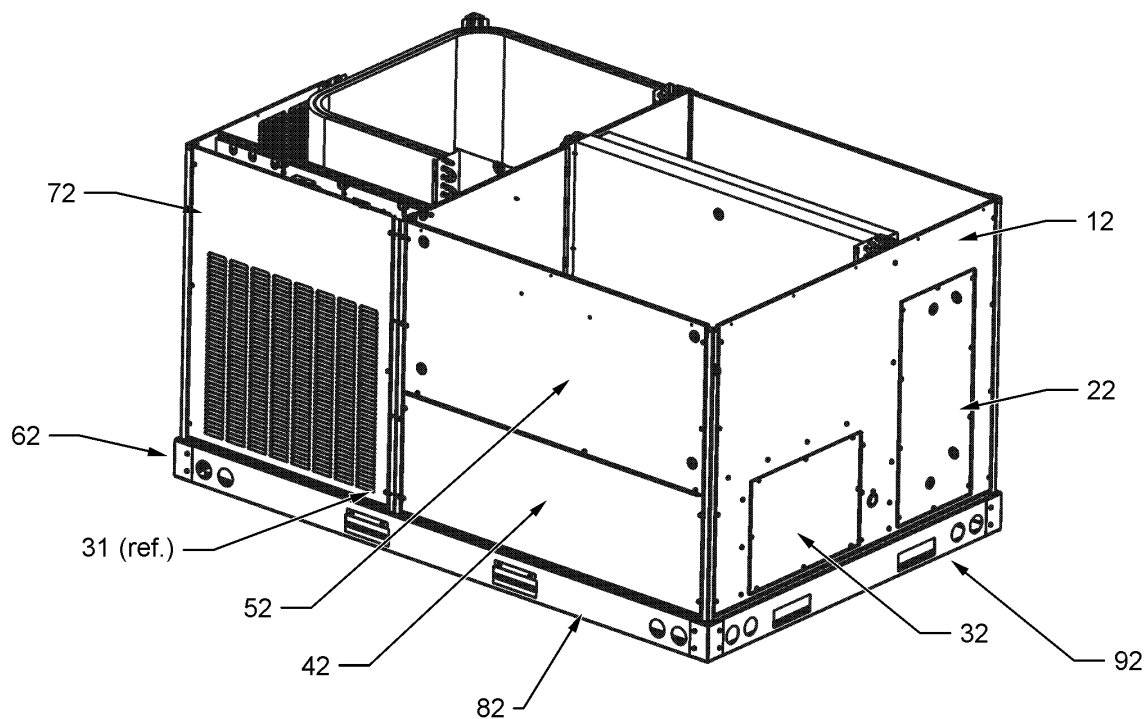

IMAGE 2



Cabinet Assembly

Ref. Part No: No:	Description:	Ref. Part No: No:	Description:
-------------------	--------------	-------------------	--------------

Image 1:

11	0270L00362NG	FILTER DOOR
21	0121L00976NG	ECONOMIZER DOOR (M2, M3, M4, M5, M6, M7, M8, M9, M12, M14, M15)
31	0121L00233RFNG	POST-SIDE SUPPORT (QTY 3)
31	0121L01159RFNG	RF, Post-Side, Painted 3-5Ton (M3, M5, M8, M10, M12, M13, M15)
41	0121L01198RFNG	CORNER POST (QTY 4)
51	0121L00263NG	LOUVERED COMPRESSOR PANEL (M2, M3, M4, M5, M6, M7, M8, M9, M10, M11, M12)
51	0121L00836NG	LOUVERED COMPRESSOR PANEL (M1, M13, M14, M15)
NS	0121L01309	ECONOMIZER COVER (M1, M11, M12, M14)
NS	0164L00009	GASKET-RUBBER, CPOST (QTY 3)
NS	0164L00011	GASKET-RUBBER, SIDE POST (QTY 2)

Image 2:

12	0121L00236NG	DUCT PANEL
22	0121L00023NG	RETURN DUCT COVER
32	0121L00024NG	SUPPLY DUCT COVER
42	0121L00279NG	ELECTRIC HEAT DOOR (M1, M2, M4, M6, M7, M9, M11, M14)
42	0121L01176NG	ELECTRIC HEAT DOOR (M3, M5, M8, M10, M12, M13, M15)
52	0121L00259NG	BLOWER DOOR (M1, M2, M4, M6, M7, M9, M11, M14)
52	0121L01157NG	BLOWER DOOR (M3, M5, M8, M10, M12, M13, M15)
62	0121G00301	RAIL CORNER BRACKET (QTY 4)
72	0121L00262NG	LOUVERED CONTROL PANEL (M1, M2, M4, M6, M7, M9, M11, M14)
72	0121L01121NG	LOUVERED CONTROL PANEL (M3, M5, M8, M10, M12, M13, M15)
82	0121L00244RF	SIDE RAIL (QTY 2)
92	0121L00245	END RAIL (QTY 2)

Expanded Model Nomenclature

M1 - DCH036XXX3BJXLAA
M2 - DCH036XXX3BXXCAA
M3 - DCH036XXX3BXXJAB
M4 - DCH036XXX3BXXXAA
M5 - DCH036XXX3BXXXAB
M6 - DCH036XXX4BXXXAA
M7 - DCH036XXX4BXXXAB
M8 - DCH036XXX4BXXXAC
M9 - DCH036XXX7BXXXAA
M10 - DCH036XXX7BXXXAB
M11 - DCH0360103BAXFAA
M12 - DCH0360103BAXXAB
M13 - DCH0360104BHXFAC
M14 - DCH0360104BJXQAB
M15 - DCH0360153BHXFAB

Evaporator, Condenser and Partiton Assy

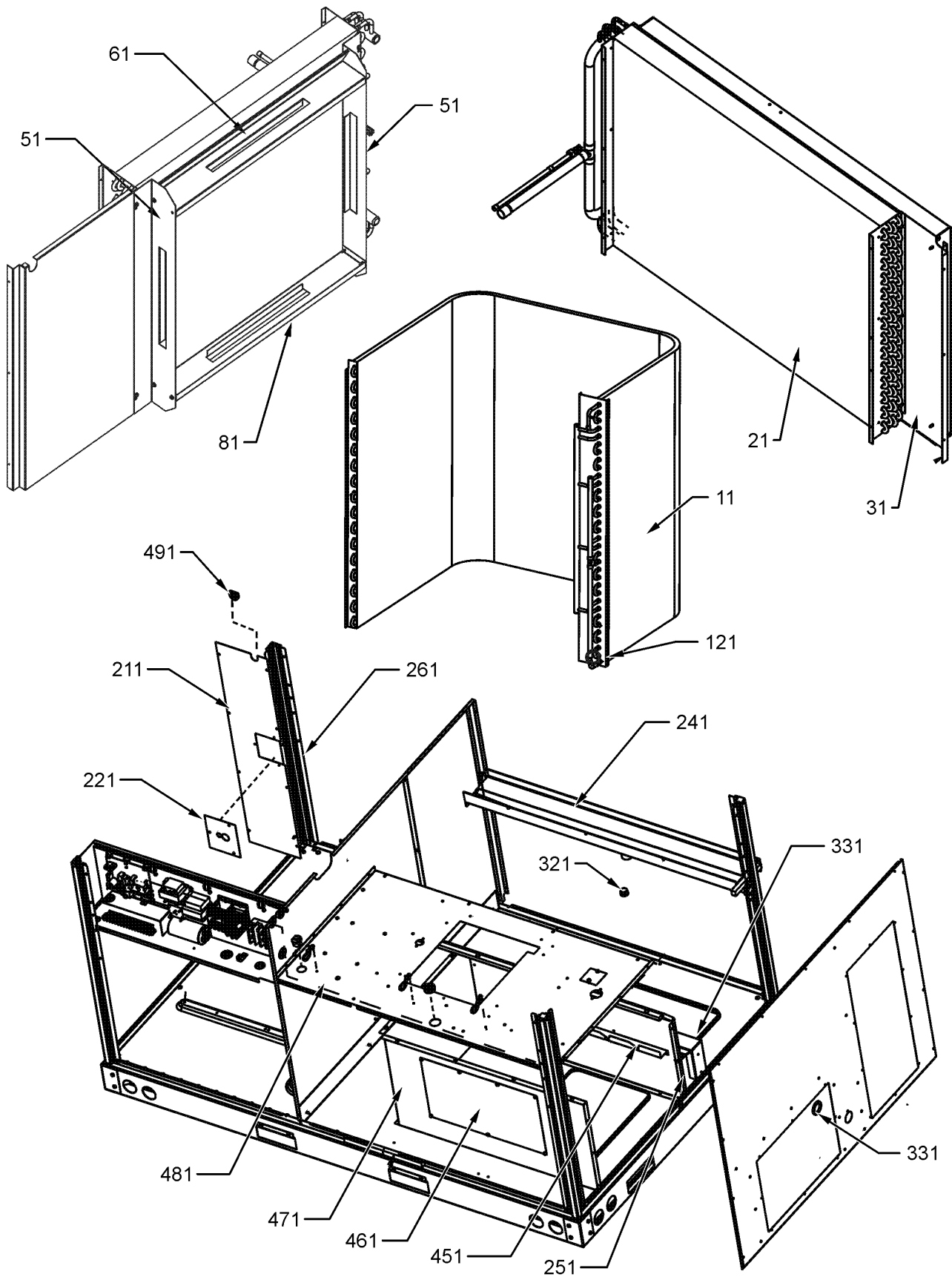

Evaporator, Condenser and Partiton Assy

Ref. Part No: No:	Description:	Ref. Part No: No:	Description:
Image 1:			
11 0201L00038	TUBING ASSY, COND COIL (M1, M2, M3, M4, M5, M6, M7, M8, M11, M12, M13, M14, M15)		
11 0201L00048	TUBING ASSY, COND COIL 575V (M9, M10)		
21 0202L00026	TUBING ASSY, EVAP COIL		
31 0121L00289	EVAP BLOCK-OFF		
51 0121L00292	FILTER ANGLE-VERTICAL (QTY 2)		
61 0121L00290	FILTER ANGLE-TOP		
81 0121L00291	FILTER ANGLE-BOTTOM		
121 0130M00100	DEFROST CONTROL (M1, M2, M3, M4, M5, M6, M7, M8, M11, M12, M13, M14, M15)		
121 0130M00048	DEFROST THERMOSTAT (34°/60°) (M9, M10)		
211 0121L00311	COND BLOCK-OFF (M1, M2, M3, M4, M5, M6, M7, M8, M11, M12, M13, M14, M15)		
211 0121L00319	COND BLOCK-OFF (M9, M10)		
221 0121L00939	CONDENSER BLOCKOFF PLATE		
231 0121L00238	DRAIN PAN SUPPORT		
241 0161L00005	DRAIN PAN		
251 0121L00243	DECK SIDE CHANNEL		
261 0121L00254	COND MOUNTING ANGLE		
321 0163L00071	DRAIN PLUG		
331 0154L00009	DRAIN PAN GASKET		
451 0121L00288	ELECTRIC HEAT RETAINER		
461 0121L00144	ELECTRIC HEAT COVER		
471 0121L00256	ELECTRIC HEAT PANEL		
481 0121L00242	BLOWER DECK (M9)		
481 0121L01205	BLOWER DECK (M1, M2, M4, M6, M7, M11, M14)		
481 0121L01442	BLOWER DECK (M3, M5, M8, M10, M12, M13, M15)		
491 A4568804	GROMMET-D (QTY 4)		
NS 0160L00138	Air Filter 24x24x2		
NS 0121L00321	SMOKE DETECTOR COVER		

Expanded Model Nomenclature

M1 - DCH036XXX3BJXLAA
M2 - DCH036XXX3BXXCAA
M3 - DCH036XXX3BXXJAB
M4 - DCH036XXX3BXXXAA
M5 - DCH036XXX3BXXXAB
M6 - DCH036XXX4BXXXAA
M7 - DCH036XXX4BXXXAB
M8 - DCH036XXX4BXXXAC
M9 - DCH036XXX7BXXXAA
M10 - DCH036XXX7BXXXAB
M11 - DCH0360103BAXFAA
M12 - DCH0360103BAXXAB
M13 - DCH0360104BHXFAC
M14 - DCH0360104BJXQAB
M15 - DCH0360153BHXFAB

Belt Drive Blower and Control Box Assy

IMAGE 1

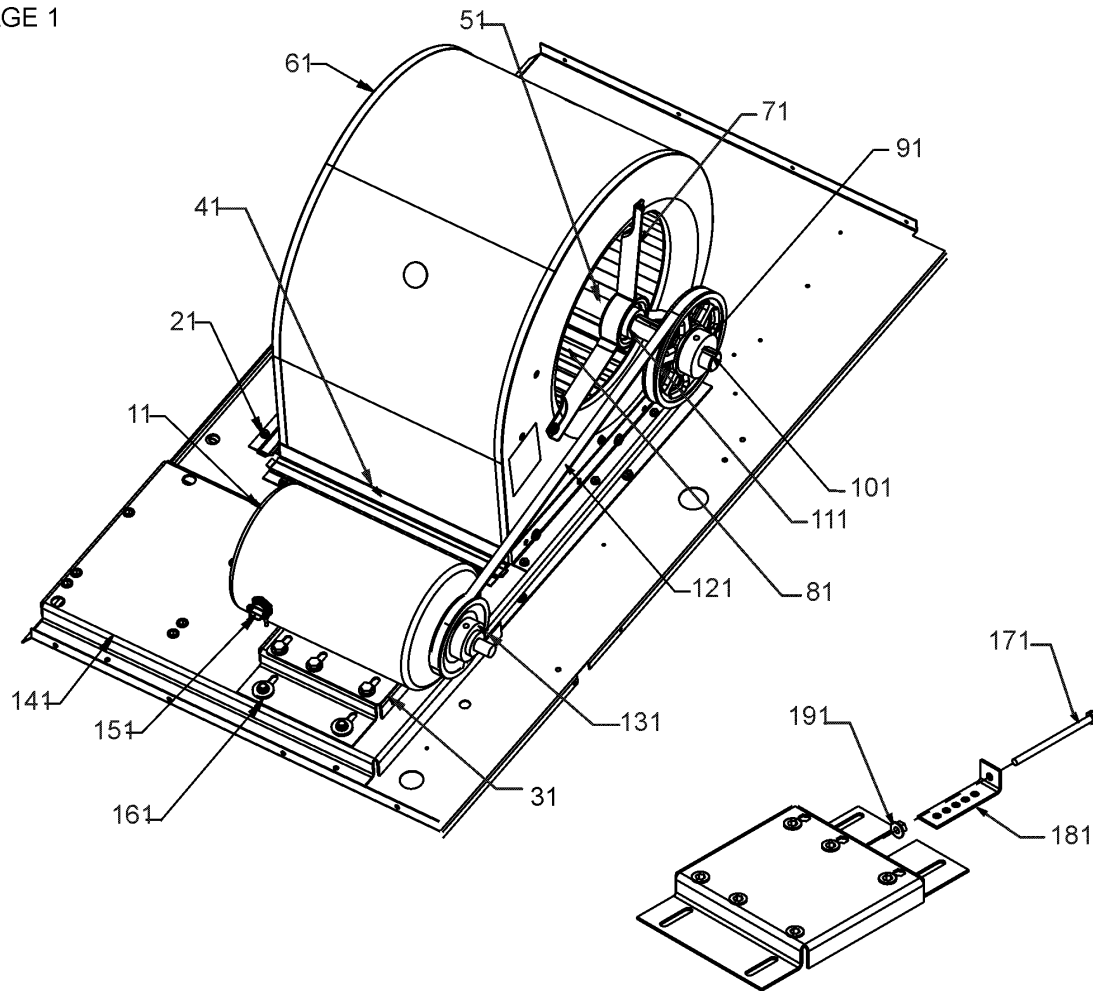
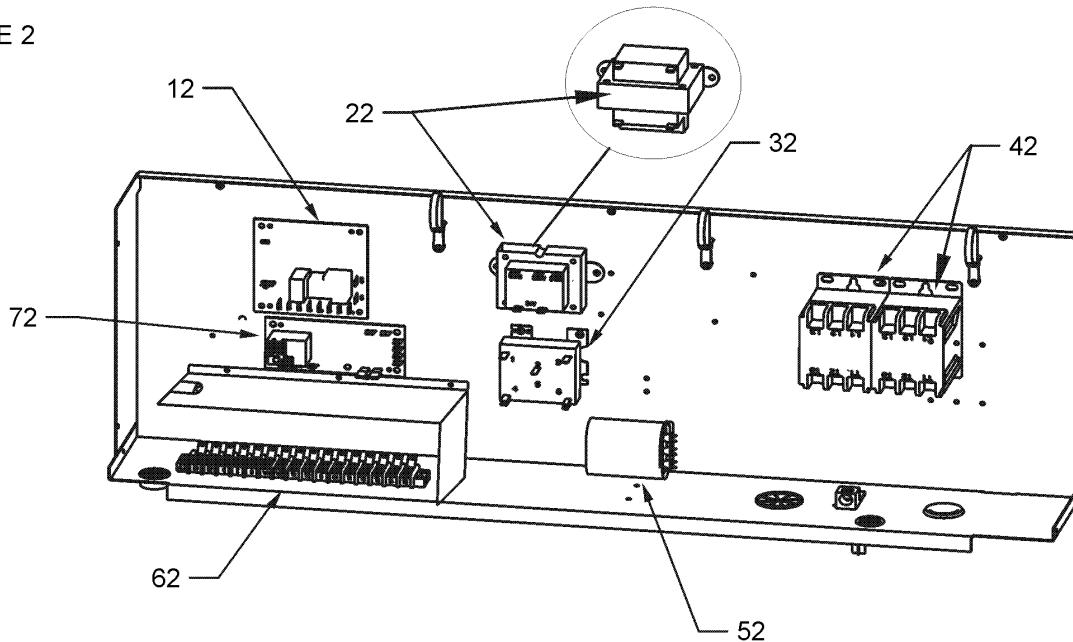

IMAGE 2



Belt Drive Blower and Control Box Assy

Ref. Part No: No:	Description:	Ref. Part No: No:	Description:
Image 1:		Expanded Model Nomenclature	
11	0131L00003	BELT DRIVE MOTOR 1 HP (M1, M2, M3, M4, M5, M6, M7, M8, M11, M12, M13, M14, M15)	M1 - DCH036XXX3BJXLAA
11	0131L00004	BELT DRIVE MOTOR 1.5 HP 575V (M9, M10)	M2 - DCH036XXX3BXXCAA
21	0121L00297	BLOWER SIDE ANGLE	M3 - DCH036XXX3BXXJAB
31	0121L00899	MOTOR BASE	M4 - DCH036XXX3BXXXAA
41	0121L00281	BLOWER MOUNTING ANGLE	M5 - DCH036XXX3BXXXAB
51	0163L00005	BELT DRIVE BLOWER SHAFT	M6 - DCH036XXX4BXXXAA
61	2539302F	BLOWER HOUSING 11 X 10	M7 - DCH036XXX4BXXXAB
71	B3201300	MOUNTING BRACKET BEARING (QTY 2)	M8 - DCH036XXX4BXXXAC
81	B1368056	BELT DRIVE BLOWER WHEEL	M9 - DCH036XXX7BXXXAA
91	B2120011	FIXED SHEAVE	M10 - DCH036XXX7BXXXAB
101	B1398604	STEEL KEY (000158812) 2.0"	M11 - DCH0360103BAXFAA
111	B1399500	BALL BEARING 1.00" (QTY 2)	M12 - DCH0360103BAXXAB
121	0164L00010	FAN BELT, NOTCHED	M13 - DCH0360104BHXFAC
131	0163L00024	VARIABLE PITCH SHEAVE 1VL40 X 5/8"	M14 - DCH0360104BJXQAB
141	0121L01203	BLOWER PLATE SUPPORT	M15 - DCH0360153BHXFAB
151	B1393726	ELECT. CONNECTING BUSHING	
161	B1393738	BOLT 1/4-20 X 3/4"	
171	0163M00045	BOLT 1/4-20 X 4"	
181	3225000F	BELT TIGHTENER ANGLE	
191	B1393023	NUT / LOCK .25-20	
NS	1864703F	BLOWER CUT-OFF	
NS	B1398603	STEEL KEY (000158812) 4.5"	
Image 2:			
12	PCBDM133	DEFROST CONTROL BOARD	
22	0130M00144	TRANSFORMER	
22	0130M00138	TRANSFORMER 208/230, 24V	
22	0130M00145	TRANSFORMER 480V to 24V, 75VA	
22	0130M00148	TRANSFORMER 575V to 24V, 75VA	
32	0130M00025	24V RELAY	
42	CONT3P025024V	CONTACTOR 25 AMP, 3P, 24V	
42	CONT3P030024V	CONTACTOR 30 AMP, 3P, 24V	
52	CAP030000440LA	CAPACITOR 3/440V	
52	CAP050000370LA	CAPACITOR 5/370V	
52	CAP075000370LA	CAPACITOR 7.5/370V	
62	0130M00038	TERMINAL BOARD	
72	PCBFM103	ELECTRONIC BLOWER TIME DELAY	
NS	20520901	CAPACITOR STRAP (QTY 2)	
NS	0259L00077	DEFROST HARNESS	
NS	0259L00078	DEFROST HARNESS	
NS	0259L00178	HARNESS, ECONOMIZER	
NS	0259L00092	HARNESS-SMOKE DETECTOR SENSOR	
NS	0259L00122	WIRE HARNESS, CONTROL	
NS	0259L00090	WIRE HARNESS-SMOKE DETECTOR	
NS	0259L00061	WIRING HARNESS	
NS	0259L00065	WIRING HARNESS	
NS	0259L00070	WIRING HARNESS	
NS	0259L00071	WIRING HARNESS	

ACCESSORY PARTS LIST

NOTE: NOT ALL OPTIONS AVAILABLE FOR ALL PRODUCTS

1 LOW AMBIENT KITS

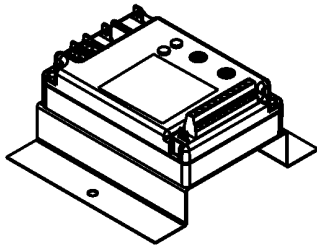

2 GFCI CONVENIENCE OUTLET

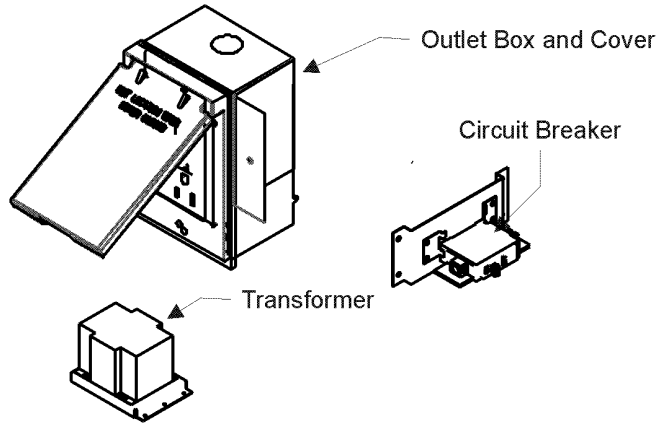

3 DISCONNECT MODULE (NON-FUSED)

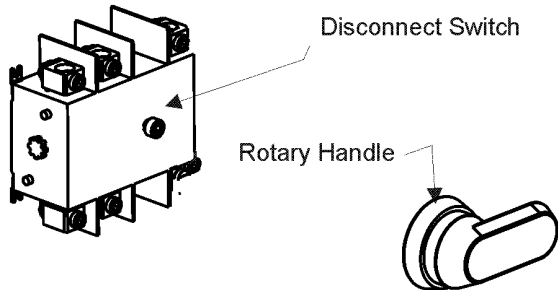

4 SMOKE DETECTORS

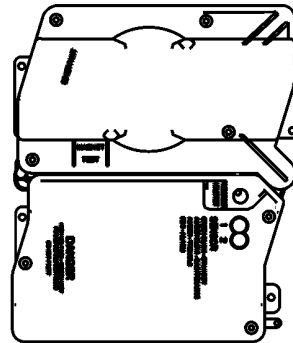

5 DDC CONTROL

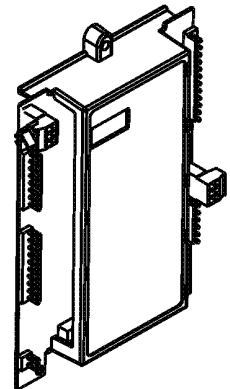

6 HINGED DOOR ASSEMBLIES

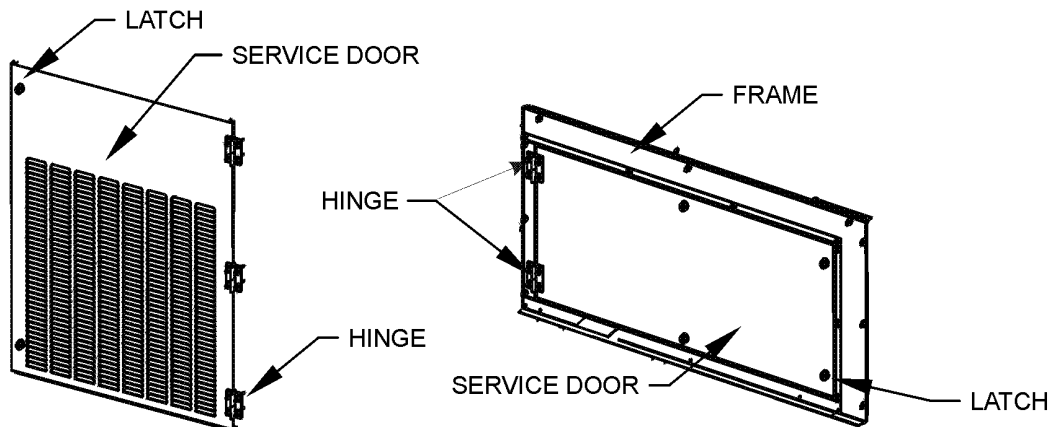

Accessory Parts List

Ref. Part No:	No:	Description:	Ref. Part No:	No:	Description:
Image 1:					
NS	0121L00316	BRACKET-CONV OUTLET MOUNT (M1, M3, M11, M13, M14, M15)			
NS	0121L00332	BRACKET-SMOKE DETECTOR (M1, M3)			
NS	0130M00065	CIRCUIT BREAKER, CONVENIENCE OUTLET (M14)			
NS	0121L00837NG	DISCONNECT COVER (M1, M13, M14, M15)			
NS	0130L00012	GANG BOX-GFCI OUTLET (M1, M3, M11, M13, M14, M15)			
NS	0130L00039	HANDLE, ROTARY (M1, M13, M14, M15)			
NS	LAKT03	LOW AMBIENT KIT (M1, M2, M11, M13, M14, M15)			
NS	0161G00012	POWER OUTLET BOX (M1, M3, M11, M13, M14, M15)			
NS	0130L00103	RECEPTACLE-GFCI OUTLET (M1, M3, M11, M13, M14, M15)			
NS	0130L00042	SHAFT, CUT (M13, M14)			
NS	0130L00049	SHAFT, DISCONNECT (M1, M13, M14, M15)			
NS	0121L00321	SMOKE DETECTOR COVER			
NS	D4120	SMOKE DETECTOR, PHOTO 4WIRE (M14)			
NS	D4S	SMOKE DETECTOR, SENSOR ONLY (M1, M3)			
NS	0130L00027	SWITCH-DISCONNECT 100A (M1, M15)			
NS	0130L00046	SWITCH-DISCONNECT 60A (M13, M14)			
NS	0130M00061	TRANSFORMER, CONVENIENCE OUTLET (M14)			

Expanded Model Nomenclature

M1 - DCH036XXX3BJXLAA
M2 - DCH036XXX3BXXCAA
M3 - DCH036XXX3BXXJAB
M4 - DCH036XXX3BXXXAA
M5 - DCH036XXX3BXXXAB
M6 - DCH036XXX4BXXXAA
M7 - DCH036XXX4BXXXAB
M8 - DCH036XXX4BXXXAC
M9 - DCH036XXX7BXXXAA
M10 - DCH036XXX7BXXXAB
M11 - DCH0360103BAXFAA
M12 - DCH0360103BAXXAB
M13 - DCH0360104BHXFAC
M14 - DCH0360104BJXQAB
M15 - DCH0360153BHXFAB