

Commercial 25 Ton Package Gas Units

DCG3004003BJXGAB
DCG3004003BXXXAA
DCG3004003BXXXAB
DCG3004004BBXXAB
DCG3004004BFXXAB
DCG3004004BHDXAB
DCG3004004BHXXAB
DCG3004004BJJXAB
DCG3004004BVDBAB
DCG3004004BVXXAB
DCG3004004BXXXAA
DCG3004004BXXXAB
DCG3004007BXSXAB
DCG3004007BXXXAA
DCG3004007BXXXAB

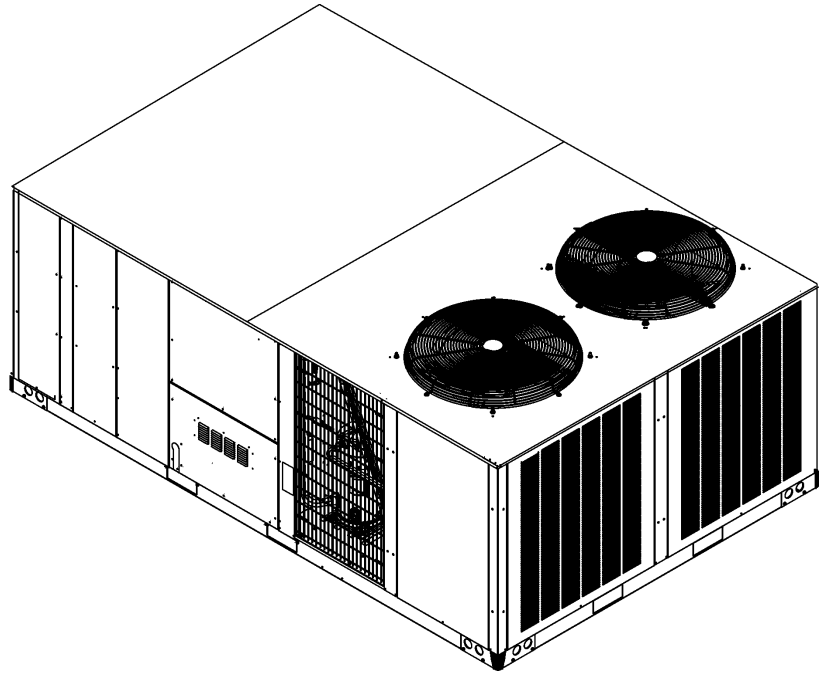

This manual is to be used by qualified technicians only.

This manual replaces RP-D1067E.

© 2015 - 2018 **DAIKIN COMPANY, L.P.** ♦ 5151 San Felipe St., Suite 500 ♦ Houston, TX 77056

Important Information

Index

Functional Parts List	3
Illustration and Parts	4 - 21

Views shown are for parts illustrations only, not servicing procedures

Text Codes:

AR - As Required

NA - Not Available

NS - Not Shown

00000000 - See Note

QTY - Quantity Example (QTY 3) (If Quantity not shown, Quantity = 1)

M - Model Example (M1) (If M Code not shown, then part is used on all Models)

Expanded Model Nomenclature:

Example M1 - Model#1 M2 - Model#2 M3 - Model#3

Daikin Company, L.P. is not responsible for personal injury or property damage resulting from improper service. Review all service information before beginning repairs.

Warranty service must be performed by an authorized technician, using authorized factory parts. If service is required after the warranty expires, Daikin Company, L.P. also recommends contacting an authorized technician and using authorized factory parts.

Daikin Company, L.P. reserves the right to discontinue, or change at any time, specifications or designs without notice or without incurring obligations.

For assistance within the U.S.A. contact:

Equipment Support
Daikin North America, LLC
19001 Kermier Road
Waller, Texas 77484
855-770-5678-Telephone
713-863-2382-Facsimile

For assistance outside the U.S.A. contact:

International Division
Daikin North America, LLC
19001 Kermier Road
Waller, Texas 77484
713-861-2500-Telephone
713-863-2382-Facsimile

Functional Parts

Part

No: Description:

Part No:	Description:	Expanded Model Nomenclature
0271L00027	150-15R BD 1.44 TWIN BLOWER	M1 - DCG3004003BJXGAB
0130M00242	24V RELAY (QTY 2)	M2 - DCG3004003BXXXAA
0130M00025	24V RELAY (M4, M5)	M3 - DCG3004003BXXXAB
0130M00249	AUXILLARY SWITCH (QTY 2)	M4 - DCG3004004BBXXAB
0163L00000	BECKETT BURNER (QTY 8)	M5 - DCG3004004BFXXAB
ZP137KCETFE155	COMP, 136,000, 575/60/3 (M13, M14, M15)	M6 - DCG3004004BHDXAB
ZP137KCETF5250	COMP, 137000, 200/230/60/3 (M1, M2, M3)	M7 - DCG3004004BHXXAB
ZP137KCETFD155	COMPRESSOR 135,000, 460/60/3 (M4, M5, M6, M7, M8, M9, M10, M11, M12)	M8 - DCG3004004BJJXAB
CONT3P030024V	CONTACTOR 30 AMP, 3P, 24V (QTY 3)	M9 - DCG3004004BVDBAB
CONT3P050024V	CONTACTOR 50 AMP, 3P, 24V (M1, M2, M3)	M10 - DCG3004004BVXXAB
0130L00020	CRANK CASE HEATER, 90W, 240V (M1, M2, M3)	M11 - DCG3004004BXXXAA
0130L00021	CRANK CASE HEATER, 90W, 480V (M4, M5, M6, M7, M8, M9, M10, M11, M12)	M12 - DCG3004004BXXXAB
0130L00022	CRANK CASE HEATER, 90W, 575V (M13, M14, M15)	M13 - DCG3004007BXSXAB
0130M00074	CUT-OUT SWITCH, HIGH PRESSURE (QTY 2)	M14 - DCG3004007BXXXAA
0130M00087	CUT-OUT SWITCH, LOW PRESSURE (QTY 2)	M15 - DCG3004007BXXXAB
0130L00112	DUCT TEMP SENSOR-OE230G (M4, M5)	
0164L00013	FAN BELT-NOTCHED	
0130F00010	FLAME SENSOR	
0130M00246	FUSE BLOCK	
0130M00247	FUSE BLOCK	
0130L00102	FUSE, J CLASS (QTY 3)	
0130L00101	FUSE, J CLASS (QTY 3)	
PCBAG123	IGNITION BOARD, DSI INTEGRATED	
20261709	IGNITOR	
0130M00064	LIMIT	
10123529	MANUAL RESET LIMIT-GREEN	
0131L00051	MOTOR, 7.5 HP BD 230,460V (M1, M2, M3, M4, M5, M6, M7, M8, M9, M10, M11, M12)	
0131L00050	MOTOR, 7.5 HP BELT DRIVE (M13, M14, M15)	
PCBCG100	PCB, CONTROL, HP, GAS (M4, M5)	
0130L00105	PHASE MONITOR (M8)	
11112501	PRESSURE SWITCH	
20162903	PRIMARY LIMIT - BLUE (M8, M13)	
0130M00063	PRIMARY LIMIT - GOLD 140° (M1, M2, M3, M4, M5, M6, M7, M9, M10, M11, M12, M14, M15)	
10135604	RELAY (M1, M3, M4, M5, M6, M7, M8, M9, M10, M12, M13, M15)	
0130M00264	RELAY, THERMISTOR (M1, M3, M4, M5, M6, M7, M8, M9, M10, M12, M13, M15)	
0130M00144	TRANSFORMER (M1, M2, M3)	
0130M00146	TRANSFORMER 480V TO 230V, 150VA (M4, M5, M6, M7, M8, M9, M10, M11, M12)	
0130M00145	TRANSFORMER 480V to 24V, 75VA (M4, M5, M6, M7, M8, M9, M10, M11, M12)	
0130M00147	TRANSFORMER 575V TO 230V, 150VA (M13, M14, M15)	
0130M00148	TRANSFORMER 575V to 24V, 75VA (M13, M14, M15)	
0151M00015	VALVE, GAS (HW) VR83	

Cabinet Assembly

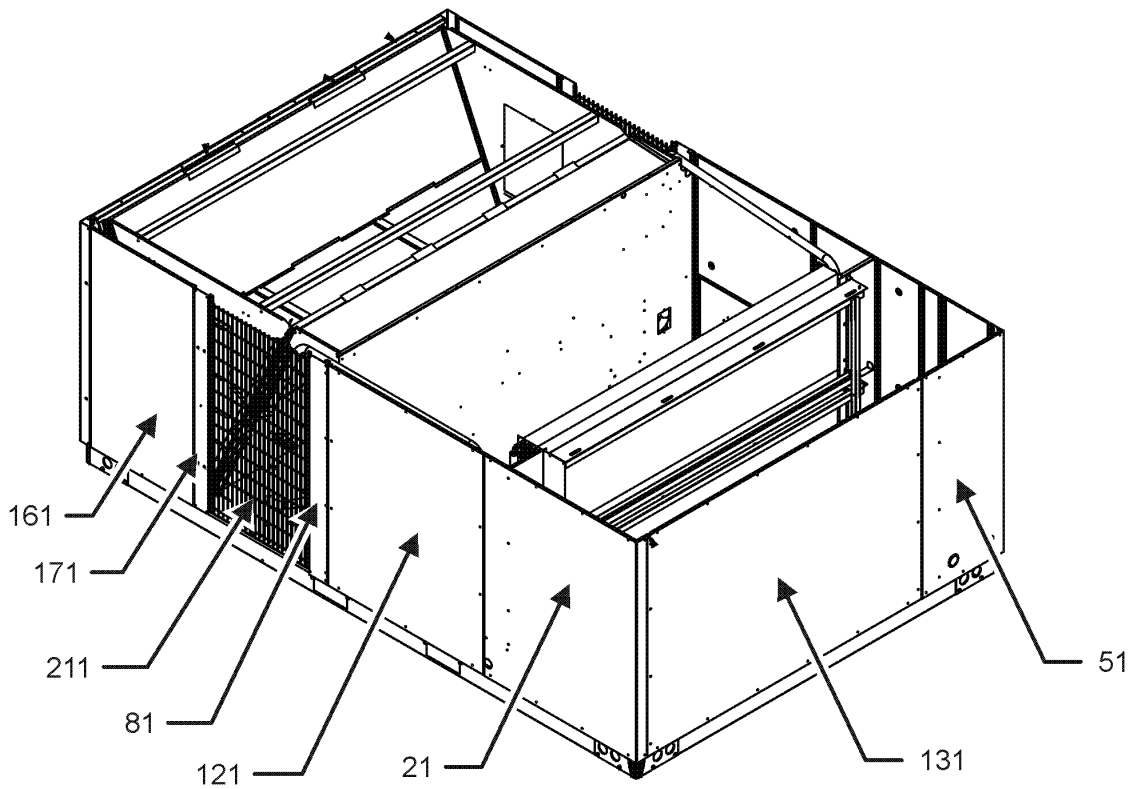
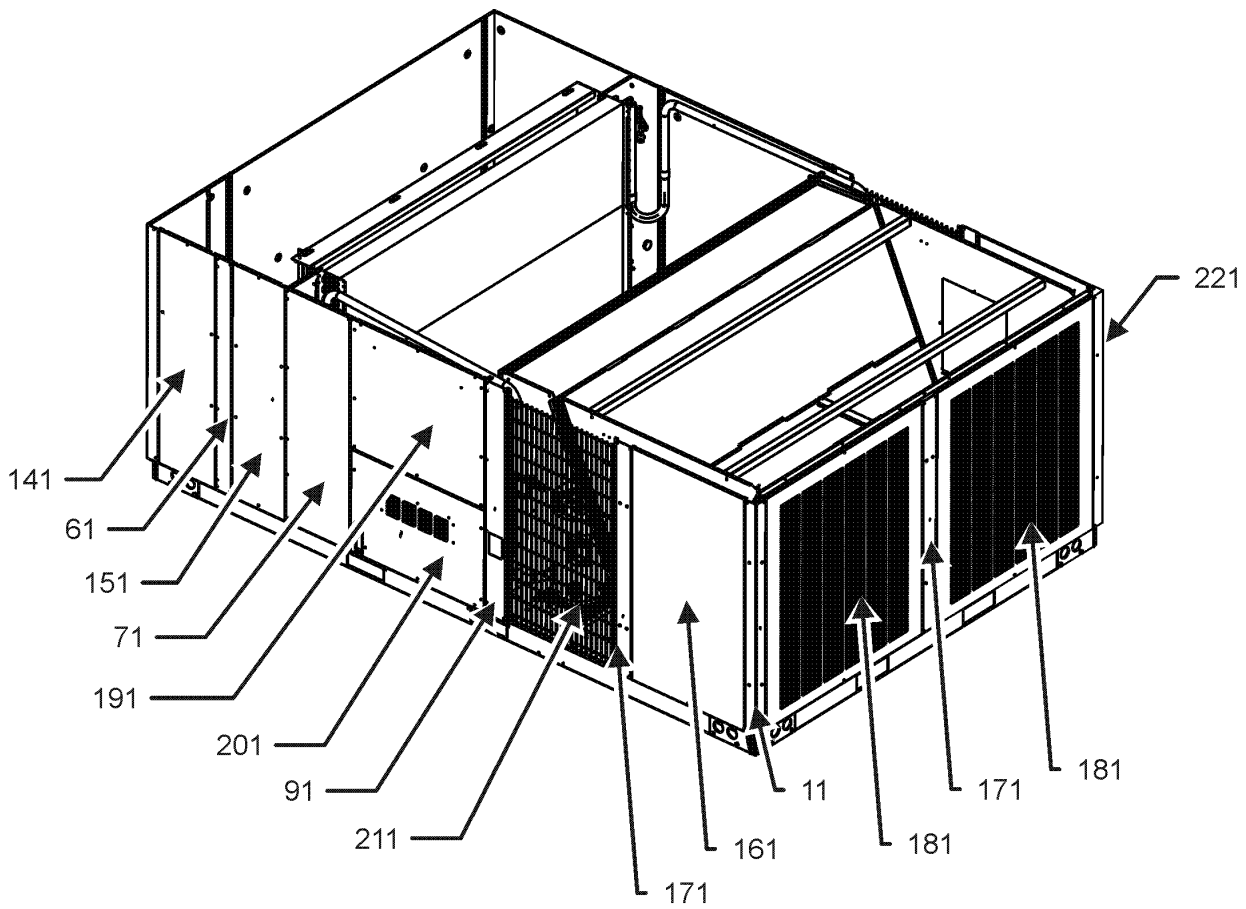

Cabinet Assembly

Ref. Part No:	Part No:	Description:	Ref. Part No:	Part No:	Description:
<i>Image 1:</i>					
11	0121L01143NG	POST, CORNER (QTY 2)			
21	0121L00681NG	EVAP PANEL			
51	0121L00679NG	CONTROL CORNER PANEL (M2, M3, M4, M5, M10, M11, M12, M13, M14, M15)			
51	0121L01900NG	CONTROL CORNER PANEL (M6)			
51	0121L01902NG	CONTROL COVER PANEL (M9)			
51	0121L00800NG	DUCT PANEL (M7, M8)			
51	0121L00742NG	PAINTED CONTROL CORNER (M1)			
61	0121L01937NG	CONTROL/FILTER POST (M6, M9)			
61	0121L02048NG	CONTROL/FILTER POST (M1, M2, M3, M4, M5, M7, M8, M10, M11, M12, M13, M14, M15)			
71	0121L01479NG	BLOWER DOOR POST (M6, M9)			
71	0121L00710NG	POST/BLOWER DOOR (M1, M2, M3, M4, M5, M7, M8, M10, M11, M12, M13, M14, M15)			
81	0121L00903NG	POST PARTITION-EVAP SIDE			
91	0121L01524NG	POST PARTITION, GAS FLUE (M6, M9)			
91	0121L00904NG	POST PARTITION-GAS FLUE (M1, M2, M3, M4, M5, M7, M8, M10, M11, M12, M13, M14, M15)			
121	0121L00685NG	BLOWER DOOR-EVAP SIDE			
131	0121L00688NG	ACCESSORY PANEL			
141	0121L00687NG	CONTROL DOOR (M1, M2, M3, M4, M5, M7, M8, M10, M11, M12, M13, M14, M15)			
141	0121L01603NG	CONTROL DOOR (M6, M9)			
151	0121L00686NG	FILTER DOOR (M1, M2, M3, M4, M5, M7, M8, M10, M11, M12, M13, M14, M15)			
151	0121L01601NG	FILTER DOOR (M6, M9)			
161	0121L00907NG	PANEL-COND SIDE (QTY 2)			
171	0121L01144NG	POST, COND PANEL (QTY 3)			
181	0121L01174NG	PANEL-LOUVER, END (QTY 2)			
191	0121L00713NG	BLOWER DOOR-GAS SIDE			
201	0121L00712NG	BURNERS DOOR			
211	0152L00000	GRILLE-CONDENSER (QTY 2)			
221	0121L00476NG	TURNBUCKLE DOOR (QTY 16)			
NS	0121L00562NG	HOOD-COMBUSTION AIR			
NS	M0204317	SCREW-MACHINE (QTY 16)			

Expanded Model Nomenclature

- M1 - DCG3004003BJXGAB
- M2 - DCG3004003BXXXAA
- M3 - DCG3004003BXXXAB
- M4 - DCG3004004BBXXAB
- M5 - DCG3004004BFXXAB
- M6 - DCG3004004BHDXAB
- M7 - DCG3004004BHXXAB
- M8 - DCG3004004BJJXAB
- M9 - DCG3004004BVDBAB
- M10 - DCG3004004BVXXAB
- M11 - DCG3004004BXXXAA
- M12 - DCG3004004BXXXAB
- M13 - DCG3004007BXSXAB
- M14 - DCG3004007BXXXAA
- M15 - DCG3004007BXXXAB

Top Panel Assembly

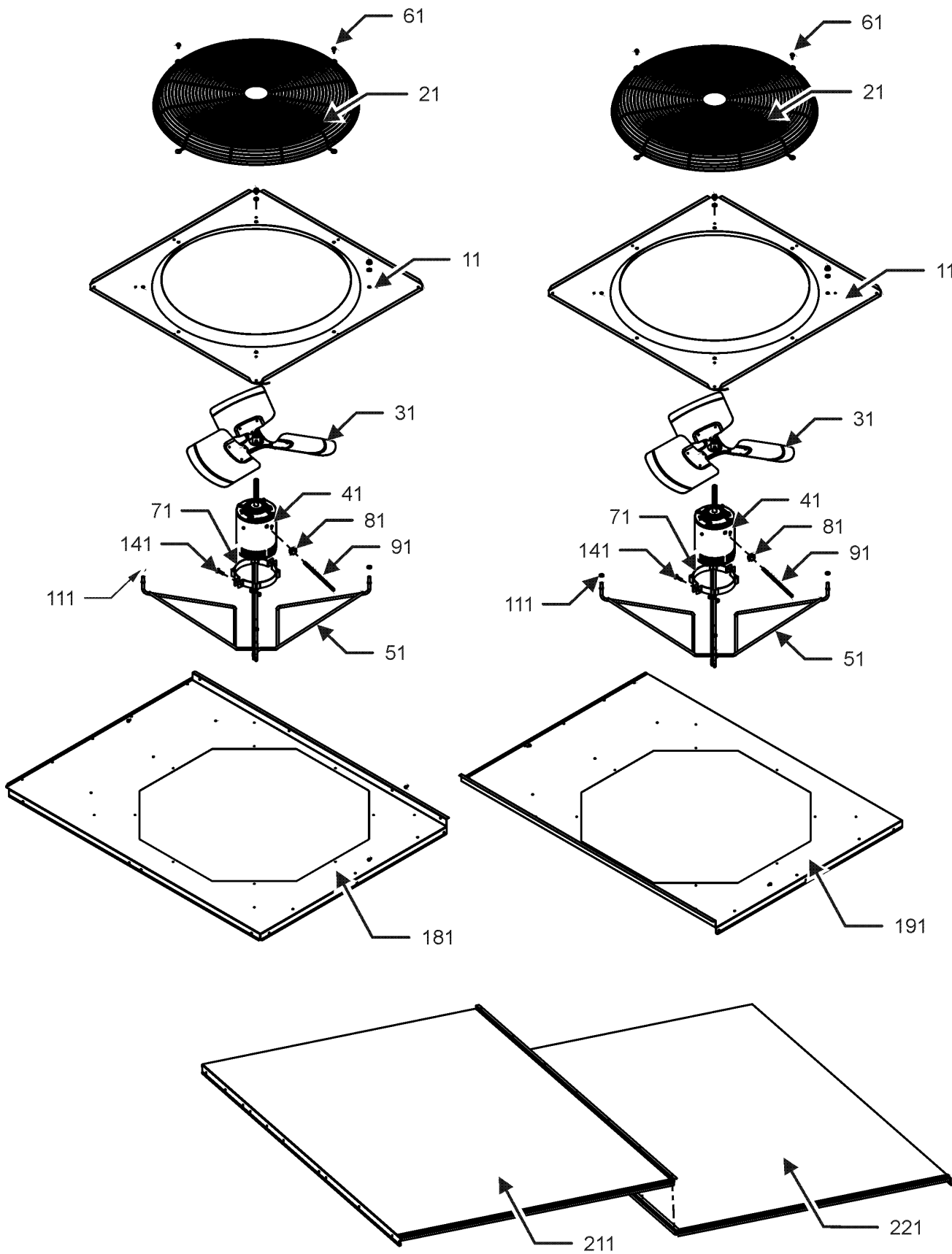

Top Panel Assembly

Ref. Part No: No:	Description:	Ref. Part No: No:	Description:
-------------------	--------------	-------------------	--------------

Image 1:

11	0121L01151NG	FAN PANEL 30" (QTY 2)
21	0152L00003	FAN GRILLE (QTY 2)
31	0150M00044	FAN BLADE (QTY 2)
41	0131M00697	MOTOR, COND (M1, M2, M3, M4, M5, M6, M7, M8, M9, M10, M11, M12)
41	0131M00721	MOTOR, COND 575 V (M13, M14, M15)
51	0163L00080	MOTOR MOUNT (QTY 2)
61	0163M00097	WASHERED SCREW (QTY 8)
71	0163L00082	MOTOR CLAMP BAND (QTY 2)
81	B1393726	ELECT. CONNECTING BUSHING (QTY 2)
91	0259L00219	POWER HARNESS, CM PIGTAIL (QTY 2)
111	B1392912	FLAT WASHER 3/8 ID X 7/8 OD (QTY 16)
141	0163M00275	CARRIAGE BOLT (QTY 2)
181	0121L01081NG	TOP, FAN C1
191	0121L01094NG	TOP, FAN C2
211	0121L00693NG	TOP-CONTROL SIDE
221	0121L00694NG	TOP PANEL ASSY

Expanded Model Nomenclature

M1 - DCG3004003BJXGAB
M2 - DCG3004003BXXXAA
M3 - DCG3004003BXXXAB
M4 - DCG3004004BBXXAB
M5 - DCG3004004BFXXAB
M6 - DCG3004004BHDXAB
M7 - DCG3004004BHXXAB
M8 - DCG3004004BJJXAB
M9 - DCG3004004BVDBAB
M10 - DCG3004004BVXXAB
M11 - DCG3004004BXXXAA
M12 - DCG3004004BXXXAB
M13 - DCG3004007BXSXAB
M14 - DCG3004007BXXXAA
M15 - DCG3004007BXXXAB

Partition and Base Pan Assembly

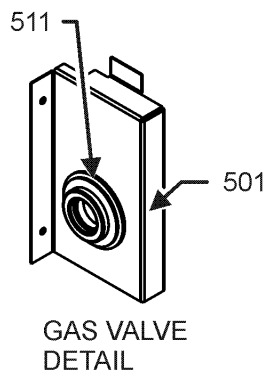
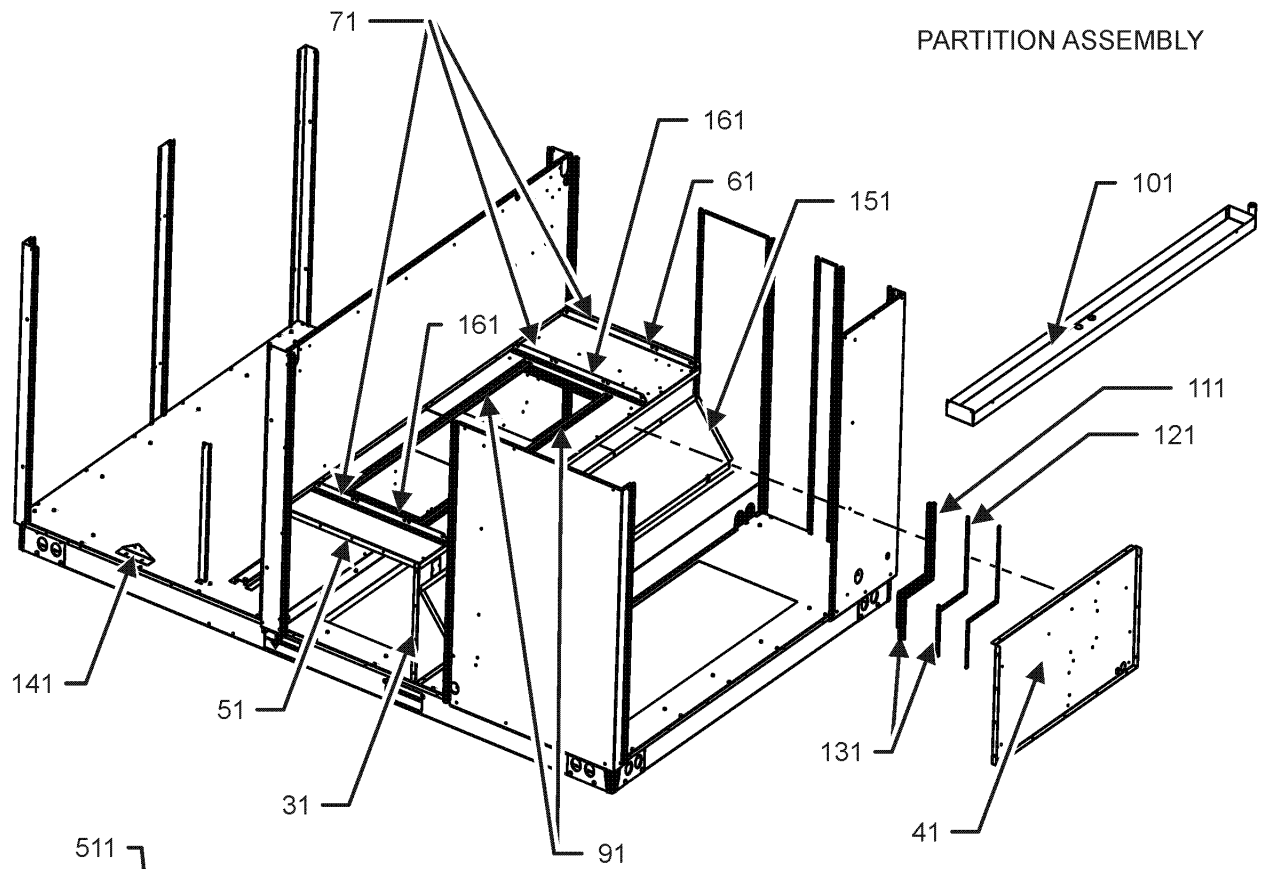

PARTITION PANEL REFERENCE ONLY

BASE PAN ASSEMBLY

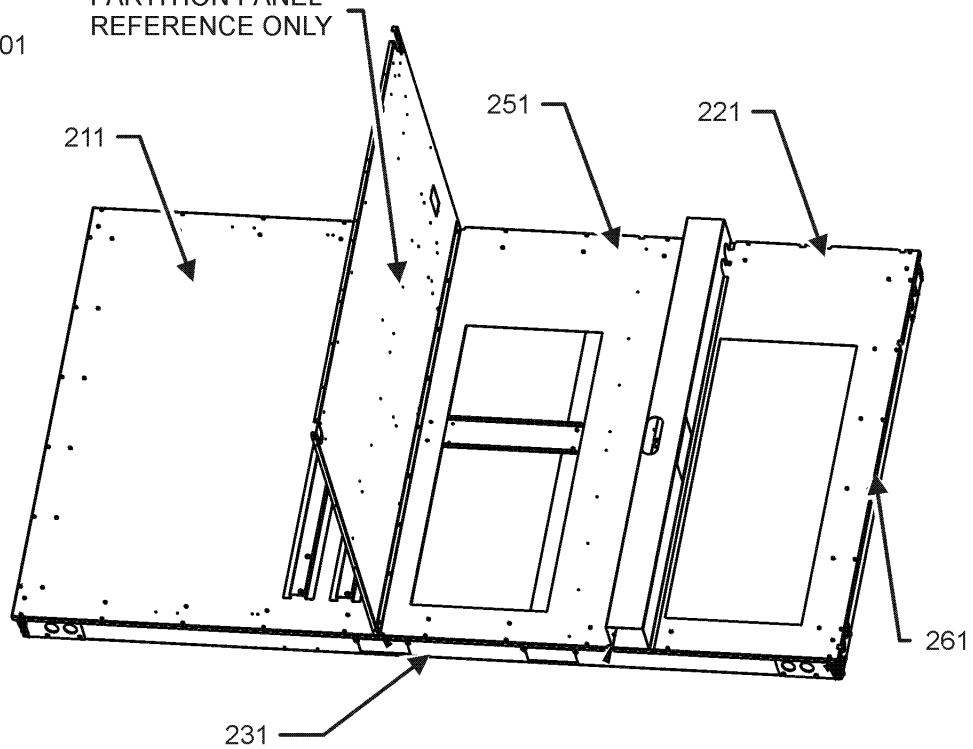

Partition and Base Pan Assembly

Ref. Part No:	No:	Description:	Ref. Part No:	No:	Description:
Image 1:					
31	0121L01163	DECK, SIDE DUCT END			
41	0121L01162	DECK, SIDE HEAT END			
51	0121L01160	BLOWER DECK, EVAP SIDE			
61	0121L01161	BLOWER DECK, MOTOR SIDE			
71	0121L01431	MOTOR MOUNT ANGLE (QTY 3)			
91	0121L00478	BLOWER DECK RAIL (QTY 2)			
101	0270L00612DG	WELDMENT-DRAIN PAN			
111	0121L00551	HEAT EXCHANGER ANGLE, RH SIDE			
121	0121L00552	HEAT EXCHANGER ANGLE, LH SIDE			
131	0121L00553	LOWER HEAT EXCHANGER ANGLE (QTY 2)			
141	0121L00913	BRACKET-COND/BASEPAN (QTY 2)			
151	0121L01158	SHIELD, BLOWOFF			
161	0121L00481	BLOWER RAIL (QTY 2)			
211	0121L00902	BASEPAN-OUTDOORS			
221	0121L00947	BASE PAN-RETURN			
231	0121L00720	SIDE RAIL			
251	0121L00948	BASE PAN-SUPPLY			
261	0121L00722	BASE RAIL, ACCESSORY END			
501	0121L00697	GAS VALVE PIPE BRACKET			
511	B1910013	GAS LINE GROMMET			
NS	0121L00723	BASE RAIL CORNER BRACE (QTY 4)			
NS	0121L00721	BASE RAIL, CONDENSER END (QTY 2)			
NS	0121L00625	COMPRESSOR RAIL BRACKET (QTY 4)			
NS	0121L00719	CONTROL SIDE BASE RAIL			
NS	0141L00029	FORK BOARD (QTY 2)			
NS	0121L00724	FORK BOARD BRACKET (QTY 4)			
NS	0121L00605	FORK BOARD PLATE			
NS	0121L00321	SMOKE DETECTOR COVER			

Expanded Model Nomenclature

M1 - DCG3004003BJXGAB
M2 - DCG3004003BXXXAA
M3 - DCG3004003BXXXAB
M4 - DCG3004004BBXXAB
M5 - DCG3004004BFXXAB
M6 - DCG3004004BHDXAB
M7 - DCG3004004BHXXAB
M8 - DCG3004004BJJXAB
M9 - DCG3004004BVDBAB
M10 - DCG3004004BVXXAB
M11 - DCG3004004BXXXAA
M12 - DCG3004004BXXXAB
M13 - DCG3004007BXSXAB
M14 - DCG3004007BXXXAA
M15 - DCG3004007BXXXAB

Condenser and Evaporator Assembly

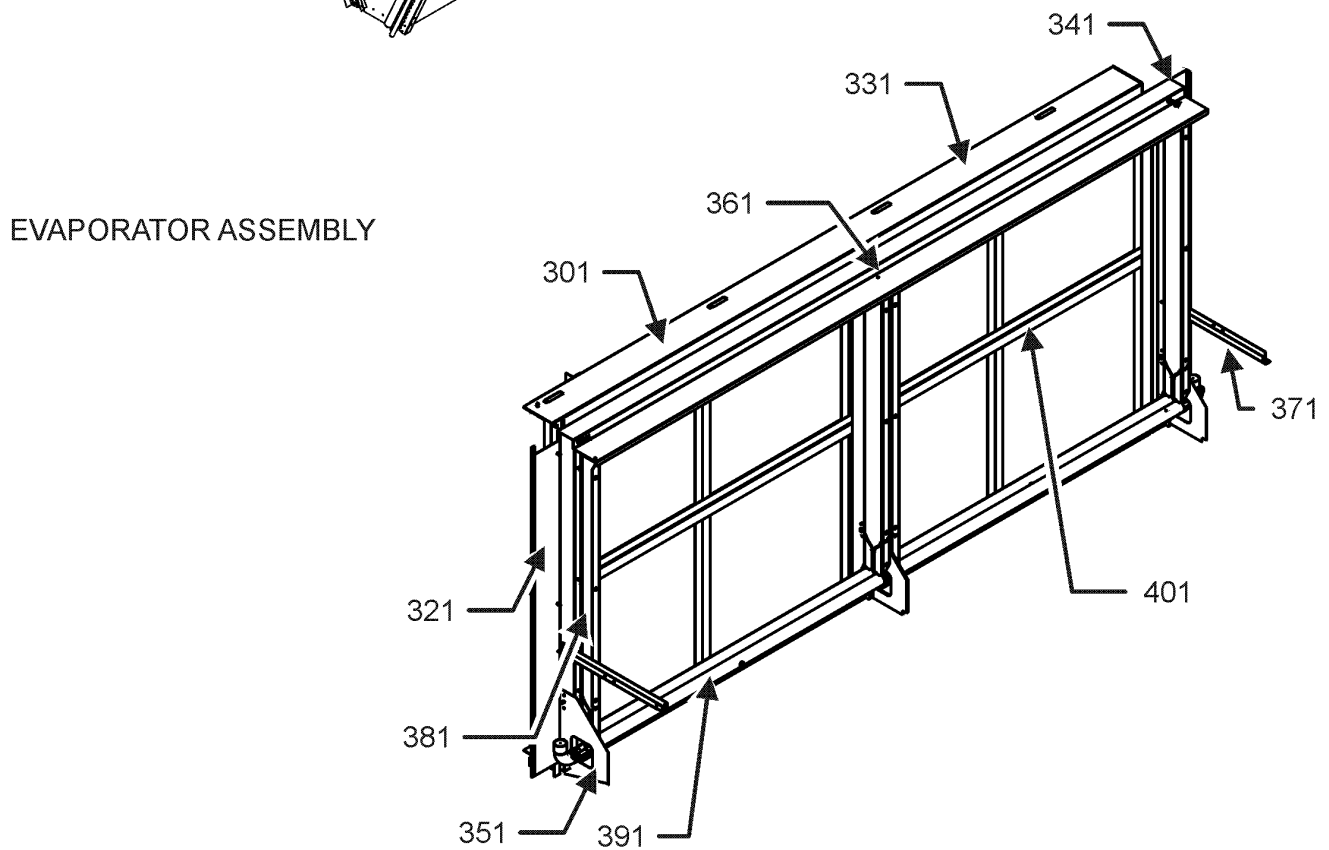
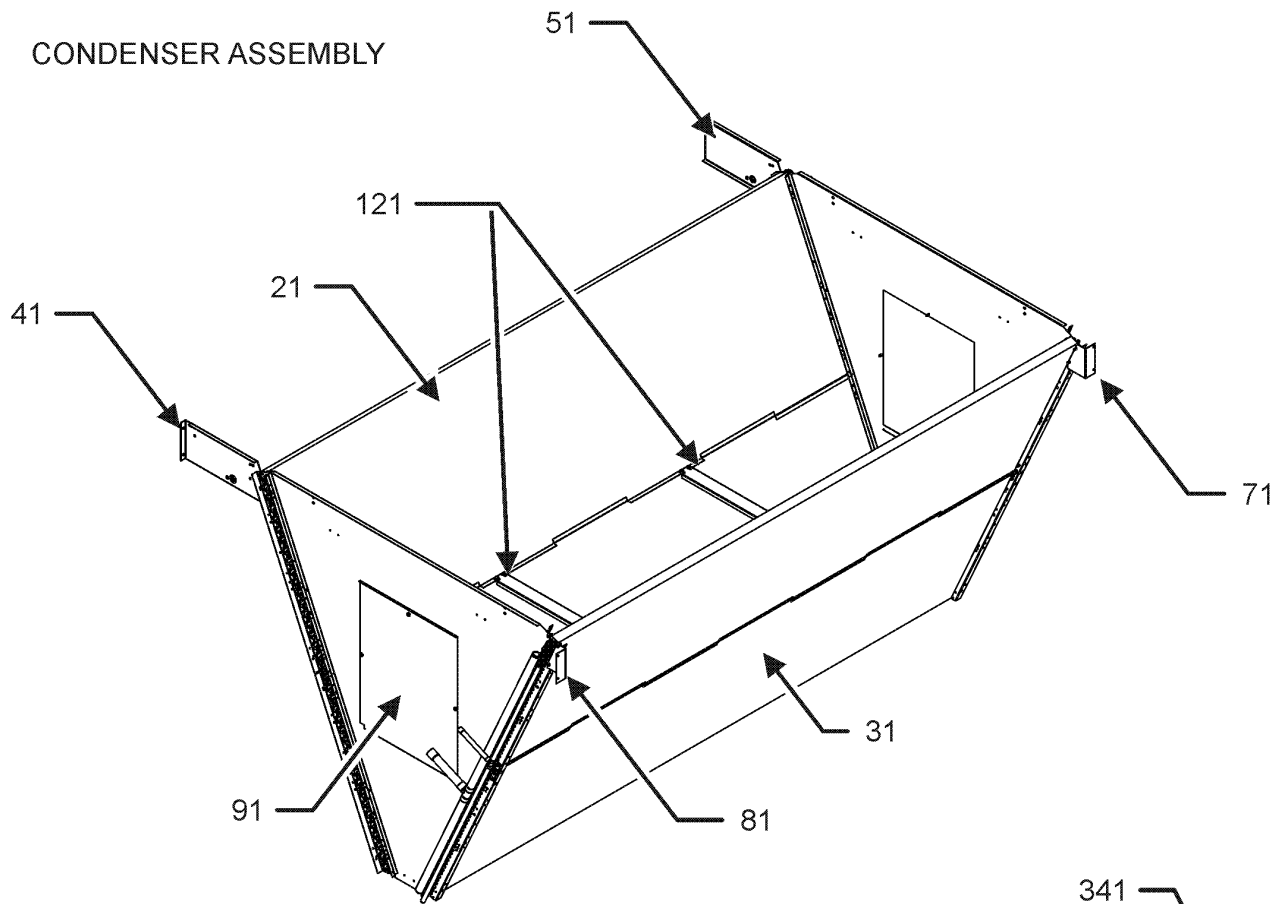

Condenser and Evaporator Assembly

Ref. Part No: No:	Description:	Ref. Part No: No:	Description:
-------------------	--------------	-------------------	--------------

Image 1:

21	0201L00151	CONDENSER COIL ASSY C1
31	0201L00152	CONDENSER COIL ASSY C2
41	0121L01154	BRACKET, CONDENSER END C1
51	0121L01156	BRACKET, CONDENSER END C2
71	0121L01153	BRACKET, COND/POST C2
81	0121L01155	BRACKET, COND/POST C1
91	0121L00910	COVER-COIL CLEANING (QTY 2)
121	0121L00901	BRACE-COND COILS (QTY 2)
301	0202L00102	EVAP COIL ASSY C1
321	0121L01086	EVAP BLOCKOFF, RIGHT
331	0202L00103	EVAP COIL ASSY C2
341	0121L01085	EVAP BLOCKOFF, LEFT
351	0121L01133	END SUPPORT PLATE (QTY 2)
361	0121L01188	TOP FILTER RACK
371	0121L01164	EVAP COIL SUPPORT BRACKET (QTY 2)
381	0121L01184	ANGLE, FILTER RACK
391	0121L01187	BOTTOM FILTER RACK
401	0270L00614	CENTER FILTER RACK
NS	0160L00136	Air Filter 20x20x2 (QTY 8)
NS	0121L01178	ANGLED FILTER SLIDER (QTY 4)
NS	0121L01139	BOTTOM BLOCKOFF, FILTER RACK
NS	0121L01137	FILTER PULL (QTY 2)
NS	0121L00632	FILTER SUPPORT ANGLE
NS	0121L01089	MIDDLE EVAP BLOCKOFF, LEFT
NS	0121L01088	MIDDLE EVAP BLOCKOFF, RIGHT

Expanded Model Nomenclature

M1 - DCG3004003BJXGAB
M2 - DCG3004003BXXXAA
M3 - DCG3004003BXXXAB
M4 - DCG3004004BBXXAB
M5 - DCG3004004BFXXAB
M6 - DCG3004004BHDXXAB
M7 - DCG3004004BHXXAB
M8 - DCG3004004BJJXAB
M9 - DCG3004004BVDBAB
M10 - DCG3004004BVXXAB
M11 - DCG3004004BXXXAA
M12 - DCG3004004BXXXAB
M13 - DCG3004007BXSXAB
M14 - DCG3004007BXXXAA
M15 - DCG3004007BXXXAB

Tubing and Compressor Assembly

TUBING ASSEMBLY

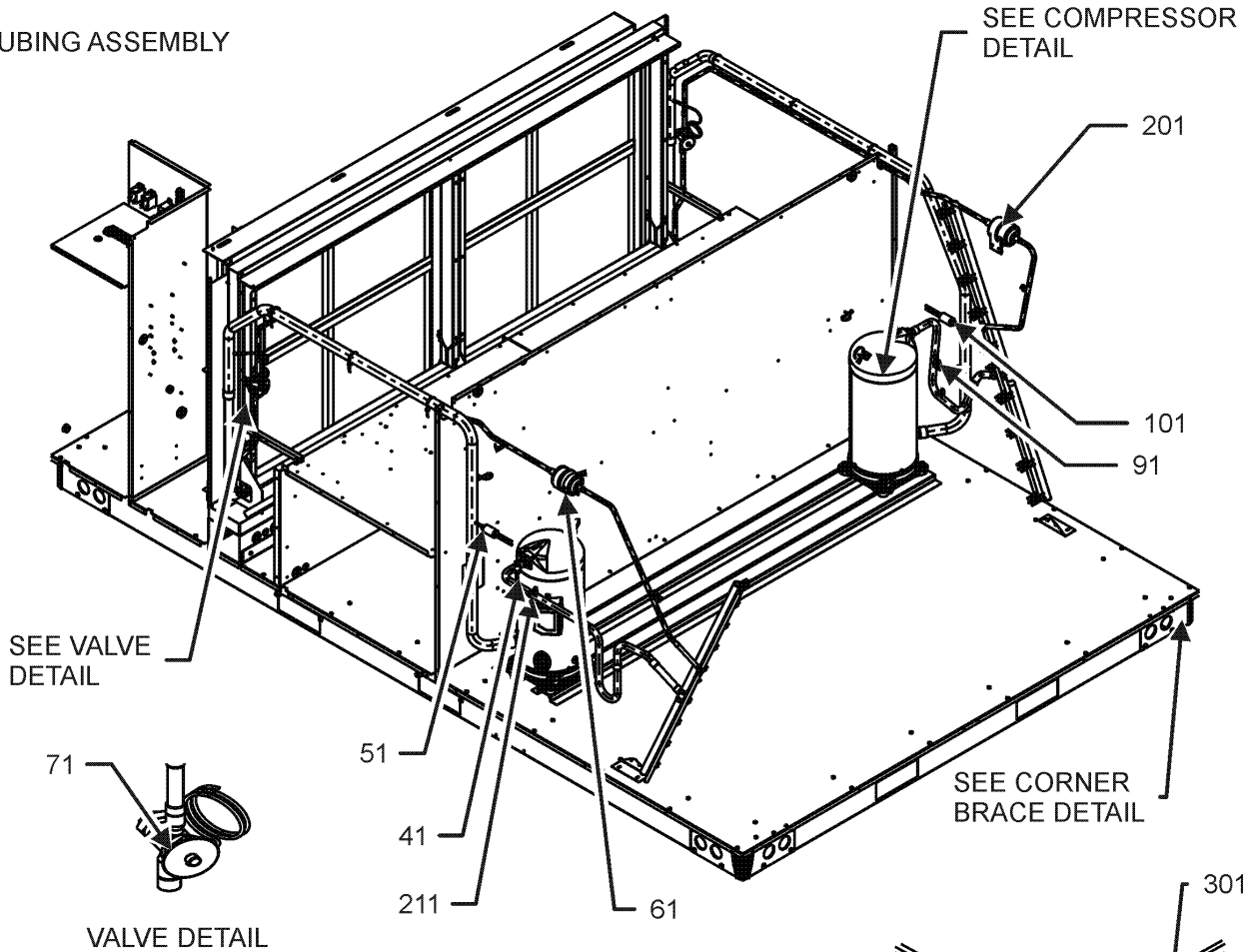

COMPRESSOR ASSEMBLY

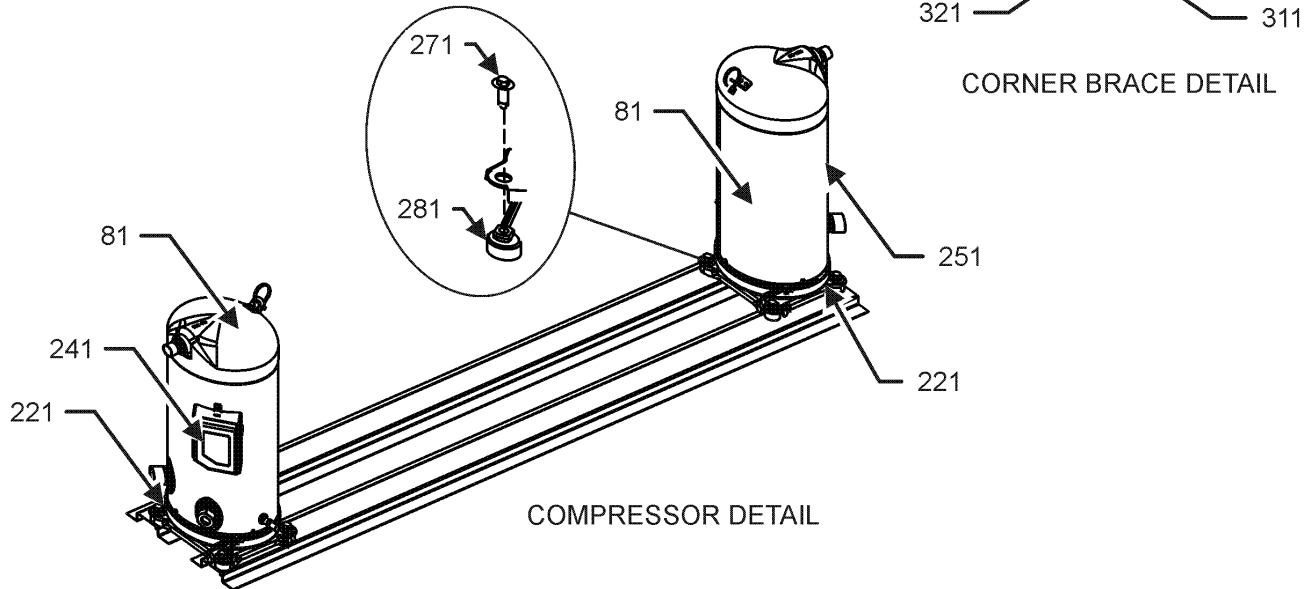

Tubing and Compressor Assembly

Ref. Part No: No:	Description:	Ref. Part No: No:	Description:
Image 1:			
41	0130M00074		CUT-OUT SWITCH, HIGH PRESSURE
51	0130M00087		CUT-OUT SWITCH, LOW PRESSURE
61	0162L00025		FILTER DRIER
71	0210L00470		TXV WELDMENT (QTY 2)
81	ZP137KCETFE155		COMP, 136,000, 575/60/3 (M13, M14, M15)
81	ZP137KCETF5250		COMP, 137000, 200/230/60/3 (M1, M2, M3)
81	ZP137KCETFD155		COMPRESSOR 135,000, 460/60/3 (M4, M5, M6, M7, M8, M9, M10, M11, M12)
91	0130M00074		CUT-OUT SWITCH, HIGH PRESSURE
101	0130M00087		CUT-OUT SWITCH, LOW PRESSURE
201	0162L00025		FILTER DRIER
211	B1787000		VALVE CORE (QTY 2)
221	0130L00020		CRANK CASE HEATER, 90W, 240V (M1, M2, M3)
221	0130L00021		CRANK CASE HEATER, 90W, 480V (M4, M5, M6, M7, M8, M9, M10, M11, M12)
221	0130L00022		CRANK CASE HEATER, 90W, 575V (M13, M14, M15)
241	0159L00061		COMPRESSOR SCROLL HARNESS (M1, M2, M3)
241	0159L00063		COMPRESSOR SCROLL HARNESS (M4, M5, M6, M7, M8, M9, M10, M11, M12, M13, M14, M15)
251	0159L00062		COMPRESSOR SCROLL HARNESS (M1, M2, M3)
251	0159L00064		COMPRESSOR SCROLL HARNESS (M4, M5, M6, M7, M8, M9, M10, M11, M12, M13, M14, M15)
261	0164M00018		COMPRESSOR GROMMET (QTY 8)
271	B1393740		COMPRESSOR BOLT & SLEEVE (QTY 8)
301	0121L00723		BASE RAIL CORNER BRACE (QTY 4)
311	0121L00616		RAIL BRACE ANGLE, RIGHT (QTY 4)
321	0121L00617		RAIL BRACE ANGLE, LEFT (QTY 4)
NS	0163M00175		CAP WITH O-RING (QTY 6)

Expanded Model Nomenclature

M1 - DCG3004003BJXGAB
M2 - DCG3004003BXXXAA
M3 - DCG3004003BXXXAB
M4 - DCG3004004BBXXAB
M5 - DCG3004004BFXXAB
M6 - DCG3004004BHDXAB
M7 - DCG3004004BHXXAB
M8 - DCG3004004BJJXAB
M9 - DCG3004004BVDBAB
M10 - DCG3004004BVXXAB
M11 - DCG3004004BXXXAA
M12 - DCG3004004BXXXAB
M13 - DCG3004007BXSXAB
M14 - DCG3004007BXXXAA
M15 - DCG3004007BXXXAB

Blower Assembly

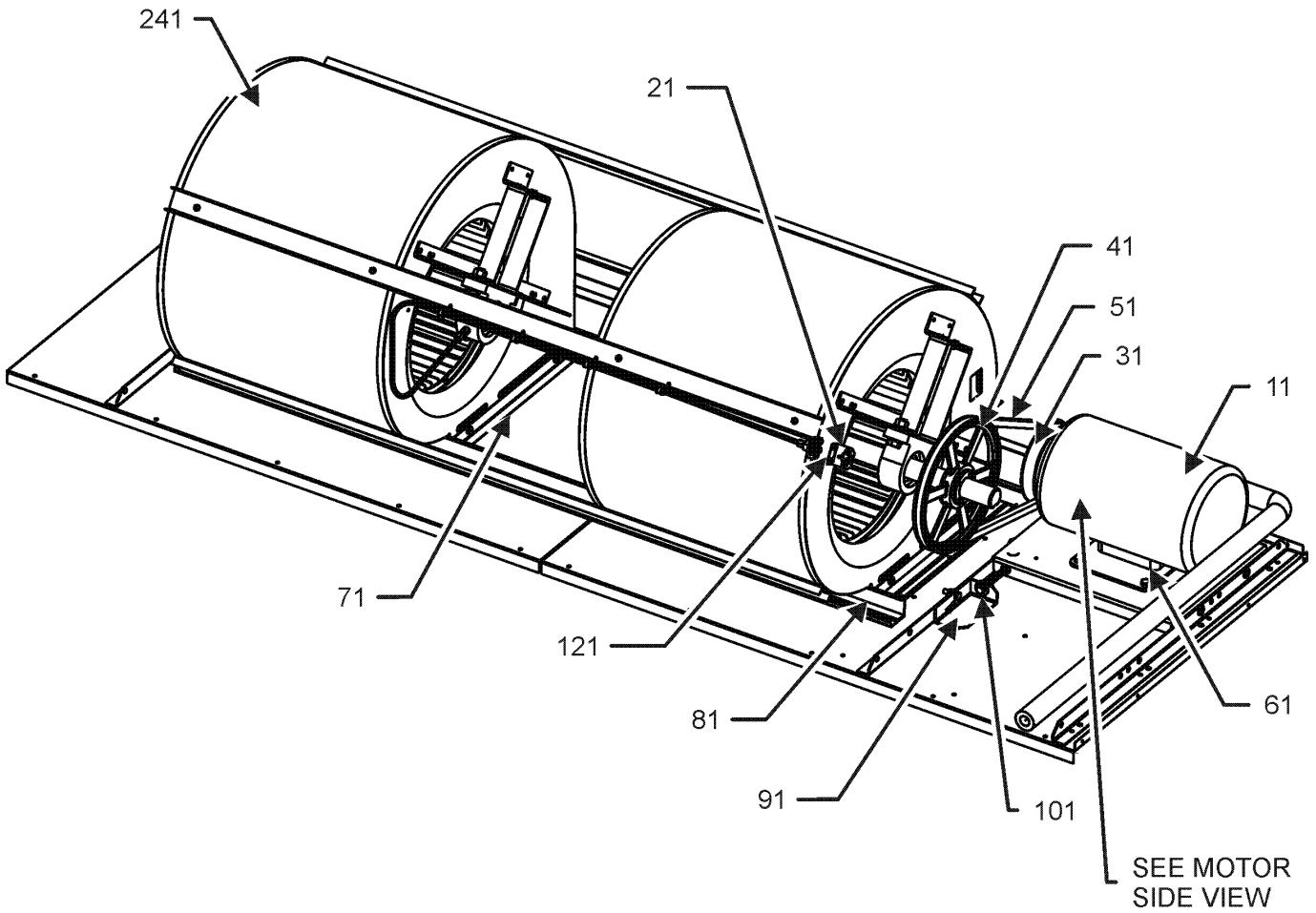

MOTOR SIDE VIEW

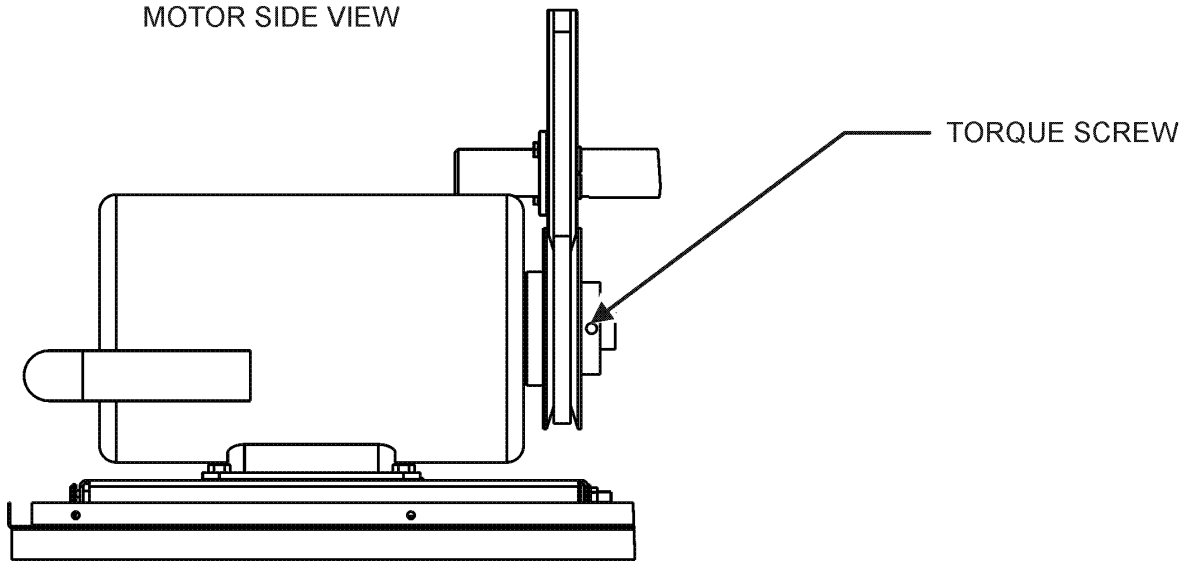

Blower Assembly

Ref. Part No: No:	Description:	Ref. Part No: No:	Description:
-------------------	--------------	-------------------	--------------

Image 1:

11	0131L00051	MOTOR, 7.5 HP BD 230,460V (M1, M2, M3, M4, M5, M6, M7, M8, M9, M10, M11, M12)
11	0131L00050	MOTOR, 7.5 HP BELT DRIVE (M13, M14, M15)
21	0130M00064	LIMIT
31	0163L00068	VP SHEAVE
41	0163L00141	SHEAVE, FIXED BK110H
51	0164L00013	FAN BELT-NOTCHED
61	0121L01430	BASE, MOTOR
71	0121L00482	BLOWER SIDE ANGLE (QTY 4)
81	0121L00479	BLOWER RAIL (QTY 2)
91	0121L01429	BRACKET, DRIVE SCREW
101	0163M00351	BOLT, 3/8-16-6
121	0121L00594	SECONDARY LIMIT BRACKET
241	0271L00027	150-15R BD 1.44 TWIN BLOWER

Expanded Model Nomenclature

- M1 - DCG3004003BJXGAB
- M2 - DCG3004003BXXXAA
- M3 - DCG3004003BXXXAB
- M4 - DCG3004004BBXXAB
- M5 - DCG3004004BFXXAB
- M6 - DCG3004004BHDXAB
- M7 - DCG3004004BHXXAB
- M8 - DCG3004004BJJXAB
- M9 - DCG3004004BVDBAB
- M10 - DCG3004004BVXXAB
- M11 - DCG3004004BXXXAA
- M12 - DCG3004004BXXXAB
- M13 - DCG3004007BXSXAB
- M14 - DCG3004007BXXXAA
- M15 - DCG3004007BXXXAB

Heat Exchanger Assembly

Ref. Part No:	Ref. Part No:	Description:	Description:
Image 1:			
41	0154L00025	COVER GASKET	
51	0121L00545	COVER-REAR 8 TUBE	
91	0131L00014	VENT MOTOR	
101	0270L00186	PARTITION TUBE ASSY 8B (M1, M2, M3, M4, M5, M6, M7, M9, M10, M11, M12, M14, M15)	
181	0154L00026	INNER COLLECTOR BOX GASKET	
191	0154L00027	OUTER COLLECTOR BOX GASKET	
201	0121L00550	COVER-COLLECTOR BOX 8	
211	0121L00546	CHANNEL-COLLECTOR BOX 8	
251	0154L00029	ID BLOWER GASKET	
261	0121L00668	FLUE WRAPPER, BACK	
281	20162903	PRIMARY LIMIT - BLUE (M8, M13)	
281	0130M00063	PRIMARY LIMIT - GOLD 140° (M1, M2, M3, M4, M5, M6, M7, M9, M10, M11, M12, M14, M15)	
301	11112501	PRESSURE SWITCH	
311	A3468601	PRESSURE SWITCH HOSE	
321	10123529	MANUAL RESET LIMIT-GREEN	
331	0121L00053	FLAME ROLLOUT BRACKET	
341	0121L00548	PLATE-TUBE PANEL 8	
351	0154L00028	TUBE PANEL GASKET	
381	0121L00930	SUPPORT-HEAT TUBES 2.25	
401	0121L00670	FLUE WRAPPER EXIT (M8, M13)	
401	0121L02100	FLUE-EXIT WRAPPER (M1, M2, M3, M4, M5, M6, M7, M9, M10, M11, M12, M14, M15)	
411	0121L00671	FLUE COVER EXIT	
431	0121L00669	FLUE COVER, FRONT	
441	0121L00808	SUPPORT-HEAT TUBES 2.25	
451	0121L00823	BRACKET-TUBE SUPPORT (QTY 2)	
511	20261709	IGNITOR	
521	0151M00015	VALVE, GAS (HW) VR83	
531	0163L00014	ORIFICE (QTY 8)	
541	0130F00010	FLAME SENSOR	
561	0163L00033	MANIFOLD-GAS 8 BURNER	
571	0163L00000	BECKETT BURNER (QTY 8)	
581	0121L00635	BRACKET-8 BURNERS	
591	0121G00268	BRACKET-BURNER TOP/BOT (QTY 2)	
NS	0163L00040	FLUE SCREEN	

Expanded Model Nomenclature

M1 - DCG3004003BJXGAB
M2 - DCG3004003BXXXAA
M3 - DCG3004003BXXXAB
M4 - DCG3004004BBXXAB
M5 - DCG3004004BFXXAB
M6 - DCG3004004BHDXAB
M7 - DCG3004004BHXXAB
M8 - DCG3004004BJJXAB
M9 - DCG3004004BVDBAB
M10 - DCG3004004BVXXAB
M11 - DCG3004004BXXXAA
M12 - DCG3004004BXXXAB
M13 - DCG3004007BXSXAB
M14 - DCG3004007BXXXAA
M15 - DCG3004007BXXXAB

Control Box Assembly

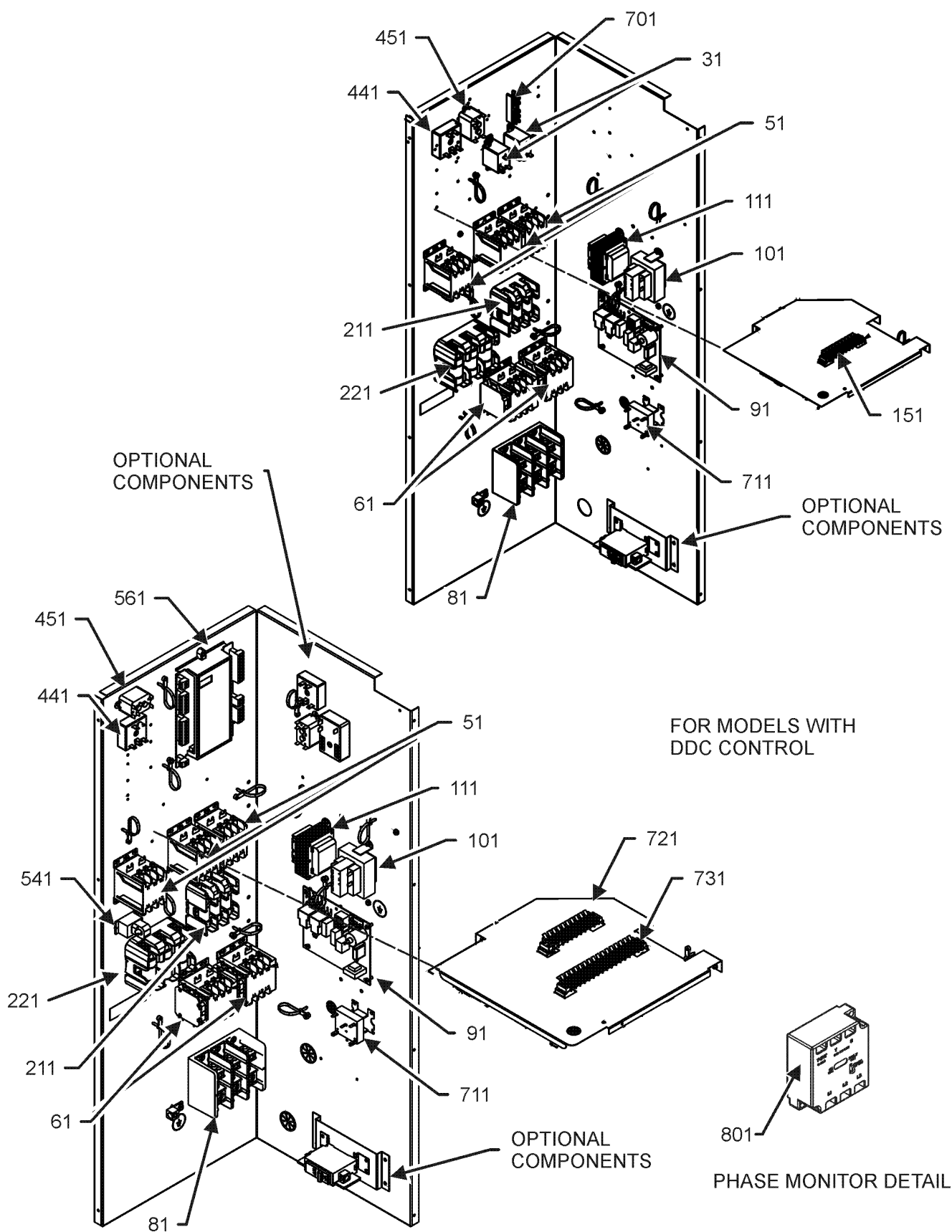

Control Box Assembly

Ref. Part No: No:	Description:	Ref. Part No: No:	Description:
Image 1:		Image 1:	
31	0130M00242 24V RELAY (QTY 2)	NS 0259L00229	HARN, PWR & CNTL, GAS (M1, M3, M4, M5, M6, M7, M8, M9, M10, M11, M12, M13, M14, M15)
51	CONT3P030024V CONTACTOR 30 AMP, 3P, 24V (QTY 3)	NS 0259L00456	HARN, PWR CNTL TR1 (M4, M5)
51	CONT3P050024V CONTACTOR 50 AMP, 3P, 24V (M1, M2, M3)	NS 0259L00218	HARN, PWR, CM, C1
61	0130M00249 AUXILLARY SWITCH (QTY 2)	NS 0259L00217	HARN, PWR, CM, C2
81	0130M00042 POWER BLOCK (M1, M2, M3, M4, M5, M6, M7, M8, M9, M10, M11, M12, M13, M15)	NS 0259L00215	HARN, PWR, CMC INTERCONN (M2, M11, M14)
91	PCBAG123 IGNITION BOARD, DSI INTEGRATED	NS 0259L00196	HARN, PWR, EM, 1 SPD
101	0130M00144 TRANSFORMER (M1, M2, M3)	NS 0259L00222	HARN, PWR, FB TO EM_CM, 1 SPD
101	0130M00145 TRANSFORMER 480V TO 24V, 75VA (M4, M5, M6, M7, M8, M9, M10, M11, M12)	NS 0259L00210	HARN, PWR, PB TO CC1 (M1, M2, M3, M4, M5)
101	0130M00147 TRANSFORMER 575V TO 230V, 150VA (M13, M14, M15)	NS 0259L00221	HARN, PWR, PB TO CC1 (M4, M5, M6, M7, M8, M9, M10, M11, M12, M13, M14, M15)
111	0130M00146 TRANSFORMER 480V TO 230V, 150VA (M4, M5, M6, M7, M8, M9, M10, M11, M12)	NS 0259L00211	HARN, PWR, PB TO CC2 (M1, M2, M3, M4, M5)
111	0130M00148 TRANSFORMER 575V TO 24V, 75VA (M13, M14, M15)	NS 0259L00220	HARN, PWR, PB TO CC2 (M4, M5, M6, M7, M8, M9, M10, M11, M12, M13, M14, M15)
151	0130M00240 TERMINAL BOARD	NS 0259L00199	HARN, PWR, PB TO FB
211	0130M00246 FUSE BLOCK	NS 0259L00460	HARN., IIC (M4, M5)
221	0130M00247 FUSE BLOCK	NS 0259L00247	HARNESS, CC_CMC (M1, M3, M4, M5, M6, M7, M8, M9, M10, M12, M13, M15)
441	0130M00264 RELAY, THERMISTOR (M1, M3, M4, M5, M6, M7, M8, M9, M10, M12, M13, M15)	NS 0259L00247	HARNESS, CC_CMC (M1, M3, M4, M5, M6, M7, M8, M9, M10, M12, M13, M15)
451	10135604 RELAY (M1, M3, M4, M5, M6, M7, M8, M9, M10, M12, M13, M15)	NS 0130L00108	OD Air Temp Sensor (M4, M5)
541	0259L00368 CURRENT SWITCH WITH TERMS (M4, M5)	NS 0130L00107	ROOM SENSOR (M4, M5)
561	PCBCG100 PCB, CONTROL, HP, GAS (M4, M5)	NS 0259L00473	WIRE ASSY (M8)
701	802007090 TERMINAL BOARD	NS 0259L00474	WIRE ASSY (M8)
711	0130M00025 24V RELAY (M4, M5)	NS 0259L00090	WIRE HARNESS-SMOKE DETECTOR (M1)
721	0130M00274 TERMINAL BOARD (M4, M5)	Expanded Model Nomenclature M1 - DCG3004003BJXGAB M2 - DCG3004003BXXXAA M3 - DCG3004003BXXXAB M4 - DCG3004004BBXXAB M5 - DCG3004004BFXXAB M6 - DCG3004004BHDXXAB M7 - DCG3004004BHXXAB M8 - DCG3004004BJJXAB M9 - DCG3004004BVDBAB M10 - DCG3004004BVXXAB M11 - DCG3004004BXXXAA M12 - DCG3004004BXXXAB M13 - DCG3004007BXSXAB M14 - DCG3004007BXXXAA M15 - DCG3004007BXXXAB	
731	0130M00275 TERMINAL BOARD (M4, M5)		
801	0130L00105 PHASE MONITOR (M8)		
NS 0130L00112	DUCT TEMP SENSOR-OE230G (M4, M5)		
NS 0130L00101	FUSE, J CLASS (QTY 3)		
NS 0130L00102	FUSE, J CLASS (QTY 3)		
NS 0259L00248	HARN, BC_CCR, 1 SPD EM (M1, M3, M4, M5, M6, M7, M8, M9, M10, M12, M13, M15)		
NS 0259L00450	HARN, CC_CMC (M4, M5)		
NS 0259L00451	HARN, CH, C1 (M4, M5)		
NS 0259L00452	HARN, CH, C2 (M4, M5)		
NS 0259L00212	HARN, CH/LPS/HPS, C1 (M2, M11, M14)		
NS 0259L00278	HARN, CH/LPS/HPS, C1 (M1, M3, M4, M5, M6, M7, M8, M9, M10, M12, M13, M15)		
NS 0259L00213	HARN, CH/LPS/HPS, C2 (M2, M11, M14)		
NS 0259L00279	HARN, CH/LPS/HPS, C2 (M1, M3, M4, M5, M6, M7, M8, M9, M10, M12, M13, M15)		
NS 0259L00245	HARN, CNTL GAS 230V (M2)		
NS 0259L00207	HARN, CNTL, BR_CCR, 1SPD EM (M2, M11, M14)		
NS 0259L00202	HARN, CNTL,CC_CM (M2, M11, M14)		
NS 0259L00463	HARN, COMP1-CCH-HPS-LPS (M4, M5)		
NS 0259L00462	HARN, COMP2-CCH-HPS-LPS (M4, M5)		
NS 0259L00455	HARN, DDC 10 PIN CONN (M4, M5)		
NS 0259L00475	HARN, DDC 12 PIN 1SPD GAS CONN (M4, M5)		
NS 0259L00453	HARN, DDC 2 PIN CONN (M4, M5)		
NS 0259L00454	HARN, DDC 6 PIN CONN (M4, M5)		
NS 0259L00457	HARN, DDC 8 PIN CONN (M4, M5)		
NS 0259L00203	HARN, IGN SUB-ASSY 2, ECON PLF		
NS 0259L00204	HARN, IGN, SUB-ASSY 1, IGN PLM		
NS 0259L00235	HARN, IGN, SUB-ASSY 5		

Accessory Parts List

ACCESSORY PARTS LIST

NOTE: NOT ALL OPTIONS AVAILABLE FOR ALL PRODUCTS

1 LOW AMBIENT KITS

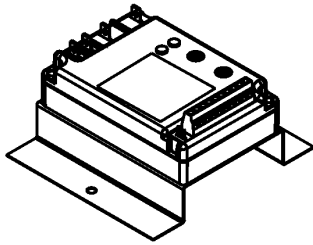

2 GFCI CONVENIENCE OUTLET

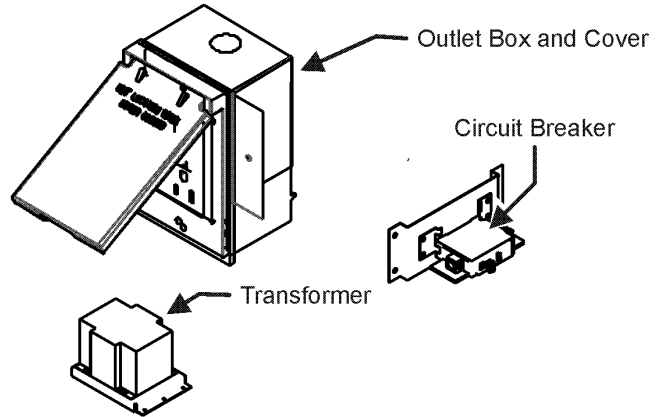

3 DISCONNECT MODULE (NON-FUSED)

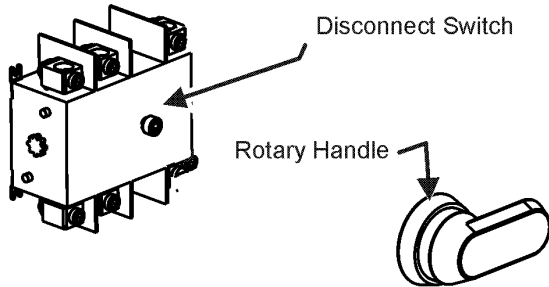

4 SMOKE DETECTORS

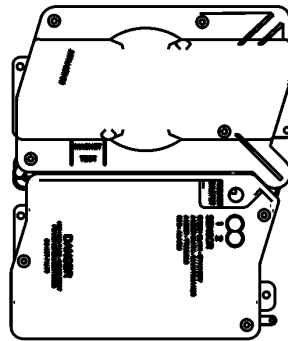

5 DDC CONTROL

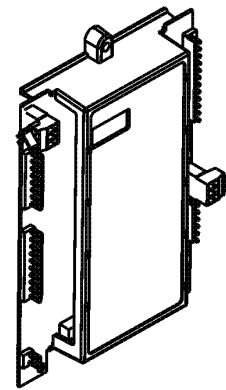

6 HINGED DOOR ASSEMBLIES

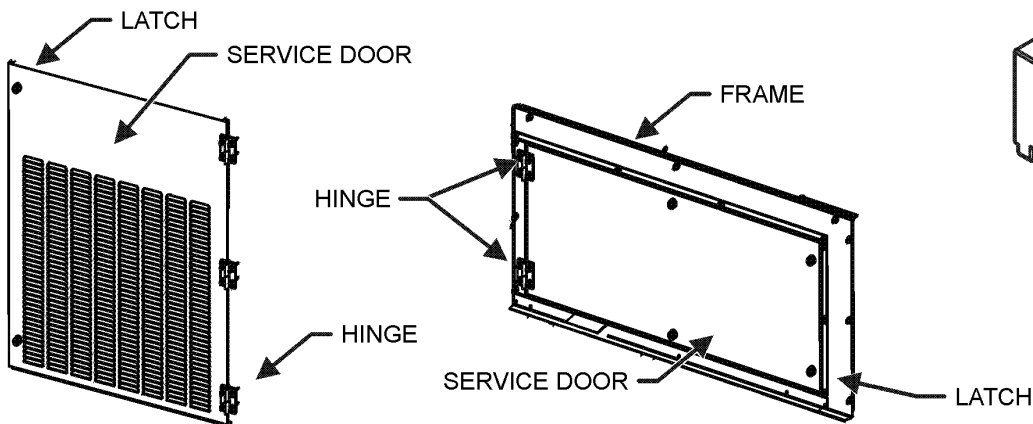

7 PHASE MONITOR

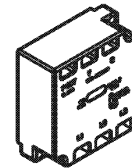

Accessory Parts List

Ref. Part No:	Part No:	Description:	Ref. Part No:	Part No:	Description:
Image 1:					
NS	DDNECNJ180300B	15-25 TON DFLOW ECON (M9, M10)			
NS	1036611B	15-25T DFLOW ECON (M1, M8)			
NS	10366D11B	15-25T DFLOW ECON, DDC (M5)			
NS	0121L00316	BRACKET-CONV OUTLET MOUNT (M1, M9)			
NS	0121L00855	BRACKET-DISCONNECT SWITCH (M1, M6, M7, M8)			
NS	0121L01053	BRACKET-SMOKE DETECTOR (M1)			
NS	0130M00065	CIRCUIT BREAKER, CONVENIENCE OUTLET (M9)			
NS	0121L01603NG	CONTROL DOOR (M6, M9)			
NS	0121L00839NG	DISCONNECT COVER (M1, M6, M7, M8)			
NS	0121L01601NG	FILTER DOOR (M6, M9)			
NS	0130L00012	GANG BOX-GFCI OUTLET (M1, M9)			
NS	0130L00039	HANDLE, ROTARY (M1, M6, M7, M8)			
NS	0163M00307	HINGE, LEFT HAND (M6, M9)			
NS	0161G00012	POWER OUTLET BOX (M1, M9)			
NS	0130L00103	RECEPTACLE-GFCI OUTLET (M1, M9)			
NS	0121L01486NG	SERVICE DOOR BACK BLOWER (M6, M9)			
NS	0121L01484NG	SERVICE DOOR FRAME, BLOWER (M6, M9)			
NS	0121L01485NG	SERVICE DOOR FRONT BLOWER (M6, M9)			
NS	0130L00043	SHAFT, CUT (M1)			
NS	0130L00058	SHAFT, CUT (M6, M7)			
NS	0130L00059	SHAFT, CUT (M8)			
NS	0130L00049	SHAFT, DISCONNECT (M1, M6, M7, M8)			
NS	D4120	SMOKE DETECTOR, PHOTO 4WIRE (M1)			
NS	0130L00027	SWITCH-DISCONNECT 100A (M6, M7)			
NS	0130L00033	SWITCH-DISCONNECT 200A (M1)			
NS	0130L00046	SWITCH-DISCONNECT 60A (M8)			
NS	0130M00061	TRANSFORMER, CONVENIENCE OUTLET (M9)			

Expanded Model Nomenclature

M1 - DCG3004003BJXGAB
M2 - DCG3004003BXXXAA
M3 - DCG3004003BXXXAB
M4 - DCG3004004BBXXAB
M5 - DCG3004004BFXXAB
M6 - DCG3004004BHDXXAB
M7 - DCG3004004BHXXAB
M8 - DCG3004004BJJXAB
M9 - DCG3004004BVDBAB
M10 - DCG3004004BVXXAB
M11 - DCG3004004BXXXAA
M12 - DCG3004004BXXXAB
M13 - DCG3004007BXSXAB
M14 - DCG3004007BXXXAA
M15 - DCG3004007BXXXAB