

Commercial 8.5 Ton Package Cooling Unit

DCC1020163BBXXAB
DCC1020163BHXXAA
DCC1020163BHXXAB
DCC1020163BJXFAB
DCC1020164BXXAAB
DCC1020164BXXAAC
DCC1020303BHXFAB
DCC1020303BHXXAB
DCC1020303BJXAAB
DCC1020304BHXBAC
DCC1020304BJXFAC
DCC102XXX3BHDBAB
DCC102XXX3BHXXAA
DCC102XXX3BHXXAB
DCC102XXX3BJXAAB
DCC102XXX3BXXXAA
DCC102XXX3BXXXAB
DCC102XXX4BFXXAC
DCC102XXX4BHXFAC
DCC102XXX4BHXXAB
DCC102XXX4BHXXAC
DCC102XXX4BJXBAC
DCC102XXX4BXXBAB
DCC102XXX4BXXBAC
DCC102XXX4BXXXAA
DCC102XXX4BXXXAB
DCC102XXX4BXXXAC
DCC102XXX7BXXXAA
DCC102XXX7BXXXAB
DCC102XXX7BXXXAC

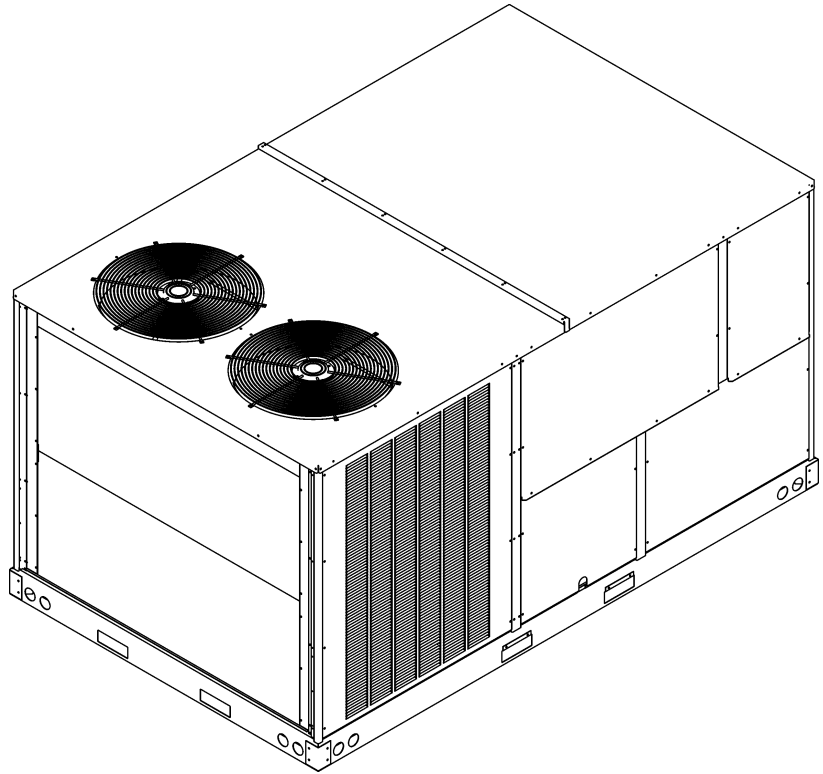

This manual is to be used by qualified technicians only.

This manual replaces RP-D1022L.

Important Information

Index

| | |
|------------------------------|--------|
| Functional Parts List | 3 |
| Illustration and Parts | 4 - 15 |

Views shown are for parts illustrations only, not servicing procedures.

Text Codes:

AR - As Required

NA - Not Available

NS - Not Shown

00000000 - See Note

QTY - Quantity Example (QTY 3) (If Quantity not shown, Quantity = 1)

M - Model Example (M1) (If M Code not shown, then part is used on all Models)

Expanded Model Nomenclature:

| |
|--------------|
| Example |
| M1 - Model#1 |
| M2 - Model#2 |
| M3 - Model#3 |

Daikin Company, L.P. is not responsible for personal injury or property damage resulting from improper service. Review all service information before beginning repairs.

Warranty service must be performed by an authorized technician, using authorized factory parts. If service is required after the warranty expires, Daikin Company, L.P. also recommends contacting an authorized technician and using authorized factory parts.

Daikin Company, L.P. reserves the right to discontinue, or change at any time, specifications or designs without notice or without incurring obligations.

For assistance within the U.S.A. contact:

Equipment Support
Daikin North America, LLC
19001 Kermier Road
Waller, Texas 77484
855-770-5678-Telephone
713-863-2382-Facsimile

For assistance outside the U.S.A. contact:

International Division
Daikin North America, LLC
19001 Kermier Road
Waller, Texas 77484
713-861-2500-Telephone
713-863-2382-Facsimile

Functional Parts

Part

No: Description:

| | |
|----------------|--|
| B3240006 | BELT DRIVE MOTOR 2 HP (M1, M2, M3, M4, M5, M6, M7, M8, M9, M10, M11, M12, M13, M14, M15, M16, M20, M21, M22, M23, M24, M25, M26, M27, M28, M29, M30) |
| 0131L00005 | BELT DRIVE MOTOR 2 HP 575 V (M17, M18, M19) |
| 03-77429 | BLOWER WHEEL |
| CAP030000440LA | CAPACITOR 3/440V (M18, M19) |
| CAP050000370LA | CAPACITOR 5/370V (M1, M2, M3, M4, M5, M6, M14, M17, M20, M21, M22, M23, M26, M27, M28) |
| CAP075000370LA | CAPACITOR 7.5/370V (M7, M8, M9, M10, M11, M12, M13, M15, M16, M24, M25, M29, M30) |
| ZP44K5ETF5130 | COMPRESSOR 44000, 200/230/60/3 (M1, M2, M3, M4, M5, M6, M20, M21, M22, M23, M26, M27, M28) |
| ZP44K5ETFD130 | COMPRESSOR 44000, 460/60/3 (M7, M8, M9, M10, M11, M12, M13, M14, M15, M16, M24, M25, M29, M30) |
| ZP44K5ETFE130 | COMPRESSOR 44000, 575/60/3 (M17, M18, M19) |
| B13400269 | COND MOTOR 380/460 50/60 CYCLE (M14) |
| 0131M00432 | COND MOTOR 380/460/50/60 CYCLE (M7, M8, M9, M10, M11, M12, M13, M15, M16, M24, M25, M29, M30) |
| 0131M00098 | COND MOTOR 575V (M17) |
| 0131M00431 | COND MOTOR 575V (M18, M19) |
| CONT3P025024V | CONTACTOR 25 AMP, 3P, 24V (QTY 3) |
| 0130M00030 | CUT-OUT SWITCH, HIGH PRESSURE |
| 0130M00031 | CUT-OUT SWITCH, HIGH PRESSURE |
| 0130L00002 | CUT-OUT SWITCH, LOW PRESSURE (M1, M2, M3, M4, M6, M7, M8, M9, M10, M11, M13, M14, M16, M19, M20, M22, M23, M25, M26, M27, M28, M29, M30) |
| 0130L00003 | CUT-OUT SWITCH, LOW PRESSURE |
| 0130L00112 | Duct Temp Sensor (M7, M20) |
| PCBFM103 | ELECTRONIC BLOWER TIME DELAY |
| 0150G00001 | FAN BLADE (QTY 2) |
| 0131M00847 | MOTOR, 1/4 HP, 1 SP, 6 PL (M1, M2, M3, M4, M5, M6, M20, M21, M22, M23, M26, M27, M28) |
| 0164L00000 | NOTCHED FAN BELT AX51 |
| 0130L00108 | OD Air Temp Sensor (M7, M20) |
| 0130M00038 | TERMINAL BOARD |
| 0130M00144 | TRANSFORMER (M1, M2, M3, M4, M5, M6, M20, M21, M22, M23, M26, M27, M28) |
| 0130M00145 | TRANSFORMER 480V to 24V, 75VA (M7, M8, M9, M10, M11, M12, M13, M14, M15, M16, M24, M25, M29, M30) |
| 0130M00148 | TRANSFORMER 575V to 24V, 75VA (M17, M18, M19) |

Expanded Model Nomenclature

| |
|------------------------|
| M1 - DCC102XXX3BHDBAB |
| M2 - DCC102XXX3BHXXAA |
| M3 - DCC102XXX3BHXXAB |
| M4 - DCC102XXX3BJXAAB |
| M5 - DCC102XXX3BXXXAA |
| M6 - DCC102XXX3BXXXAB |
| M7 - DCC102XXX4BFXXAC |
| M8 - DCC102XXX4BHXFAC |
| M9 - DCC102XXX4BHXXAB |
| M10 - DCC102XXX4BHXXAC |
| M11 - DCC102XXX4BJXBAC |
| M12 - DCC102XXX4BXXBAB |
| M13 - DCC102XXX4BXXBAC |
| M14 - DCC102XXX4BXXXAA |
| M15 - DCC102XXX4BXXXAB |
| M16 - DCC102XXX4BXXXAC |
| M17 - DCC102XXX7BXXXAA |
| M18 - DCC102XXX7BXXXAB |
| M19 - DCC102XXX7BXXXAC |
| M20 - DCC1020163BBXXAB |
| M21 - DCC1020163BHXXAA |
| M22 - DCC1020163BHXXAB |
| M23 - DCC1020163BJXFAB |
| M24 - DCC1020164BXXAAB |
| M25 - DCC1020164BXXAAC |
| M26 - DCC1020303BHXFAB |
| M27 - DCC1020303BHXXAB |
| M28 - DCC1020303BJXAAB |
| M29 - DCC1020304BHXBAC |
| M30 - DCC1020304BJXFAC |

Cabinet Assembly

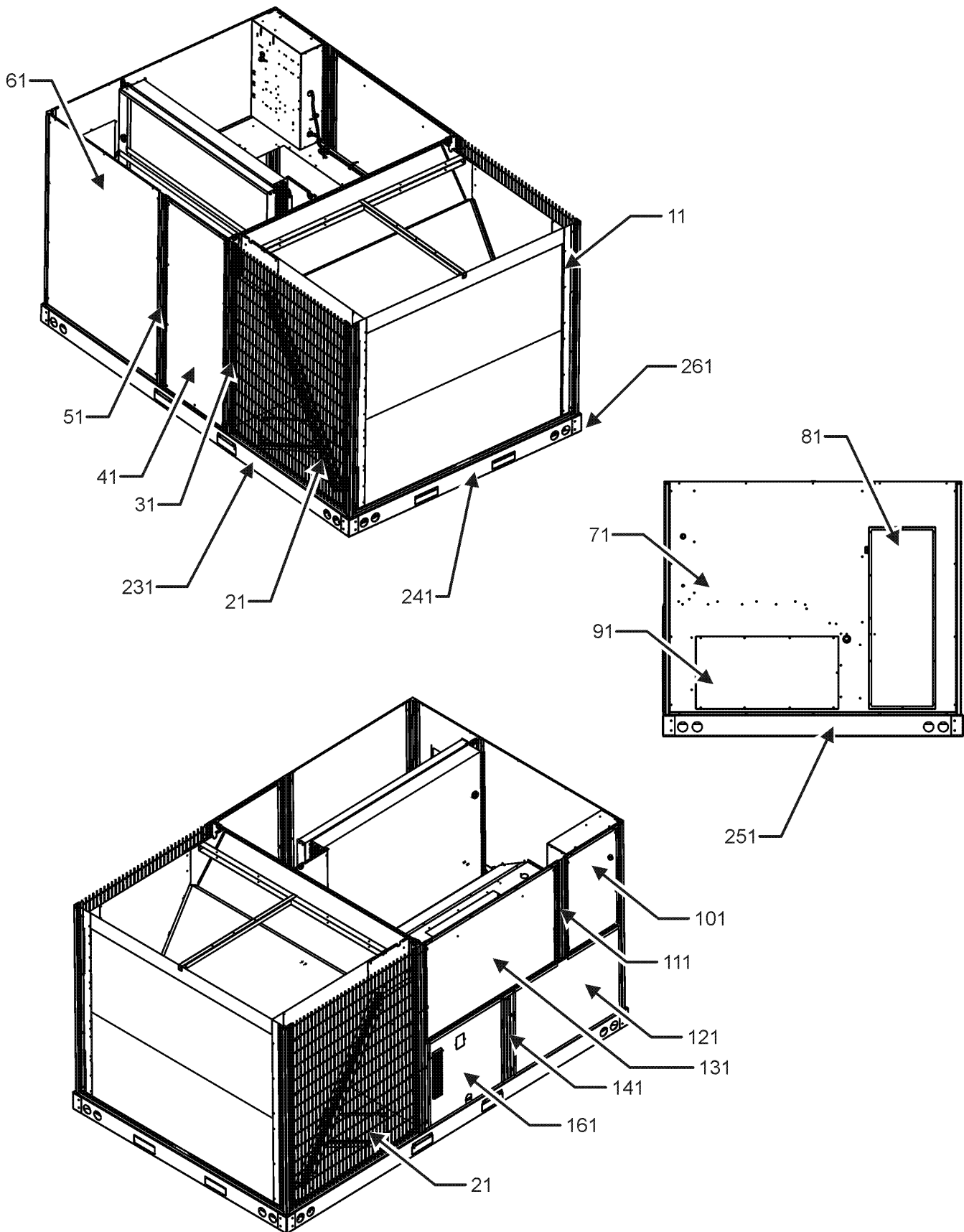

Cabinet Assembly

| Ref. Part No: No: | Description: | Ref. Part No: No: | Description: |
|-------------------|---|------------------------------------|--------------------|
| Image 1: | | Expanded Model Nomenclature | |
| 11 | 0121L00065RFNG CORNER POST (QTY 3) | M1 | - DCC102XXX3BHDBAB |
| 11 | 0121L01407RFNG CORNER POST (M1) | M2 | - DCC102XXX3BHXXAA |
| 21 | 0121L00511NG LOUVERED SIDE PANEL (QTY 2) | M3 | - DCC102XXX3BHXXAB |
| 31 | 0121L00738RFNG ROLL FORM SIDE POST (M2, M3, M4, M5, M6, M7, M8, M9, M10, M11, M12, M13, M14, M15, M16, M17, M18, M19, M20, M21, M22, M23, M24, M25, M26, M27, M28, M29, M30) | M4 | - DCC102XXX3BJXAAB |
| 31 | 0121L01400RFNG ROLL FORM SIDE POST (M1) | M5 | - DCC102XXX3BXXXAA |
| 41 | 0121L00737NG FILTER DOOR | M6 | - DCC102XXX3BXXXAB |
| 51 | 0121L00739RFNG FILTER DOOR POST (M2, M3, M4, M5, M6, M7, M8, M9, M10, M11, M12, M13, M14, M15, M16, M17, M18, M19, M20, M21, M22, M23, M24, M25, M26, M27, M28, M29, M30) | M7 | - DCC102XXX4BFXAC |
| 51 | 0121L01432RFNG FILTER DOOR POST (M1) | M8 | - DCC102XXX4BHXFAC |
| 61 | 0121L00510NG ECONOMIZER DOOR (M1, M2, M3, M4, M5, M6, M8, M9, M10, M11, M12, M13, M14, M15, M16, M17, M18, M19, M20, M21, M22, M23, M24, M25, M26, M27, M28, M29, M30) | M9 | - DCC102XXX4BHXXAB |
| 71 | 0121L01364NG DUCT PANEL (M5, M6, M7, M12, M13, M14, M15, M16, M17, M18, M19, M20) | M10 | - DCC102XXX4BHXXAC |
| 71 | 0121L01365NG DUCT PANEL (M1, M2, M3, M4, M8, M9, M10, M11, M21, M22, M23, M26, M27, M28, M29, M30) | M11 | - DCC102XXX4BJXBAC |
| 71 | 0121L01366NG DUCT PANEL (M24, M25) | M12 | - DCC102XXX4BXXBAB |
| 81 | 0121L00082NG RETURN DUCT COVER | M13 | - DCC102XXX4BXXBAC |
| 91 | 0121L00099NG SUPPLY DUCT COVER | M14 | - DCC102XXX4BXXXAA |
| 101 | 0121L00974NG CONTROL DOOR | M15 | - DCC102XXX4BXXXAB |
| 111 | 0121L02474RFNG POST, CNTRL BOX, RLLD FRM, PNT (M2, M3, M4, M5, M6, M7, M8, M9, M10, M11, M12, M13, M14, M15, M16, M17, M18, M19, M20, M21, M22, M23, M24, M25, M26, M27, M28, M29, M30) | M16 | - DCC102XXX4BXXXAC |
| 111 | 0121L02476RFNG POST, CNTRL BX, RLLD FORM, PNT (M1) | M17 | - DCC102XXX7BXXXAA |
| 121 | 0121L00767NG ELECTRIC HEAT DOOR | M18 | - DCC102XXX7BXXXAB |
| 131 | 0121L00763NG BLOWER DOOR | M19 | - DCC102XXX7BXXXAC |
| 141 | 0121L00765RFNG BURNER BOX POST | M20 | - DCC1020163BBXXAB |
| 161 | 0121L00828NG BURNER AREA DOOR | M21 | - DCC1020163BHXXAA |
| 231 | 0121L01099RF RAIL, BASE SIDES RF (QTY 2) | M22 | - DCC1020163BHXXAB |
| 241 | 0121L00834RF RAIL-BASE COND END | M23 | - DCC1020163BJXFAB |
| 251 | 0121L00071RF RAIL, BASE DUCT END | M24 | - DCC1020164BXXAAB |
| 261 | 0121G00301 RAIL CORNER BRACKET (QTY 4) | M25 | - DCC1020164BXXAAC |
| NS | 0121L00055 BRACKET-FORK BOARD (QTY 4) | M26 | - DCC1020303BHXFAB |
| NS | 0121L01310 ECONOMIZER COVER (M7) | M27 | - DCC1020303BHXXAB |
| NS | 0141L00006X FORK BOARD (QTY 2) | M28 | - DCC1020303BJXAAB |
| NS | 0164L00009 GASKET-RUBBER, CPOST (QTY 3) | M29 | - DCC1020304BHXBAC |
| NS | 0164L00011 GASKET-RUBBER, SIDE POST (QTY 4) | M30 | - DCC1020304BJXFAC |

Top Panel & Tubing Assembly

IMAGE 1

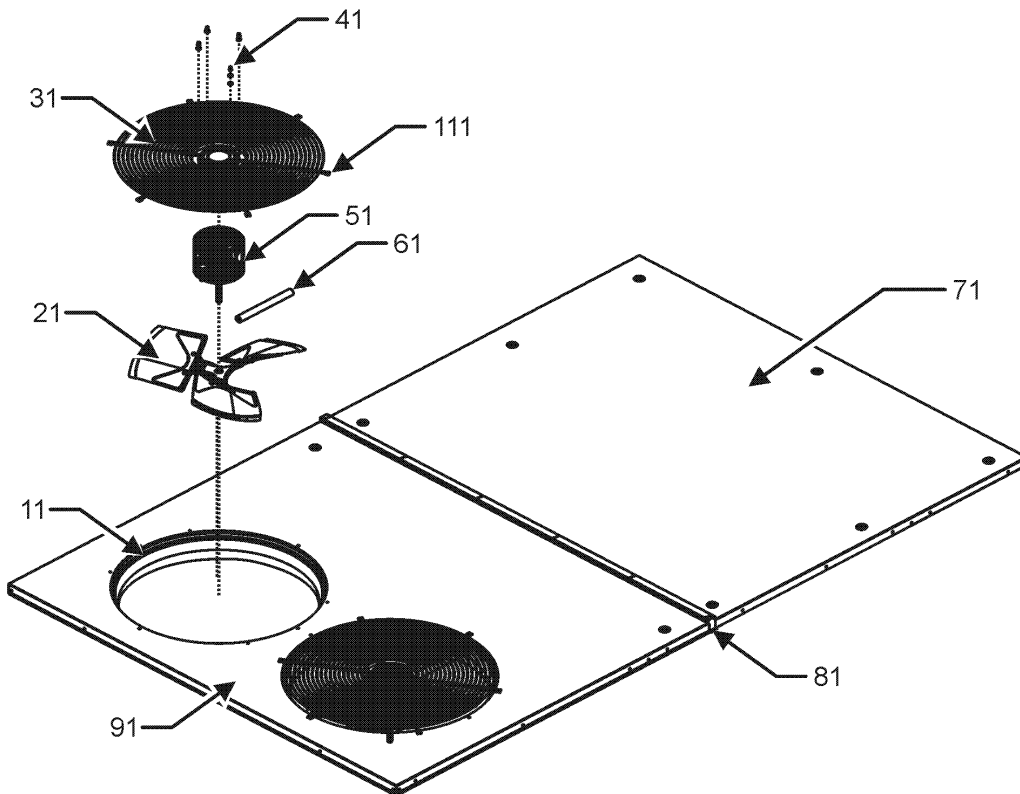
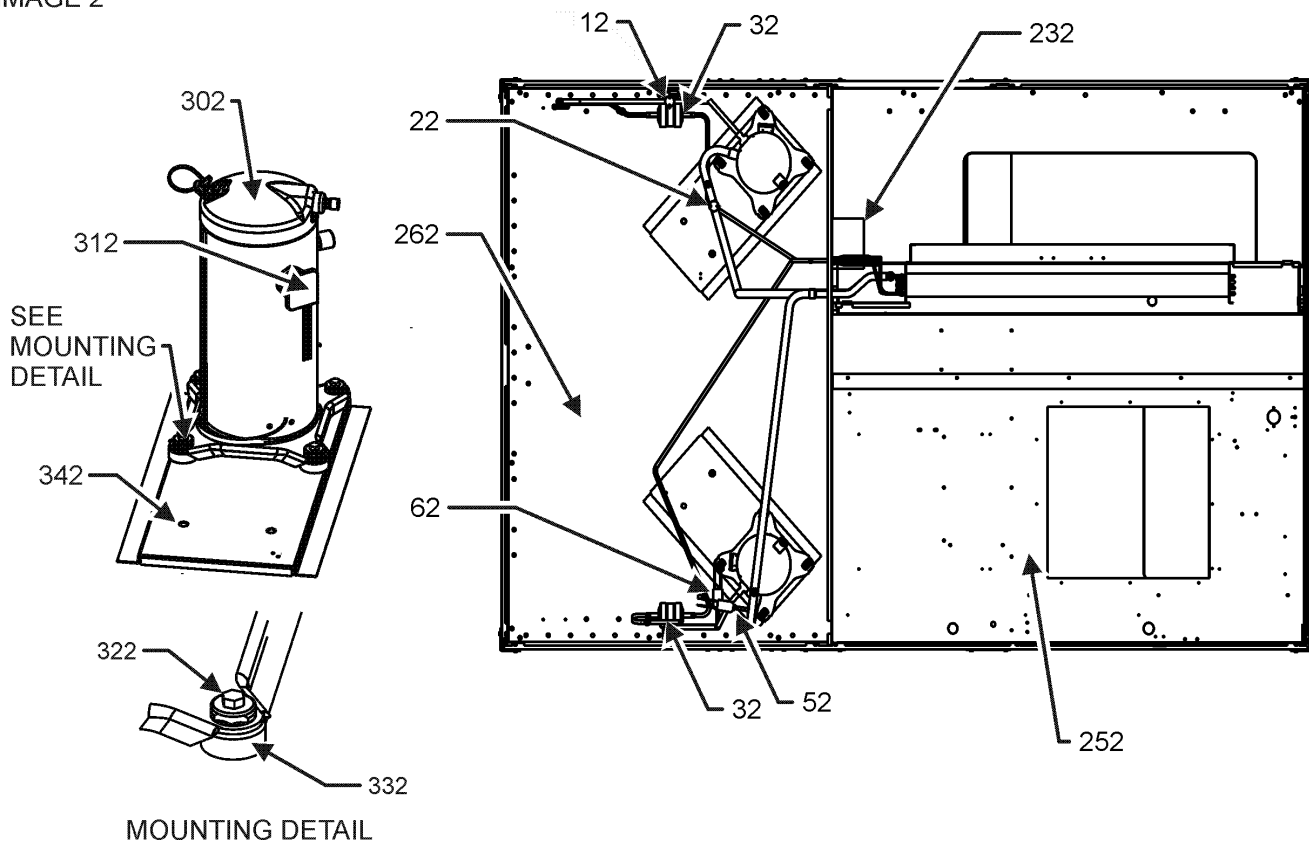

IMAGE 2



Top Panel & Tubing Assembly

| Ref. Part No: No: | Description: | Ref. Part No: No: | Description: |
|-------------------|---|------------------------------------|------------------------------------|
| Image 1: | | Image 2: | |
| 11 | 0161L00000 VENTURI RING 22" (QTY 2) | NS | 0163M00175 CAP WITH O-RING (QTY 4) |
| 21 | 0150G00001 FAN BLADE (QTY 2) | Expanded Model Nomenclature | |
| 31 | 0152G00003 FAN GRILLE (M14, M17) | M1 - | DCC102XXX3BHDBAB |
| 31 | 0152G00000 FAN GRILLE, RAISED (M1, M2, M3, M4, M5, M6, M7, M8, M9, M10, M11, M12, M13, M15, M16, M18, M19, M20, M21, M22, M23, M24, M25, M26, M27, M28, M29, M30) | M2 - | DCC102XXX3BHXXAA |
| 41 | 0163M00006P ACORN NUT 5/16 HEX BLACK (QTY 8) | M3 - | DCC102XXX3BHXXAB |
| 51 | B13400269 COND MOTOR 380/460 50/60 CYCLE (M14) | M4 - | DCC102XXX3BJXAAB |
| 51 | 0131M00432 COND MOTOR 380/460/50/60 CYCLE (M7, M8, M9, M10, M11, M12, M13, M15, M16, M24, M25, M29, M30) | M5 - | DCC102XXX3BXXXAA |
| 51 | 0131M00098 COND MOTOR 575V (M17) | M6 - | DCC102XXX3BXXXAB |
| 51 | 0131M00431 COND MOTOR 575V (M18, M19) | M7 - | DCC102XXX4BFXAC |
| 51 | 0131M00847 MOTOR, 1/4 HP, 1 SP, 6 PL (M1, M2, M3, M4, M5, M6, M20, M21, M22, M23, M26, M27, M28) | M8 - | DCC102XXX4BHXFAC |
| 61 | 0163M00386 CONDUIT-FLEXIBLE (QTY 2) | M9 - | DCC102XXX4BHXXAB |
| 71 | 0121L00497NG TOP INDOOR | M10 - | DCC102XXX4BHXXAC |
| 81 | 20455902 SPLICE GASKET .50 X .25 (QTY 5) | M11 - | DCC102XXX4BJXBAC |
| 91 | 0121L01105NG TOP OUTDOOR | M12 - | DCC102XXX4BXXBAB |
| NS | 0259L00025 COND MOTOR HARNESS 230V (M1, M2, M3, M4, M5, M6, M17, M18, M19, M20, M21, M22, M23, M26, M27, M28) | M13 - | DCC102XXX4BXXBAC |
| NS | 0259L00027 COND MOTOR HARNESS 230V (M1, M2, M3, M4, M5, M6, M17, M18, M19, M20, M21, M22, M23, M26, M27, M28) | M14 - | DCC102XXX4BXXXAA |
| NS | 0259L00026 COND MOTOR HARNESS 460V (M7, M8, M9, M10, M11, M12, M13, M14, M15, M16, M24, M25, M29, M30) | M15 - | DCC102XXX4BXXXAB |
| NS | 0259L00028 COND MOTOR HARNESS 460V (M7, M8, M9, M10, M11, M12, M13, M14, M15, M16, M24, M25, M29, M30) | M16 - | DCC102XXX4BXXXAC |
| NS | 0163M00097 SCREW #10X3/4", BLACK (QTY 8) | M17 - | DCC102XXX7BXXXAA |
| NS | 0163M00005P WASHER, BLACK (.50 OD .218ID) (QTY 8) | M18 - | DCC102XXX7BXXXAB |
| Image 2: | | M19 - | DCC102XXX7BXXXAC |
| 12 | 0130M00031 CUT-OUT SWITCH, HIGH PRESSURE | M20 - | DCC1020163BBXXAB |
| 22 | 0130L00003 CUT-OUT SWITCH, LOW PRESSURE | M21 - | DCC1020163BHXXAA |
| 32 | B1219204 BI-FLOW FILTER DRIER (QTY 2) | M22 - | DCC1020163BHXXAB |
| 52 | 0130L00002 CUT-OUT SWITCH, LOW PRESSURE (M1, M2, M3, M4, M6, M7, M8, M9, M10, M11, M13, M14, M16, M19, M20, M22, M23, M25, M26, M27, M28, M29, M30) | M23 - | DCC1020163BJXFAB |
| 52 | 0130L00003 CUT-OUT SWITCH, LOW PRESSURE (M5, M12, M15, M17, M18, M21, M24) | M24 - | DCC1020164BXXAAB |
| 62 | 0130M00030 CUT-OUT SWITCH, HIGH PRESSURE | M25 - | DCC1020164BXXAAC |
| 232 | 0121L00359 SHIELD-EVAPORATOR DRIP | M26 - | DCC1020303BHXFAB |
| 252 | 0121L00944 BASE PAN - INDOOR | M27 - | DCC1020303BHXXAB |
| 262 | 0121L02129 BASEPAN, OUTDOOR | M28 - | DCC1020303BJXAAB |
| 302 | ZP44K5ETFE130 COMPRESSOR 44000, 200/230/60/3 (M1, M2, M3, M4, M5, M6, M20, M21, M22, M23, M26, M27, M28) | M29 - | DCC1020304BHXBAC |
| 302 | ZP44K5ETFD130 COMPRESSOR 44000, 460/60/3 (M7, M8, M9, M10, M11, M12, M13, M14, M15, M16, M24, M25, M29, M30) | M30 - | DCC1020304BJXFAC |
| 302 | ZP44K5ETFE130 COMPRESSOR 44000, 575/60/3 (M17, M18, M19) | | |
| 312 | 0159L00066 COMPRESSOR SCROLL HARNESS | | |
| 312 | 0159L00067 COMPRESSOR SCROLL HARNESS | | |
| 322 | M0221641 TF SHOULDER SCREW (QTY 8) | | |
| 332 | B1339533 COMPRESSOR GROMMET (QTY 8) | | |
| 342 | 0121L02128 MOUNTING PLATE, COMP (QTY 2) | | |
| NS | B1373315 ACCESS FITTING (QTY 4) | | |

Partition, Evaporator & Condenser Assy

CONDENSER COIL ASSEMBLY

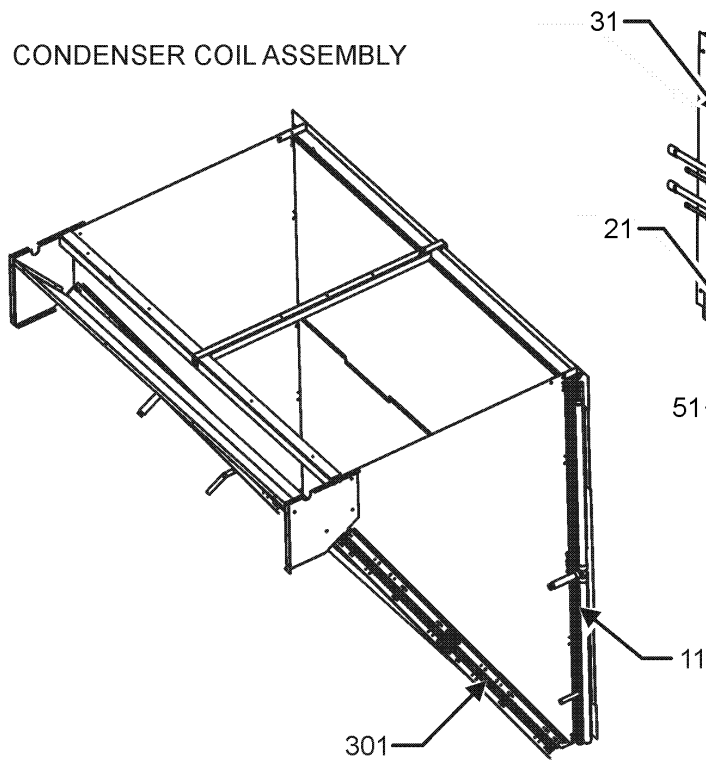

EVAPORATOR ASSEMBLY

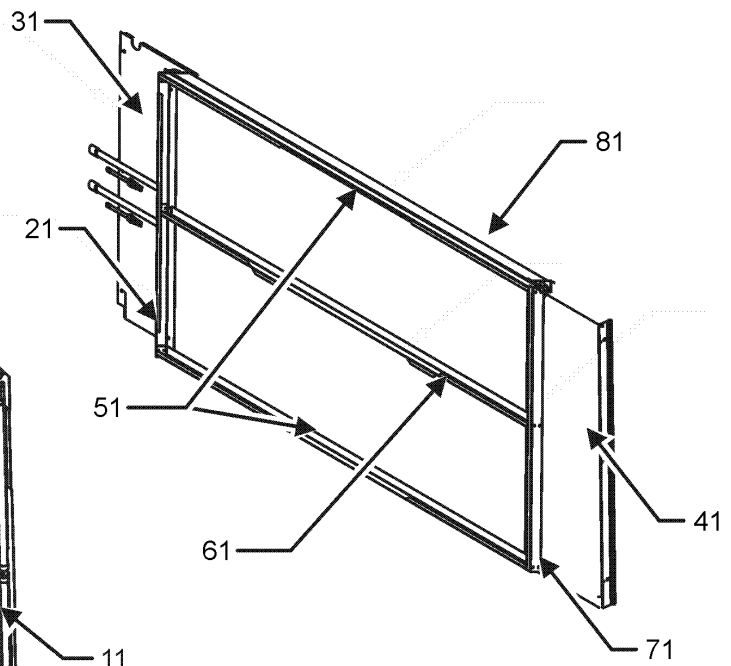

PARTITION PANEL ASSEMBLY

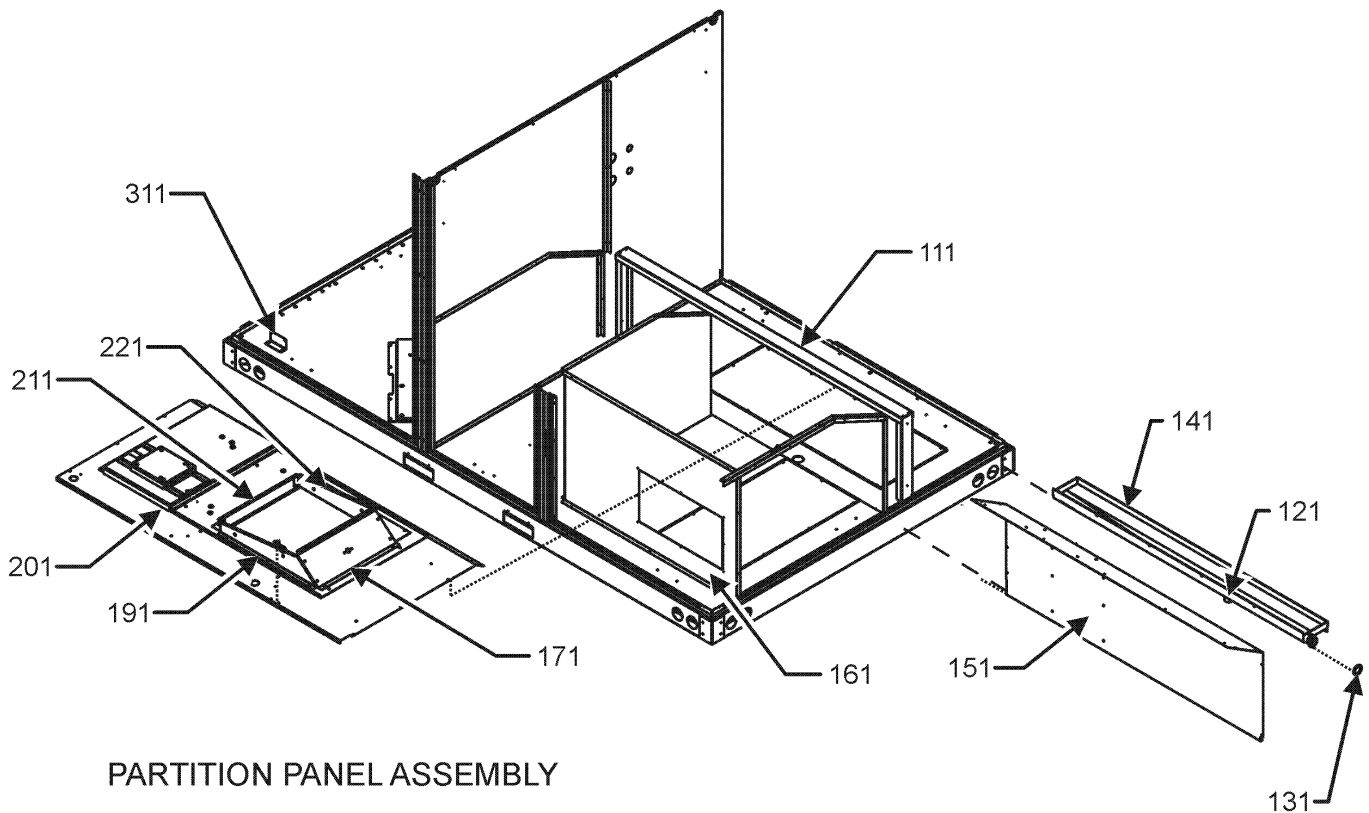

Partition, Evaporator & Condenser Assy

| Ref. Part No: | Description: | Ref. Part No: | Description: |
|-----------------|--------------|---|--|
| Image 1: | | Expanded Model Nomenclature | |
| 11 | 0201L00209 | COND COIL ASSY, 5MM (M1, M3, M4, M6, M7, M8, M10, M11, M13, M16, M19, M20, M22, M23, M25, M26, M27, M28, M29, M30) | M1 - DCC102XXX3BHDBAB M2 - DCC102XXX3BHXXAA M3 - DCC102XXX3BHXXAB M4 - DCC102XXX3BJXAAB M5 - DCC102XXX3BXXXAA M6 - DCC102XXX3BXXXAB M7 - DCC102XXX4BFXAC M8 - DCC102XXX4BHXFAC M9 - DCC102XXX4BHXXAB M10 - DCC102XXX4BHXXAC M11 - DCC102XXX4BJXBAC M12 - DCC102XXX4BXXBAB M13 - DCC102XXX4BXXBAC M14 - DCC102XXX4BXXXAA M15 - DCC102XXX4BXXXAB M16 - DCC102XXX4BXXXAC M17 - DCC102XXX7BXXXAA M18 - DCC102XXX7BXXXAB M19 - DCC102XXX7BXXXAC M20 - DCC1020163BBXXAB M21 - DCC1020163BHXXAA M22 - DCC1020163BHXXAB M23 - DCC1020163BJXFAB M24 - DCC1020164BXXAAB M25 - DCC1020164BXXAAC M26 - DCC1020303BHXFAB M27 - DCC1020303BHXXAB M28 - DCC1020303BJXAAB M29 - DCC1020304BHXBAC M30 - DCC1020304BJXFAC |
| 11 | 0201L00098 | CONDENSER TUBING ASSY C1 COOL (M2, M5, M9, M12, M14, M15, M17, M18, M21, M24) | |
| 21 | 0121L00357 | FILTER ANGLE-VERTICAL (RETURN SIDE) | |
| 31 | 0121L00210 | EVAP EXTENSION-RETURN SIDE | |
| 41 | 0121L00844 | EVAP EXTENSION-HAIRPIN SIDE | |
| 51 | 0121L00932 | FILTER ANGLE-HORIZONTAL (QTY 2) | |
| 61 | 0121L01255 | ANGLE-FILTER CENTER | |
| 71 | 0121L00358 | FILTER ANGLE-VERTICAL (HAIRPIN SIDE) | |
| 81 | 0202L00053 | TUBING ASSY, EVAP COIL (M2, M5, M9, M12, M14, M15, M17, M18, M21, M24) | |
| 81 | 0202L00112 | TUBING ASSY, EVAP COIL (M1, M3, M4, M6, M7, M8, M10, M11, M13, M16, M19, M20, M22, M23, M25, M26, M27, M28, M29, M30) | |
| 111 | 0121L00508 | DRAIN PAN SUPPORT | |
| 121 | 0163L00071 | PLUG, DRAIN | |
| 131 | 0154L00009 | DRAIN PAN GASKET | |
| 141 | 0161L00002 | DRAIN PAN | |
| 151 | 0121L00374 | DECK SIDE CHANNEL | |
| 161 | 0121L00365 | ELECTRIC HEAT PANEL (M1, M2, M3, M4, M5, M6, M7, M8, M9, M10, M11, M12, M13, M15, M16, M17, M18, M19, M20, M21, M22, M23, M24, M25, M26, M27, M28, M29, M30) | |
| 161 | 0121L00366 | ELECTRIC HEAT PANEL (M14) | |
| 171 | 0121L00090 | BLOWER TRANSITION, RH END | |
| 191 | 0121L00092 | BLOWER TRANSITION, FRONT | |
| 201 | 0121L02500 | DECK-BLOWER (M14) | |
| 211 | 0121L00097 | BLOWER TRANSITION, LH END | |
| 221 | 0121L00145 | BLOWER TRANSITION, BACK | |
| 301 | 0201L00210 | COND COIL ASSY, 5MM (M1, M3, M4, M6, M7, M8, M10, M11, M13, M16, M19, M20, M22, M23, M25, M26, M27, M28, M29, M30) | |
| 301 | 0201L00102 | CONDENSER ASSY C2 (M2, M5, M9, M12, M14, M15, M17, M18, M21, M24) | |
| 311 | 0121L00513 | BRACE-CONDENSER (QTY 2) | |
| NS | 0160L00174 | AIR FILTER 16 X 20 X 2 (M1, M2, M3, M4, M5, M6, M7, M8, M9, M10, M11, M12, M13, M15, M16, M17, M18, M19, M20, M21, M22, M23, M24, M25, M26, M27, M28, M29, M30) | |
| NS | B1369608 | AIR FILTER 20 X 16 X 2 (M14) | |
| NS | 0121L01398 | DECK, SUPPORT BLOWER (M1) | |
| NS | 0121L01402 | DECK, SUPPORT CONTROL (M1) | |
| NS | 0121L00321 | SMOKE DETECTOR COVER (QTY 2) | |

Belt Drive Blower Assembly

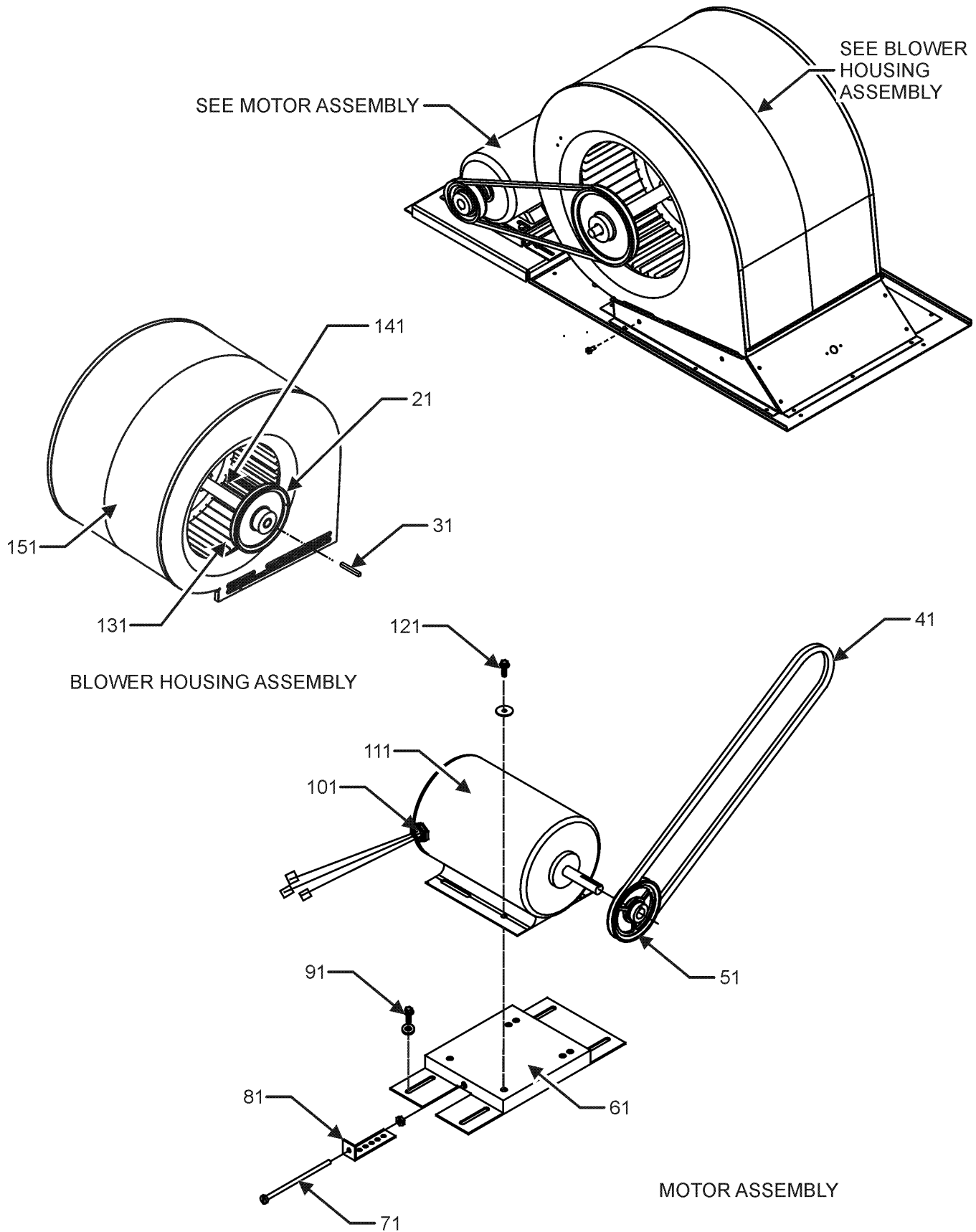

Belt Drive Blower Assembly

| Ref. Part No: | Part No: | Description: | Ref. Part No: | Part No: | Description: |
|---------------|----------|--------------|---------------|----------|--------------|
|---------------|----------|--------------|---------------|----------|--------------|

Image 1:

| | | |
|-----|------------|--|
| 21 | 0163L00134 | SHEAVE, FIXED AK74H |
| 31 | B1398604 | STEEL KEY (000158812) 2.0" |
| 41 | 0164L00000 | NOTCHED FAN BELT AX51 |
| 51 | 0163L00012 | VARIABLE PITCH SHEAVE VL40 |
| 61 | 0121L01504 | MOTOR BASE |
| 71 | 0163M00045 | BOLT 1/4-20 X 4" |
| 81 | 3225000F | BELT TIGHTENER ANGLE |
| 91 | B1446707 | SCREW 5/16-18 X 1" (QTY 4) |
| 101 | B1393726 | ELECT. CONNECTING BUSHING |
| 111 | B3240006 | BELT DRIVE MOTOR 2 HP (M1, M2, M3, M4, M5, M6, M7, M8, M9, M10, M11, M12, M13, M14, M15, M16, M20, M21, M22, M23, M24, M25, M26, M27, M28, M29, M30) |
| 111 | 0131L00005 | BELT DRIVE MOTOR 2 HP 575 V (M17, M18, M19) |
| 121 | B1393738 | BOLT 1/4-20 X 3/4" (QTY 3) |
| 131 | 03-77429 | BLOWER WHEEL |
| 141 | 04-11525 | BLOWER SHAFT |
| 151 | 04-01525 | BLOWER HOUSING |
| NS | 04-02196 | BEARING & FRAME ASSY |

Expanded Model Nomenclature

| |
|------------------------|
| M1 - DCC102XXX3BHDBAB |
| M2 - DCC102XXX3BHXXAA |
| M3 - DCC102XXX3BHXXAB |
| M4 - DCC102XXX3BJXAAB |
| M5 - DCC102XXX3BXXXAA |
| M6 - DCC102XXX3BXXXAB |
| M7 - DCC102XXX4BFXXAC |
| M8 - DCC102XXX4BHXFAC |
| M9 - DCC102XXX4BHXXAB |
| M10 - DCC102XXX4BHXXAC |
| M11 - DCC102XXX4BJXBAC |
| M12 - DCC102XXX4BXXBAB |
| M13 - DCC102XXX4BXXBAC |
| M14 - DCC102XXX4BXXXAA |
| M15 - DCC102XXX4BXXXAB |
| M16 - DCC102XXX4BXXXAC |
| M17 - DCC102XXX7BXXXAA |
| M18 - DCC102XXX7BXXXAB |
| M19 - DCC102XXX7BXXXAC |
| M20 - DCC1020163BBXXAB |
| M21 - DCC1020163BHXXAA |
| M22 - DCC1020163BHXXAB |
| M23 - DCC1020163BJXFAB |
| M24 - DCC1020164BXXAAB |
| M25 - DCC1020164BXXAAC |
| M26 - DCC1020303BHXFAB |
| M27 - DCC1020303BHXXAB |
| M28 - DCC1020303BJXAAB |
| M29 - DCC1020304BHXBAC |
| M30 - DCC1020304BJXFAC |

Control Box Assembly

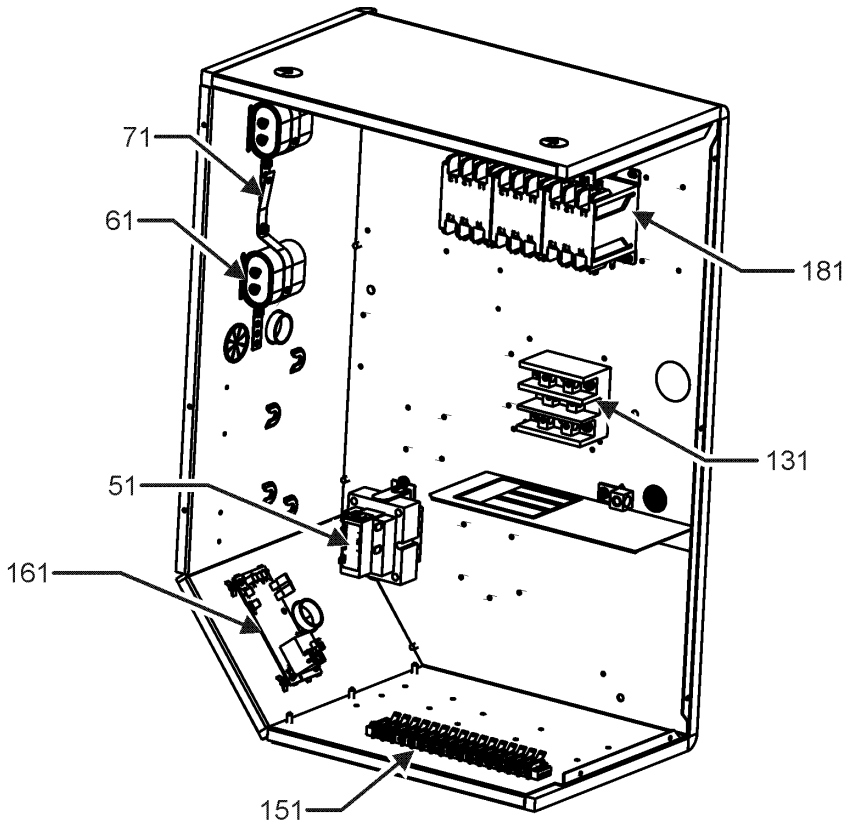

CONTROL BOX
FOR MODELS
WITH DDC CONTROL

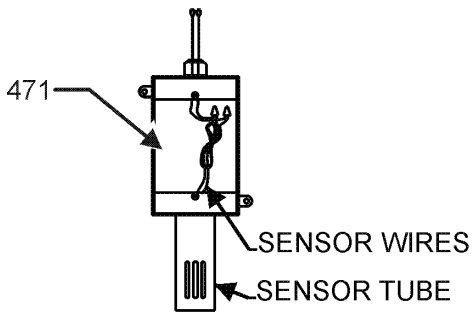
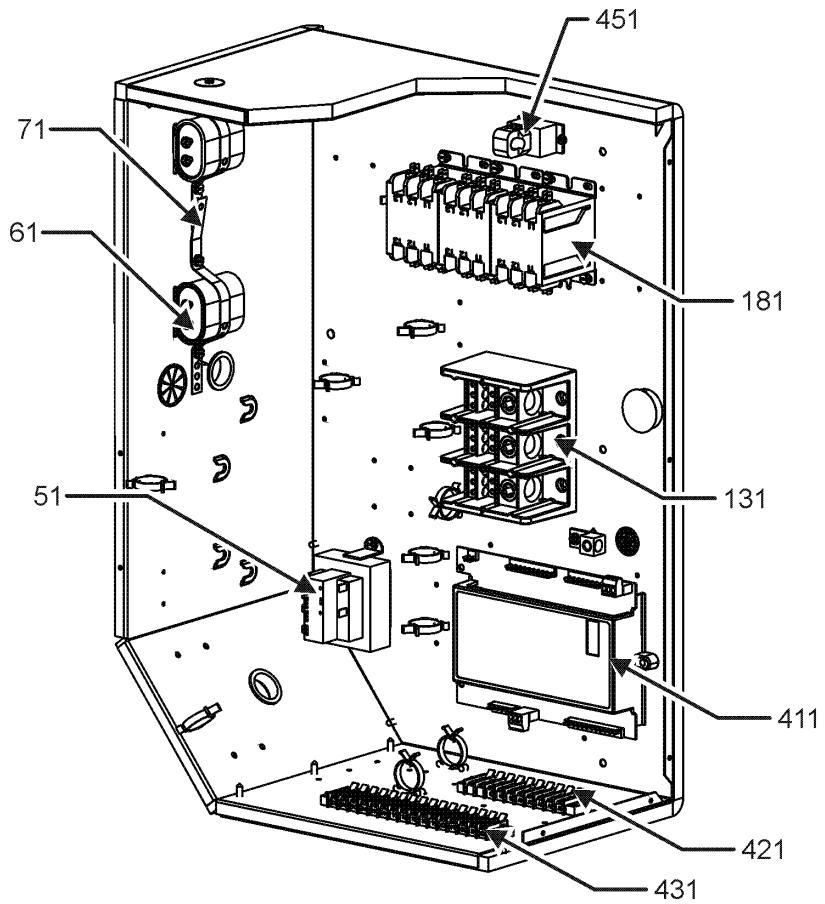

FRONT VIEW

Control Box Assembly

| Ref. Part No: | No: | Description: | Ref. Part No: | No: | Description: |
|-----------------|----------------|---|------------------------------------|------------------|--------------|
| Image 1: | | | Expanded Model Nomenclature | | |
| 51 | 0130M00144 | TRANSFORMER (M1, M2, M3, M4, M5, M6, M20, M21, M22, M23, M26, M27, M28) | M1 - | DCC102XXX3BHDBAB | |
| 51 | 0130M00145 | TRANSFORMER 480V to 24V, 75VA (M7, M8, M9, M10, M11, M12, M13, M14, M15, M16, M24, M25, M29, M30) | M2 - | DCC102XXX3BHXXAA | |
| 51 | 0130M00148 | TRANSFORMER 575V to 24V, 75VA (M17, M18, M19) | M3 - | DCC102XXX3BHXXAB | |
| 61 | CAP030000440LA | CAPACITOR 3/440V (M18, M19) | M4 - | DCC102XXX3BJXAAB | |
| 61 | CAP050000370LA | CAPACITOR 5/370V (M1, M2, M3, M4, M5, M6, M14, M17, M20, M21, M22, M23, M26, M27, M28) | M5 - | DCC102XXX3BXXXAA | |
| 61 | CAP075000370LA | CAPACITOR 7.5/370V (M7, M8, M9, M10, M11, M12, M13, M15, M16, M24, M25, M29, M30) | M6 - | DCC102XXX3BXXXAB | |
| 71 | 20520901 | CAPACITOR STRAP (QTY 2) | M7 - | DCC102XXX4BFXXAC | |
| 131 | 0130M00042 | BLOCK, POWER | M8 - | DCC102XXX4BHXFAC | |
| 151 | 0130M00038 | TERMINAL BOARD | M9 - | DCC102XXX4BHXXAB | |
| 161 | PCBFM103 | ELECTRONIC BLOWER TIME DELAY | M10 - | DCC102XXX4BHXXAC | |
| 181 | CONT3P025024V | CONTACTOR 25 AMP, 3P, 24V (QTY 3) | M11 - | DCC102XXX4BJXBAC | |
| 411 | PCBCG100 | DDC Controller (M7, M20) | M12 - | DCC102XXX4BXXBAB | |
| 421 | 0130M00274 | TERMINAL BOARD (M7, M20) | M13 - | DCC102XXX4BXXBAC | |
| 431 | 0130M00275 | TERMINAL BOARD (M7, M20) | M14 - | DCC102XXX4BXXXAA | |
| 451 | 0259L00368 | CURRENT SWITCH WITH TERMS (M7, M20) | M15 - | DCC102XXX4BXXXAB | |
| 471 | 0130L00108 | OD Air Temp Sensor (M7, M20) | M16 - | DCC102XXX4BXXXAC | |
| NS | 0130L00112 | Duct Temp Sensor (M7, M20) | M17 - | DCC102XXX7BXXXAA | |
| NS | 0259L00165 | ECONOMIZER HARNESS | M18 - | DCC102XXX7BXXXAB | |
| NS | 0259L00401 | HARN, BINARY INPUT, DDC (M7, M20) | M19 - | DCC102XXX7BXXXAC | |
| NS | 0259L00382 | HARN, CNTL PWR, DDC (M7, M20) | M20 - | DCC1020163BBXXAB | |
| NS | 0259L00385 | HARN, CNTL, HEAT PLUG INTERCON (M7, M20) | M21 - | DCC1020163BHXXAA | |
| NS | 0259L00399 | HARN, PWR XFMR CNTL (M7, M20) | M22 - | DCC1020163BHXXAB | |
| NS | 0259L00408 | HARN, RELAY OUTPUT, DDC (M7, M20) | M23 - | DCC1020163BJXFAB | |
| NS | 0259L00496 | HARNESS, NON POW, CONV, OUT (M4, M8, M23, M25, M26, M28, M30) | M24 - | DCC1020164BXXAAB | |
| NS | 0259L00032 | LCM HARNESS, ELECTRIC HEAT | M25 - | DCC1020164BXXAAC | |
| NS | 0259L00008 | MOTOR HARNESS-BELT DRIVE | M26 - | DCC1020303BHXFAB | |
| NS | 0130L00107 | ROOM SENSOR (M7, M20) | M27 - | DCC1020303BHXXAB | |
| NS | 0259L00502 | WIRE HARNESS | M28 - | DCC1020303BJXAAB | |
| NS | 0259L00503 | WIRE HARNESS (M7, M20) | M29 - | DCC1020304BHXBAC | |
| NS | 0259L00148 | WIRE HARNESS ASSY | M30 - | DCC1020304BJXFAC | |
| NS | 0259L00158 | WIRE HARNESS ASSY | | | |

Accessory Part List

ACCESSORY PARTS LIST

NOTE: NOT ALL OPTIONS AVAILABLE FOR ALL PRODUCTS

1 LOW AMBIENT KITS

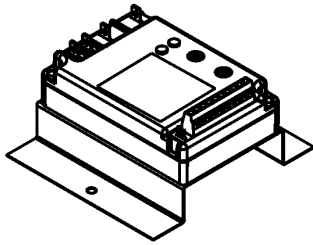

2 GFCI CONVENIENCE OUTLET

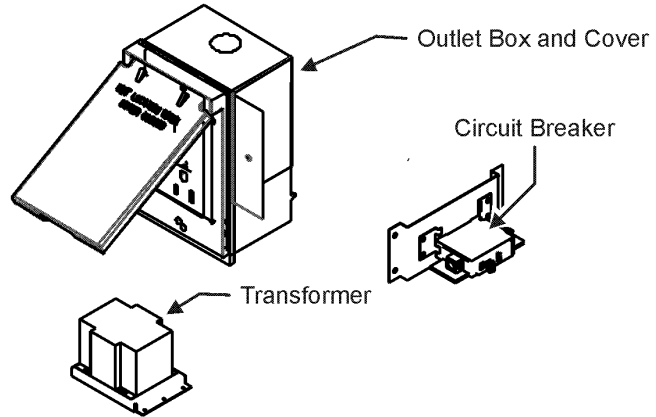

3 DISCONNECT MODULE (NON-FUSED)

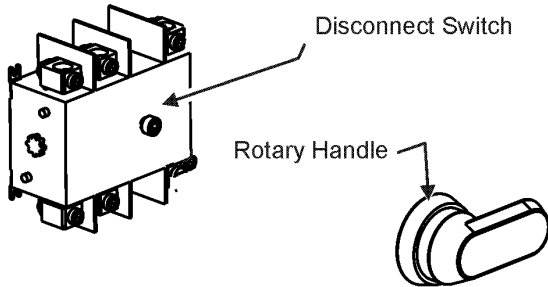

4 SMOKE DETECTORS

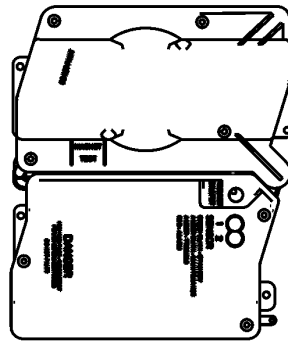

5 DDC CONTROL

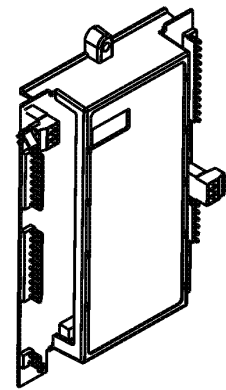

6 HINGED DOOR ASSEMBLIES

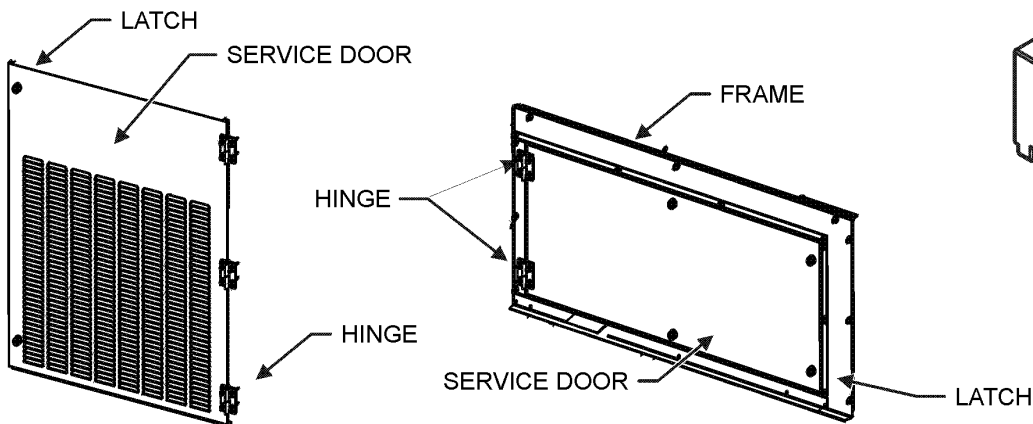

7 PHASE MONITOR

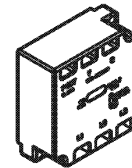

Accessory Part List

| Ref. Part No: No: | Description: | Ref. Part No: No: | Description: |
|-------------------|--|------------------------------------|--------------|
| Image 1: | | Expanded Model Nomenclature | |
| NS EHK3-16 | 15 KW 208-230/3 ELECTRIC HEAT (M20, M21, M22, M23) | M1 - DCC102XXX3BHDBAB | |
| NS EHK4-16 | 15 KW 460/3 ELECTRIC HEAT (M24, M25) | M2 - DCC102XXX3BHXXAA | |
| NS 1036610B | 7.5-12.5 TON DFLOW ECONOMIZER (M4, M11, M23, M28, M30) | M3 - DCC102XXX3BHXXAB | |
| NS 10366D10B | 7.5-12.5T DFLOW ECON, DDC (M7) | M4 - DCC102XXX3BJXAAB | |
| NS 0121L00316 | BRACKET-CONV OUTLET MOUNT (M1, M4, M8, M11, M12, M13, M23, M25, M26, M28, M29, M30) | M5 - DCC102XXX3BXXXAA | |
| NS 0130M00065 | CIRCUIT BREAKER, CONVENIENCE OUTLET (M1, M11, M12, M13, M29) | M6 - DCC102XXX3BXXXAB | |
| NS 0121L00973NG | DISCONNECT SWITCH COVER (M1, M2, M3, M4, M8, M9, M10, M11, M21, M22, M23, M26, M27, M28, M29, M30) | M7 - DCC102XXX4BFXAC | |
| NS 0121L01397NG | DOOR FRAME, BLOWER (M1) | M8 - DCC102XXX4BHXFAC | |
| NS 0121L01406NG | DOOR FRAME, CONTROL (M1) | M9 - DCC102XXX4BHXXAB | |
| NS 0121L02481NG | DOOR, SERVICE, BACK, BLOWER (M1) | M10 - DCC102XXX4BHXXAC | |
| NS 0121L02480NG | DOOR, SERVICE, FRONT, BLOWER (M1) | M11 - DCC102XXX4BJXBAC | |
| NS EHK3-30 | ELECTRIC HEATER KIT (M26, M27, M28) | M12 - DCC102XXX4BXXBAB | |
| NS EHK4-30 | ELECTRIC HEATER KIT (M29, M30) | M13 - DCC102XXX4BXXBAC | |
| NS 0130L00012 | GANG BOX-GFCI OUTLET (M1, M4, M8, M11, M12, M13, M23, M25, M26, M28, M29, M30) | M14 - DCC102XXX4BXXXAA | |
| NS 0130L00039 | HANDLE, ROTARY (M1, M2, M3, M4, M8, M9, M10, M11, M21, M22, M23, M26, M27, M28, M29, M30) | M15 - DCC102XXX4BXXXAB | |
| NS 0163M00307 | HINGE, LEFT HAND (M1) | M16 - DCC102XXX4BXXXAC | |
| NS 0163M00308 | HINGE, RIGHT HAND (M1) | M17 - DCC102XXX7BXXXAA | |
| NS 0163M00322 | LATCH (M1) | M18 - DCC102XXX7BXXXAB | |
| NS LAKT03 | LOW AMBIENT KIT (M8, M23, M26, M30) | M19 - DCC102XXX7BXXXAC | |
| NS 0121L02220NG | PNT, DOOR FRAME FILTER (M1) | M20 - DCC1020163BBXXAB | |
| NS 0121L02223NG | PNT, SERVICE DOOR BACK FILTER (M1) | M21 - DCC1020163BHXXAA | |
| NS 0121L02218NG | PNT, SERVICE DOOR FRONT FILTER (M1) | M22 - DCC1020163BHXXAB | |
| NS 0161G00012 | POWER OUTLET BOX (M1, M4, M8, M11, M12, M13, M23, M25, M26, M28, M29, M30) | M23 - DCC1020163BJXFAB | |
| NS 0130L00103 | RECEPTACLE-GFCI OUTLET (M1, M4, M8, M11, M12, M13, M23, M24, M25, M26, M28, M29, M30) | M24 - DCC1020164BXXAAB | |
| NS 0121L01404NG | SERVICE DOOR BACK, CONTROL (M1) | M25 - DCC1020164BXXAAC | |
| NS 0121L01403NG | SERVICE DOOR FRONT, CONTROL (M1) | M26 - DCC1020303BHXFAB | |
| NS 0130L00043 | SHAFT, CUT (M1, M2, M3, M4) | M27 - DCC1020303BHXXAB | |
| NS 0130L00056 | SHAFT, CUT (M8, M9, M10, M11, M26, M27, M28) | M28 - DCC1020303BJXAAB | |
| NS 0130L00057 | SHAFT, CUT (M21, M22, M23, M29, M30) | M29 - DCC1020304BHXBAC | |
| NS 0130L00049 | SHAFT, DISCONNECT (M1, M2, M3, M4, M8, M9, M10, M11, M21, M22, M23, M26, M27, M28, M29, M30) | M30 - DCC1020304BJXFAC | |
| NS 0130L00027 | SWITCH-DISCONNECT 100A (M8, M9, M10, M11, M26, M27, M28) | | |
| NS 0130L00033 | SWITCH-DISCONNECT 200A (M1, M2, M3, M4) | | |
| NS 0130L00046 | SWITCH-DISCONNECT 60A (M21, M22, M23, M29, M30) | | |
| NS 0130M00061 | TRANSFORMER, CONVENIENCE OUTLET (M1, M11, M12, M13, M29) | | |