

# Pipe Rollers & Roller Supports

## B3114 - Pipe Roll with Sockets

**Size Range:** 2" (25mm) thru 30" (750mm) pipe

**Material:** Cast iron and steel axle  
(Non-metallic polyurethane rollers are available)

**Function:** For supporting pipe where expansion may occur due to thermal movement. Double rod design provides support for greater loads.

**Approvals:** Conforms to Federal Specification WW-H-171E & A-A-1192A, Type 42, 2" (50mm) thru 24" (600mm), and Manufacturers Standardization Society ANSI/MSS SP-69 & SP-58, Type 41

**Note:** When pipe line is insulated, total outside diameter of pipe and covering should be used to determine size of hanger; also see B3160 to B3165 on pages 157 thru 162.

**Finish:** Plain. Contact customer service for alternative finishes and materials.

**Order By:** Part number, pipe size and finish

**Note:** Not for continuous cycling applications.

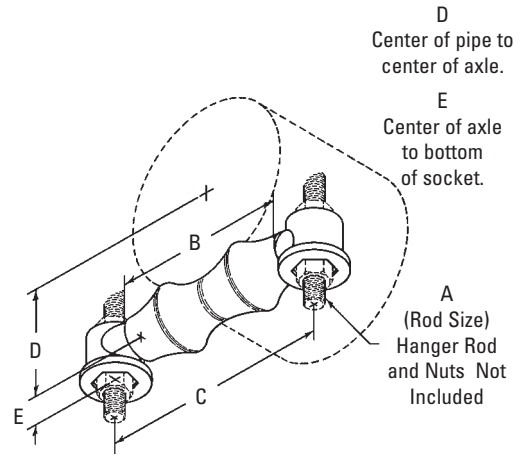

**Notes:** If using D.I. pipe refer to page 307 for sizing. Non-metallic rollers with hot-dip galvanized sockets and stainless steel hardware are available for most sizes (B3114NM-Pipe Size). Contact Eaton Engineering for more information.

Part No.	Pipe Size		Rod Size		B		C		D	
	in.	(mm)	A	in. (mm)	in. (mm)	in. (mm)	in. (mm)	in. (mm)		
B3114-2	2"	(50)	3/8"-16	25/8" (66.7)	41/8" (104.8)	19/16" (39.7)				
B3114-2 1/2	2 1/2"	(65)	1/2"-13	31/8" (79.4)	47/8" (123.8)	17/8" (47.6)				
B3114-3	3"	(80)	1/2"-13	33/4" (95.2)	51/2" (139.7)	23/16" (55.6)				
B3114-3 1/2	3 1/2"	(90)	1/2"-13	41/4" (107.9)	61/8" (155.6)	21/2" (63.5)				
B3114-4	4"	(100)	5/8"-11	43/4" (120.6)	63/4" (171.4)	23/4" (69.8)				
B3114-5	5"	(125)	5/8"-11	513/16" (147.6)	81/16" (204.8)	33/8" (85.7)				
B3114-6	6"	(150)	3/4"-10	67/8" (174.6)	99/16" (242.9)	315/16" (100.0)				
B3114-8	8"	(200)	7/8"-9	87/8" (225.4)	1115/16" (303.2)	51/16" (128.6)				
B3114-10	10"	(250)	7/8"-9	11" (279.4)	141/16" (357.2)	61/4" (158.7)				
B3114-12	12"	(300)	7/8"-9	13" (330.2)	1513/16" (401.6)	73/8" (187.3)				
B3114-14	14"	(350)	1"-8	141/4" (361.9)	173/4" (450.8)	81/4" (209.5)				
B3114-16	16"	(400)	1"-8	161/4" (412.7)	193/4" (501.6)	91/4" (234.9)				
B3114-18	18"	(450)	1"-8	181/4" (463.5)	217/8" (555.6)	103/8" (263.5)				
B3114-20	20"	(500)	1 1/4"-7	201/4" (514.3)	241/4" (615.9)	111/2" (292.1)				
B3114-24	24"	(600)	1 1/2"-6	241/4" (615.9)	287/8" (733.4)	1313/16" (350.8)				
B3114-30	30"	(750)	1 1/2"-6	301/4" (768.3)	351/2" (901.7)	171/4" (438.1)				

Part No.	E		Max. O.D. Covering		Design Load		Approx. Wt./100	
	in.	(mm)	in.	(mm)	Lbs.	(kN)	Lbs.	(kg)
B3114-2	3/4"	(19.0)	33/4"	(82.5)	600	(2.67)	119	(54.0)
B3114-2 1/2	3/4"	(19.0)	33/4"	(95.2)	660	(2.93)	140	(63.5)
B3114-3	3/4"	(19.0)	41/2"	(114.3)	700	(3.11)	158	(71.6)
B3114-3 1/2	3/4"	(19.0)	5"	(127.0)	750	(3.33)	170	(77.1)
B3114-4	3/4"	(19.0)	57/8"	(149.2)	750	(3.33)	188	(85.3)
B3114-5	3/4"	(19.0)	7"	(177.8)	750	(3.33)	246	(111.6)
B3114-6	1 1/8"	(28.6)	81/4"	(209.5)	1070	(4.76)	504	(228.6)
B3114-8	1 1/8"	(28.6)	101/2"	(266.7)	1350	(6.00)	658	(298.4)
B3114-10	1 1/8"	(28.6)	123/4"	(323.8)	1730	(7.69)	849	(385.1)
B3114-12	1 1/8"	(28.6)	143/4"	(374.6)	2400	(10.67)	1200	(544.3)
B3114-14	1 1/2"	(38.1)	161/4"	(412.7)	3130	(13.92)	2289	(1038.3)
B3114-16	1 1/2"	(38.1)	18"	(457.2)	3970	(17.66)	2497	(1132.6)
B3114-18	1 1/2"	(38.1)	201/4"	(514.3)	4200	(18.68)	2899	(1315.0)
B3114-20	1 1/2"	(38.1)	221/2"	(571.5)	4550	(20.24)	3637	(1649.7)
B3114-24	2"	(50.8)	261/2"	(673.1)	6160	(27.40)	5664	(2569.2)
B3114-30	2"	(50.8)	321/2"	(825.5)	7290	(32.42)	9437	(4280.6)

36" (900) available upon request.

All dimensions in charts and on drawings are in inches. Dimensions shown in parentheses are in millimeters unless otherwise specified.