

CHA16-823/953 SERIES

OCTOBER 29, 1993

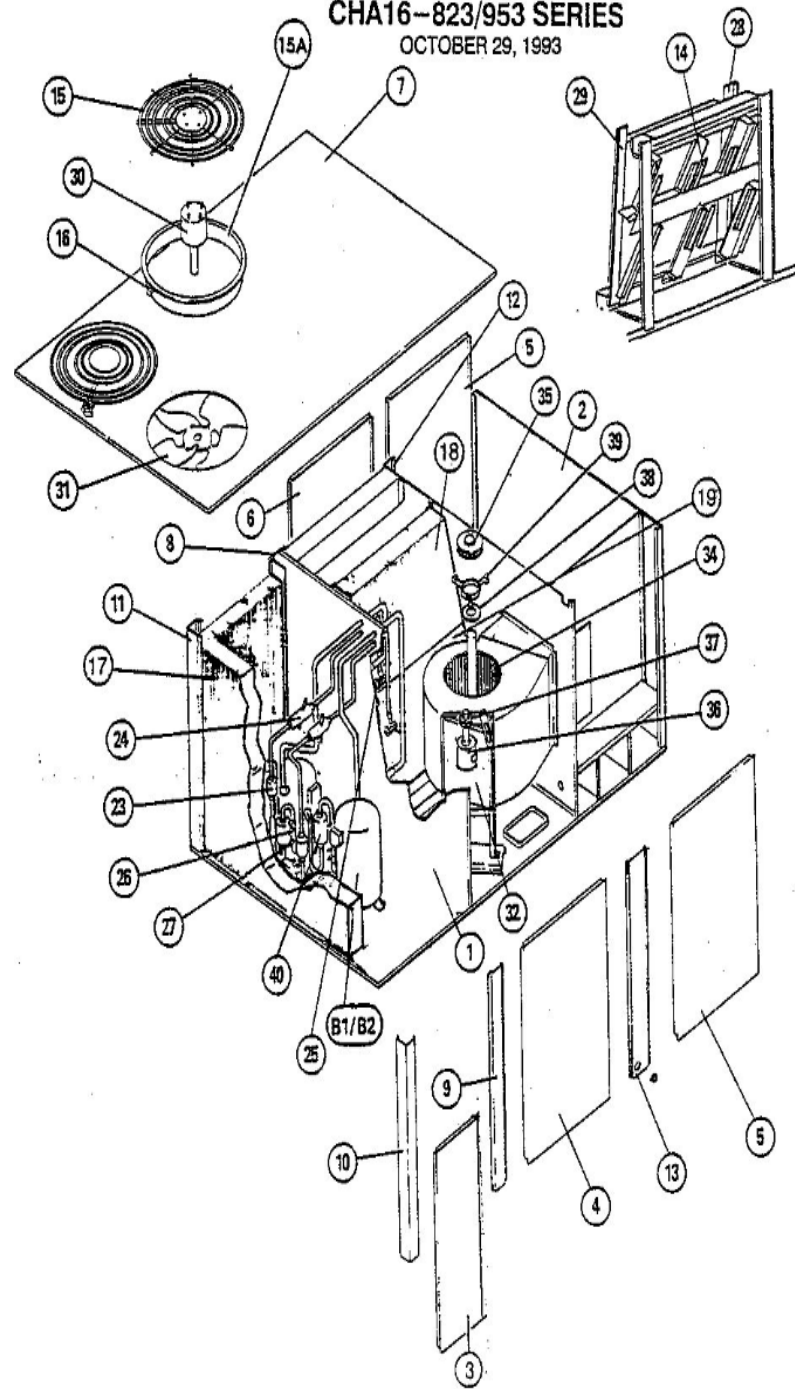

CHA16-953 Control Panel

May 27, 1992

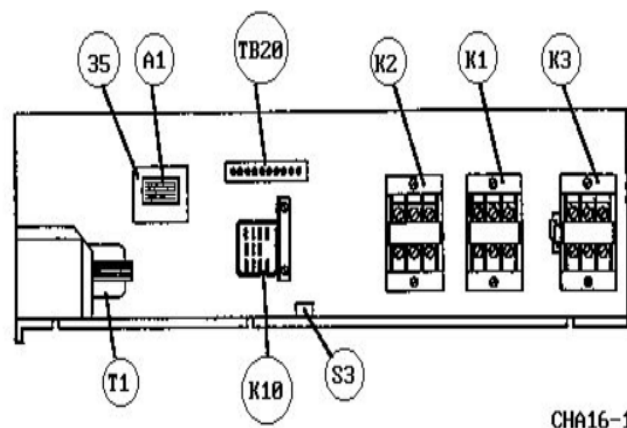

Revision Number - 4

CABINET PARTS

Callout	Name	Quantity	Description
	NUT-CAP Cat #: 85M56 Model/Part #: 100094-01	4	MOTOR
	LEG Cat #: 29W57 Model/Part #: 101262-01	4	BASE
	COVER Cat #: 69J03 Model/Part #: 69J0301	1	SOUND-COMPRESSOR (OPTIONAL)
	PANEL Cat #: 85M95 Model/Part #: LB-107754-28	1	4 LOUVER
	PANEL Cat #: 86M00 Model/Part #: LB-107755-28	1	5 LOUVER
	PANEL Cat #: 86M05 Model/Part #: LB-107756-28	1	6 LOUVER
	PANEL Cat #: 86M15 Model/Part #: LB-107758-28	1	8 LOUVER
	PLATE-PATCH(QUARTZ GRAY)(2.125SUCT OPNG) Cat #: 28W64 Model/Part #: LB-111271G-PP	1	PLATE-PATCH(QUARTZ GRAY)
1	TOP-PARAGON-METAL-MEDIUM Cat #: 55W15 Model/Part #: 603135-01G	1	PANEL - TOP (MEDIUM)
2	GRILLE-DISCHARGE Cat #: 97M69 Model/Part #: 100062-02	1	GRILLE (DISCHARGE)
3	COVER-CONTROL BOX Cat #: 97M72 Model/Part #: LB-108273	1	COVER-CONTROL BOX (MEDIUM)
4	CORNER POST Cat #: 85M75 Model/Part #: LB-107737-28	2	FRONT
5	CORNER POST Cat #: 85M80 Model/Part #: LB-107738-28	1	REAR

CONTROL PANEL PARTS

Callout	Name	Quantity	Description
C1	CAPACITOR-RUN Cat #: 22W80 Model/Part #: 100600-03	1	"10MFD,370VAC"
K1	CONTACTOR Cat #: 95M57 Model/Part #: 100438-03	1	"3PDT,24V"

COOLING PARTS

Callout	Name	Quantity	Description
	RELAY-OVERLOADCOMP-INTERNAL Cat #: Model/Part #:	1	
	CORE-VALVE Cat #: 95M48 Model/Part #: 100210-01	2	CORE - VALVE
	DRIER Cat #: 95M52 Model/Part #: 100214-03	1	LIQUID LINE (FOOTNOTE 1)
	FITTING-PRESS TAP Cat #: 95M47 Model/Part #: 100520-01	2	FITTING - PRESSURE TAP (BRASS)
	HARNESS-COMPRESSOR Cat #: 15M36 Model/Part #: 15M3601	1	MOLDED PLUG- POWER
	HARNESS-COMP Cat #: 49M73 Model/Part #: 49M7301	1	MOLD PLUG FOR 2ND STAGE
	DRIER Cat #: 88K45 Model/Part #: 88K4501	1	SUCTION LINE (OPTIONAL)
	MOUNT PKG-COMP Cat #: 54M63 Model/Part #: LB-106528	1	MOUNT PKG-COMP
10	ASSY-REPAIR PART Cat #: 10M37 Model/Part #: LB-110660AL	1	W/MANIFOLD
11	VALVE-SERVICE Cat #: 10W32 Model/Part #: 100432-01	1	"LIQUID LINE, 3/8""
12	VALVE-BALL SERVICE 7/8 X 7/8 Cat #: 77W34 Model/Part #: 102831-05	1	"SUCTION LINE, 7/8""
13	FAN Cat #: 27W59 Model/Part #: 100017-09	1	"1/2""BORE,22""DIA,4 BLADE, 34 PITCH
B1	COMPRESSOR	1	"2.5 TON,208-

Callout	Name	Quantity	Description
	Cat #: 10H31 Model/Part #: 103137-06		230/60/3,COPE (FOOTNOTE 1)
B4	MOTOR-FAN Cat #: 97M51 Model/Part #: 100483-05	1	"1/4HP, 825 RPM,208-230/60/1"
HR1	HEATER-CRANKCASE Cat #: 93M04 Model/Part #: 100499-01	1	"240 VOLT, 40 WATT"
S4	SWITCH-HI PRESS-AUTO Cat #: 93W01 Model/Part #: 100087-12	1	SWITCH -HI PRESS - AUTO
S40	THERMOSTAT SPST OPEN@70°F CLOSE@50°F 40" Cat #: 95M54 Model/Part #: 100503-01	1	"CC HEATER OPEN 70F, CLOSE 50F"
S87	SWITCH-LO PRESS-AUTO Cat #: 88M98 Model/Part #: 100087-03	1	"IN 90 PSIG, OUT 40 PSIG"

Note:

Note1: Compressor uses POE oil. The filter drier MUST BE replaced at time of compressor change. Please advise customer of this requirement at time of order. (The filter drier is excluded from the Lennox Quality Care Limited Warranty).