

CHA11-1853/2753/3003 SERIES CABINET PARTS
JUNE 20, 1989

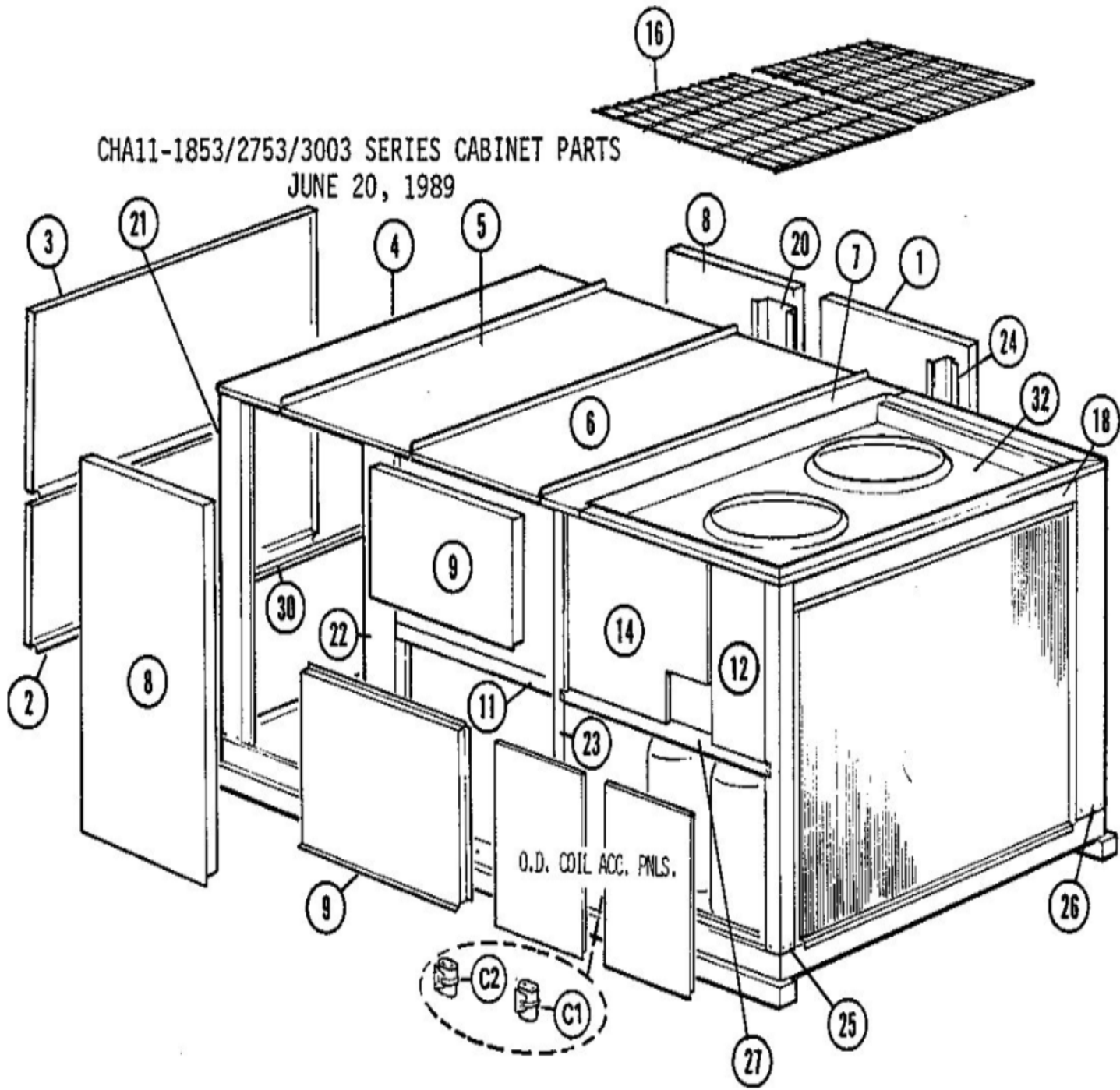

CHA11-1853/2753/3003 SERIES
COOLING SECTION
JUNE 17, 1991

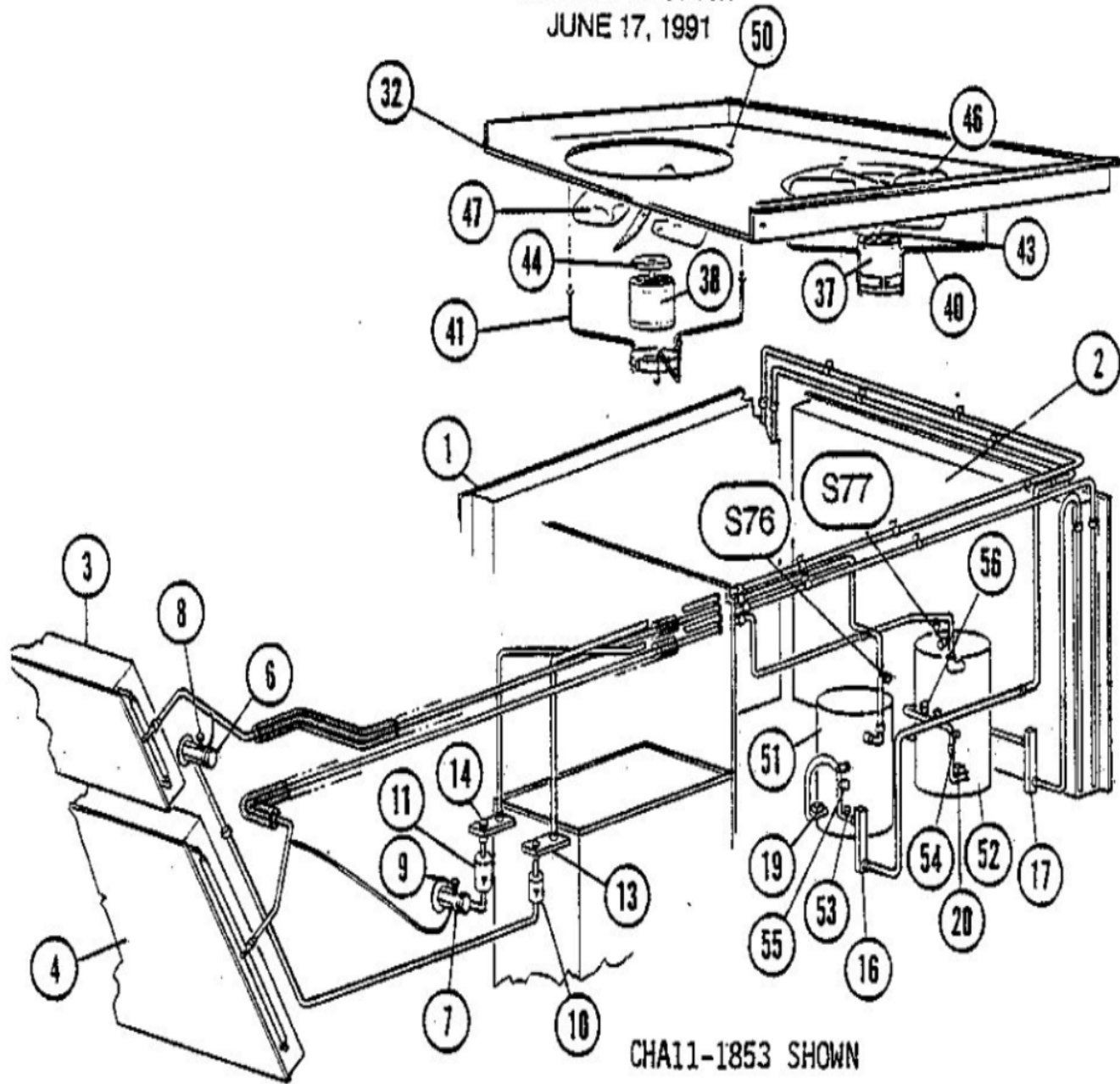

CHA11-1853 SHOWN



CHA11-1853/2753 SERIES
CONTROL PANEL PARTS
(DASH 1 & 2)
JANUARY 26, 1988

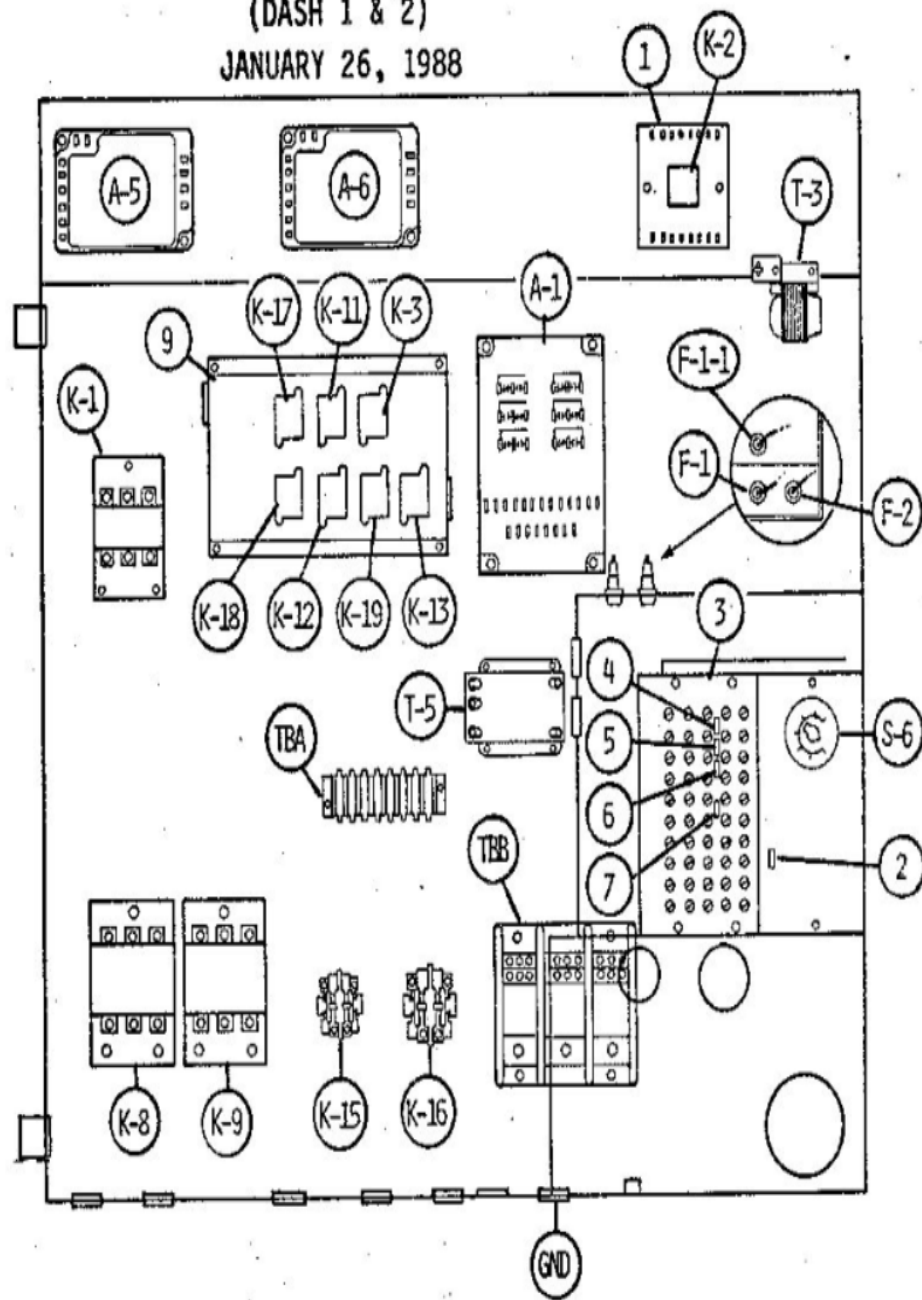

CHA11-1853/2753/3003 SERIES CONTROL PANEL PARTS (DASH 5 ON)

A9
MAY 26, 1992
A10

Standard Units Only
2753/3003

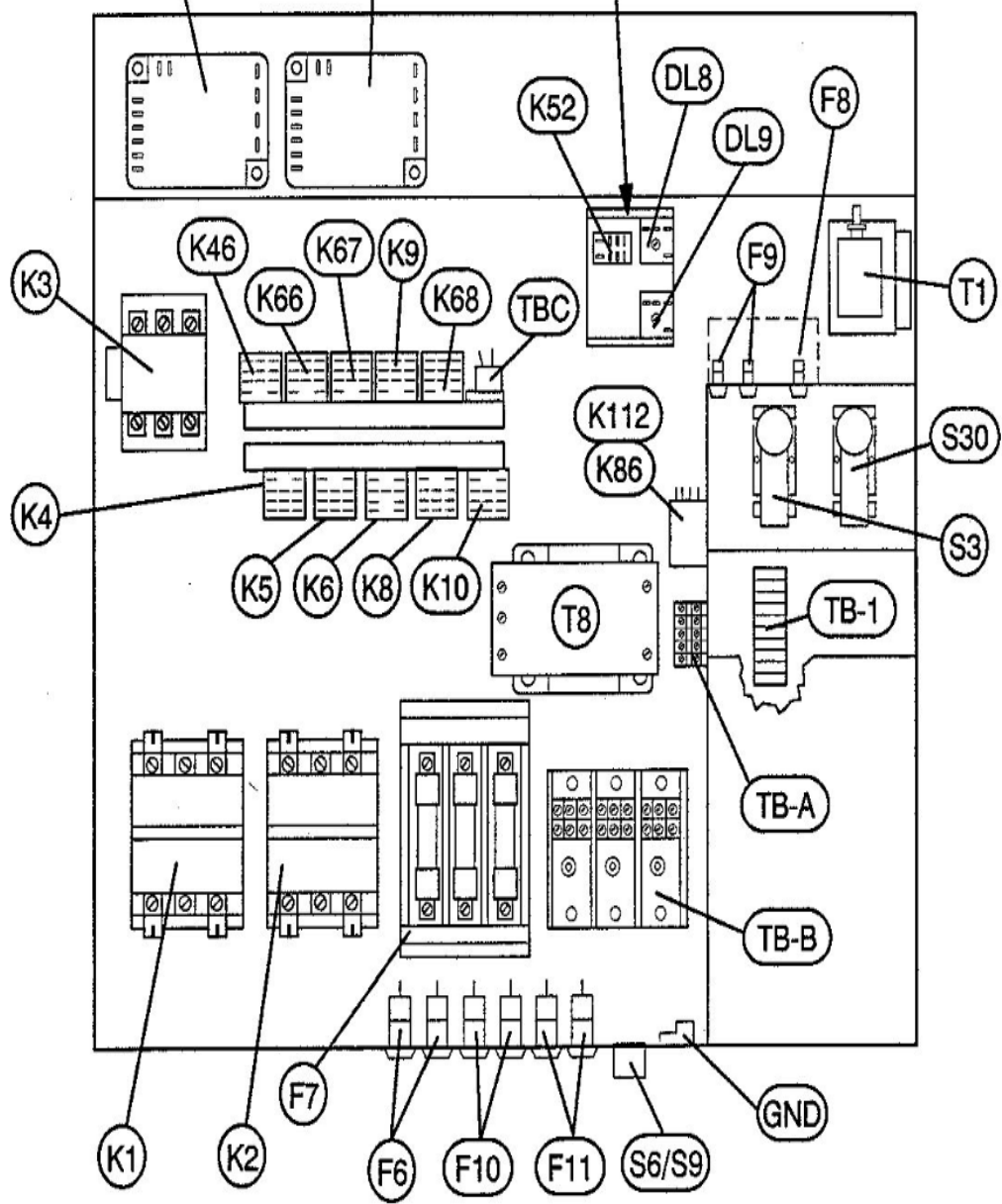

CHA11-1853/2753/3003 SERIES
BLOWER SECTION
JUNE 20, 1989

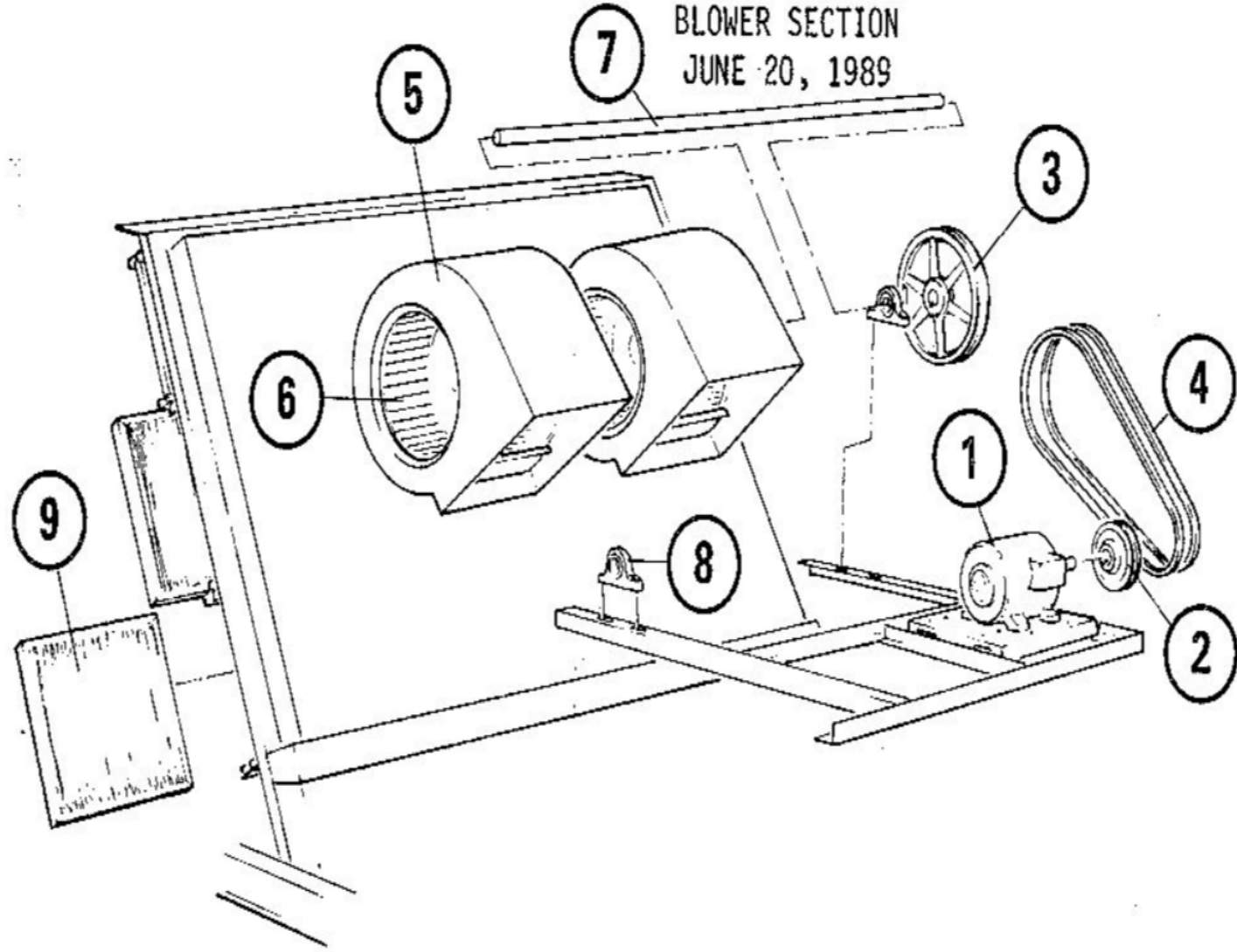

HWC11-185/275 SERIES

MAY 7, 1985

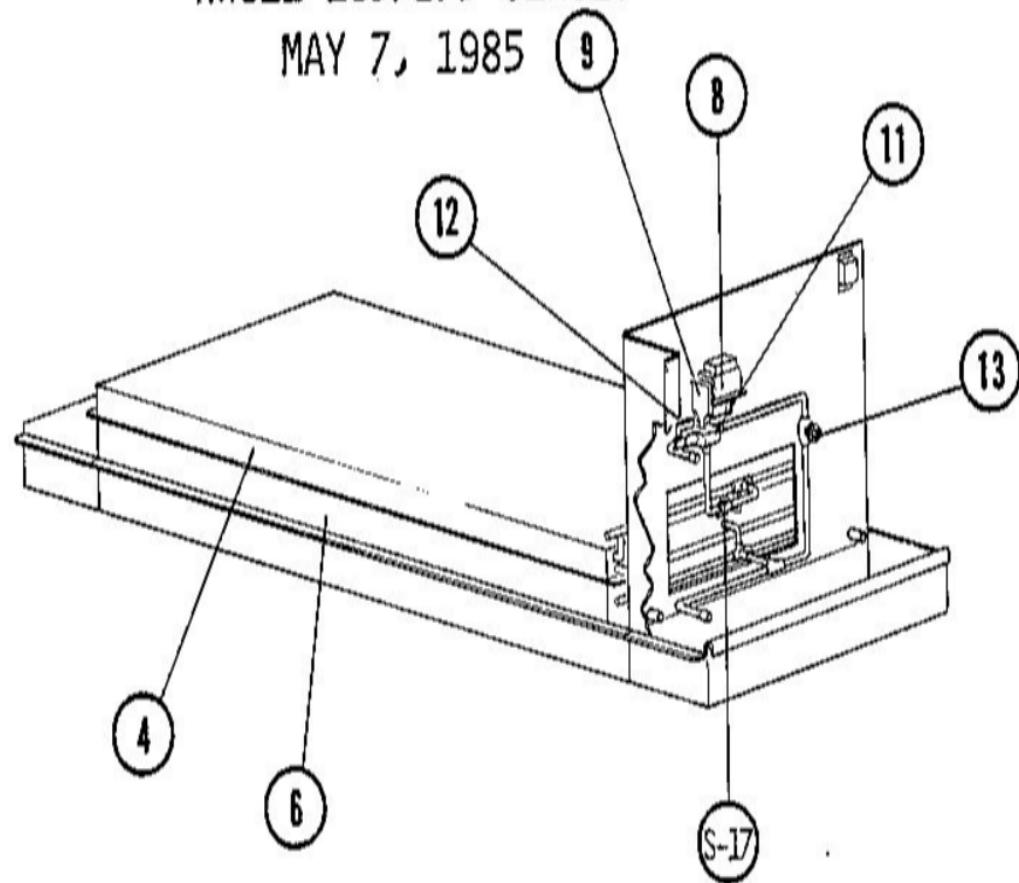

Callout	Name	Quantity	Description
B1	COMPRESSOR Cat #: 21J64 Model/Part #: 10B4101	1	"5TON,208-230/60/3,LEN"
B1	COMPRESSOR Cat #: 25J25 Model/Part #: 33F6401	1	"5TON,575/60/3,LEN"
B1	COMPRESSOR 460/60/3, LENNOX Cat #: 29M24 Model/Part #: 98C8701	1	"5TON,460/60/3,LEN"
B2	MOTOR-FAN Cat #: 41C83 Model/Part #: 76A7601	1	"1/2HP,1075RPM,208-230/60/1"
C1	CAPACITOR-RUN Cat #: 53H14 Model/Part #: 96C5301	1	"25MFD,440VAC(1 PHASE ONLY)"
C1	CAPACITOR-RUN Cat #: 53H15 Model/Part #: 96C5401	1	"30MFD,440VAC(1 PHASE ONLY)"
C2	CAPACITOR-FAN MTR Cat #: 53H06 Model/Part #: 96C4301	1	"15MFD,370VAC"
S4	SWITCH-LO PRESS Cat #: 38509 Model/Part #: P-8-9152	1	"CUTIN 30PSIG,CUTOUT 10PSIG"
T2	TRANSFORMER Cat #: 41C30 Model/Part #: 41C3001	1	"240/480VPRI,120/240VSEC, 3000VA,NO FUSE
T3	TRANSFORMER Cat #: 41C31 Model/Part #: 41C3101	1	"600VPRI,120/240VSEC,3000VA, NO FUSE(CAN

Note:

Note1: WHEN ORDERING--28C4601 MOTOR MUST BE MATCHED WITH 81A4301 CAPACITOR.

Note2: CUT TO SIZE FOR LEFT AND RIGHT GRILLES. Note3: WHEN ORDERING--57A3101
MOTOR MUST BE MATCHED WITH 81A4201 CAPACITOR.