

C2AL SERIES
MARCH 29, 1999

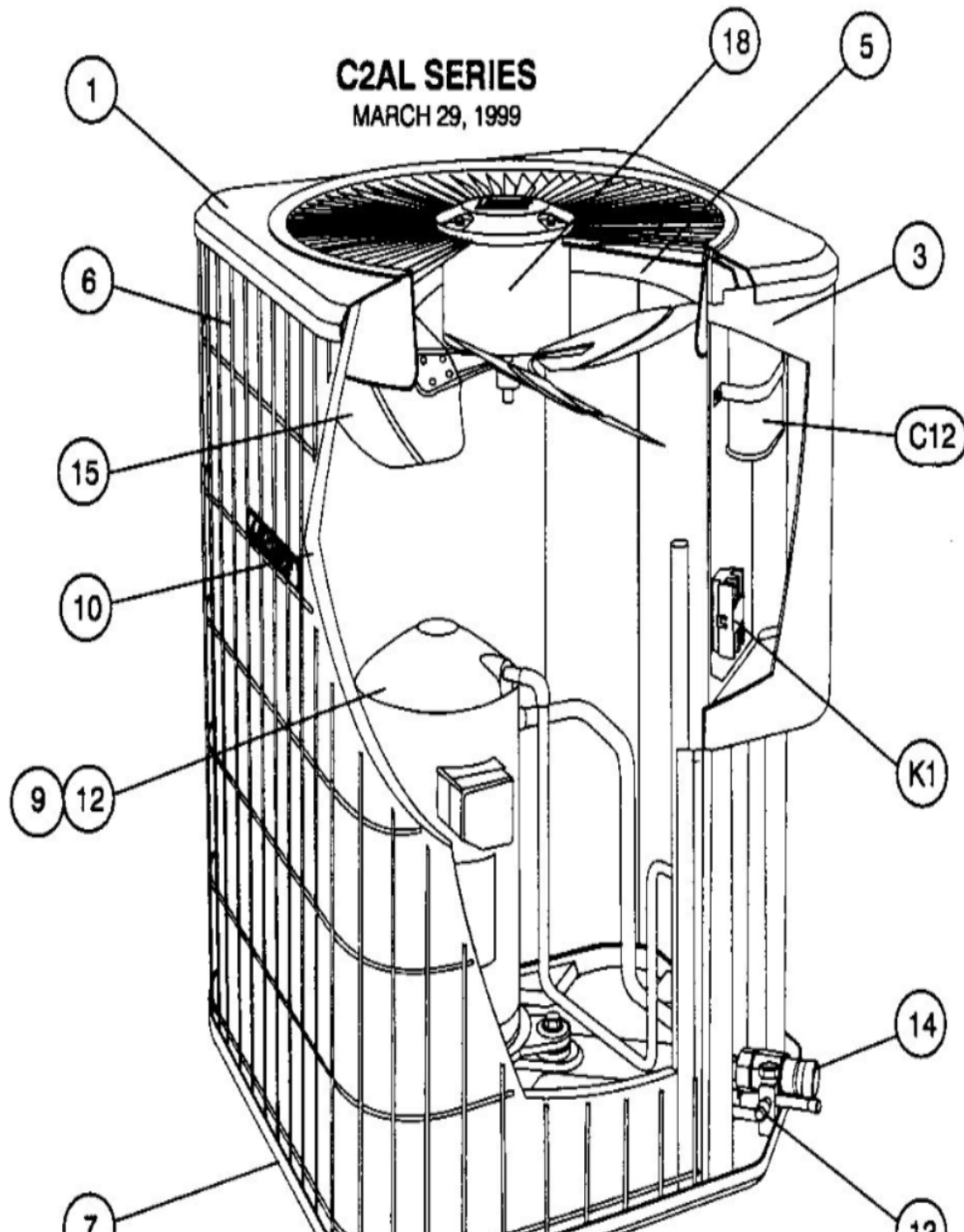

Revision Number - 1

*OPTIONAL PARTS-FIELD INSTALLED

Callout	Name	Quantity	Description
	CAPACITOR-START Cat #: 21J29 Model/Part #: 21J2901	1	"270-324MFD,330VAC"
	VALVE-SADDLE Cat #: 65G91 Model/Part #: 65G9101	1	"3/8""
	SWITCH-HI PRESS Cat #: 86H31 Model/Part #: 86H3101	1	OUT 410+10PSIG
	SWITCH-LO PRESS Cat #: 87265 Model/Part #: P-8-10978	1	"IN 55+5PSIG,OUT 25+5PSIG"
	RELAY-POTENTIAL Cat #: 58327 Model/Part #: P-8-3577	1	SPNC
KIT 1	LOSS OF CHARGE KIT Cat #: 94J47 Model/Part #: LB-87620A	1	INC NEXT 2 PARTS
KIT 2	HI PRESS CUTOUT KIT Cat #: 94J46 Model/Part #: LB-87619A	1	INC NEXT 2 PARTS
KIT 3	START-KIT Cat #: 81J69 Model/Part #: LB-31200BW	1	INC NEXT 2 PARTS

CABINET PARTS

Callout	Name	Quantity	Description
	NUT-CAP Cat #: 68J41 Model/Part #: 68J4101	4	TOP PANEL
1	PANEL-TOP Cat #: 23M21 Model/Part #: LB-94436L	1	TOP PANEL (BEIGE)
3	COVER-CONTROL BOX Cat #: 37K03 Model/Part #: LB-86268L	1	COVER-CONTROL PANEL (BEIGE)
5	ORIFICE Cat #: 68J47 Model/Part #: 68J4701	1	"22""
6	GUARD-COIL	1	OUTDOOR

Callout	Name	Quantity	Description
	Cat #: 39L5101 Model/Part #: 39L5101		
7	LEG Cat #: 94J45 Model/Part #: LB-87156A	1	BASE(SET OF 4)
9	COVER Cat #: 69J03 Model/Part #: 69J0301	1	SOUND- COMPRESSOR

CONTROL PANEL PARTS

Callout	Name	Quantity	Description
C12	CAPACITOR-FAN&RUN Cat #: 49K50 Model/Part #: 49K5001	1	"80+7.5MFD,370VAC(ROUND)"
K1	CONTACTOR-COMP Cat #: 96C86 Model/Part #: 96C8601	1	"SPST,24V"

COOLING PARTS

Callout	Name	Quantity	Description
	RELAY-OVERLOADCOMP-INTERNAL Cat #: Model/Part #:	1	
	DRIER Cat #: 12L71 Model/Part #: 12L7101	1	LIQUID LINE(OPT REPLACEMENT)
	DRIER Cat #: 15B63 Model/Part #: 15B6301	1	SUCTION LINE(OPT REPLACEMENT)
	HARNESS-COMPRESSOR Cat #: 15M35 Model/Part #: 15M3501	1	MOLDED PLUG
	HEATER-CRANKCASE Cat #: 31J20 Model/Part #: 31J2001	1	COMP(240V)
	MOUNT PKG-COMP Cat #: 74J30 Model/Part #: 74J3001PR	1	MOUNT PKG-COMP
10	COIL-OUTDOOR Cat #: 94J34 Model/Part #: LB-87170T	1	W/MANIFOLD
12	COMPRESSOR Cat #: 15M84 Model/Part #: 15M8401	1	"4TON,208- 230/60/1,COPE(AFTER 6/01 PROD)

Callout	Name	Quantity	Description
12	COMPRESSOR Cat #: 53J06 Model/Part #: 53J0601	1	"4TON,208-230/60/1,COPE"
13	VALVE-SERVICE Cat #: 68J10 Model/Part #: 68J1001	1	"LIQUID-LINE,3/8""
14	VALVE-SERVICE Cat #: 39L20 Model/Part #: 39L2001	1	"SUCTION LINE 1 1/8"" X 7/8""
15	FAN Cat #: 68J43 Model/Part #: 68J4301	1	"1/2""BORE,22""DIA,4 BLADE"
18	MOTOR-FAN Cat #: 68J24 Model/Part #: 68J2401	1	"1/3HP,1075RPM,208-230/60/1"

Note:

There are no technical notes for this product.