

Braeburn®

Wi-Fi Setup Guide

BlueLink™
smart connect



Model 7320 Universal Programmable Smart Wi-Fi Thermostat

**Leave this Setup Guide
with thermostat.**

1 Wire and Install Thermostat

- Properly wire and configure thermostat. Refer to the Installer Guide.
- Refer to the User Manual for programming and maintenance.

NOTE: Thermostat must have 24 VAC with common “C” wire to use Wi-Fi.

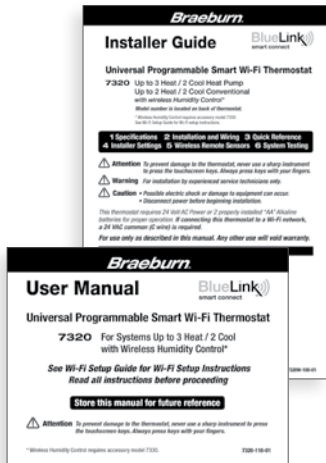

2 *Set-Up for Connection*

Before beginning setup you will need to:

- Know your Wi-Fi network name and password
- Have a valid e-mail address
- Get the FREE app

Apple® Devices:

Download the BlueLink Smart Connect™ application from the **Apple® App Store**

Android™ Devices:

Download the BlueLink Smart Connect™ application from the **Google Play Store**

Desktop Computer:

Go to **www.bluelinksmartconnect.com** and create an account.

NOTE: Your desktop PC must have a wireless connection.



3 Login and Register

- 3.1 Open the application or select login on the www.bluelinksmartconnect.com website.
- 3.2 Select **REGISTER** and complete the information on the registration screens. You will need a valid e-mail address to complete the registration.
- 3.3 Once you reach the Create Account screen, select **REGISTER**.



4 Enter Serial Number

4.1 Enter the thermostat serial number. You can locate this number on the back of the thermostat or on the enclosed thermostat registration card. Enter this number into the application and select **ENTER**.

NOTE: If you removed the thermostat to locate the serial number, make sure to reconnect it before selecting **ENTER**.

4.2 Enter your network name (SSID) and password, select **ENTER**.

The application will now instruct you to put the thermostat into Wi-Fi connect mode.

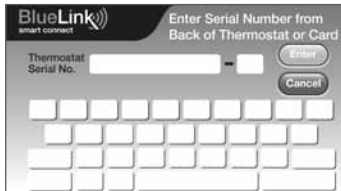

5 Enable Wi-Fi on Thermostat

5.1 On the thermostat, press and hold the **CONFIG** and **DAY/TIME** buttons for 3 seconds.

5.2 The display will alternate the words WIFI and SKIP and the  symbol will flash.

NOTE: *If you are already connected to a Wi-Fi network, you will see the network name (SSID) displayed 4 characters at a time with a solid  symbol. If needed, clear Wi-Fi settings and return to step 5.1 (See “Clear your Wi-Fi settings”). If you are not connected to 24 VAC the thermostat will not display any Wi-Fi information.*

5.3 Press the **Λ** button until the word SCAN appears in the display.

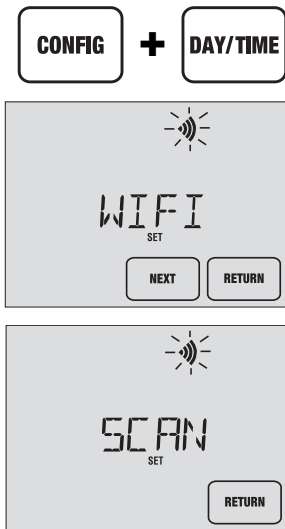

6 Connect to Thermostat

6.1 Return to the application and select OK. The word WAIT will appear in the thermostat display.

6.2 The application will prompt you to go to your smartphone, tablet or computer Wi-Fi settings and select the **BlueLink_WiFi** network.

NOTE: Do not exit the application. Minimize it so that you can return to the same screen after selecting the **BlueLink_WiFi** network.

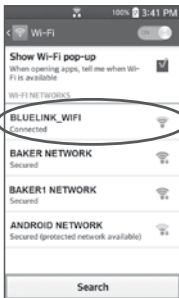
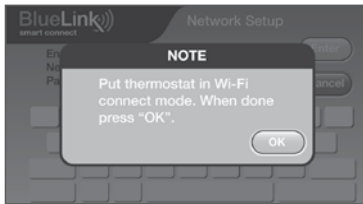

Android™ Sample

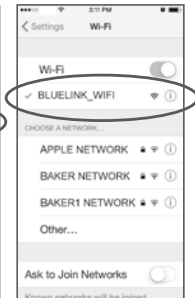

Apple® Sample

7 Complete Setup

7.1 After selecting the **BlueLink_WiFi** network, return to the application and select OK.

7.2 Once a connection is made, **Connection Successful** will appear in the application screen. At thermostat, your network name followed by the MAC address will appear.

7.3 At thermostat, press **RETURN** to exit Wi-Fi setup mode.

NOTE: After setup is complete, make sure to return your device to the original wireless network.

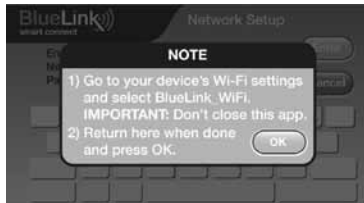

Changing Your Wi-Fi Settings

First Clear Your Thermostat Wi-Fi Settings

1. Press and hold the **CONFIG** button for 1 second.
2. The display will change showing the first User Option.
3. Press **NEXT** until you see the word WIFI in the display.
4. Press the **Λ** button until CL WIFI appears.
5. Press **RETURN** to exit and clear all Wi-Fi settings.

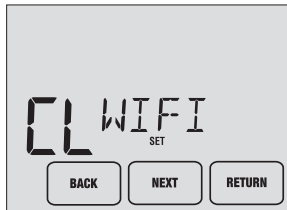

Then Update Your App Settings

1. Open the app and select **Update Account**.
2. Enter your account password.
3. Select **Wi-Fi Settings**.
4. Select the thermostat you wish to change.
5. Choose **WI-FI Network** or **WI-FI Password** and select Enter.
6. Update the information and select **Enter**.



NOTE: To complete setup, follow the instructions in the app and refer to sections 5 - 7.

Record Network Information for Future Reference

Network Name (SSID) _____

Network Password _____

Thermostat Serial Number # _____

You may need this information later or if calling for support.

Visit www.bluelinksmartconnect.com for support materials.

Braeburn[®]

Braeburn Systems LLC
2215 Cornell Avenue • Montgomery, IL 60538
Technical Assistance: www.braeburnonline.com
844-BLU-LINK (844-258-5465) (U.S.)
630-844-1968 (Outside the U.S.)

©2015 Braeburn Systems LLC • All Rights Reserved • Made in China.

Apple and the Apple logo are trademarks of Apple Inc., registered in the U.S. and other countries. App Store is a service mark of Apple Inc. All other trademarks are the property of their respective owners.

7320-105-02