

GVSR250H

2-1/2" Electro-Galvanized Split Ring Extension Hanger (Hinged)

Specifications:

- **Material:** Malleable iron for strength and durability
- **Hinge Design:** Two-piece split ring for easy installation
- **Fastening:** Secured with bolt and nut closure
- **Thread Compatibility:** Accepts standard 1/2" threaded rod
- **Finish:** Electro-Galvanized *Zinc-plated*

Description:

The Split Ring Hanger provides secure support for non-insulated, stationary pipes when suspended from threaded rod. Its two-piece hinged construction enables fast installation without the need to remove or disassemble existing piping. Designed for dependable performance in light- to medium-duty support conditions.

Applications:

- Suspension of steel, copper, or plastic pipe
- Plumbing systems, including water supply, drainage, and venting
- HVAC piping installations
- Fire protection piping where permitted by applicable codes
- Use in commercial, residential, and light industrial environments

Certifications/Listings/Approvals

- FM Approved
- ASTM B504
- ASTM D3359-2017
- ASTM B117-2016
- ANSI A156.18



Nominal Pipe Size	Rod Size	Rec. Max Load
IPS	(in)	(Lbs)
2-1/2"	1/2"	300



Product Offerings and Dimensions

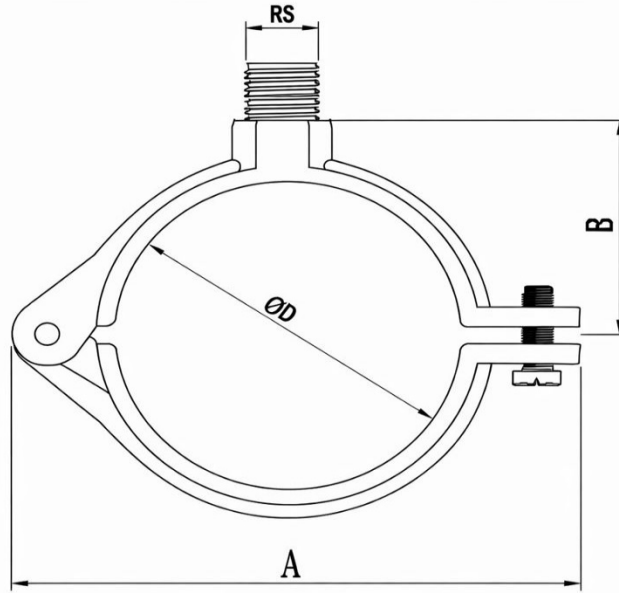

PART NO.	Nominal Pipe Size (IPS)	A – IN	B – IN	D – IN	Rod Size (RS)	Max Rec. Load (lbs)
GVSR050H	1/2"	2.17"	0.71"	0.84"	3/8"	180 lbs
GVSR075H	3/4"	2.36"	0.80"	1.05"	3/8"	180 lbs
GVSR100H	1"	2.76"	0.98"	1.32"	3/8"	180 lbs
GVSR125H	1-1/4"	3.07"	1.15"	1.66"	3/8"	180 lbs
GVSR150H	1-1/2"	3.33"	1.26"	1.90"	3/8"	180 lbs
GVSR200H	2"	3.94"	1.56"	2.37"	3/8"	180 lbs
GVSR250H	2-1/2"	4.84"	2.06"	2.89"	1/2"	300 lbs
GVSR300H	3"	5.55"	2.48"	3.50"	1/2"	300 lbs
GVSR400H	4"	6.61"	2.99"	4.50"	1/2"	300 lbs