

GVSR200H

2" Electro-Galvanized Split Ring Extension Hanger (Hinged)

Specifications:

- **Material:** Malleable iron for strength and durability
- **Hinge Design:** Two-piece split ring for easy installation
- **Fastening:** Secured with bolt and nut closure
- **Thread Compatibility:** Accepts standard 3/8" threaded rod
- **Finish:** Electro-Galvanized *Zinc-plated*



Description:

The Split Ring Hanger provides secure support for non-insulated, stationary pipes when suspended from threaded rod. Its two-piece hinged construction enables fast installation without the need to remove or disassemble existing piping. Designed for dependable performance in light- to medium-duty support conditions.



Applications:

- Suspension of steel, copper, or plastic pipe
- Plumbing systems, including water supply, drainage, and venting
- HVAC piping installations
- Fire protection piping where permitted by applicable codes
- Use in commercial, residential, and light industrial environments

| Nominal Pipe Size | Rod Size | Rec. Max Load |
|-------------------|----------|---------------|
| IPS | (in) | (Lbs) |
| 2" | 3/8" | 180 |

Certifications/Listings/Approvals

- FM Approved
- ASTM B504
- ASTM D3359-2017
- ASTM B117-2016
- ANSI A156.18



Product Offerings and Dimensions

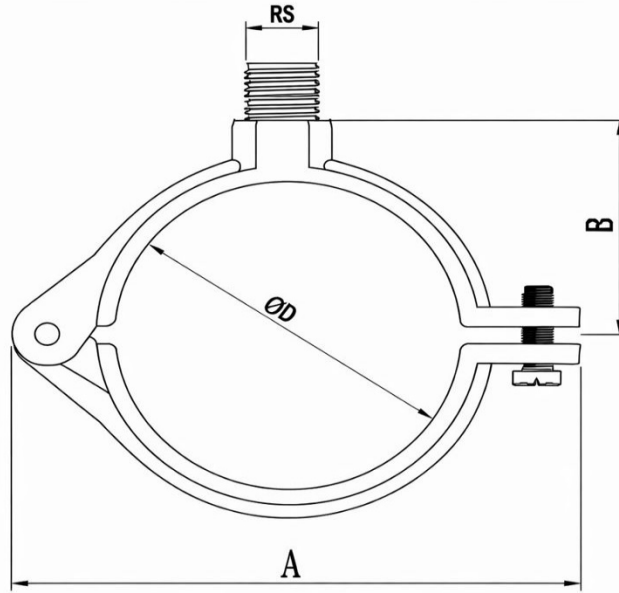

| PART NO. | Nominal Pipe Size (IPS) | A – IN | B – IN | D – IN | Rod Size (RS) | Max Rec. Load (lbs) |
|----------|-------------------------|--------|--------|--------|---------------|---------------------|
| GVSR050H | 1/2" | 2.17" | 0.71" | 0.84" | 3/8" | 180 lbs |
| GVSR075H | 3/4" | 2.36" | 0.80" | 1.05" | 3/8" | 180 lbs |
| GVSR100H | 1" | 2.76" | 0.98" | 1.32" | 3/8" | 180 lbs |
| GVSR125H | 1-1/4" | 3.07" | 1.15" | 1.66" | 3/8" | 180 lbs |
| GVSR150H | 1-1/2" | 3.33" | 1.26" | 1.90" | 3/8" | 180 lbs |
| GVSR200H | 2" | 3.94" | 1.56" | 2.37" | 3/8" | 180 lbs |
| GVSR250H | 2-1/2" | 4.84" | 2.06" | 2.89" | 1/2" | 300 lbs |
| GVSR300H | 3" | 5.55" | 2.48" | 3.50" | 1/2" | 300 lbs |
| GVSR400H | 4" | 6.61" | 2.99" | 4.50" | 1/2" | 300 lbs |