

Heavy Pattern Sillcock

(Lead Free)

FEATURES

- **Brass Construction** – C46400 brass alloy includes tin for added corrosion resistance and excellent strength
- **Rated for Durability** - Able to withstand a maximum operating temperature of 160°F at 125 PSI
- **Outlet Type** – Garden Hose Thread

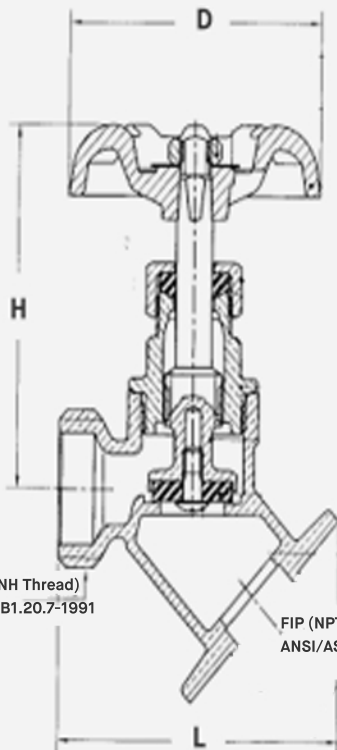

SKU	Size	Dimension				
		D	H	L	FIP	MHT
SKT050-H	1/2" FIP x 3/4" MHT	2.08"	2.40"	2.12"	1/2"- 14NPT	3/4"- 11.5NH
SKT075-H	3/4" FIP x 3/4" MHT	2.08"	2.40"	2.48"	3/4"- 14NPT	3/4"- 11.5NH

No	Parts	Materials	QTY	Water Contact
1	Nut	Hot Rolled SAE 1010R	1	No
2	Name Plate	Aluminum A1100	1	No
3	Handle	Cast Iron JIS Z22202	1	No
4	Packing Nut	Brass Rod C37700	1	No
5	Packing	Rubber (NBR) SN-719F	1	Yes
6	Bonnet	Cast Brass C46400 MOD	1	Yes
7	Stem	Cast Brass C46400 MOD	1	Yes
8	Seat Packing	Rubber (NBR) SN-719F	1	Yes
9	Screw	Forged Brass C26000	1	Yes
10	Body	Cast Brass C46400 MOD	1	Yes

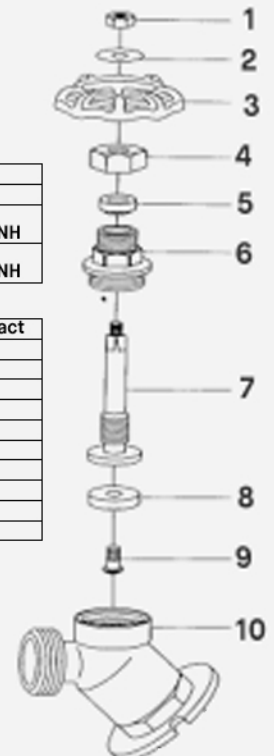

MHT (NH Thread)
ASME B1.20.7-1991

FIP (NPT Thread)
ANSI/ASME B1.20.1-2013