

# Radiator Valve Spud Wrench

SKU: RVSW-2

## FEATURES

- **Ductile Iron Construction** – Provides excellent strength and durability, making it ideal for heavy-duty resistance to impact and wear.
- **1/2" - 2" Size Applicable** – For effective use on a wide variety of jobs.
- **Zinc-Plated Finish** – Both highly durable and corrosion resistant.

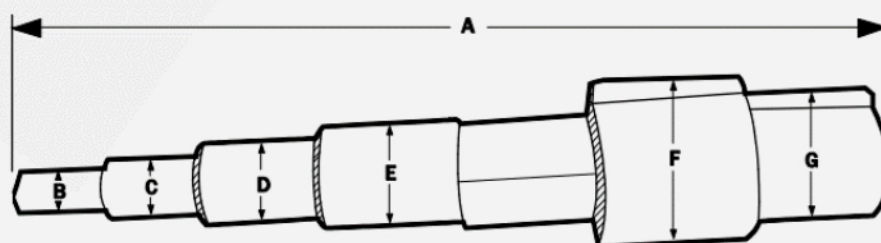

SKU	A	B	C	D	E	F	G
RVSW-2	10-2/5"	1/2"	3/4"	1"	1-1/4"	2"	1-1/2"