

Poly PEX Crimp Elbow

FEATURES

- Material: Acudel 22000, Radel R-5100
- For use with PEX-A tubing manufactured to ASTM Standard F876-877
- NSF/ANSI Standard 14
- NSF/ANSI Standard 61
- NSF/ANSI Standard 372 (Low Lead)
- ASTM F1960
- CSA B137.5



SKU: PXLE038, PXLE050, PXLE075,
PXLE100, PXLE075-050

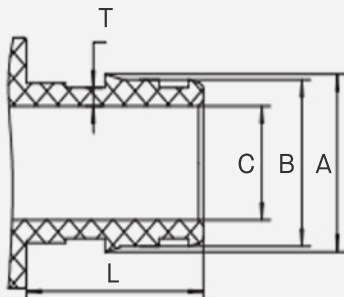

Insert for Fittings Size					
Size	A	B	C	L	T
3/8"	0.476"	0.437"	0.268"	0.601"	0.047"
1/2"	0.614"	0.575"	0.385"	0.719"	0.057"
5/8"	0.744"	0.693"	0.494"	0.876"	0.057"
3/4"	0.87"	0.791"	0.59"	0.955"	0.057"
1"	1.106"	1.028"	0.788"	1.191"	0.072"
1-1/4"	1.357"	1.271"	0.97"	1.455"	0.075"
1-1/2"	1.49"	1.378"	1.084"	1.714"	0.095"
2"	2.075"	1.954"	1.484"	2.157"	0.128"