

PVC Compression Coupling

1/2" to 4"

FEATURES

- Durable - PVC body and nuts and rubber gaskets deliver strong, long-lasting performance
- Versatile - Rated at 150 PSI at 73°F
- Fully Compliant - Meets NSF approved low lead standards for safe and effective use on commercial and residential jobs
- IPS for use with piping or repairs on galvanized or plastic pipe. Pipe must be restrained after installation.

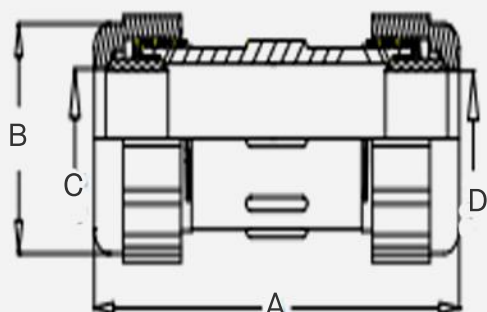

SKU	Size	A	B	C	D
PVCC050	1/2"	5.24"	1.69"	0.89"	0.82"
PVCC075	3/4"	5.53"	1.95"	1.13"	1.00"
PVCC100	1"	6.09"	2.20"	1.35"	1.30"
PVCC125	1-1/4"	6.47"	2.66"	1.33"	1.60"
PVCC150	1-1/2"	6.90"	2.92"	2.00"	1.85"
PVCC200	2"	7.70"	3.43"	2.43"	2.30"
PVCC250	2-1/2"	9.80"	4.09"	3.00"	2.80"
PVCC300	3"	10.90"	4.74"	3.60"	3.45"
PVCC400	4"	12.00"	5.80"	4.60"	4.45"