

PVC Schedule 40 Spigot x Socket Bushing

FEATURES

- **Fully-Compliant** – Meets UPC, NSF, and ASTM D2665 standards for spigot x socket connection-type PVC.

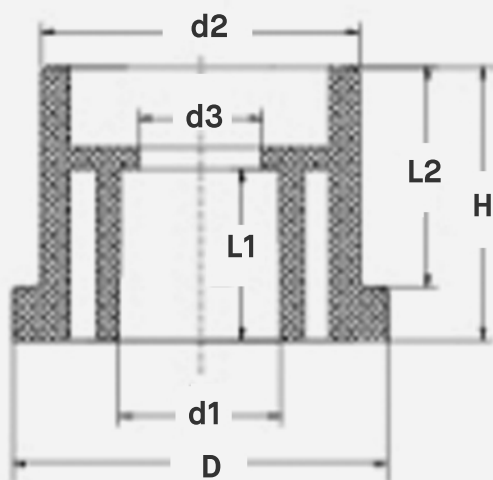

SKU	Nominal Size	D	d1	d2	d3	H	L1	L2
PVBB075-050	3/4" x 1/2"	1.26"	0.84"	1.05"	0.73"	1.28"	0.88"	1.02"
PVBB100-050	1" x 1/2"	1.59"	0.84"	1.31"	0.64"	1.34"	0.88"	1.07"
PVBB100-075	1" x 3/4"	1.61"	1.05"	1.31"	0.81"	1.34"	1.02"	1.08"
PVBB125-050	1-1/4" x 1/2"	1.92"	0.84"	1.66"	0.64"	1.42"	0.88"	1.13"
PVBB125-075	1-1/4" x 3/4"	1.93"	1.05"	1.66"	0.81"	1.42"	1.02"	1.13"
PVBB125-100	1-1/4" x 1"	1.93"	1.31"	1.66"	1.06"	1.42"	1.08"	1.13"
PVBB150-050	1-1/2" x 1/2"	2.19"	0.84"	1.90"	0.64"	1.61"	0.88"	1.32"
PVBB150-075	1-1/2" x 3/4"	2.19"	1.05"	1.90"	0.81"	1.61"	1.02"	1.32"
PVBB150-100	1-1/2" x 1"	2.19"	1.31"	1.90"	1.06"	1.61"	1.06"	1.32"
PVBB150-125	1-1/2" x 1-1/4"	2.23"	1.66"	1.90"	1.61"	1.62"	1.14"	1.34"
PVBB200-050	2" x 1/2"	2.69"	0.84"	2.38"	0.64"	1.87"	0.87"	1.56"
PVBB200-075	2" x 3/4"	2.69"	1.05"	2.38"	0.81"	1.87"	1.02"	1.56"
PVBB200-100	2" x 1"	2.69"	1.31"	2.38"	1.07"	1.87"	1.06"	1.56"
PVBB200-125	2" x 1-1/4"	2.69"	1.66"	2.38"	1.38"	1.87"	1.14"	1.56"
PVBB200-150	2" x 1-1/2"	2.69"	1.90"	2.38"	1.85"	1.87"	1.34"	1.56"
PVBB300-150	3" x 1-1/2"	4.28"	1.90"	3.50"	1.69"	2.28"	1.34"	1.97"
PVBB300-200	3" x 2"	4.09"	2.38"	3.50"	2.17"	2.28"	1.57"	1.97"
PVBB400-200	4" x 2"	5.43"	2.38"	4.50"	2.17"	2.13"	1.57"	1.77"
PVBB600-400	6" x 4"	7.83"	4.50"	6.63"	4.25"	3.15"	2.13"	2.72"