

Expansion PEX EP Coupling

FEATURES

- For use with PEX-A tubing.
- Material: Acudel 22000, Radel R-5100
- Maximum Operating Temperature: 210°F
- Manufactured to ASTM Standard F876-877
- NSF/ANSI Standard 14
- NSF/ANSI Standard 61
- NSF/ANSI Standard 372 (Low Lead)
- ASTM F1960
- CSA B137.5



SKU: PPLC050, PPLC075, PPLC100,
PPLC050-075, PPLC075-100

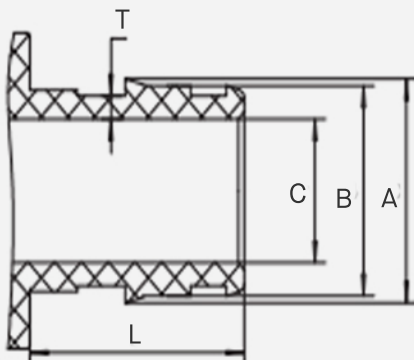

| Insert for Fittings Size | | | | | |
|--------------------------|--------|--------|--------|--------|--------|
| Size | A | B | C | L | T |
| 3/8" | 0.476" | 0.437" | 0.268" | 0.601" | 0.047" |
| 1/2" | 0.614" | 0.575" | 0.385" | 0.719" | 0.057" |
| 5/8" | 0.744" | 0.693" | 0.494" | 0.876" | 0.057" |
| 3/4" | 0.87" | 0.791" | 0.59" | 0.955" | 0.057" |
| 1" | 1.106" | 1.028" | 0.788" | 1.191" | 0.072" |
| 1-1/4" | 1.357" | 1.271" | 0.97" | 1.455" | 0.075" |
| 1-1/2" | 1.49" | 1.378" | 1.084" | 1.714" | 0.095" |
| 2" | 2.075" | 1.954" | 1.484" | 2.157" | 0.128" |