



# 1/2" Expansion PEX x 1/2" Female Sweat Copper Pipe Adapter (Lead Free Brass)

## FEATURES

**Size:** 1/2" PEX x 1/2" Sweat

**Material:** Brass

**Brass Alloy:** C46500

**Application:** Plumbing & Heating

**Durable** – Maximum working pressure: 200psi,  
Maximum temperature: 200°F

### Standards Met:

ASTM F1960

NSF

ASTM F877

**Fitting System Compatibility:** Expander (ProPEX)

**Lead Free** - Made from certified lead-free brass for safe and effective use in hydronics and potable water systems.

**Please Note:** This product is susceptible to dezincification and does not hold a high DZR rating. This product should not be used in applications where brass parts may be exposed to hard water (high sulfur or mineral content).

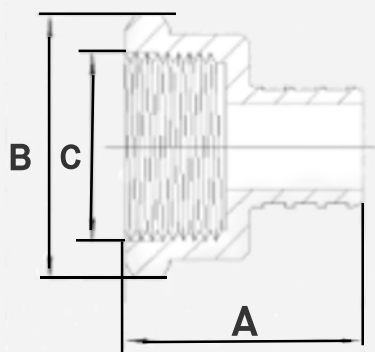

SKU	A	B	C
PPCA050	1.260"	1.102"	NPT 1/2"