

# 3-in-1 Push-Fit Fitting Removal Tool



**Model:** PFTL

**Size:** 1/2", 3/4" 1"

**Length:** 6.5 inches

**Weight:** 0.42lb

**Grip Material:** Rubber Dipped



**One Tool Fits Three Sizes**  
No interchangeable faceplates required



## HOW TO DISCONNECT

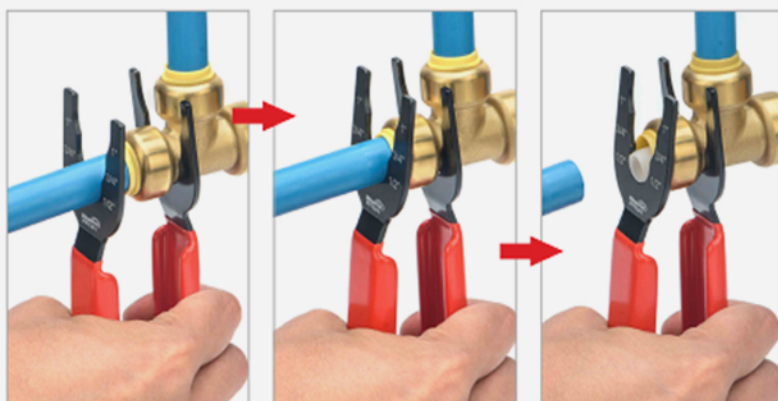

**Step 1:** Place the teeth around the fitting assembly. The fork end with the iCrimp logo should be positioned around the tube to push against the release collar and the other end around the neck of the fitting.

**Step 2:** Squeeze the tool with one hand and pull the tube with a twisting action with the other hand to release the tube.

## TIPS For Disconnect 1/2" Brass Push Tee

With 3 sizes in one faceplate design, you might not be able to remove the PEX tubing from the middle part of 1/2" Brass Push Tee, here are the solutions:

