

1/2" Hose Barb x 3/8" Male Brass Pipe Adapter

FEATURES

- **Brass Construction** – Brass alloy C3604 is strong and corrosion resistant for long-lasting, reliable performance in plumbing applications.
- **Connection Types** - Hose barb, male pipe, hose barb x male pipe

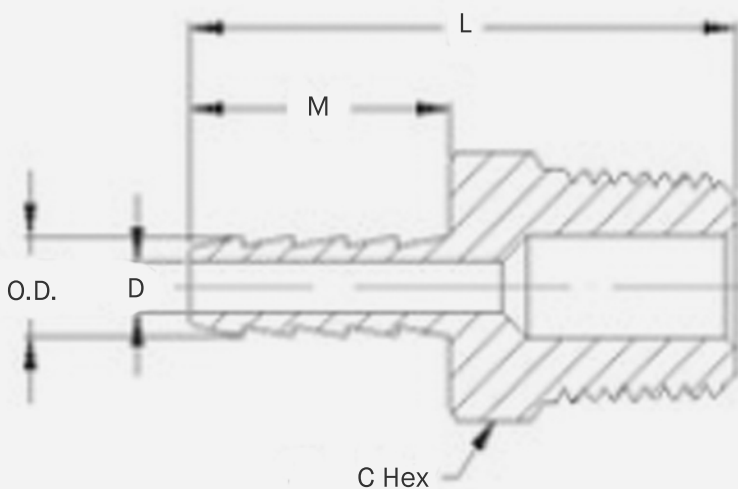

SKU	Hex C	L	M	O.D.
GHBM050-038	.874"	1.858"	.970"	.646"