

Classic Single Handle Kitchen Faucet

Model: FTK100

FEATURES

- Low-lead brass body
- Zinc handle
- D25 stainless steel ball cartridge
- 1/2"- 14 NPSM male inlet connections
- Neoperl aerator
- Flow rate: 1.8gpm Max @60PSI



REPLACEMENT PARTS

No.	Description	Part Number
1	Handle Assembly	52008012CP/AP/HA
2	Screw & Button	5Y0161200PLO
3	Bonnet	52007904NT
4	Cap	52007905CP/AP/HA
5	Aerator Assembly	5Y0161100CP0
5A	Washer	52006919PL
5B	Aerator	5E0P0023PL
6	Mounting Hardware	5Y0161400PLO
6A	Bolt	53001005ZZ
6B	Nut	52008013PL
7	Cartridge	52007908NT

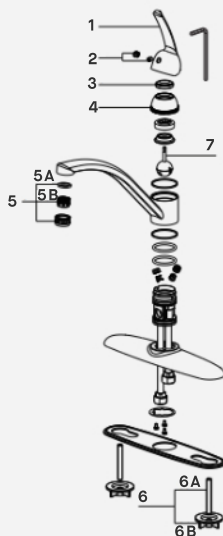

TOOLS YOU WILL NEED



ADJUSTABLE WRENCH



PHILLIPS SCREWDRIVER



PIPE TAPE



GROOVE JOIN PLIERS

INSTALLATION

1

Put the faucet into the mounting holes and lock it with screw nut.

2

Put the spray base into the mounting hole and lock it with screw nut.

3

Insert sidespray hose into the spray base, and connect the other end of the hose with the faucet.

4

Install water inlet hoses and tighten with a wrench.

5

Remove aerator assembly and flush out debris. Reinstall aerator assembly.