

Single Handle Centerset Lav Faucet

Model: FTB501

FEATURES

- Zinc handle
- 25mm ceramic cartridge
- 15" flexible stainless steel inlet hose with female 3/8" compression fitting
- Neoperl aerator
- Includes plastic lift-rod pop up waste
- Polished chrome / Brushed Chrome finish
- Flow Rate :1.2 gpm Max @ 60 psi



REPLACEMENT PARTS

No.	Description	Part Number
1	Handle	5C0Z0167CP/AP/HA
2	Screw & Button	5Y0161100PLO
3	Cap	5LOP0149CP/AP/HA
4	Bonnet	52007017NT
5	Cartridge	52007014PL
6	Aerator Assembly	5Y0159200CP/AP/HAO
6a	Washer	52006919PL
6b	Aerator	5E0003600PLO
7	Mounting Hardware	5Y0159300NTO
7a	Bolt	53001005ZZ
7b	Washer	52007919CZ
7c	Nut	612013062
8	Supply Hose (Cold)	5G0M0004CC
9	Supply Hose (Hot)	5G0M0003CC
10	Lift Rod	5H0M0043CP/AP/HA
11	Plastic Pop-up	5Y0012600NT/AP/HAO

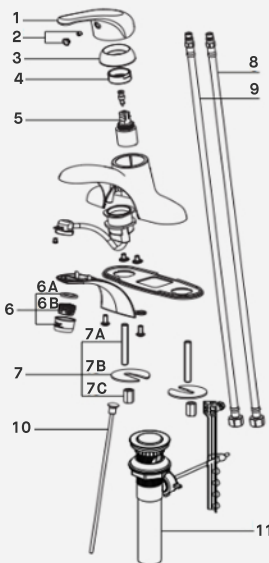

TOOLS YOU WILL NEED



ADJUSTABLE WRENCH



PHILLIPS SCREWDRIVER



PIPE TAPE



GROOVE JOIN PLIERS

INSTALLATION

1 Connect the inlet hose to the faucet.

2 Put the faucet into the mounting holes.

3 Put the washer and the screw nut onto the bolt and tighten it.

4 Connect the inlet hose to the appropriate cold and hot angle valve. If you purchased optional pop-up, please proceed to step 5 to 9. Otherwise, go to step 10.

5 Apply teflontape to the thread on the drain.

6 Slide drain trim and plug into drain hole and secure from below.

7 Install the Drain Plug Assembly and The Movable Rod Assembly into the Pop-Up Assembly.

8 Fix the horizontal rod through the metal clip and lift rod strap.

9 Install the lift rod to the pup up.

10 Tighten the screw in the strap onto the lift rod.

11 Remove aerator assembly and flush out debris. Reinstall aerator assembly.