

1/4" Flare x 1/8" MIP Brass Half Union

FEATURES

- **Brass Construction** – Brass alloy C3604 is strong and corrosion resistant for long-lasting, reliable performance in plumbing applications.
- **Connection Type** - Flare x half union

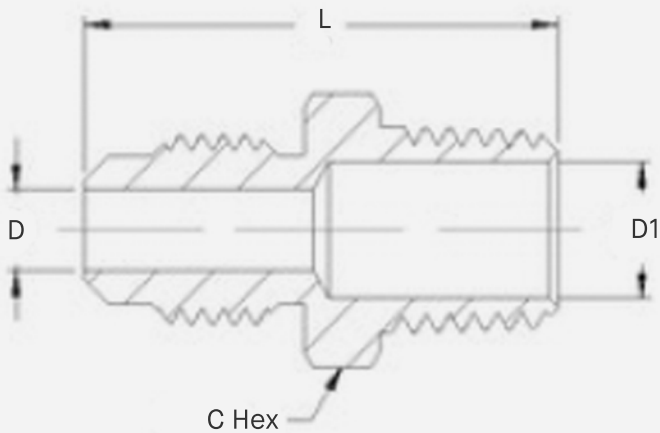

| SKU | D | L | C Hex | D1 |
|-------------|-------|--------|-------|-------|
| FLHU025-018 | .185" | 1.043" | .437" | .217" |