

# Open Grid Top PO Plug Tailpiece

Chrome Plated



## FEATURES

- **Fully Compliant** - Complies with ASME A112.18.1-2018/CSA B125.1-18 standards for use in both the United States and Canada.
- **Lead Free** – Meets cUPC standards for safe use in commercial and residential lead-free drinking water systems.
- **Chrome-Plated Brass Construction** – Makes the trip lever more durable and more attractive.

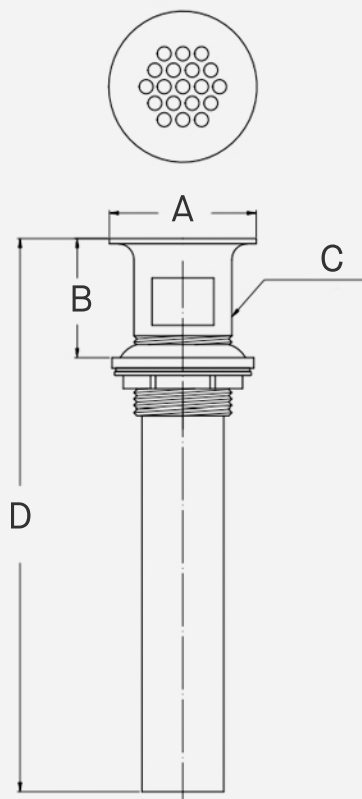

SKU	A	B	C	D
DR1-400	2.24"	1.18"	1-1/2" - 16 UNEF	6.30"
DR1-600	2.24"	1.97"	1-1/2" - 16 UNEF	8.27"