

1/2" Chrome Brass Coupling

Lead Free

FEATURES

- **Brass Construction** – The chrome plated C46400 brass alloy includes tin for added corrosion resistance and excellent strength.
- **Certified Lead-Free** - Meets NSF372 standards for safe use in drinking water systems.
- **Widely Compatible** - Meets NPT and ASME B1.20.1 regulations for standard pipe thread.
- **Durable** - Meets ASTM B124 specifications for hot forging.

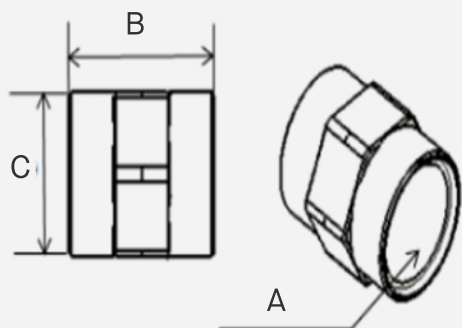

| SKU | A | B | C |
|--------|----------|-------|-------|
| CRC050 | 1/2" NPT | 1.20" | 0.93" |