

Epoxy Coated Tube Split Ring Extension Hanger

FEATURES

- **Malleable Iron Construction** – makes the connector strong yet easy to work with.
- **Copper Epoxy Finish** – Adds reliable corrosion protection.

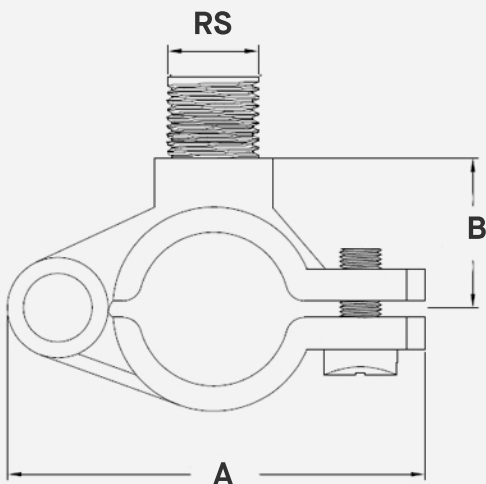

SKU	Size	A	B	Rod Size (RS)	Max Rec. Load (lbs)
CESR050H	1/2"	1.81"	0.55"	3/8"	180
CESR075H	3/4"	2.13"	0.77"	3/8"	180
CESR100H	1"	2.36"	0.85"	3/8"	180
CESR125H	1-1/4"	2.68"	1.02"	3/8"	180
CESR150H	1-1/2"	2.95"	1.14"	3/8"	180
CESR200H	2"	3.44"	1.48"	3/8"	180
CESR250H	2-1/2"	4.65"	1.77"	1/2"	300
CESR300H	3"	5.14"	2.06"	1/2"	300
CESR400H	4"	6.14"	2.56"	1/2"	300