

# Black Reducing Tee

## FEATURES

- **Malleable Iron Construction** – The ASTM A197/A197M compliant malleable iron makes the product strong yet easy to work with.
- **Widely Compatible** – Meets B16.39 and ASME B1.20.1 regulations for malleable female iron pipe thread.

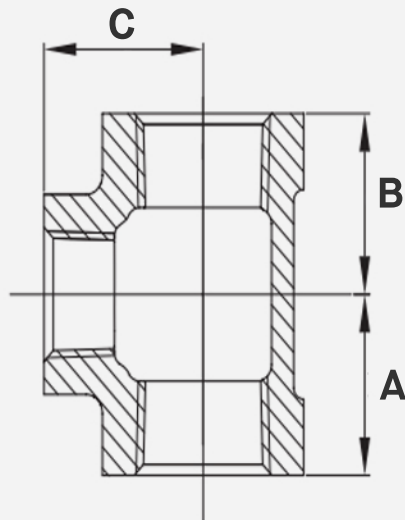

SKU	Size	A	B	C
BLT038-038-025C	3/8" x 3/8" x 1/4"	0.74"	0.74"	0.81"
BLT050-050-018C	1/2" x 1/2" x 1/8"	0.86"	0.86"	0.90"
BLT050-050-025C	1/2" x 1/2" x 1/4"	0.97"	0.97"	0.98"
BLT050-050-038C	1/2" x 1/2" x 3/8"	1.03"	1.03"	1.04"
BLT050-050-075C	1/2" x 1/2" x 3/4"	1.05"	1.05"	1.08"
BLT050-050-100C	1/2" x 1/2" x 1"	1.08"	1.08"	1.11"
BLT075-050-050C	3/4" x 1/2" x 1/2"	1.20"	1.22"	1.12"
BLT075-050-075C	3/4" x 1/2" x 3/4"	1.31"	1.31"	1.22"
BLT075-075-025C	3/4" x 3/4" x 1/4"	1.05"	1.05"	1.08"
BLT075-075-050C	3/4" x 3/4" x 1/2"	1.20"	1.20"	1.22"
BLT075-075-100C	3/4" x 3/4" x 1"	1.23"	1.23"	1.26"
BLT075-075-125C	3/4" x 3/4" x 1-1/4"	1.25"	1.25"	1.30"
BLT100-050-050C	1" x 1/2" x 1/2"	1.26"	1.40"	1.12"
BLT100-050-075C	1" x 1/2" x 3/4"	1.37"	1.45"	1.22"
BLT100-050-100C	1" x 1/2" x 1"	1.50"	1.50"	1.40"
BLT100-075-050C	1" x 3/4" x 1/2"	1.34"	1.42"	1.26"
BLT100-075-075C	1" x 3/4" x 3/4"	1.37"	1.45"	1.31"
BLT100-075-100C	1" x 3/4" x 1"	1.50"	1.50"	1.45"
BLT100-100-025C	1" x 1" x 1/4"	1.11"	1.11"	1.22"
BLT100-100-050C	1" x 1" x 1/2"	1.26"	1.26"	1.40"
BLT100-100-075C	1" x 1" x 3/4"	1.37"	1.37"	1.45"
BLT100-100-125C	1" x 1" x 1-1/4"	1.42"	1.42"	1.53"
BLT100-100-150C	1" x 1" x 1-1/2"	1.51"	1.51"	1.59"
BLT125-050-100C	1-1/4" x 1/2" x 1"	1.57"	1.49"	1.50"
BLT125-050-125C	1-1/4" x 1/2" x 1-1/4"	1.75"	1.75"	1.53"
BLT125-075-075C	1-1/4" x 3/4" x 3/4"	1.45"	1.62"	1.31"
BLT125-075-100C	1-1/4" x 3/4" x 1"	1.58"	1.67"	1.45"
BLT125-075-125C	1-1/4" x 3/4" x 1-1/4"	1.75"	1.75"	1.62"
BLT125-100-050C	1-1/4" x 1" x 1/2"	1.34"	1.53"	1.26"
BLT125-100-075C	1-1/4" x 1" x 3/4"	1.45"	1.62"	1.37"
BLT125-100-100C	1-1/4" x 1" x 1"	1.58"	1.67"	1.50"
BLT125-100-125C	1-1/4" x 1" x 1-1/4"	1.75"	1.75"	1.67"
BLT125-125-038C	1-1/4" x 1-1/4" x 3/8"	1.26"	1.26"	1.44"
BLT125-125-050C	1-1/4" x 1-1/4" x 1/2"	1.33"	1.33"	1.53"
BLT125-125-075C	1-1/4" x 1-1/4" x 3/4"	1.45"	1.45"	1.62"
BLT125-125-100C	1-1/4" x 1-1/4" x 1"	1.58"	1.58"	1.67"
BLT125-125-150C	1-1/4" x 1-1/4" x 1-1/2"	1.63"	1.63"	1.74"
BLT150-050-150C	1-1/2" x 1/2" x 1-1/2"	1.94"	1.94"	1.66"
BLT150-075-075C	1-1/2" x 3/4" x 3/4"	1.49"	1.69"	1.26"
BLT150-075-150C	1-1/2" x 3/4" x 1-1/2"	1.94"	1.94"	1.75"
BLT150-100-075C	1-1/2" x 1" x 3/4"	1.94"	1.94"	1.77"
BLT150-100-150C	1-1/2" x 1" x 1-1/2"	1.94"	1.94"	1.80"
BLT150-125-050C	1-1/2" x 1-1/4" x 1/2"	1.41"	1.66"	1.34"
BLT150-125-075C	1-1/2" x 1-1/4" x 3/4"	1.52"	1.75"	1.43"
BLT150-125-100C	1-1/2" x 1-1/4" x 1"	1.65"	1.80"	1.58"
BLT150-150-050C	1-1/2" x 1-1/2" x 1/2"	1.41"	1.41"	1.66"
BLT150-150-075C	1-1/2" x 1-1/2" x 3/4"	1.52"	1.52"	1.75"
BLT150-150-100C	1-1/2" x 1-1/2" x 1"	1.65"	1.65"	1.80"
BLT150-150-125C	1-1/2" x 1-1/2" x 1-1/4"	1.82"	1.82"	1.88"
BLT200-050-200C	2" x 1/2" x 2"	2.25"	2.25"	1.88"
BLT200-075-200C	2" x 3/4" x 2"	2.25"	2.25"	1.97"
BLT200-125-125C	2" x 1-1/4" x 1-1/4"	1.90"	2.09"	1.75"
BLT200-150-075C	2" x 1-1/2" x 3/4"	1.55"	1.93"	1.47"
BLT200-150-125C	2" x 1-1/2" x 1-1/4"	1.90"	2.10"	1.82"
BLT200-150-150C	2" x 1-1/2" x 1-1/2"	2.02"	2.16"	1.94"
BLT200-200-050C	2" x 2" x 1/2"	1.49"	1.49"	1.88"
BLT200-200-075C	2" x 2" x 3/4"	1.60"	1.60"	1.97"
BLT200-200-100C	2" x 2" x 1"	1.73"	1.73"	2.02"
BLT200-200-125C	2" x 2" x 1-1/4"	1.90"	1.90"	2.10"
BLT200-200-150C	2" x 2" x 1-1/2"	2.02"	2.02"	2.16"
BLT250-250-100C	2-1/2" x 2-1/2" x 1"	1.87"	1.87"	2.37"
BLT250-250-125C	2-1/2" x 2-1/2" x 1-1/4"	2.04"	2.04"	2.45"
BLT250-250-150C	2-1/2" x 2-1/2" x 1-1/2"	2.16"	2.16"	2.51"
BLT250-250-200C	2-1/2" x 2-1/2" x 2"	2.39"	2.39"	2.60"
BLT300-300-100C	3" x 3" x 1"	2.00"	2.00"	2.66"
BLT300-300-250C	3" x 3" x 2-1/2"	2.83"	2.83"	2.99"