

# Black Iron Pipe Nipple

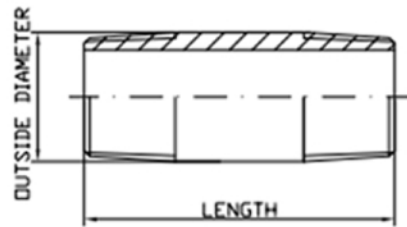

Material : ASTM A53  
 Dimensions : ASTM A733  
 Threads : ASME B1.20.1  
 Schedule : 40



Pipe Size	Pipe O.D.	Length Close	Pipe Nipple Lengths ( In )															
			In	In	In													
1/8	0.405	3/4	11/2	2	2 1/2	3	3 1/2	4	4 1/2	5	5 1/2	6	7	8	9	10	11	12
1/4	0.540	7/8	11/2	2	2 1/2	3	3 1/2	4	4 1/2	5	5 1/2	6	7	8	9	10	11	12
3/8	0.675	1	11/2	2	2 1/2	3	3 1/2	4	4 1/2	5	5 1/2	6	7	8	9	10	11	12
1/2	0.840	1 1/8	11/2	2	2 1/2	3	3 1/2	4	4 1/2	5	5 1/2	6	7	8	9	10	11	12
3/4	1.050	1 3/8	11/2	2	2 1/2	3	3 1/2	4	4 1/2	5	5 1/2	6	7	8	9	10	11	12
1	1.315	1 1/2	11/2	2	2 1/2	3	3 1/2	4	4 1/2	5	5 1/2	6	7	8	9	10	11	12
1-1/4	1.660	1 5/8	X	2	2 1/2	3	3 1/2	4	4 1/2	5	5 1/2	6	7	8	9	10	11	12
1-1/2	1.900	1 3/4	X	2	2 1/2	3	3 1/2	4	4 1/2	5	5 1/2	6	7	8	9	10	11	12
2	2.375	2	X	2	2 1/2	3	3 1/2	4	4 1/2	5	5 1/2	6	7	8	9	10	11	12
2-1/2	2.875	2 1/2	X	X	2 1/2	3	3 1/2	4	4 1/2	5	5 1/2	6	7	8	9	10	11	12
3	3.500	2 5/8	X	X	X	3	3 1/2	4	4 1/2	5	5 1/2	6	7	8	9	10	11	12
4	4.500	2 7/8	X	X	X	3	3 1/2	4	4 1/2	5	5 1/2	6	7	8	9	10	11	12
5	5.563	3	X	X	X	3	3 1/2	4	4 1/2	5	5 1/2	6	7	8	9	10	11	12
6	6.625	3 1/8	X	X	X	X	3 1/2	4	4 1/2	5	5 1/2	6	7	8	9	10	11	12
8	8.625	3 1/2	X	X	X	X	3 1/2	4	4 1/2	5	5 1/2	6	7	8	9	10	11	12