

Brass Compression x MIP Connector

FEATURES

- **BODY AND SLEEVE** – MADE FROM LOW LEAD, ENVIRONMENTALLY-FRIENDLY JIS 6802 BRASS FOR INCREASED CORROSIVE-RESISTANCE
- **NUT** - MADE FROM ROHS COMPLIANT LOW LEAD JIS C3604 BRASS FOR SAFE AND EFFECTIVE USE ON COMMERCIAL AND RESIDENTIAL JOBS

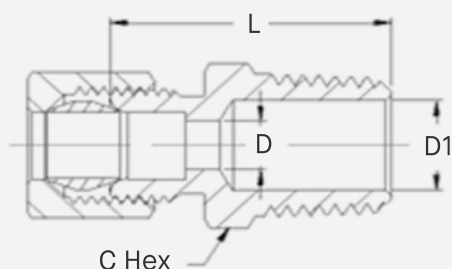
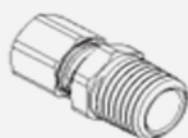

SKU	Tube OD	Male Pipe Thread	C Hex	D	D1	L
BCM025	1/4"	1/4"	.453"	.185"	.346"	.976"
BCM025-018	1/4"	1/8"	.714"	.217"	--	.843"
BCM025-038	1/4"	3/8"	.878"	.217"	.472"	1.087"
BCM025-050	1/4"	1/2"	.714"	.197"	.591"	1.063"
BCM038	3/8"	3/8"	.582"	.380"	--	1.102"
BCM038-025	3/8"	1/4"	.878"	.346"	--	1.024"
BCM038-050	3/8"	1/2"	.878"	.380"	--	1.220"
BCM050	1/2"	1/2"	.878"	.506"	--	1.220"
BCM058-050	5/8"	1/2"	.878"	.628"	--	1.260"
BCM078-075	7/8"	3/4"	1.167"	.748"	--	1.201"