

<b>JOB:</b>	<b>REPRESENTATIVE:</b>	
<b>UNIT TAG:</b>	<b>ORDER NO.:</b>	<b>DATE:</b>
<b>ENGINEER:</b>	<b>SUBMITTED BY:</b>	<b>DATE:</b>
<b>CONTRACTOR:</b>	<b>APPROVED BY:</b>	<b>DATE:</b>

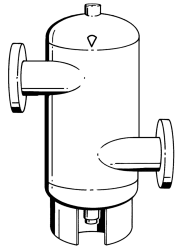

# ROLAIRTROL<sup>®</sup>

## Air Separator

Flanged Less Strainer  
Air Control and Elimination

**DESCRIPTION**

The Rolairtrol Air Separator is an ASME vessel designed with tangential openings to create a low velocity vortex where air is separated and removed from the circulating water.

**CONSTRUCTION MATERIALS**

- | Designed and constructed per ASME Section VIII, Division 1
- | Shell: Carbon Steel

**MAXIMUM WORKING PRESSURE**

125 PSIG (862 kPa)

**MAXIMUM OPERATING TEMPERATURE**

350°F (177°C)

Consult factory for higher working pressures and temperatures.

PART NUMBER	MODEL NUMBER	Capacity GPM (m <sup>3</sup> /hr)	Flanged Tangential Opening in. (mm)	TAGGING INFORMATION	QUANTITY
5363-03F-12-003	RL-3F	190 (43.2)	3 (76.2)		
5363-04F-12-003	RL-4F	300 (68.1)	4 (101.6)		
5363-05F-12-003	RL-5F	530 (120.4)	5 (127.0)		
5363-06F-12-003	RL-6F	850 (193.0)	6 (150.0)		
5363-08F-12-004	RL-8F	1,900 (431.5)	8 (203.2)		
5363-10F-12-003	RL-10F	3,600 (817.6)	10 (254.0)		
5363-12F-12-003	RL-12F	4,800 (1090.1)	12 (300.0)		
5363-03F-12-004	RL-3FB	190 (43.2)	3 (76.2)		
5363-04F-12-004	RL-4FB	300 (68.1)	4 (101.6)		
5363-05F-12-004	RL-5FB	530 (120.4)	5 (127.0)		
5363-06F-12-004	RL-6FB	850 (193.0)	6 (150.0)		
5363-08F-12-005	RL-8FB	1,900 (431.5)	8 (203.2)		
5363-10F-12-004	RL-10FB	3,600 (817.6)	10 (254.0)		
5363-12F-12-004	RL-12FB	4,800 (1090.1)	12 (300.0)		

Model numbers with a B suffix include bracket supports.

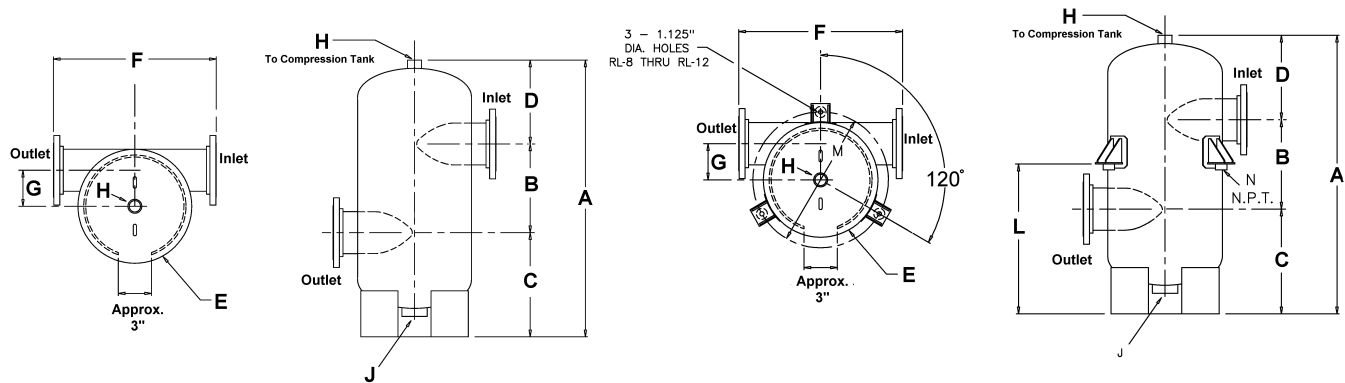

**DIMENSIONS in Inches (mm) AND WEIGHTS in Lbs (kg.)**

MODEL NUMBER	A	B	C	D	E	F	G	H	J	L*	M*	N*	Cv	Approx. Volume in Gallons (Ltr.)	Approx. Shpg. Wt. in Lbs. (Kg)	Flood Wt. Less Bracket in Lbs. (Kg)	Bracket Wt. in Lbs. (Kg)†
RL-3F (B)	26-7/8 (683)	8 (203)	10-13/16 (275)	8-1/16 (205)	10-3/4 (273)	22-3/4 (578)	3-5/8 (92)	1-1/4 (32)	2 (51)	13-3/8 (340)	14 (356)	2 (51)	215	7 (26)	115 (52)	173 (79)	9 (4)
RL-4F (B)	31-7/16 (799)	10 (254)	11-15/16 (303)	9-1/2 (241)	12-3/4 (324)	20-1/2 (521)	4-1/8 (105)	1-1/2 (38)	2 (51)	15-3/8 (391)	16 (406)	2 (51)	370	13 (49)	155 (70)	263 (119)	9 (4)
RL-5F (B)	37 (940)	12 (305)	14-1/16 (357)	10-15/16 (278)	16 (406)	23-3/4 (603)	5-1/4 (133)	1-1/2 (38)	2 (51)	18-1/2 (470)	19-3/8 (492)	2 (51)	580	25 (95)	205 (93)	414 (188)	9 (4)
RL-6F (B)	44-1/16 (1119)	14 (356)	16-13/16 (427)	13-1/4 (337)	18 (457)	25-3/4 (654)	5-11/16 (144)	1-1/2 (38)	2 (51)	22-1/8 (562)	21-1/4 (540)	2 (51)	850	34 (129)	280 (127)	564 (256)	9 (4)
RL-8F (B)	54 (1372)	18 (457)	19-7/16 (494)	16-9/16 (421)	24 (610)	31-3/4 (806)	7-11/16 (195)	2 (51)	2 (51)	26 (660)	29-1/2 (749)	2 (51)	1,445	90 (341)	420 (190)	1,171 (531)	30 (14)
RL-10F (B)	64-11/16 (1643)	22 (559)	22-5/8 (575)	20-1/16 (510)	30 (762)	37-3/4 (959)	9-5/8 (244)	2 (51)	2 (51)	31-5/8 (803)	35-1/2 (902)	2 (51)	2,340	150 (568)	800 (363)	2,052 (930)	30 (14)
RL-12F (B)	75-3/8 (1915)	27 (586)	25-3/4 (654)	22-5/8 (575)	36 (914)	46-3/4 (1187)	11-5/8 (295)	2 (51)	2 (51)	37-5/8 (956)	41-1/2 (1054)	2 (51)	3,300	291 (1,101)	1,110 (503)	3,538 (1,605)	30 (14)

\*Indicates measurements for models that have optional support brackets

†Bracket weight should be added to flood weight and approximate shipping weight for models that are being supplied with optional support brackets.

**Important Note: Dimensions not to be used for construction.**

**IMPORTANT NOTES:**

1. Consult IOM A85524 for safety and service instructions.
2. Lifting lugs are for the transportation and installation of the empty vessel, and are not to be used for complete or partial support of the flood vessel.
3. The RL skirt can support flooded vessel weight.
4. Welding to the pressure vessel boundary will void the ASME stamp.
5. Standard Rolairtrol design up to 12' can be hung from the nozzles using hangers. Optional, factory welded, support brackets are available for an additional cost.

Xylem Inc.  
 8200 N. Austin Avenue  
 Morton Grove, IL 60053  
 Phone: (847)966-3700  
 Fax: (847)965-8379  
 www.bellgossett.com



**Rolairtrol® Air Separator Performance Coverage Chart**

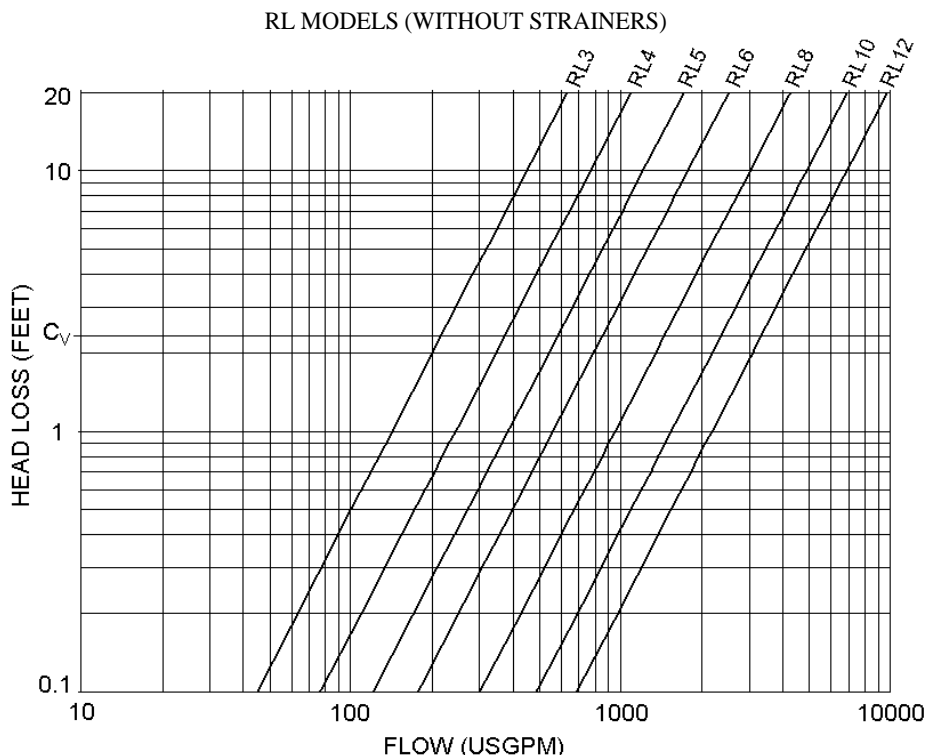

**Note:** Pressure drops for a range of flow are indicated on this chart. Users should select Rolairtrol using B&G published capacity guidance, and ASHRAE pipe sizing recommendations for optimal performance.

**TYPICAL ROLAIRTROL SPECIFICATIONS**

Furnish and install, as shown on plans, a centrifugal type air separator. The unit shall have \_\_\_\_\_" inlet and outlet flanged connections tangential to the vessel shell. The unit shall have the capability to direct accumulated air to the compression tank (air control system) or air vent (air elimination system) via an NPT vent connection at top of unit.

A blowdown connection shall be provided to facilitate routine cleaning. Specify B&G Model MBV-1 Rolairtrol accessory with appropriate fittings for manual blowdown.

Vessel shell diameter to be three times the nominal inlet/outlet pipe diameter, with a minimum vessel volume for sufficient velocity reduction.

The air separator must be designed, constructed and stamped for 125 psig @ 375°F (862 kPa @ 191°C) in accordance with Section VIII, Division I of the ASME Boiler and Pressure Vessel Code, and registered with the National Board of Boiler and Pressure Vessel Inspectors. The air separator(s) shall be painted with one shop coat of light gray air dry enamel.

Each air separator shall be Bell & Gossett Model No. \_\_\_\_\_ Rolairtrol Air Separator for \_\_\_\_\_ GPM ( \_\_\_\_\_ m<sup>3</sup>), Shell Dia. \_\_\_\_\_" ( \_\_\_\_\_ mm) and Min. Vessel Volume \_\_\_\_\_ Gal ( \_\_\_\_\_ liters).

**Refer to submittal A-329 for information on the MBV-1 manual blowdown valve.**

Xylem Inc.  
8200 N. Austin Avenue  
Morton Grove, IL 60053  
Phone: (847)966-3700  
Fax: (847)965-8379  
www.bellgossett.com

